

# *HardCabs*

*A DFK AMERICA COMPANY*

*INSTALLATION INSTRUCTIONS*

## **YAMAHA** **RHINO 700**

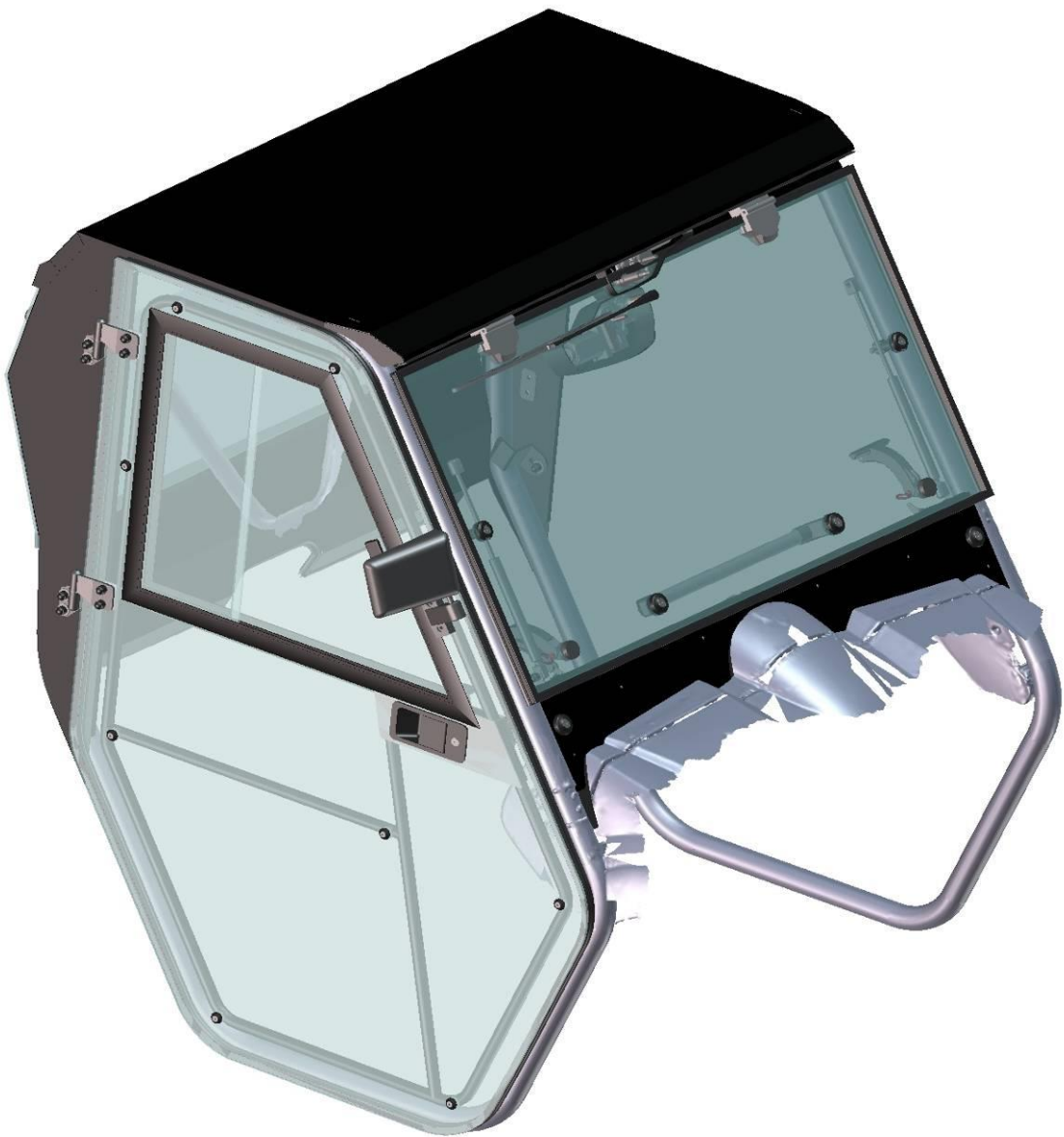

## **SAFETY INSTRUCTIONS**

***Warning: Failure to heed all safety and operating instructions and warnings regarding use of this product can result in serious bodily injury.***

### **READ PROPERLY COMPLETE ASSEMBLY INSTRUCTIONS BEFORE STARTING OF ASSEMBLY**

***Install all parts indicated in assembly instructions. Failure to fully assemble product before use could result in personal injury.***

***Assembly of product requires use of hand or power tools.  
If you are not experienced in using these types of tools,  
have product dealer do the install for you.***

***Some parts contain sharp edges, wear protective gloves if necessary.***

***Always keep your assembly area clean, uncluttered and well lit.***

***Keep visitors and children a safe distance away from the assembly area. Visitors should wear the same safety equipment described above.***

***Never operate your UTV with the cab doors open. Failure to properly latch the doors before moving the vehicle could result in serious injury.***

***Dress for safety. DO NOT wear loose clothing, gloves, neckties or jewelry if using power tools to assemble this product.***

***Tight the front glass holders screws with attention, if you tight these screws too hard the front glass may by crackle.***

***Insert all nut covers after you finish installation.***

***Never drive your UTV with the cab front window in open position.  
Failure to properly latch/lock front window before driving the vehicle  
could result in serious injury.***

***For safety purposes, if the DFK Cab doors are removed, it is mandatory that the OEM Half Doors or Nets are REINSTALLED before operating vehicle.***

## **MAINTENANCE AND CLEANING**

***To clean polycarbonate surface use soapy water solution or other subtle means.***

***Dirt and dust wash by gently water stream and swipe only with wet or damp means in the direction from top to bottom.***

***The recommended frequency of cleaning of polycarbonate part is about 1 time per month or according to the actual degree of pollution.***

***Do not use detergents that could scratch the surface plates.  
(abrasives, harsh fabrics, etc.)***

***Do not use solvents or alkaline detergents or cleaners with ammonia  
(ammonium hydroxide).***

***Do not remove the impurities from the surface of the razor blades or other sharp items.***

***Do not clean cabin when the polycarbonate plates are heated by the sun.***

***Do not use the squeegee, it could be scratched surface plates.***

***Do not clean the water current strength greater than 50 bar (WAP)***

***The manufacturer is not responsible for scratching the surface in case of failure to comply with the above instructions.***

***All bolted connections of cab must be by user at regular intervals checked and tightened.***

**FRONT PANEL**

Uninstall the rubber locks of the movable engine cover (in red rectangle) and install these rotated back on both sides.

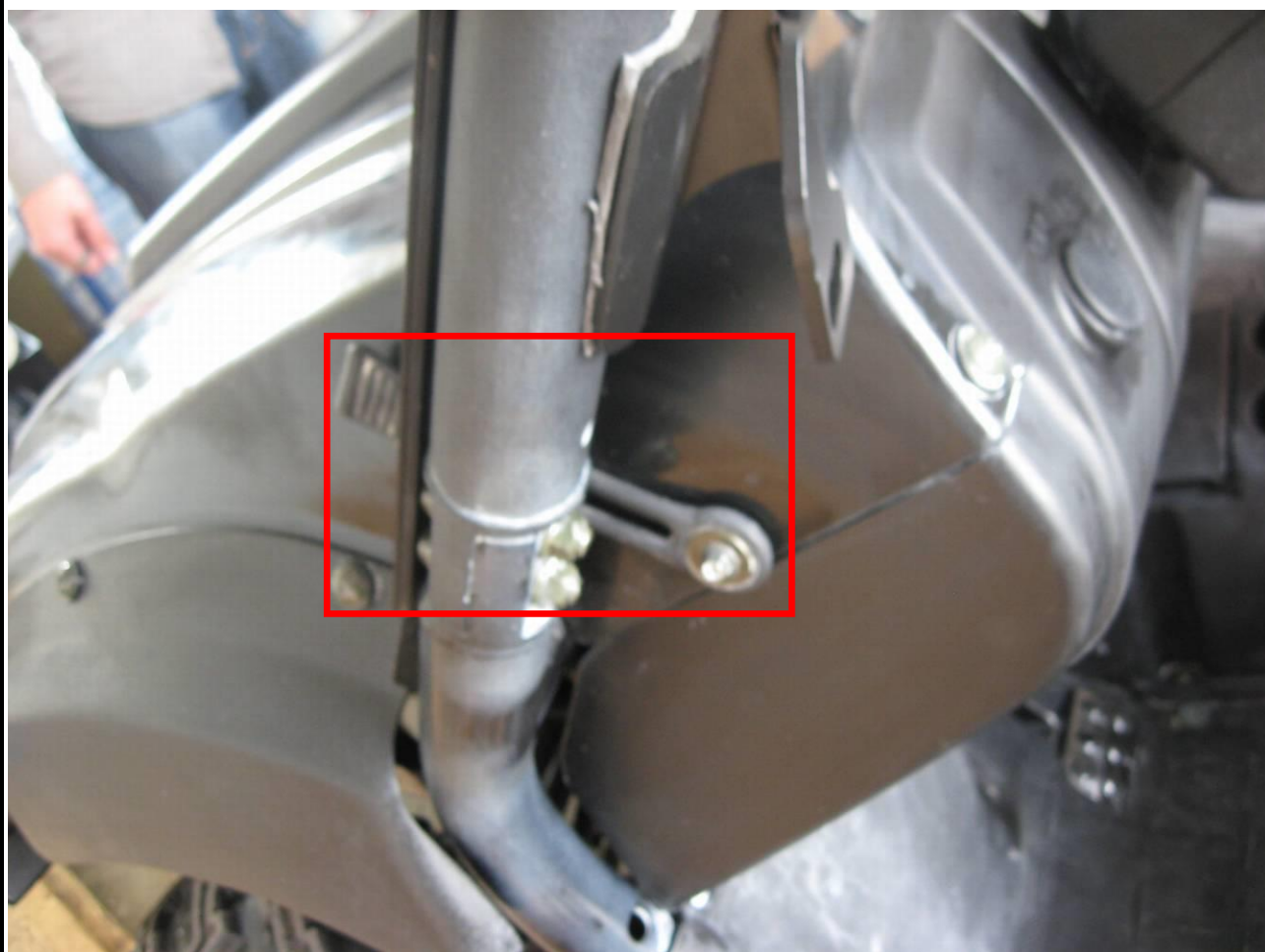

Place the bottom front metal ledge onto the dashboard.

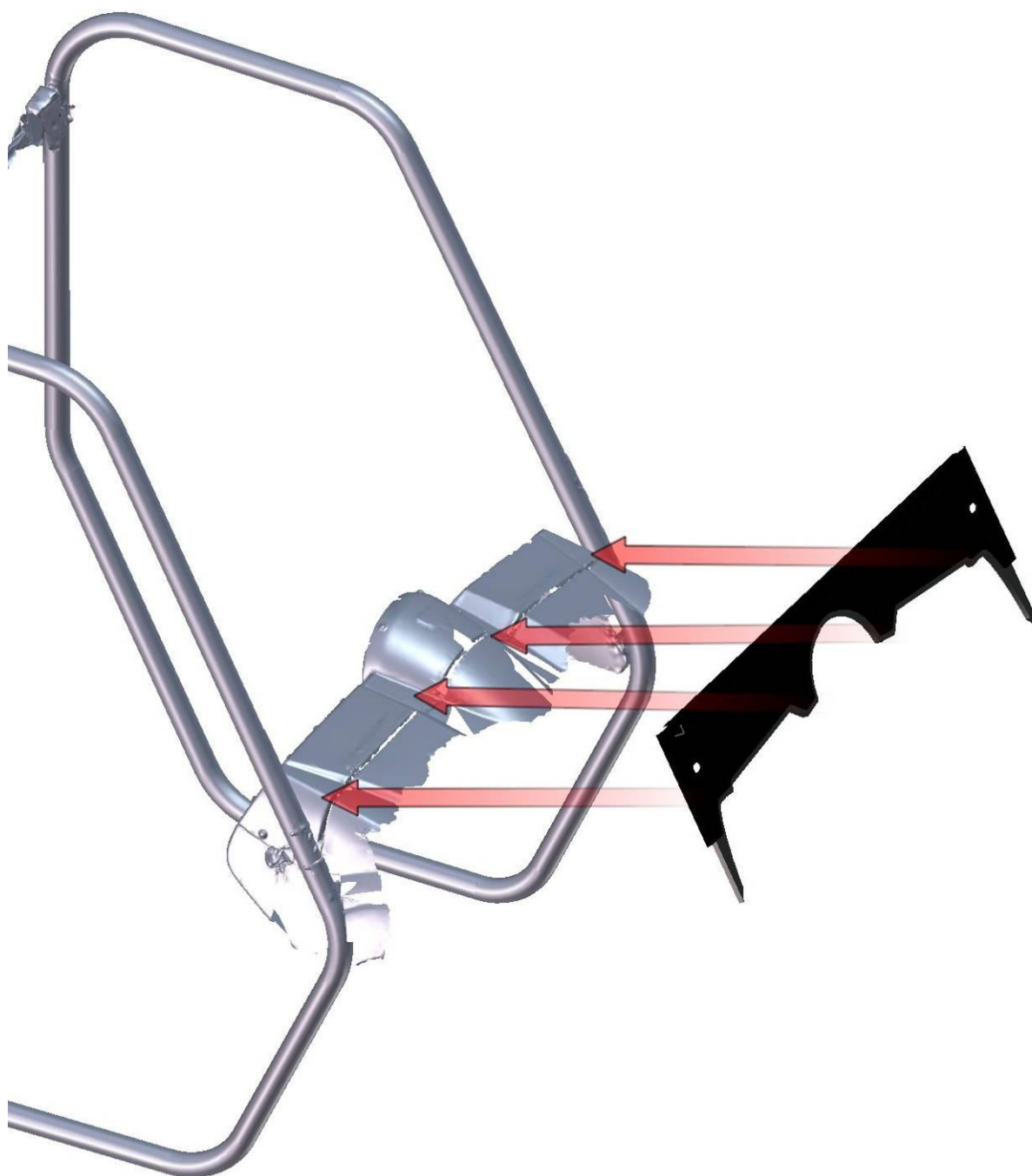

5

Install the door stop assembly into the door stop holder (step 1). Place the door stop holder onto the front ledge holder (step 2). Fix the door stop holder with the front ledge holder by nuts, washers and nut covers (step 3). Tighten nuts very gently now.

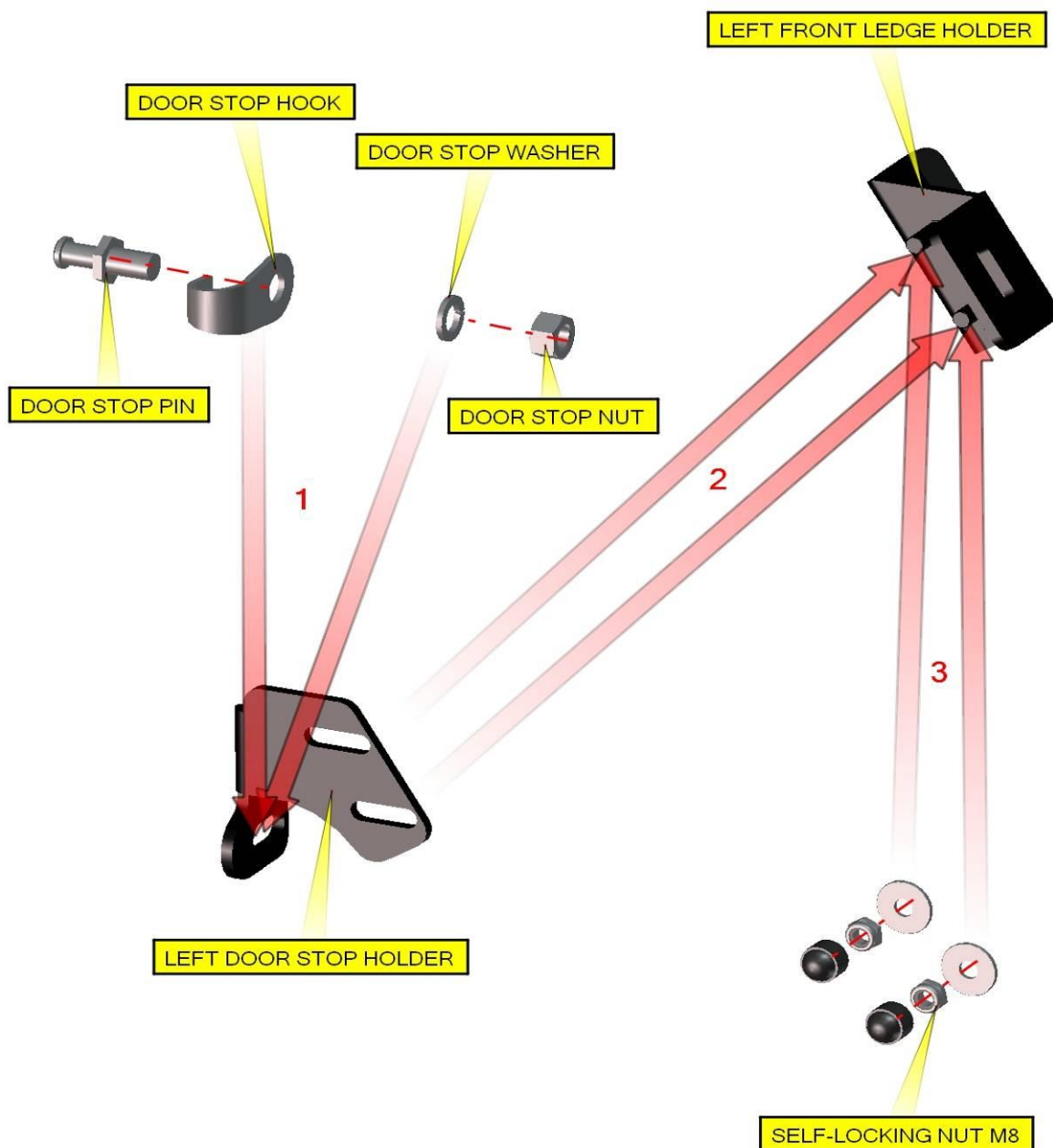



Fix the front bottom ledge with the holder to the UTV's roller cage on both sides by screws, washers, nuts and nut covers.

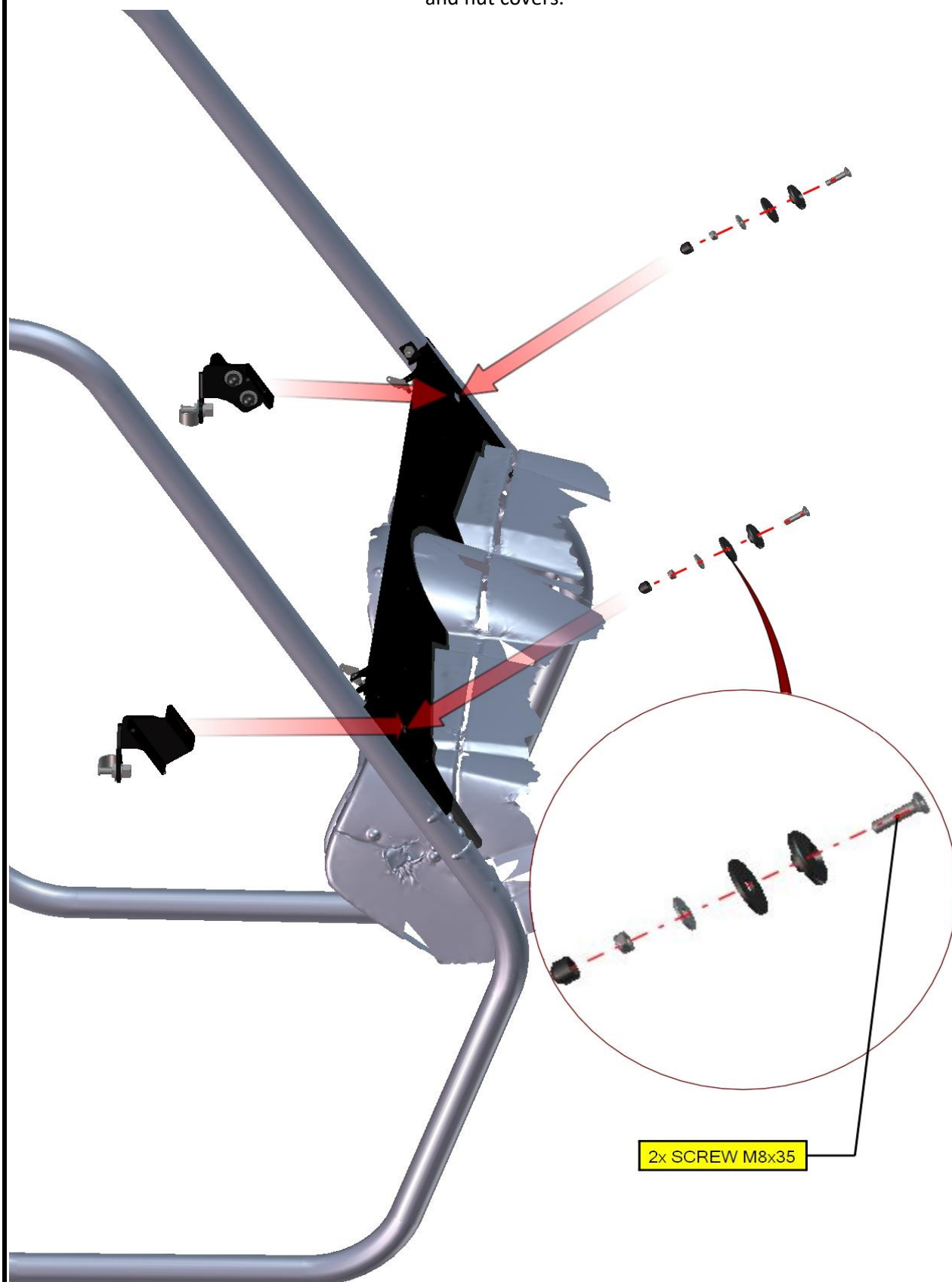

Place the hinge with the hinge washer onto the front upper ledge.

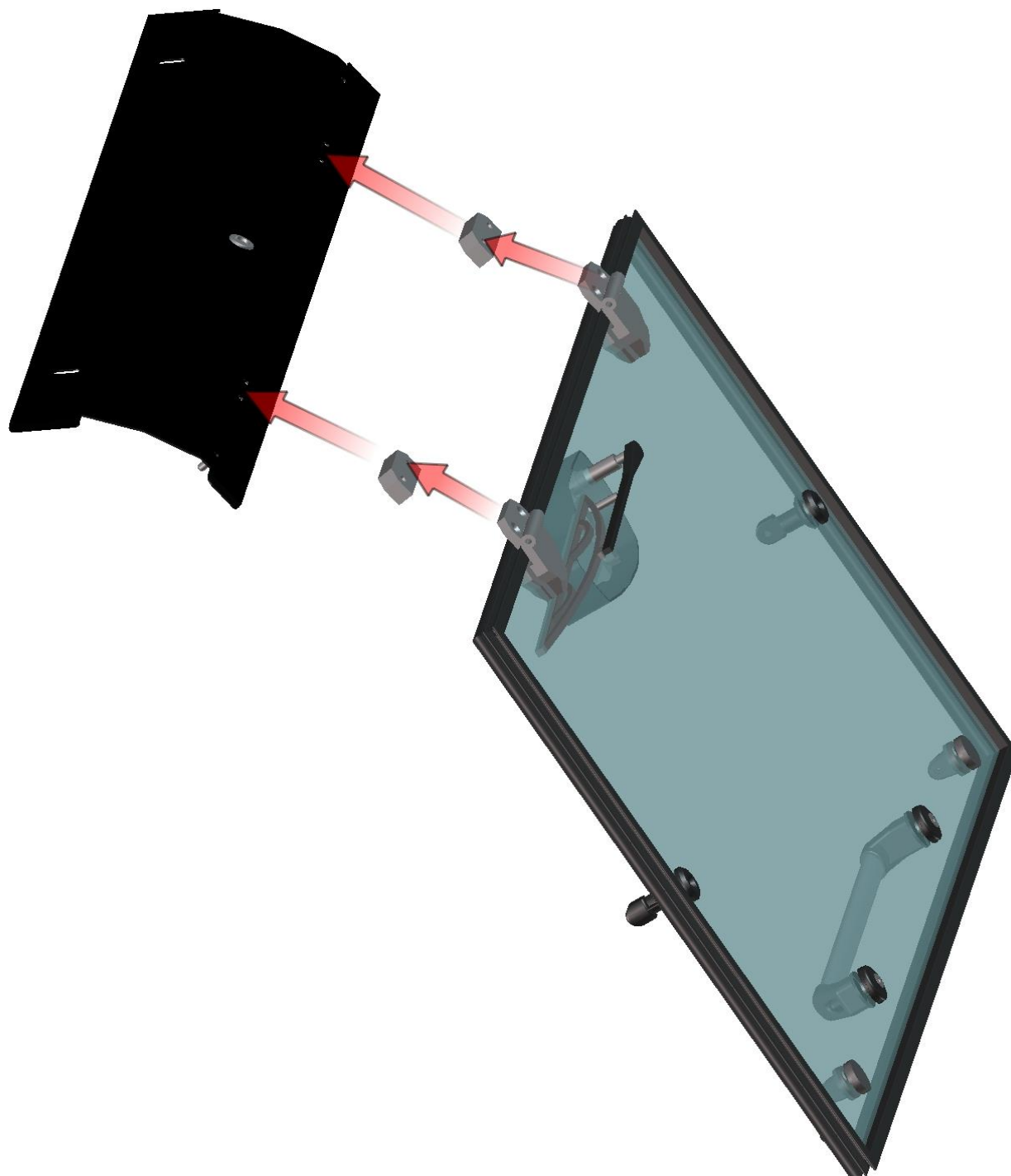



Fix the hinges with the upper ledge by screws, washers, nuts and nut covers.

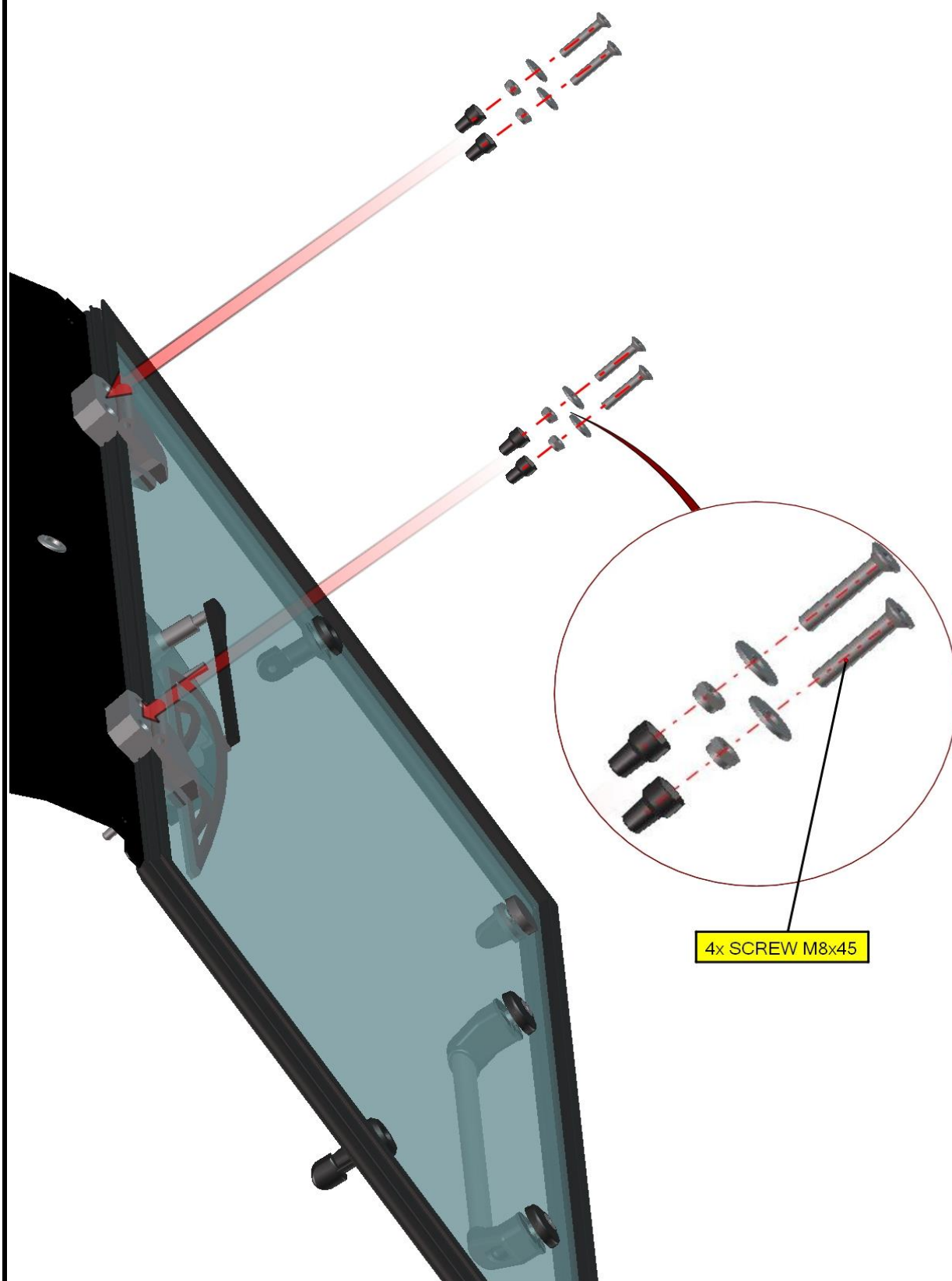

Place the front glass assembly onto the UTV's roller cage.

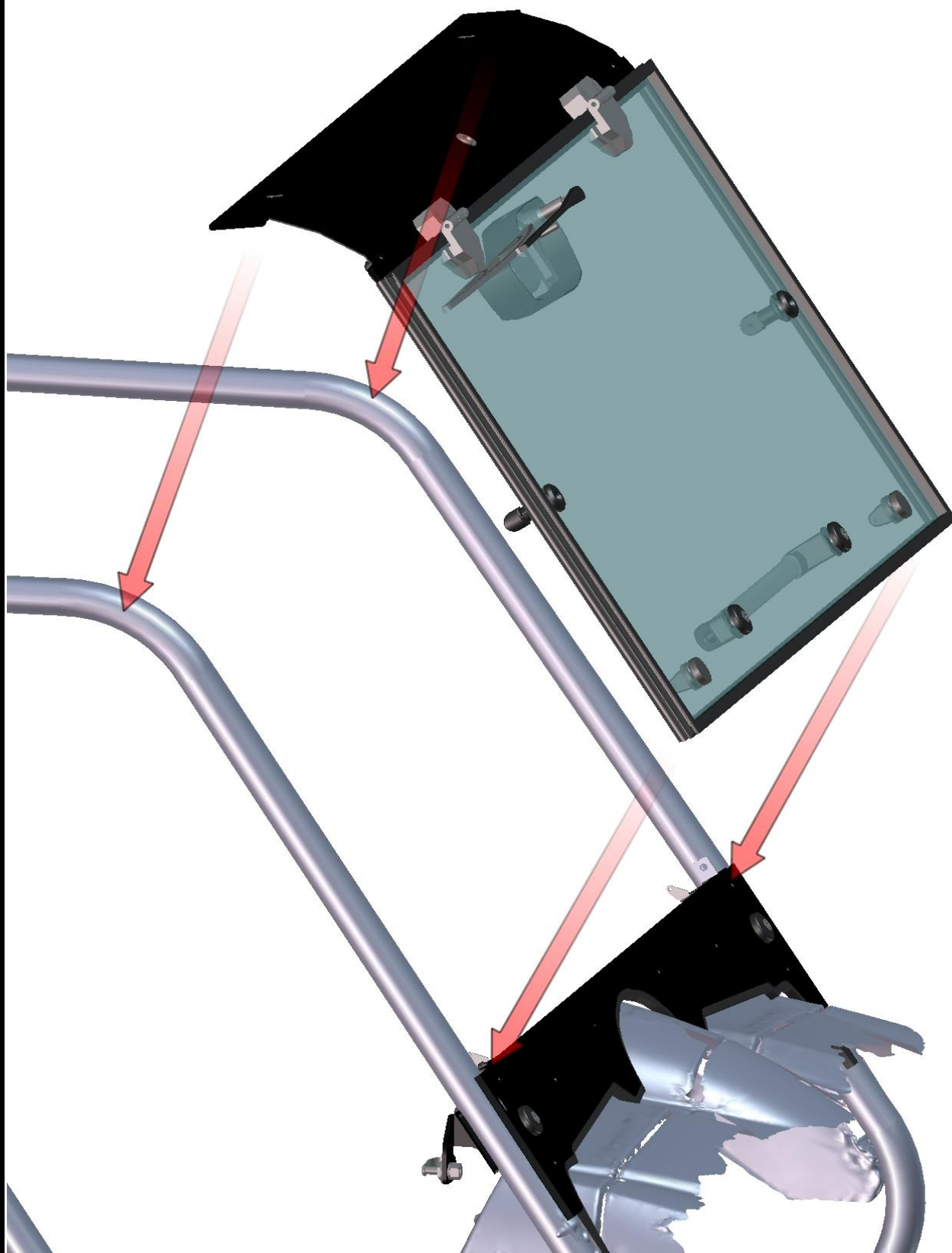

10

Place the front upper ledge holders onto the front upper ledge.

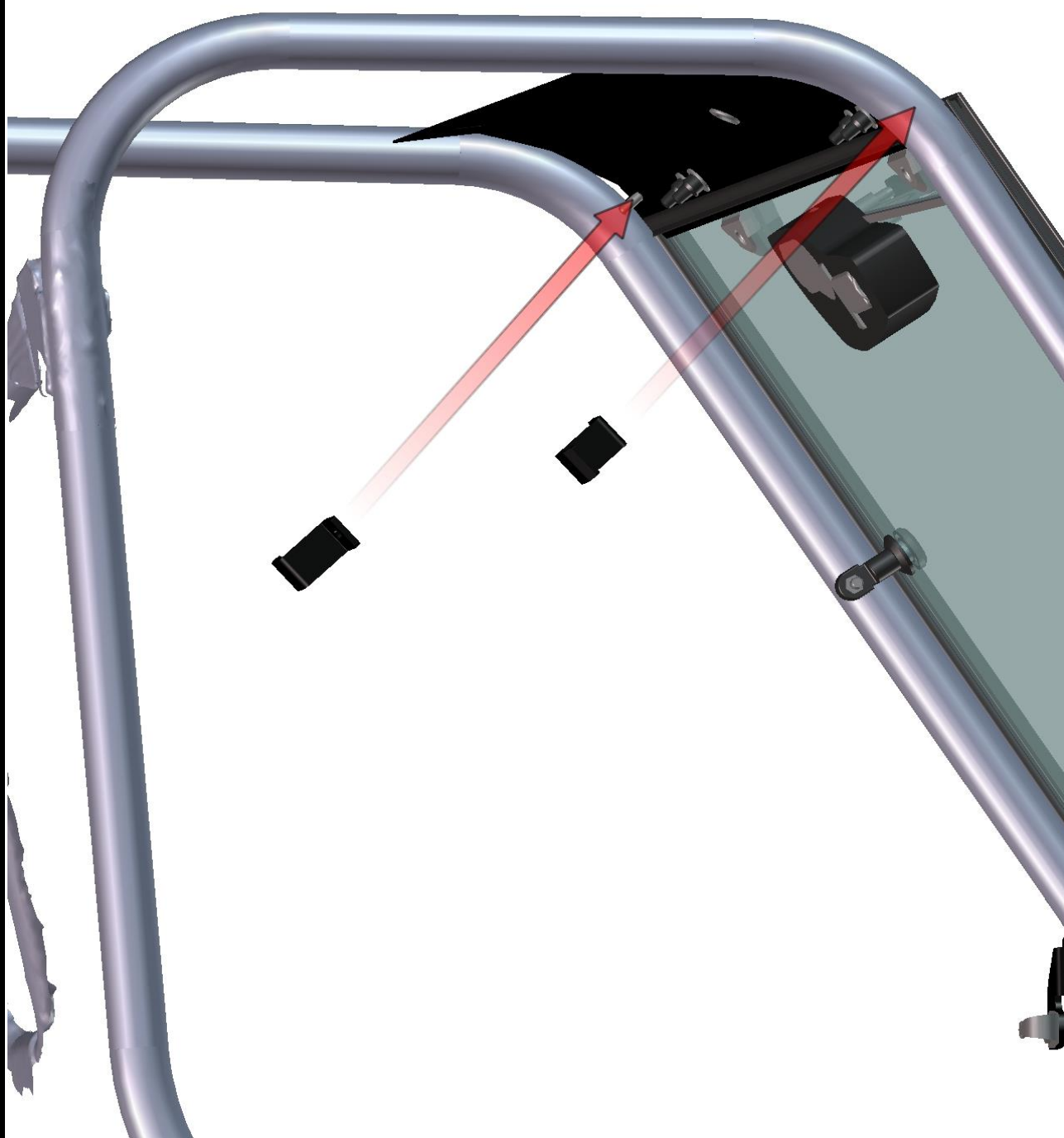

11

Fix the holders with the ledge to the roller cage by nuts, washers and nut covers.

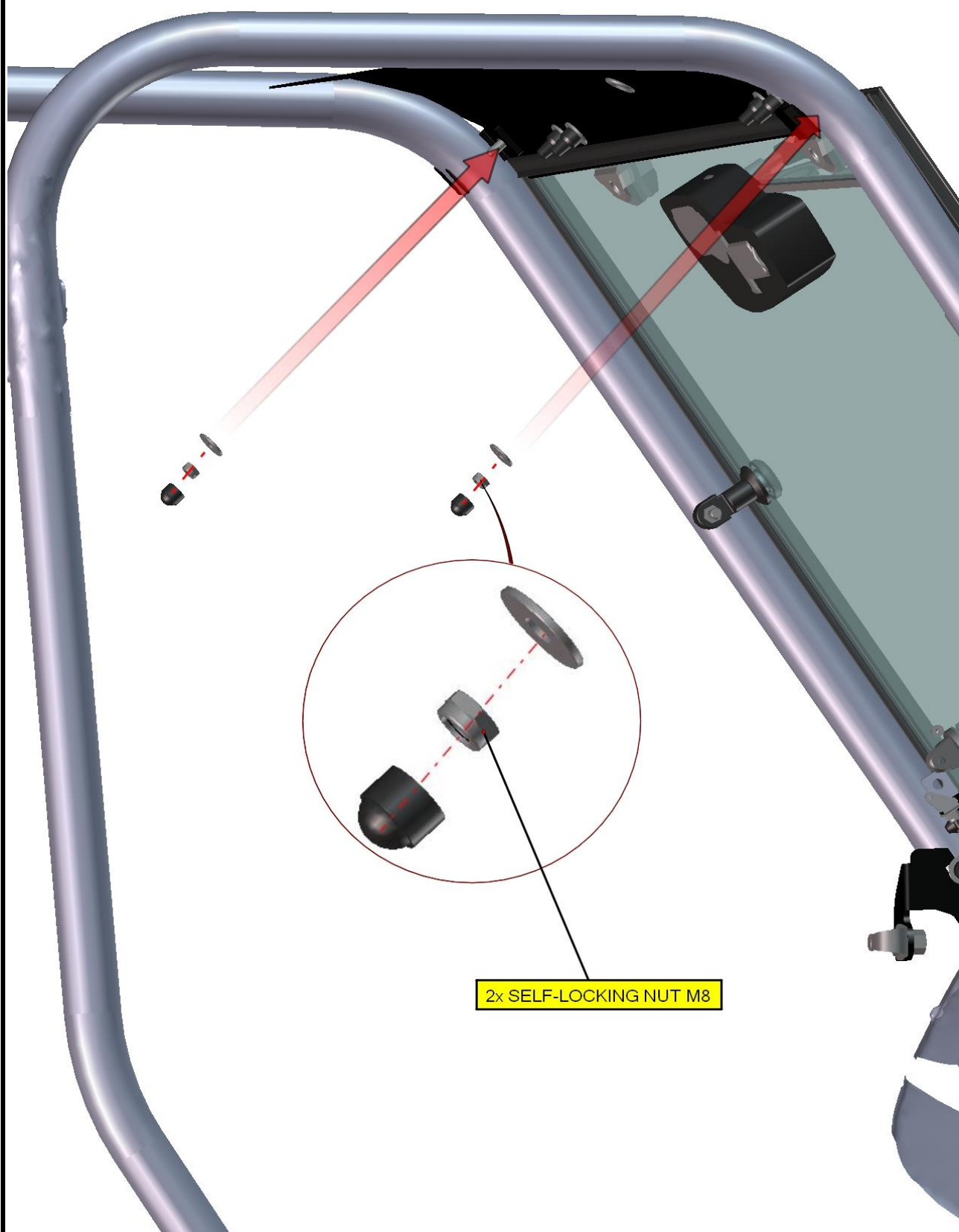

12

Open the front window. Place the front glass locks onto the holders and fix by the pins (red).



13



Insert the gas spring into the gas spring holder on UTV's both sides.



14



Insert the gas spring into the gas spring metal holder on UTV's both sides.

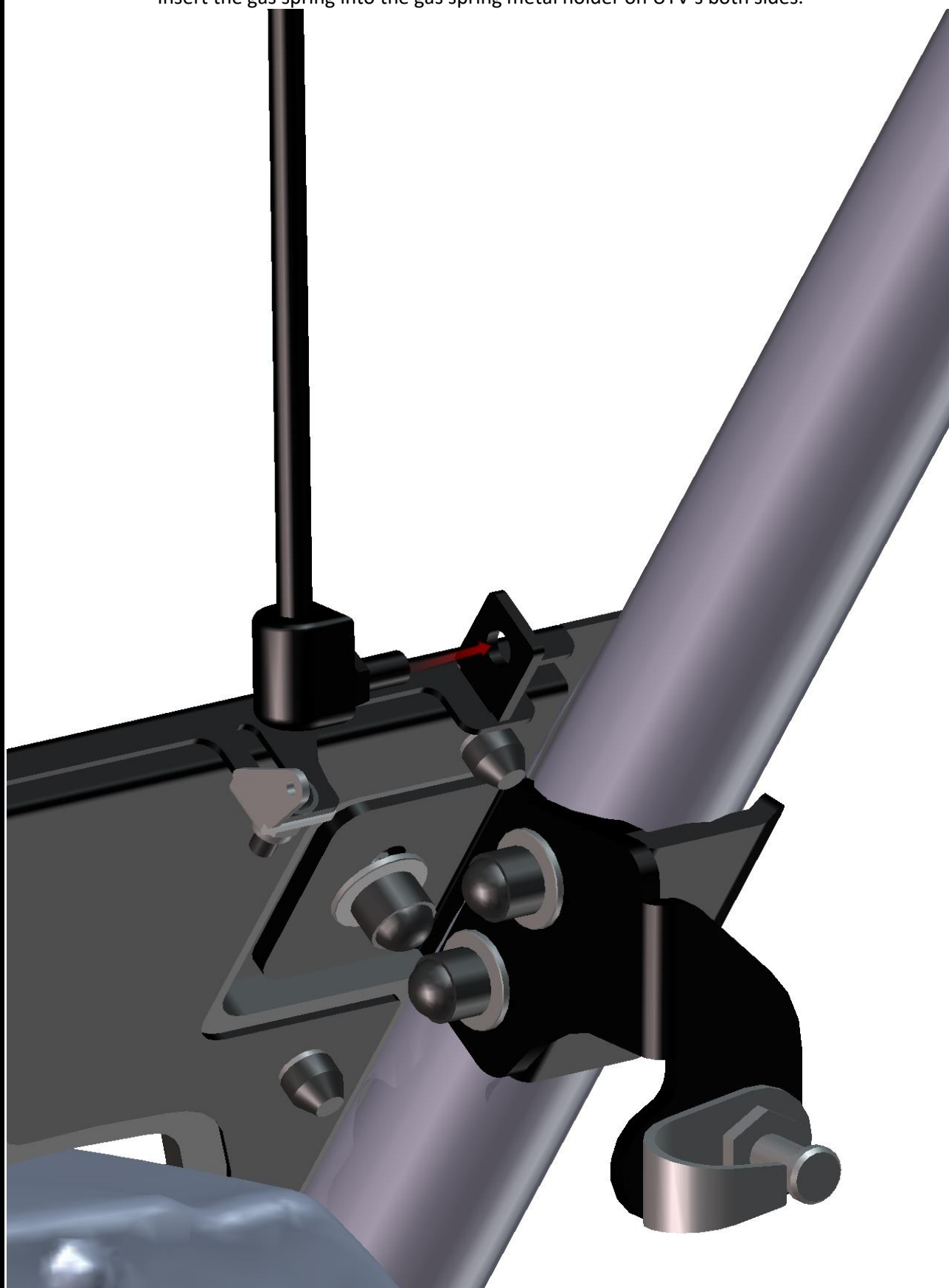

15

Fix the gas spring with the holder by nut, washer and nut cover on UTV's both sides.

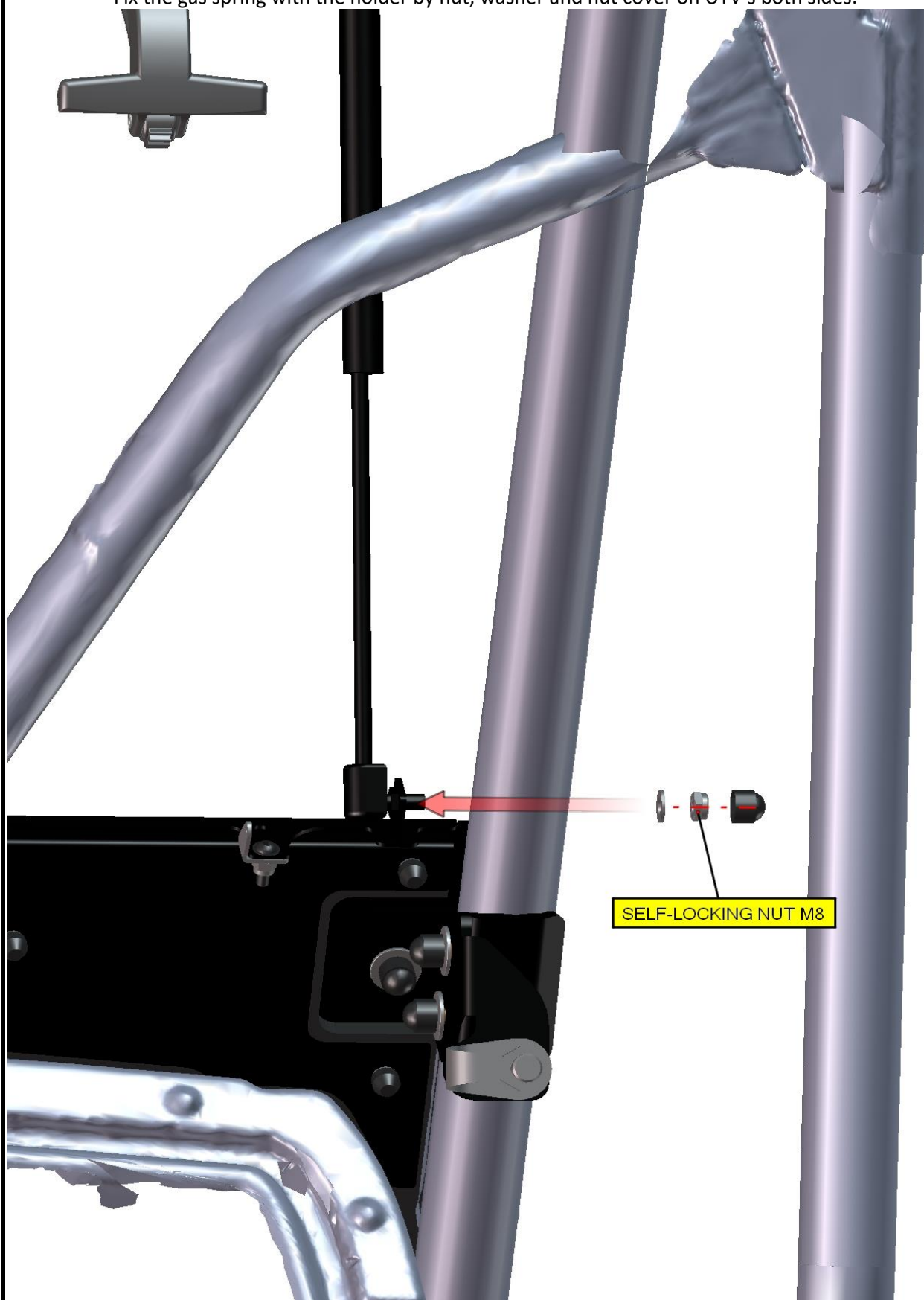

Fix the front glass lock with metal holder by included screw. Allow the holder's screw (in red circle).  
Repeat these step on second side of the UTV's.

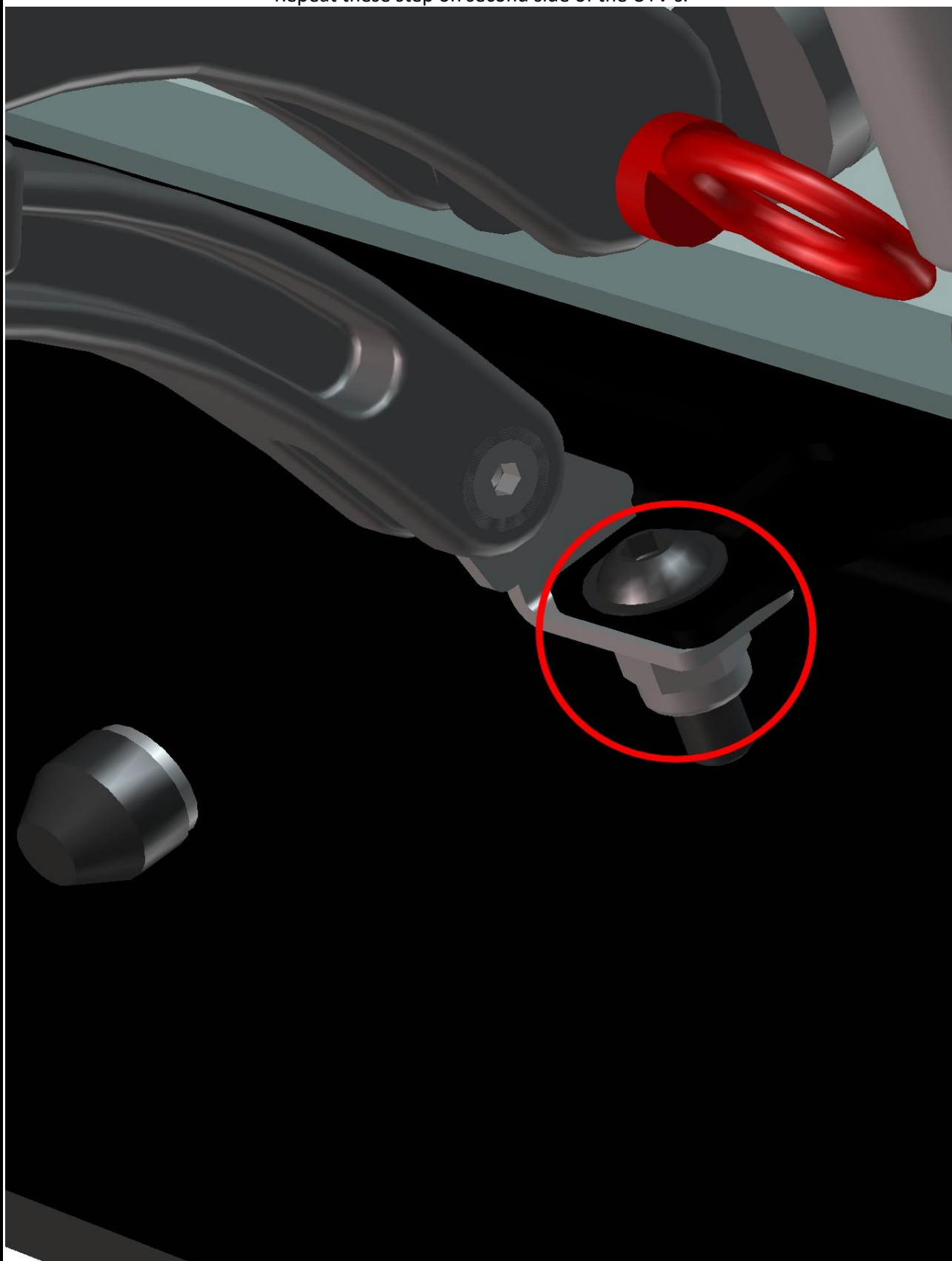

Close the window slowly to correct position and adjust the window lock holder on both sides.  
Tighten holder's screws and nut.



**REAR PANEL**

Uninstall the screws from the rear middle section of the roller cage on both sides (in red circle).  
Save these screws for later use.



Place the door bases onto the UTV's roller cage.

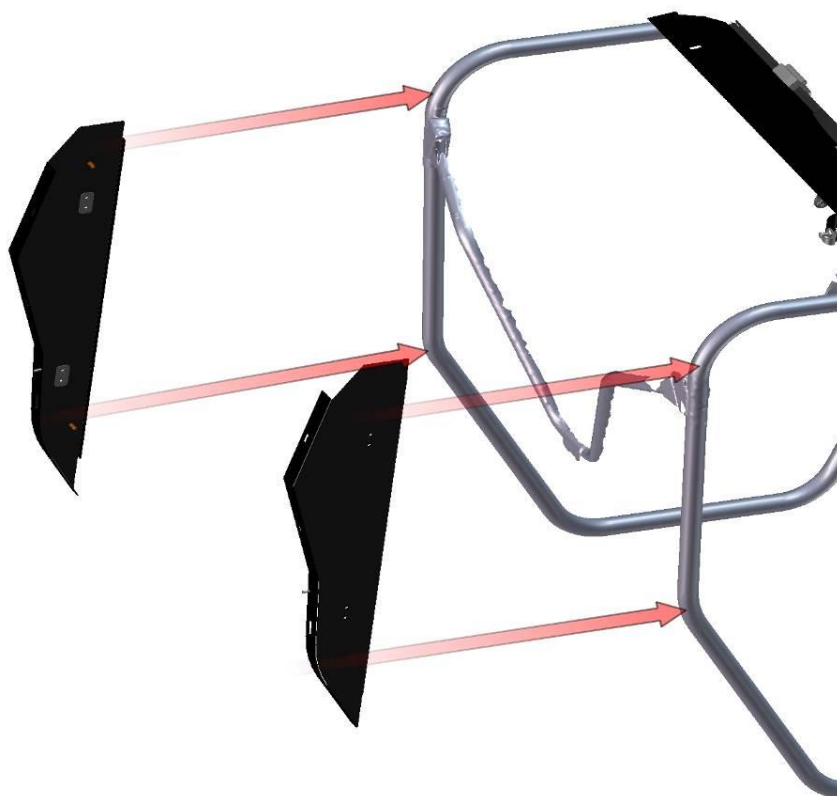



Insert the door base holders on the welded screws.

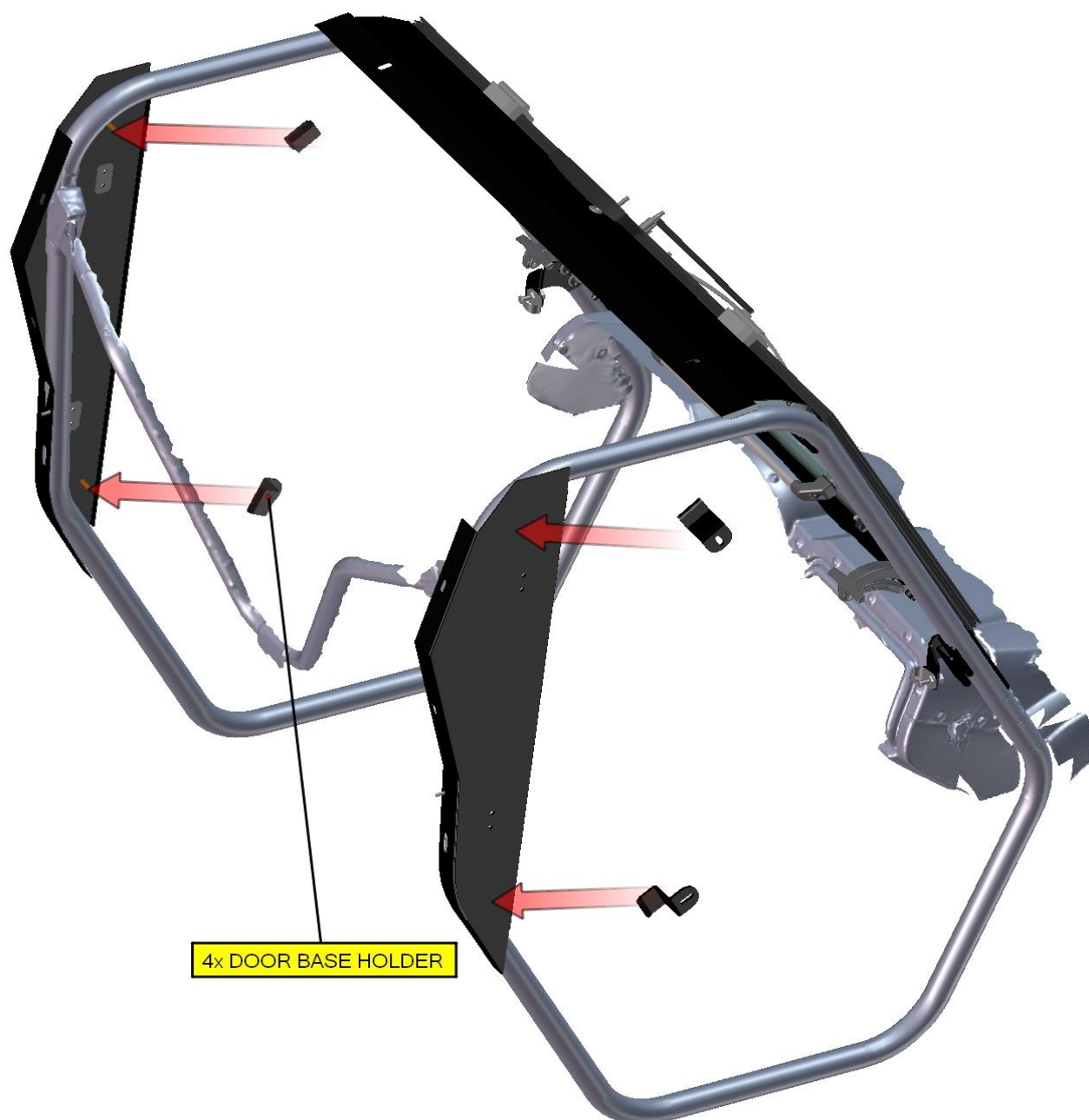

20



Fix the door base holders together with door base to the roller cage with washer, nut and nut cover.

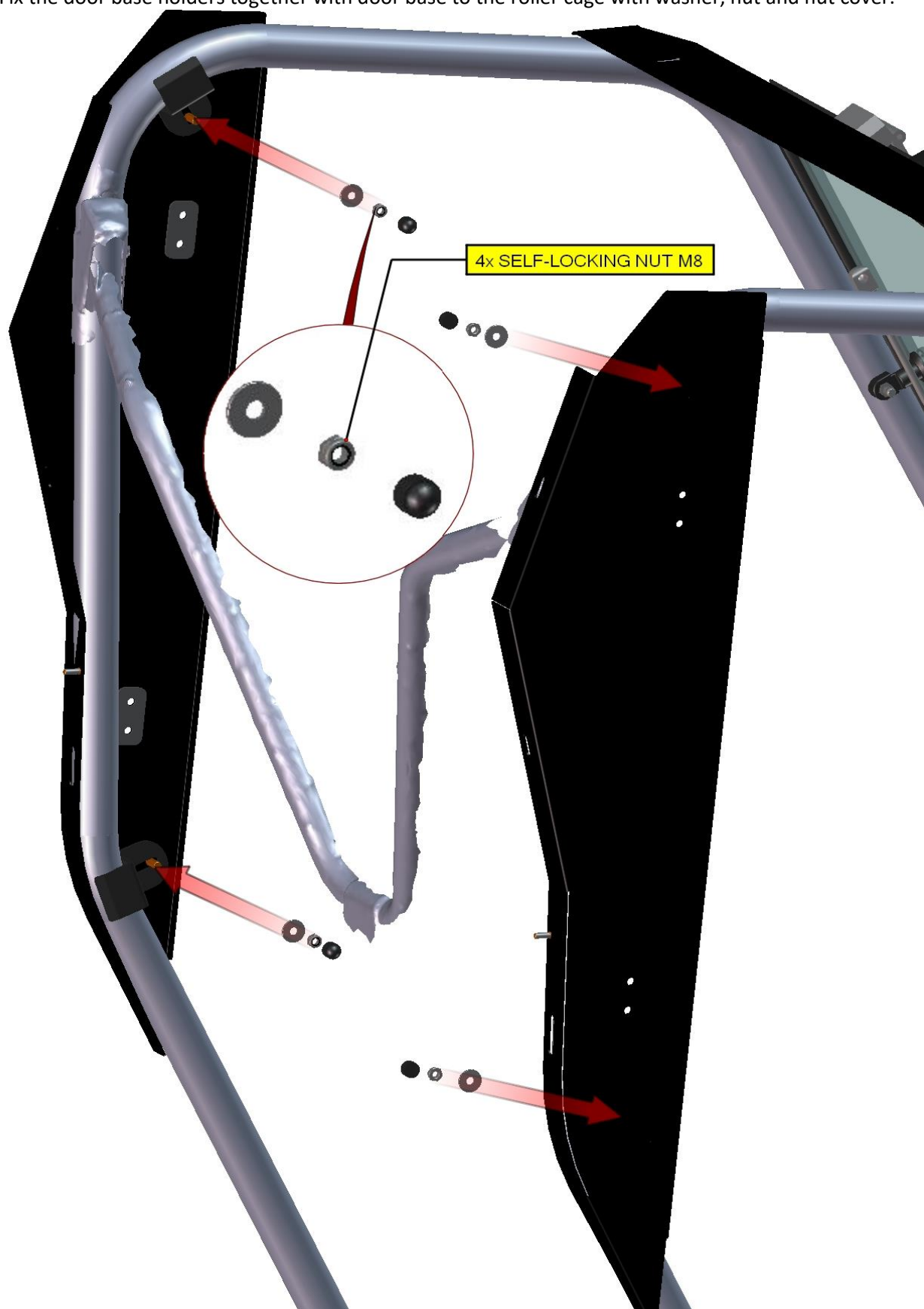

Stick the seal onto the roller cage on both sides.



View onto installed rear bottom ledge. [See next pages.](#)



Place the rear bottom ledge onto the door bases.

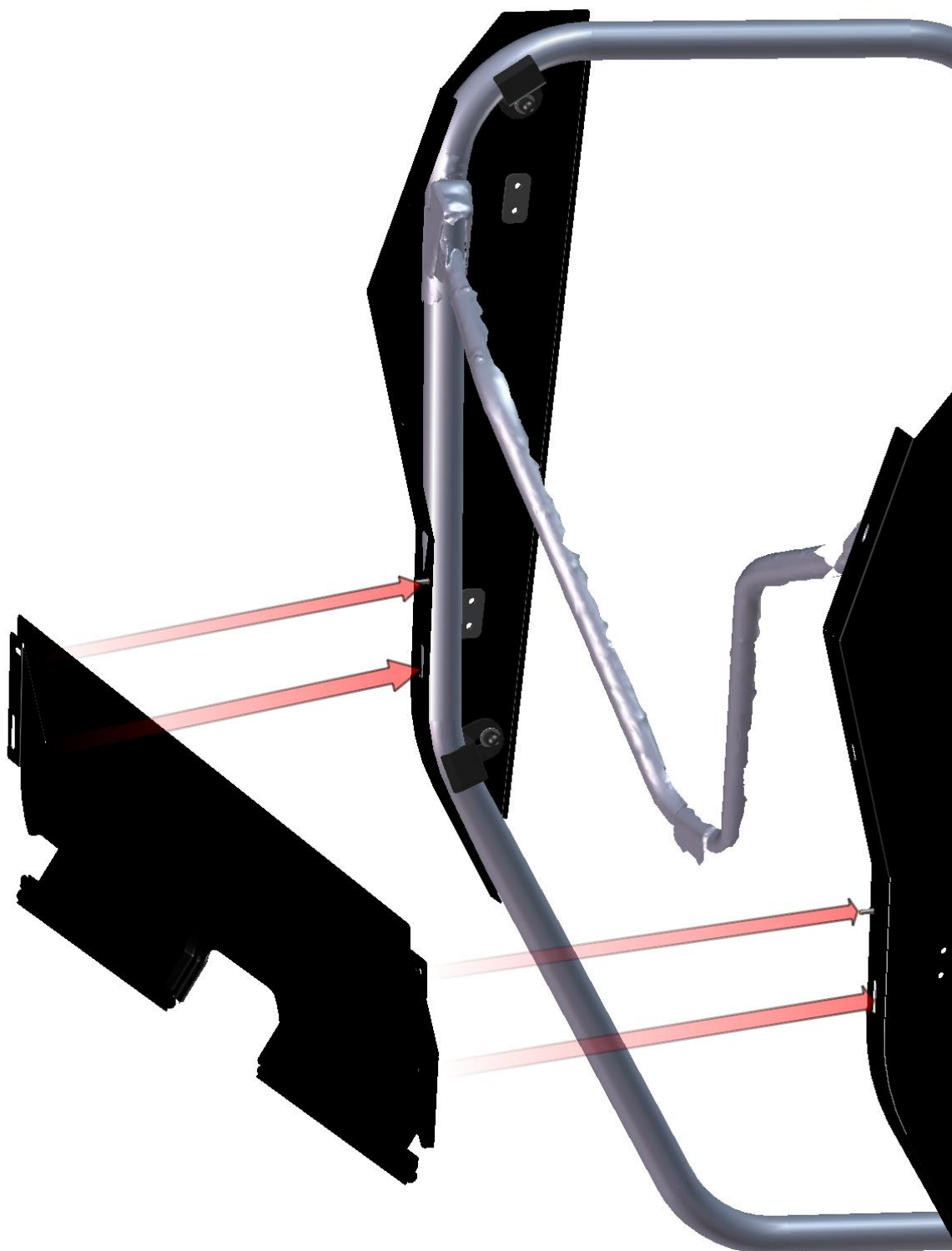

23

Fix the bottom rear ledge with the door bases.  
Take the saved screws ( from page 19) and change original outer washers with washers  $\phi 10$ .  
Insert the screws back to the roller cage (in red circles).

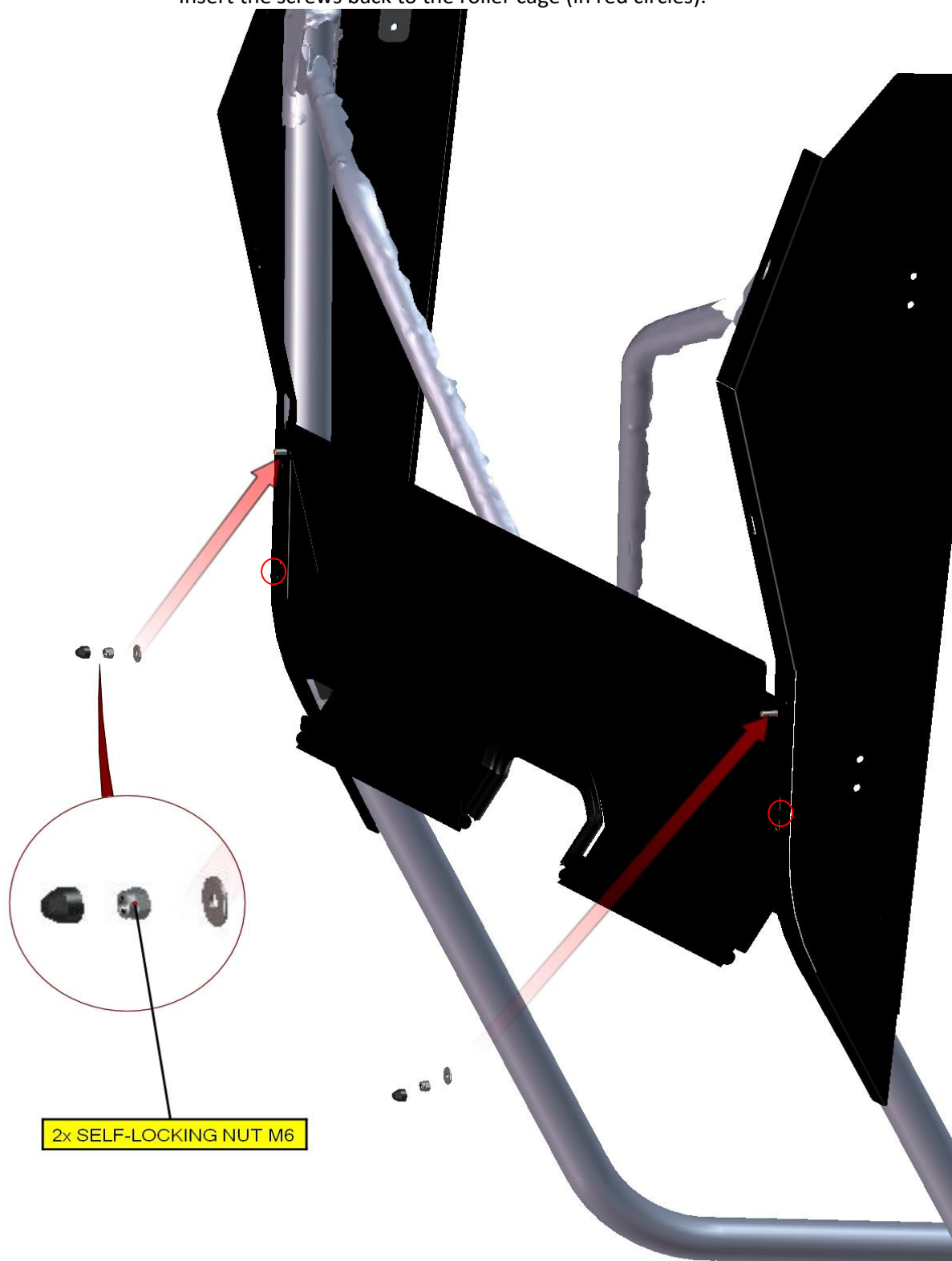

Place the rear polycarbonate panel onto the door bases.

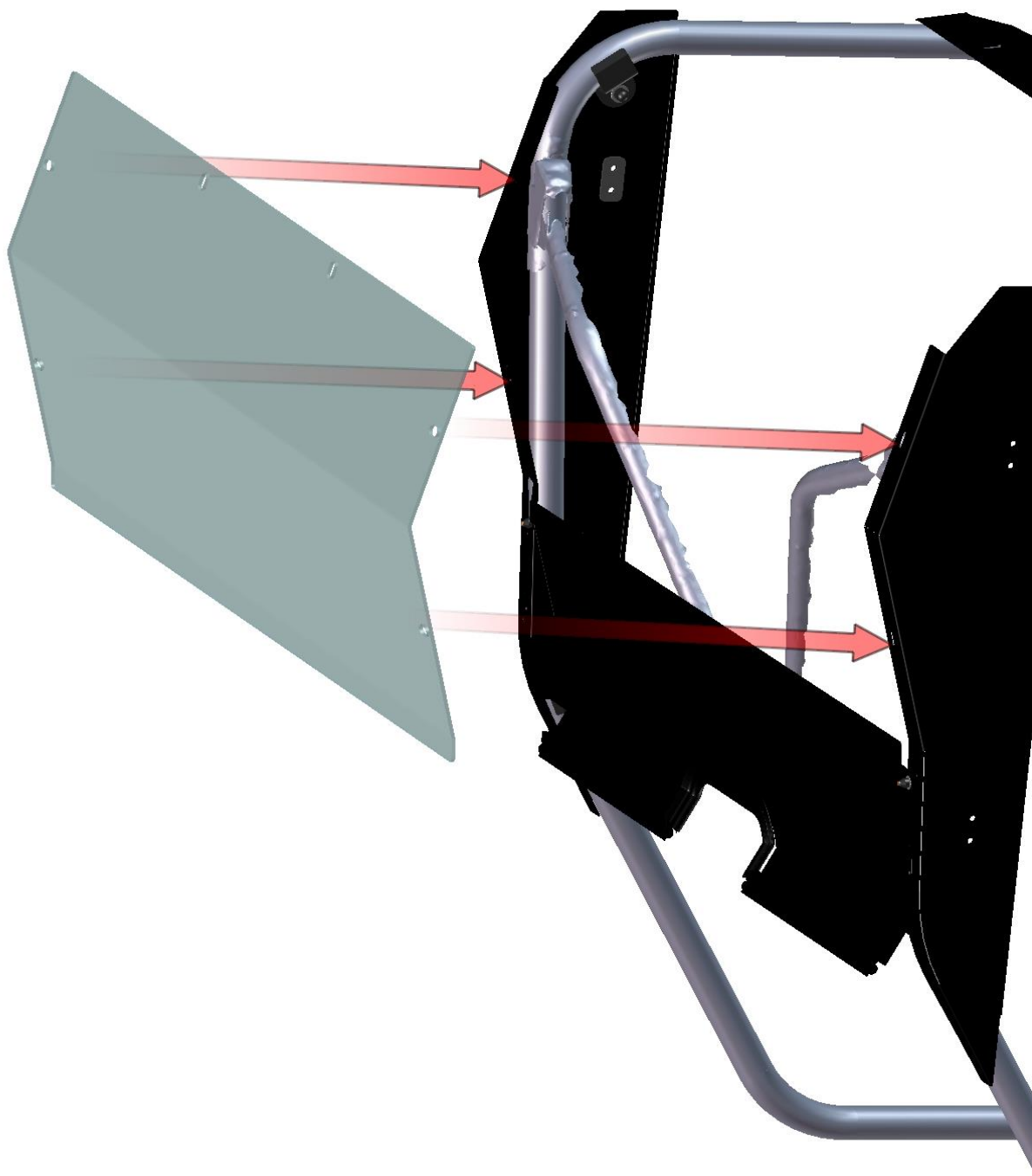

25



Fix the rear polycarbonate panel with door bases by screws, washers, nuts and nut covers.

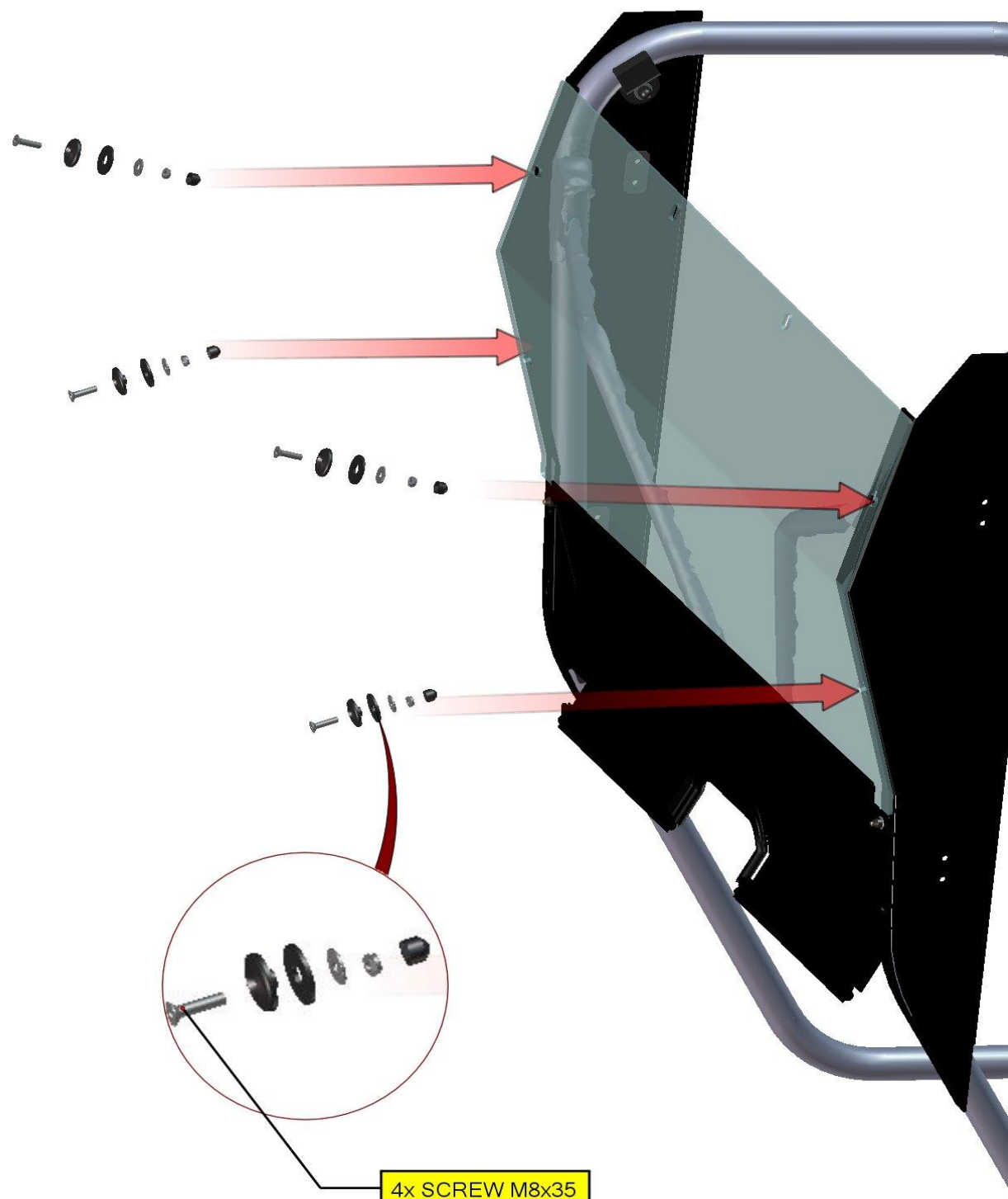



**ROOF**

Place the roof onto the roller cage and onto the front upper ledge.

You may have to allow the front upper holder's nut and adjust front window again.

If you need adjust the front ledge again, you have to take out the glass lock's pins (see page 13) and adjust glass lock assembly again.

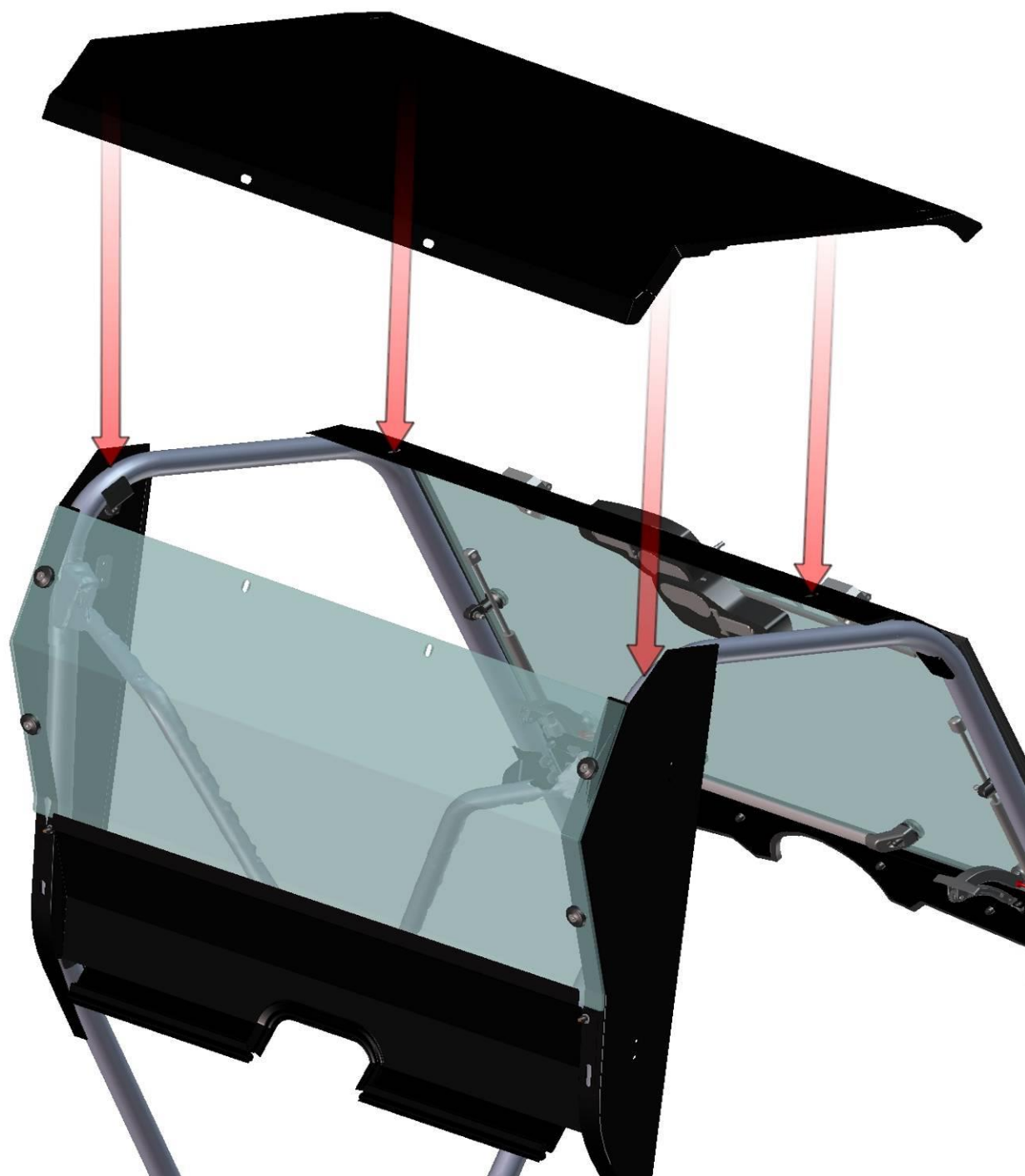

Place the roof holders to the roof from underside to fit with the welded screws.

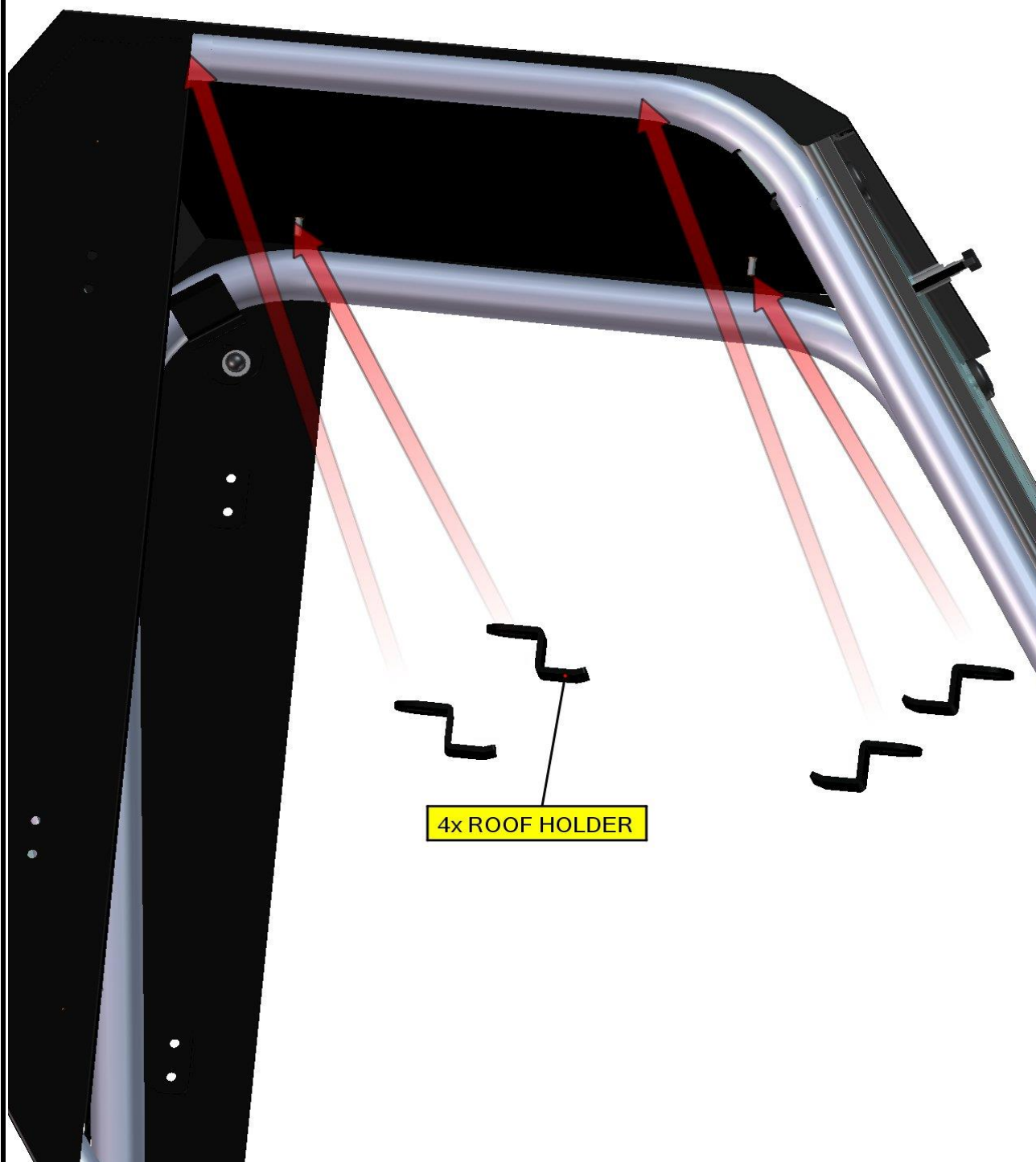

28

Fix the roof holders with the roof and with the front upper ledge to the roller cage by washers, nuts and nut covers.

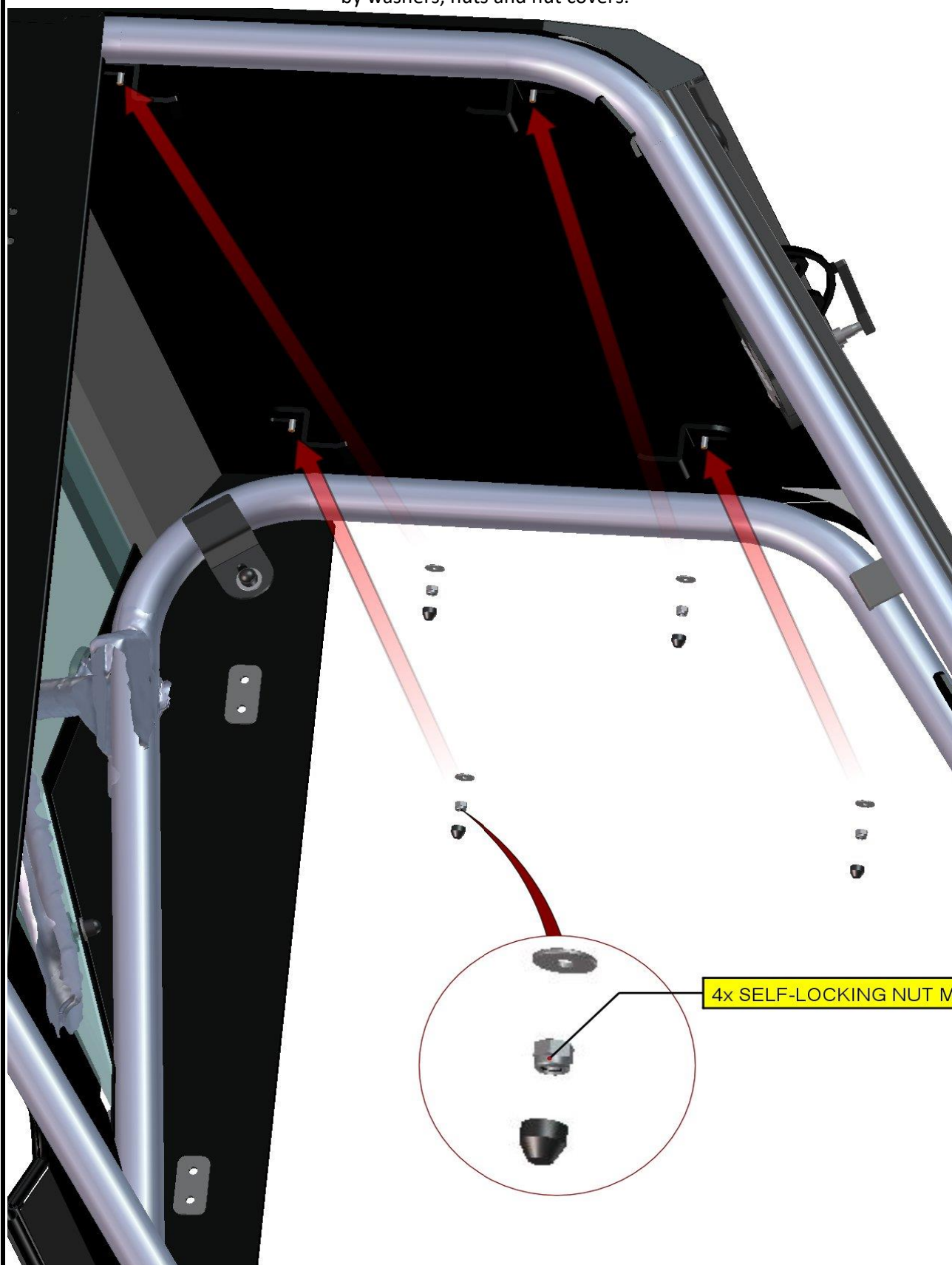

29

Connect the roof with the rear panel by screws, washers, nuts and nut covers.

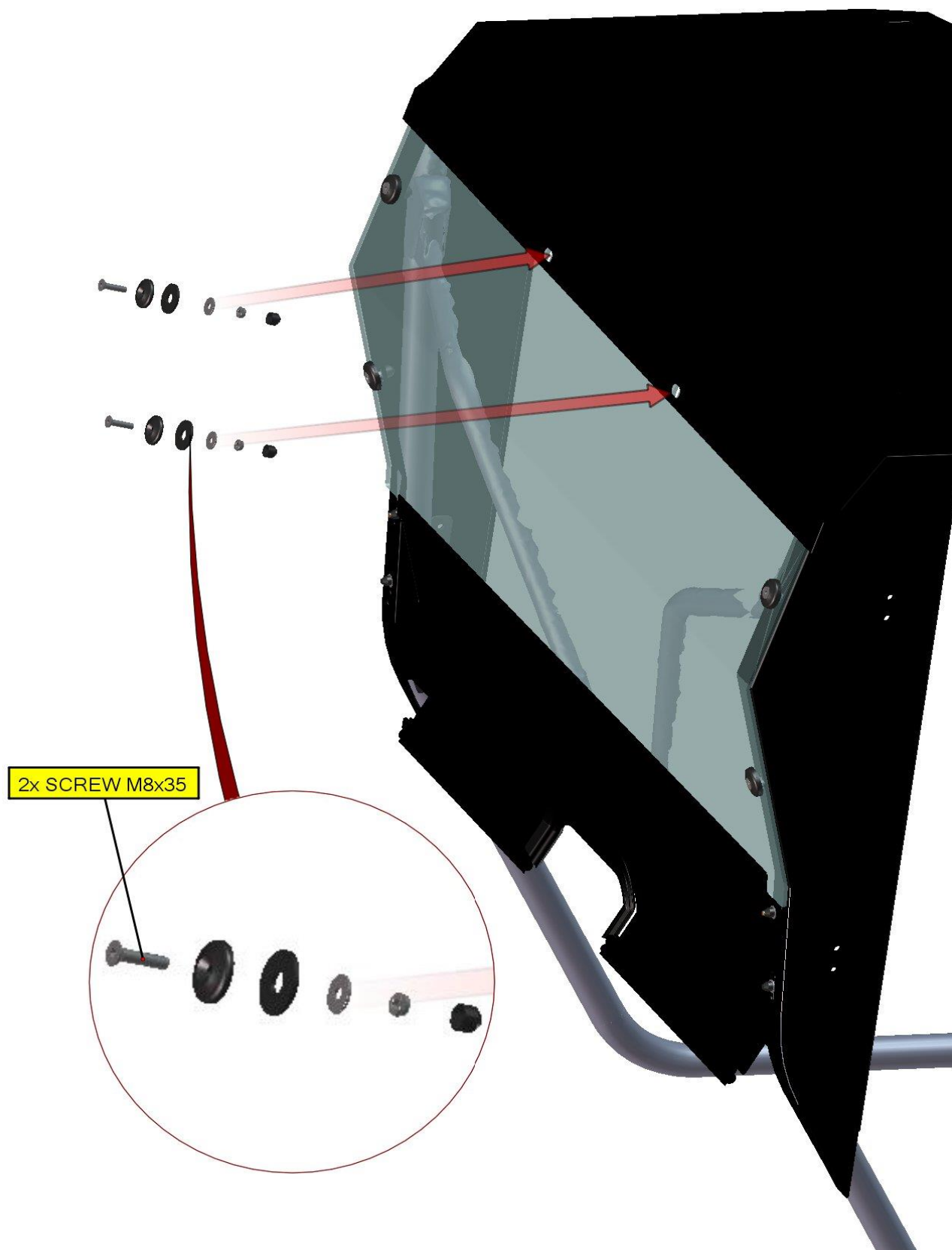

30

**LEFT AND RIGHT DOOR**

Place the hinges onto the door base.

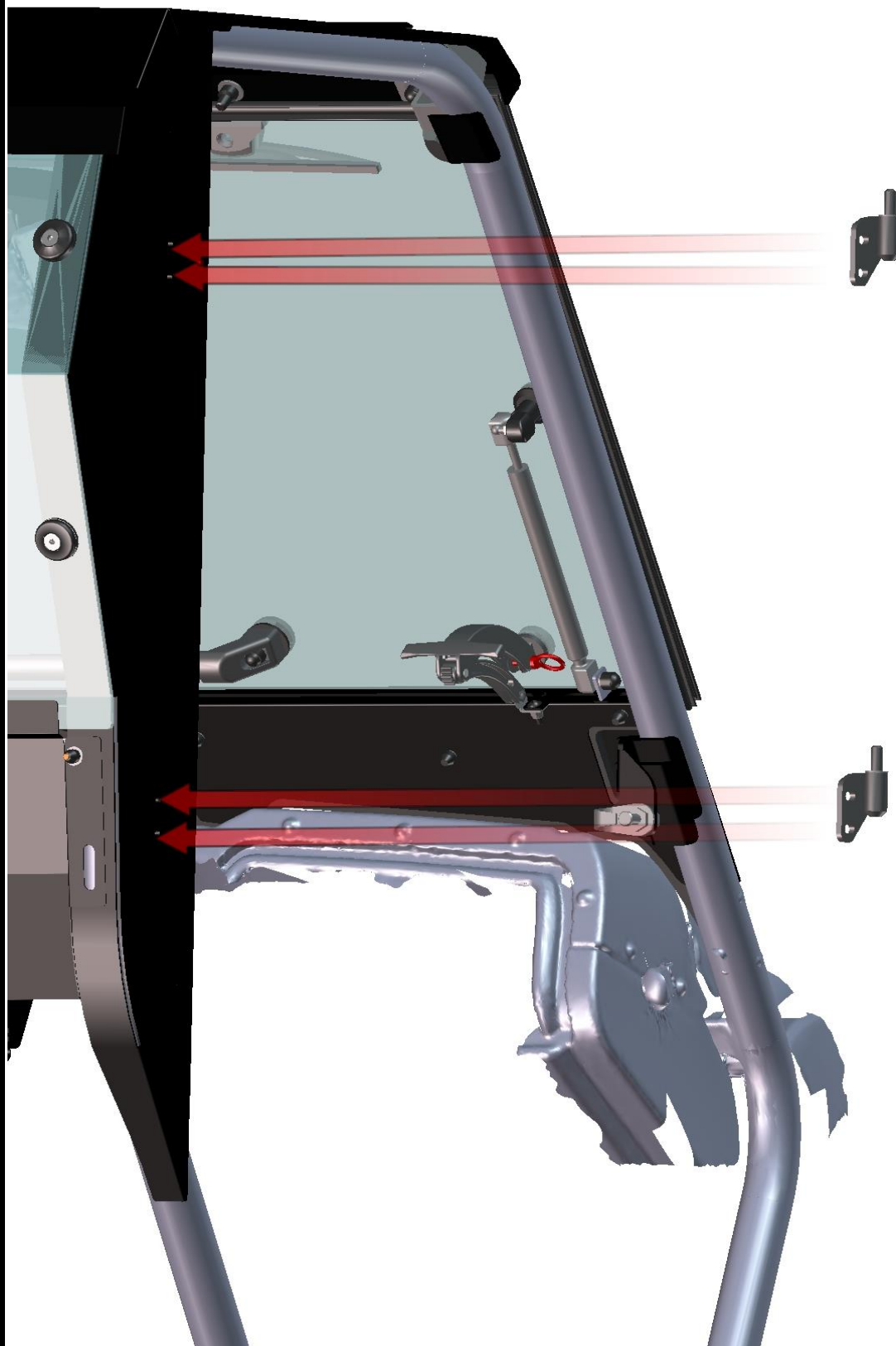



Fix the hinges with door base by screws, washers, nuts and nut covers.  
Do not tighten hard yet.

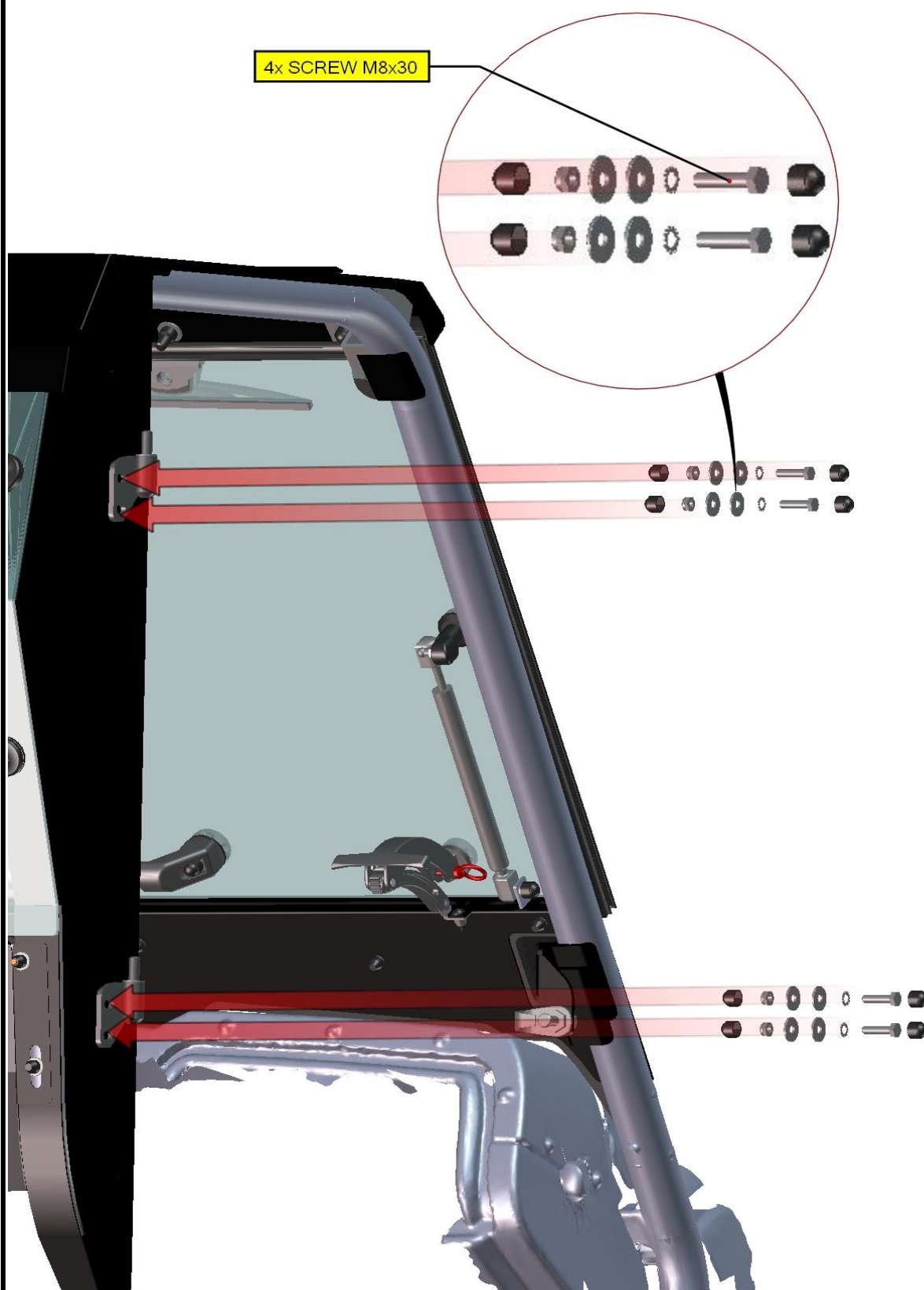



Place the door onto the hinges.

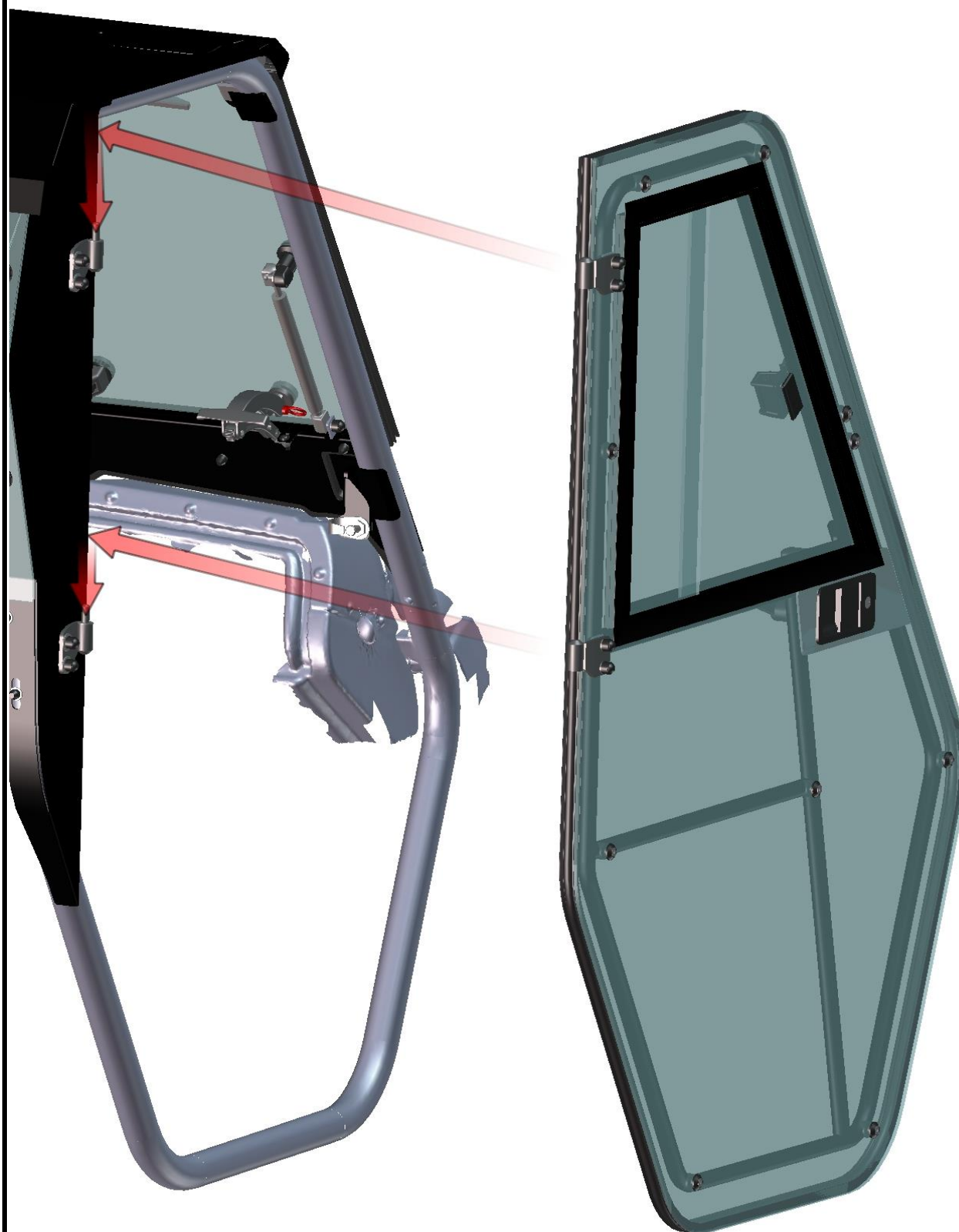

33

Adjust the door by the hinges to best position.

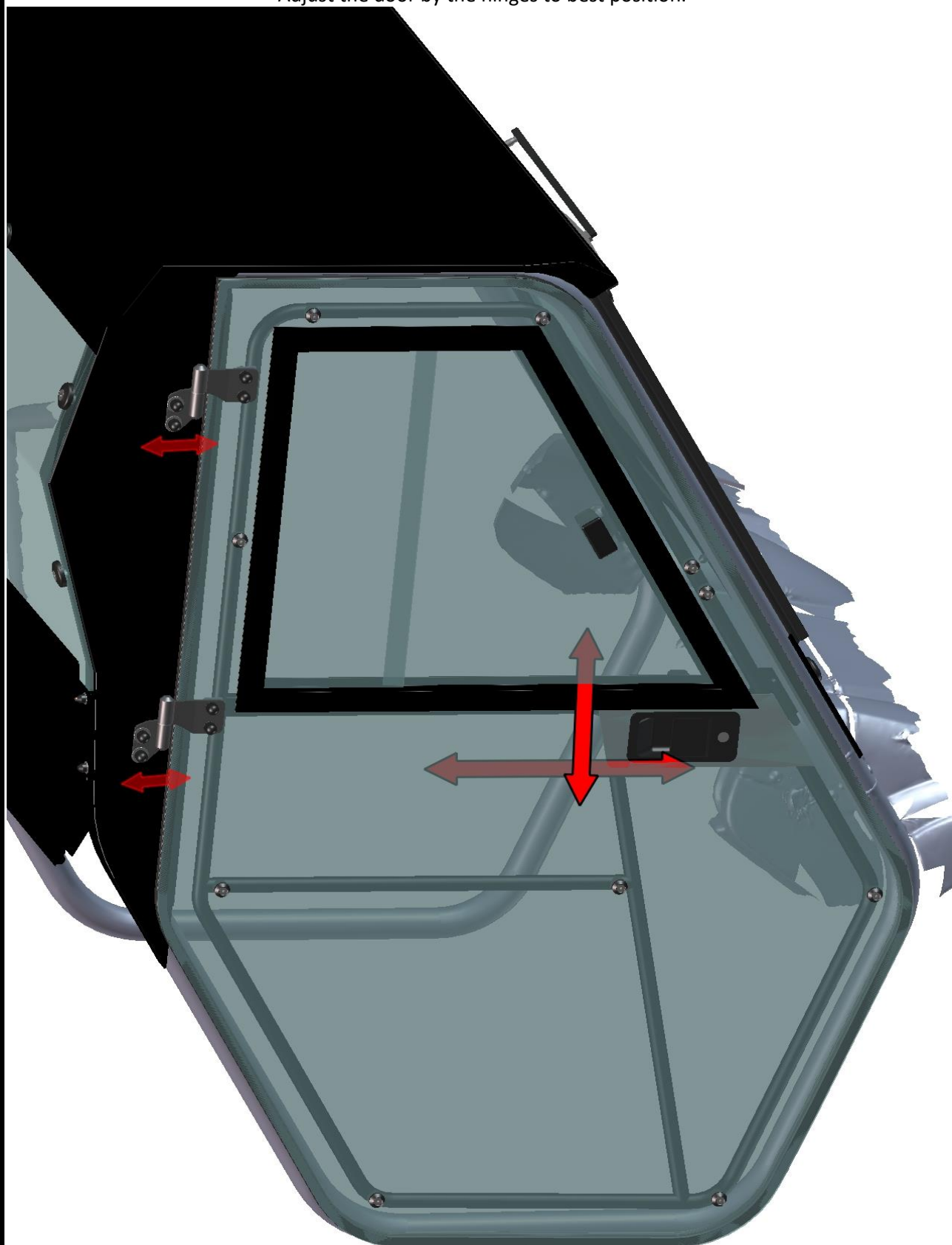

34

Allow the door stop holder nuts (in red circles) and insert the door stop pin into the inner door lock mechanism. Tighten nuts again. If you adjust door stop assembly correctly and close the door slowly, you can hear clear metallic click. If you have problems with adjusting door stop pin to best position, you can try adjust the door hinges to better position.

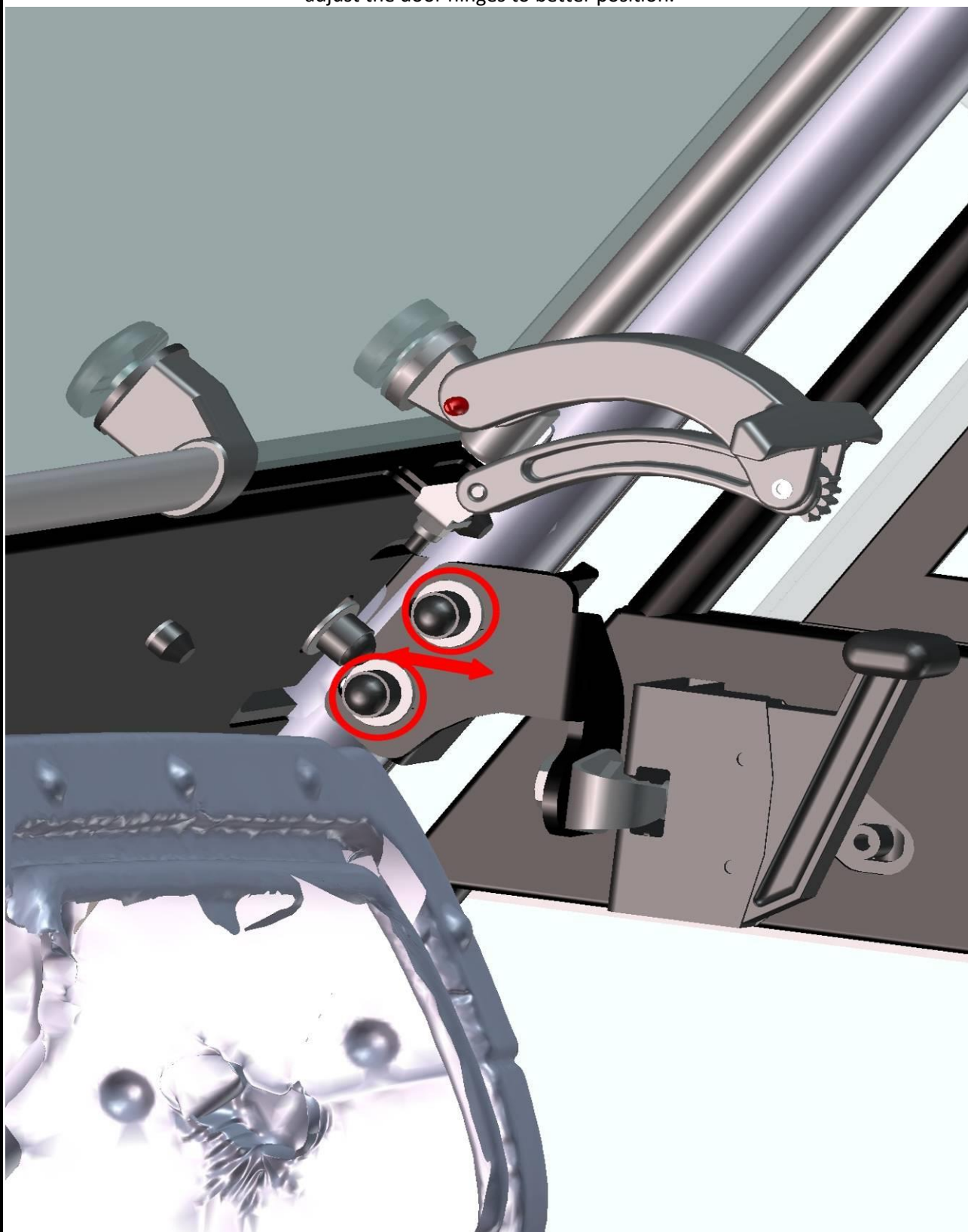

35

Uninstall the screws and washers from the polycarbonate door panel.

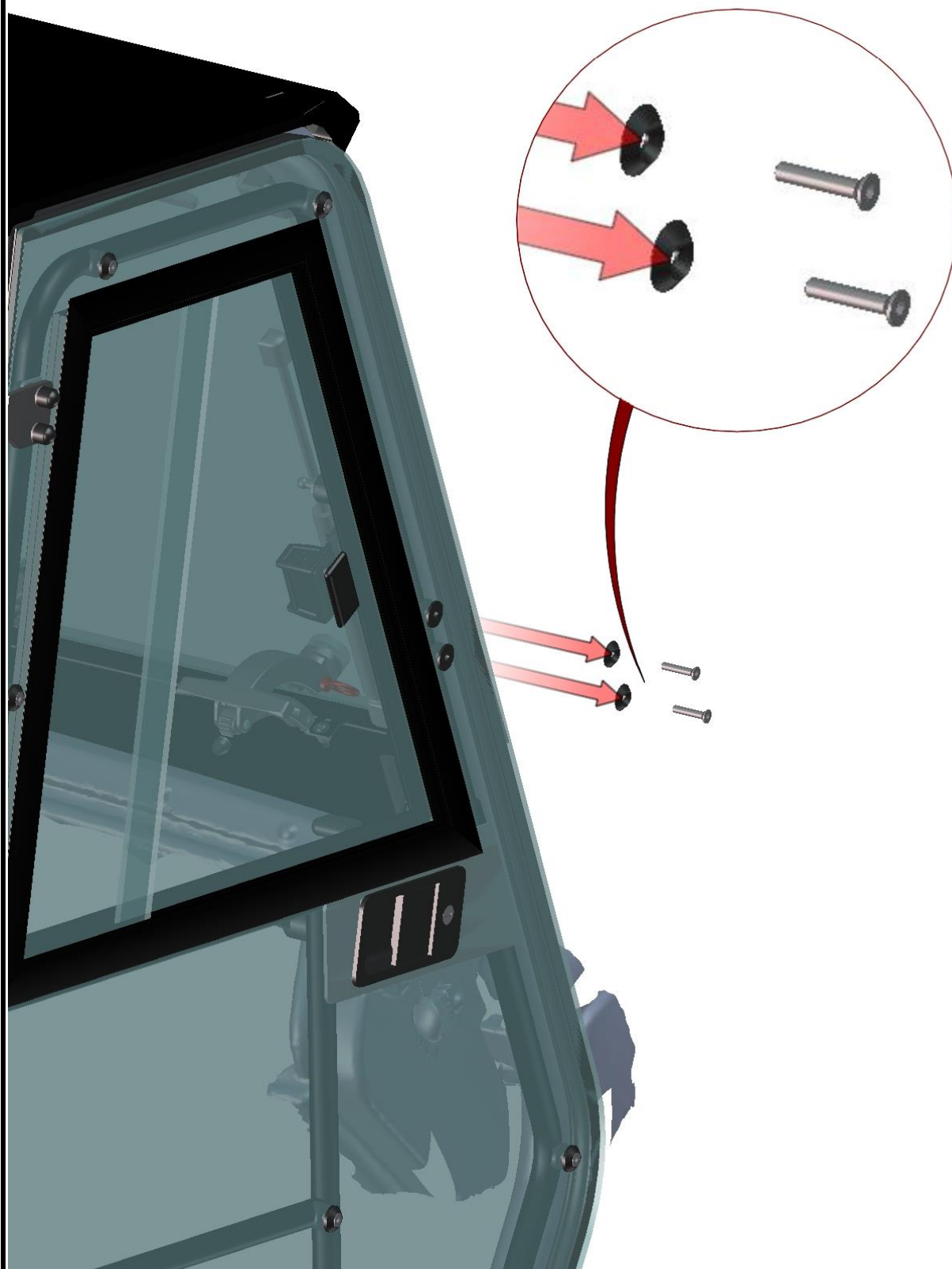



Place the rear mirror on correct position.

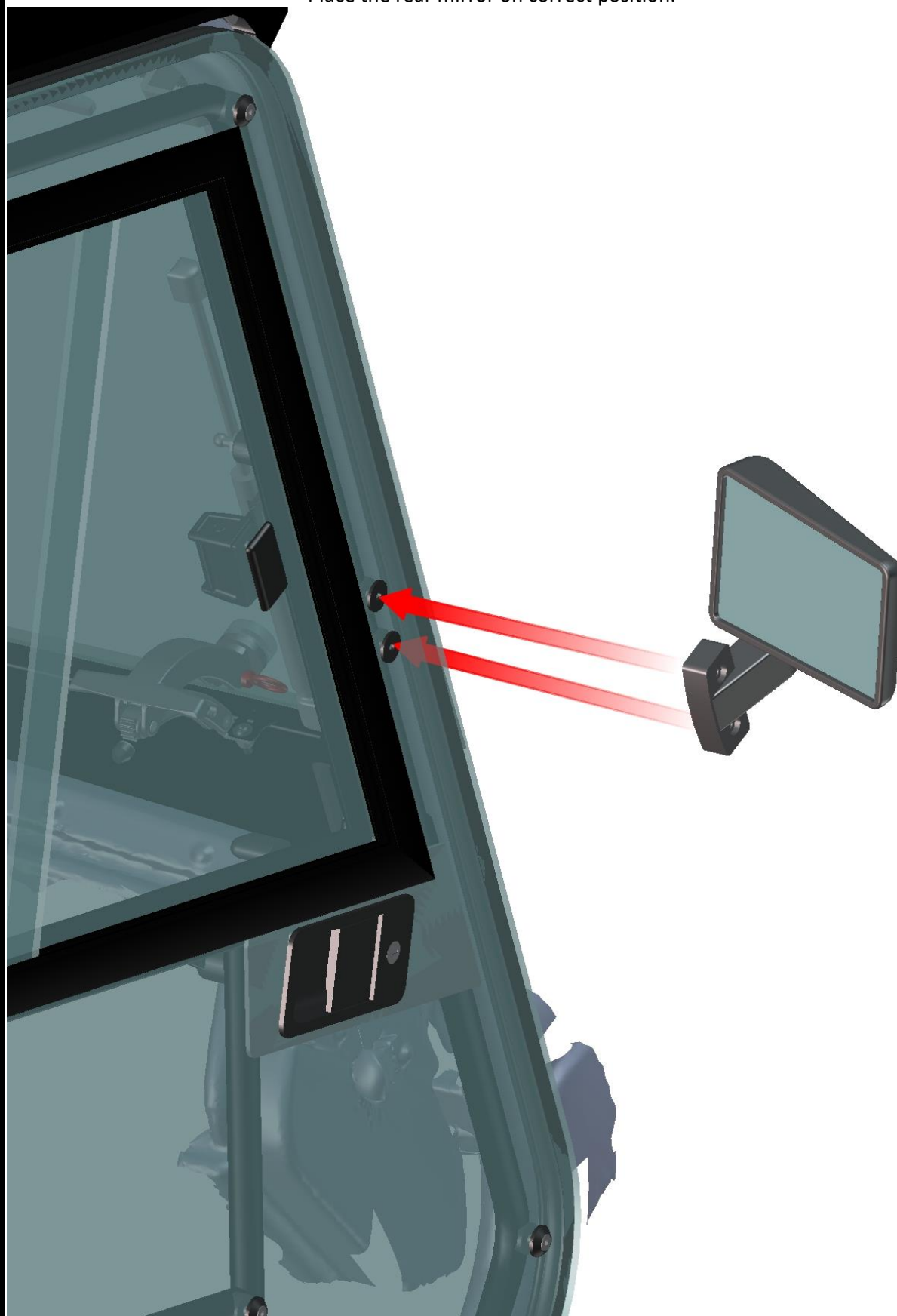

37



Fix the rear mirror with the door by screws and washers from page 35.

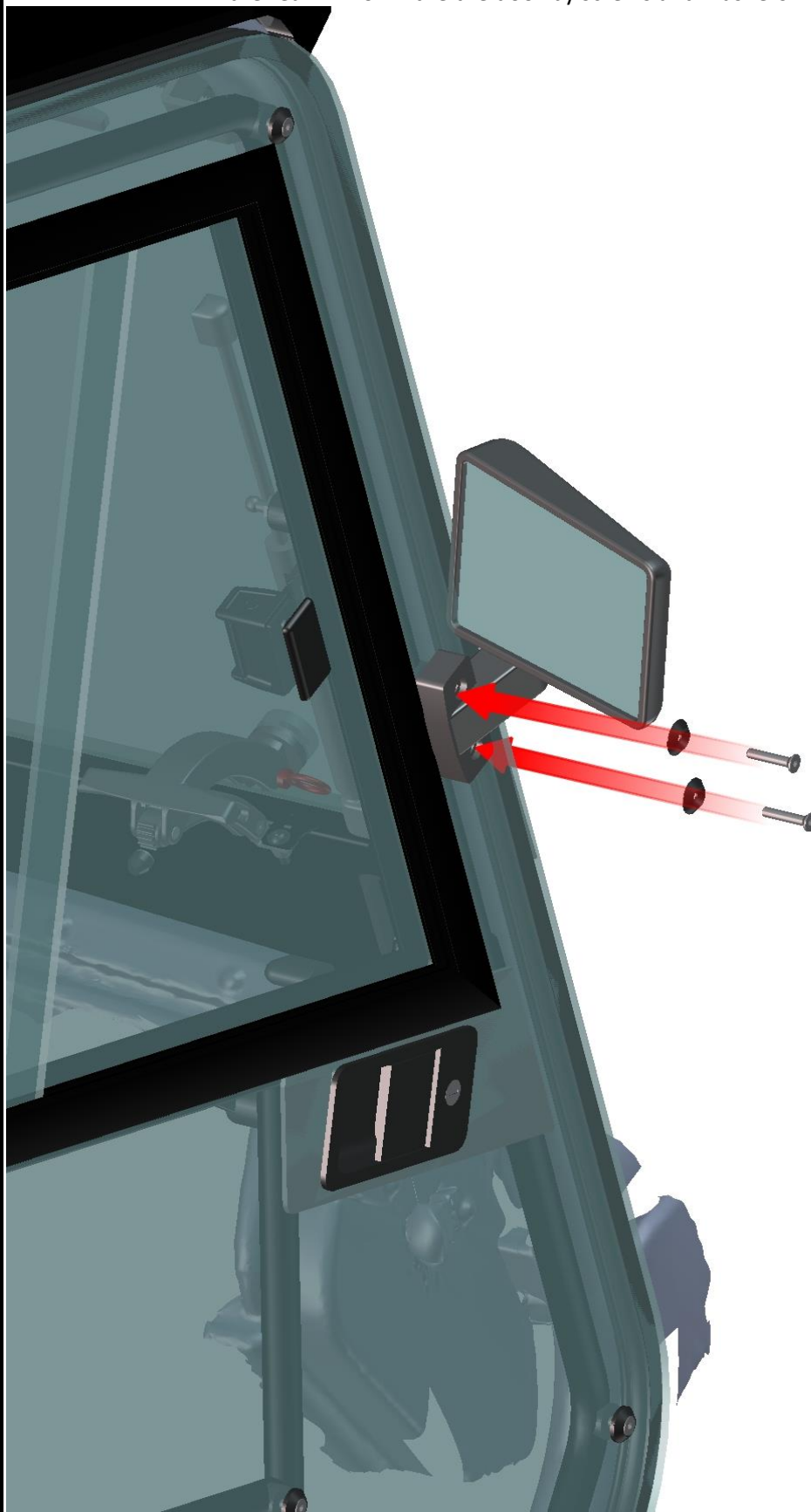

**INSTALLATION OF THE LEFT DOOR IS IDENTICAL WITH INSTALLATION OF THE RIGHT DOOR.**

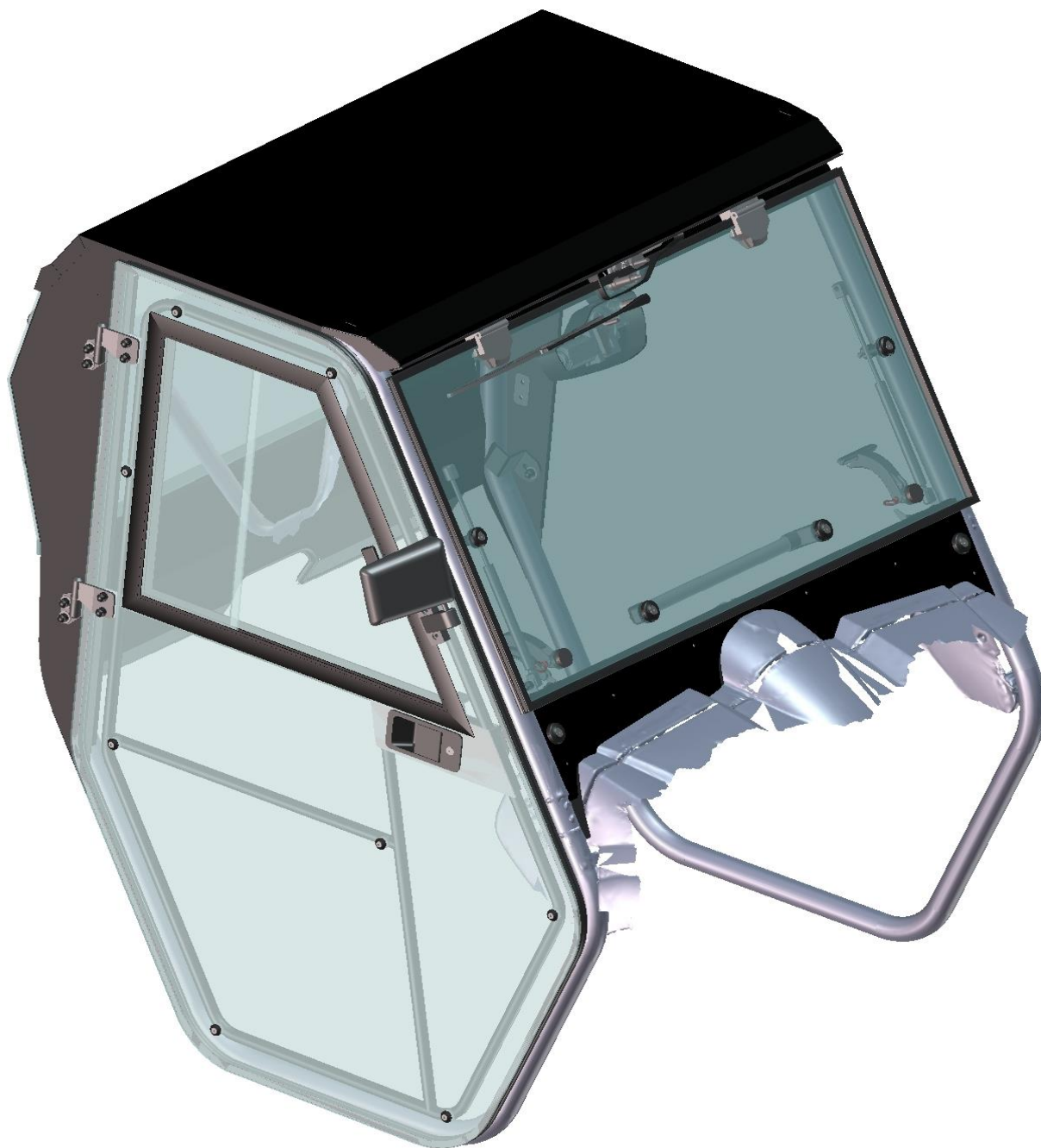

39

**ELECTROINSTALLATION – WASHER SYSTEM:**

Overall wiring diagram (wiper, washer, heating).

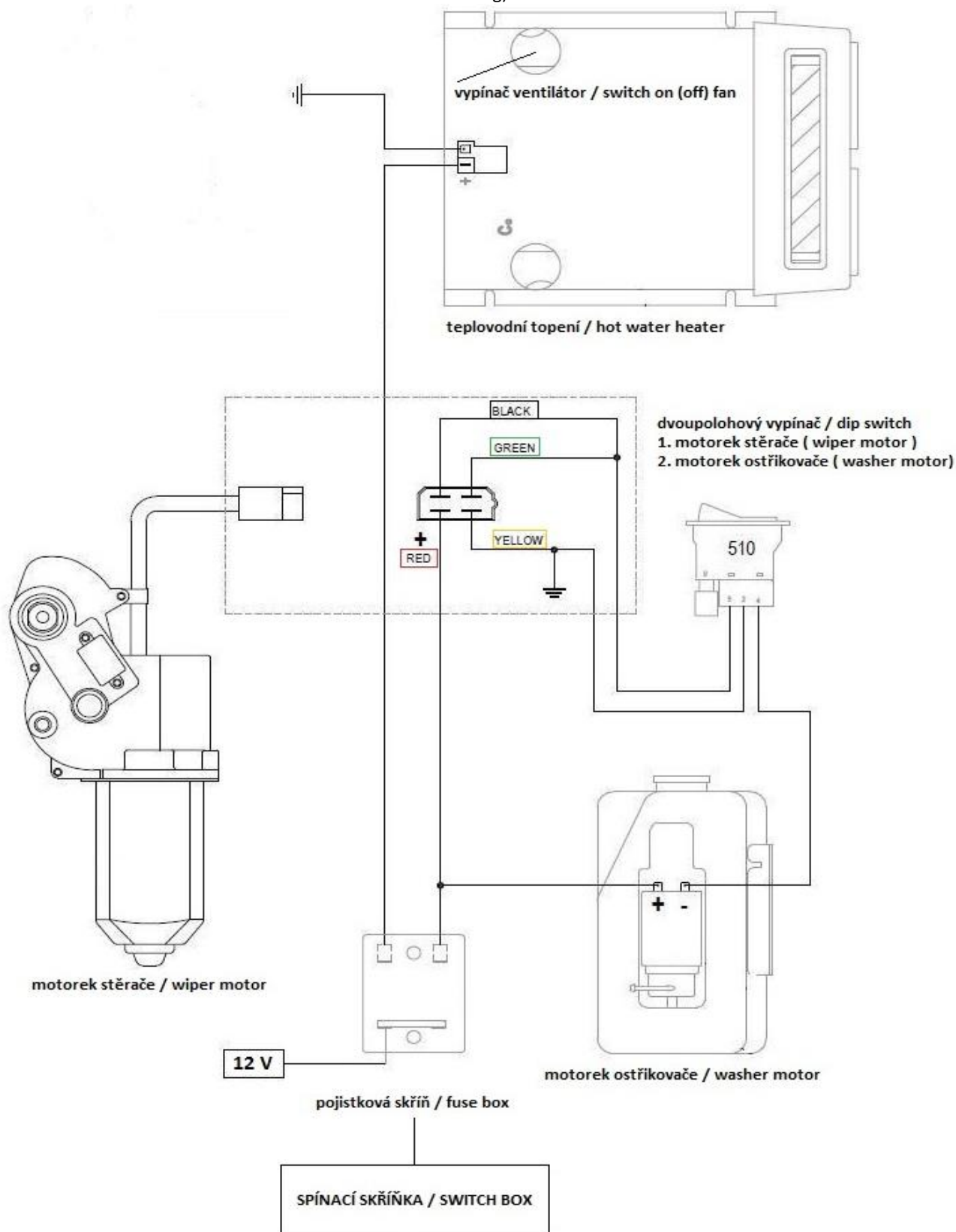

Accessories for mounting the bottle washer.

Washer tank (with pump)



Cable harness



Place the washer bottle holder onto the „U“ profile near the left front wheel and fix it (in red rectangle).



Place the washer bottle onto the holder.



Connect the harness branch no.:5 with washer pump. (See next picture.)  
Protect the connection against the water with scotch (not included).



Detail of connection.





Lead the section of harness under the dashboard (red line).

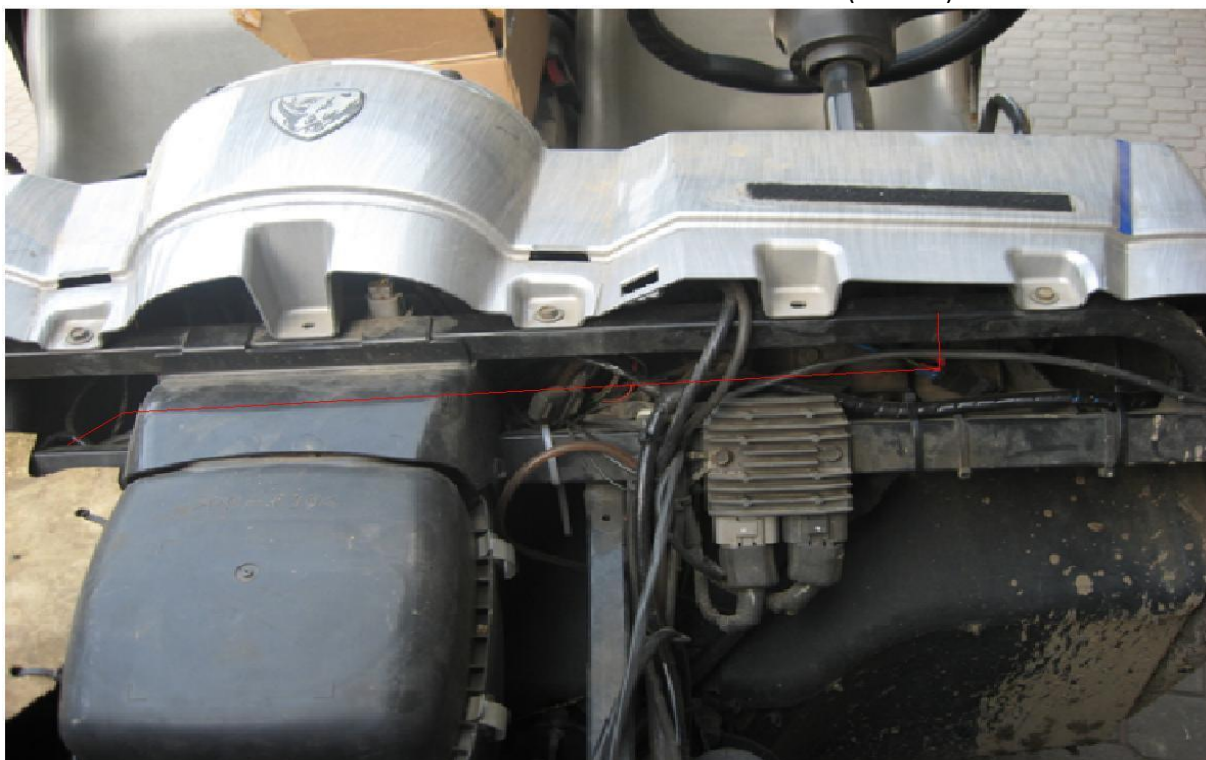

Wires to the switcher as shown on the next page.  
Make the hole for switch onto the dashboard near the steering-wheel.



Conect the harness branch no.: 2 with switch (detail of connection).

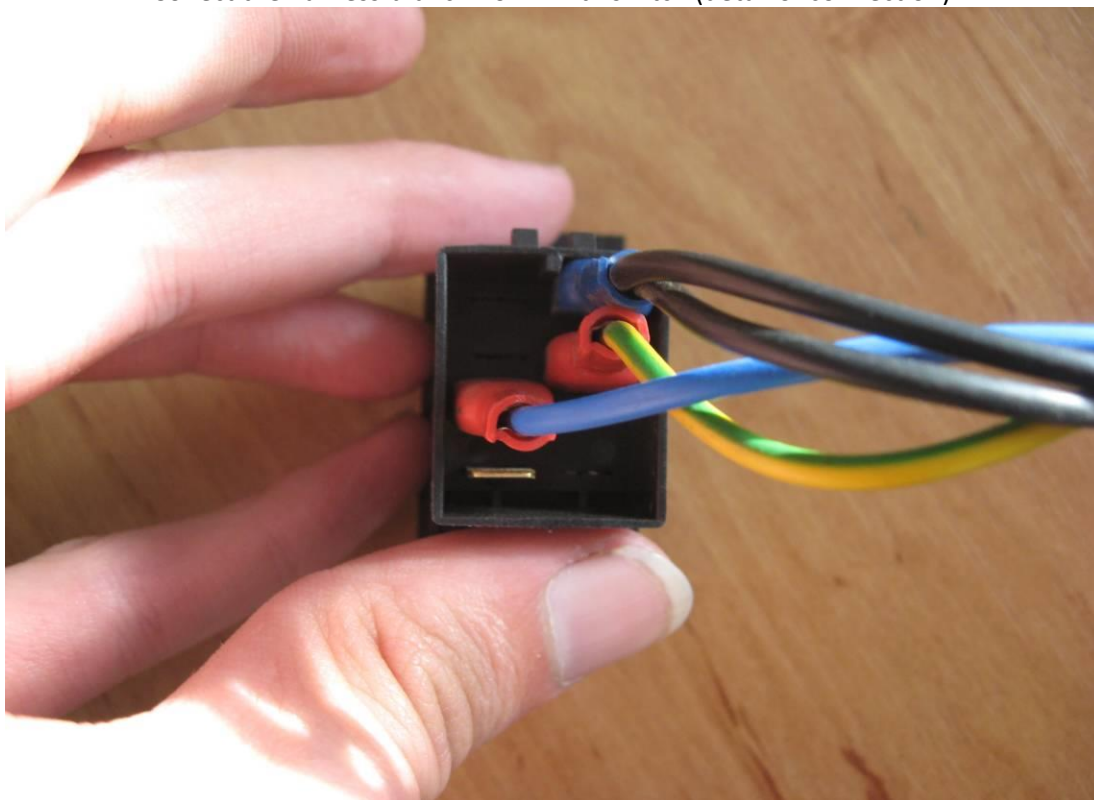

Insert the swith into the hole.  
Lead the part of harness under the dashboard and on the roller cage(red line).

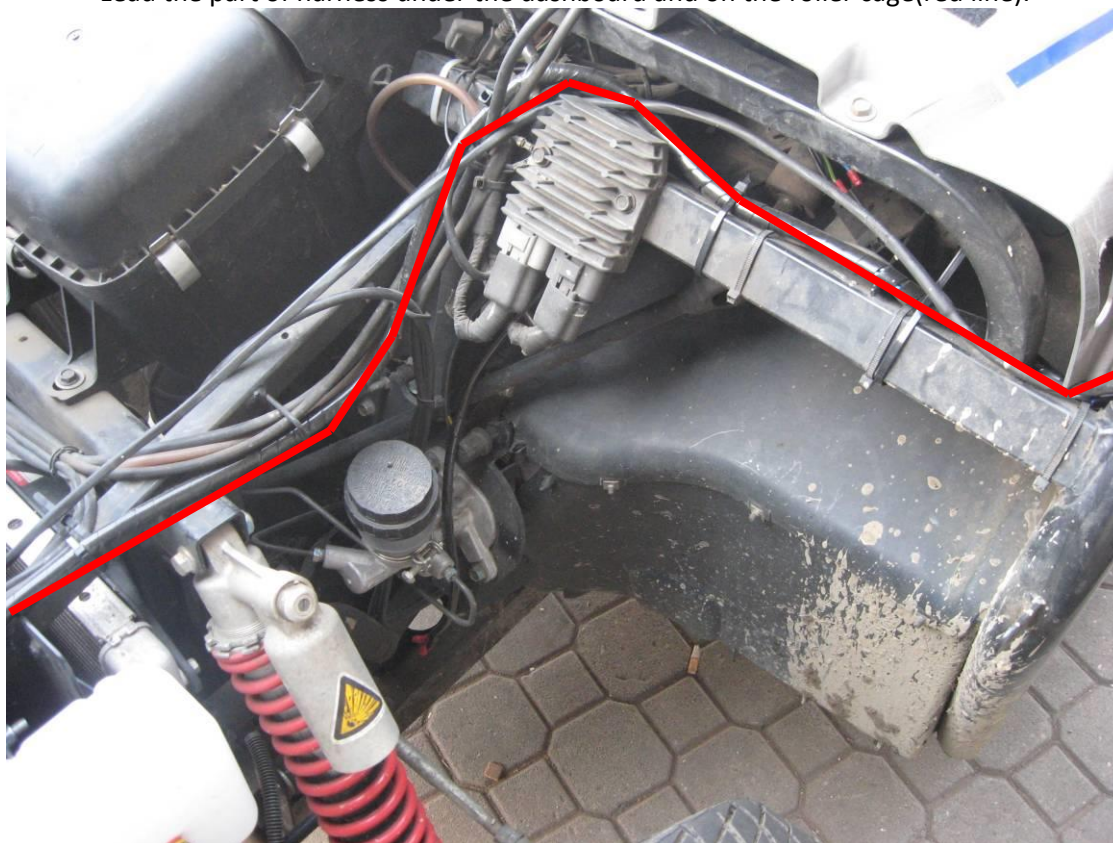



Detail on the left upper frot corner (red line).



Connect the harness branch no.: 1 with wiper motor (detail of connection).



Place the rubber inset into the hole on roof and fix it with nut (in red circle).



Connect the tubes with rubber inset on both sides(detail of the bushing tube connection).



Fill the water to the washer tank before starting usage.

**ELECTROINSTALLATION – HEATER SYSTEM:**

Accessories for mounting the heater system

heater



heater holder

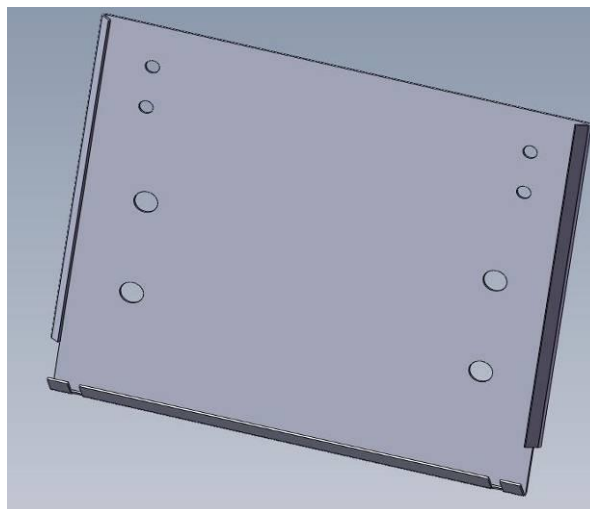

Y coupling

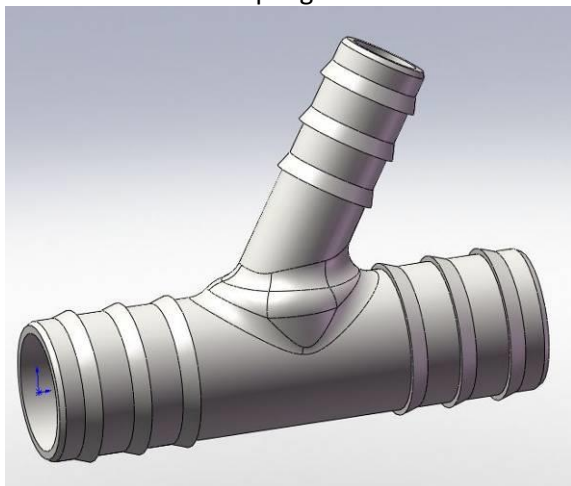

tightening strap



Position holder is heating up down at the floor in the middle of UTV's body.



Place the heater holder (in red rectangle) onto the panel under dashboard (cabin engine cover).  
Make 4 sign according to the holes (red circles) of the heater holder.

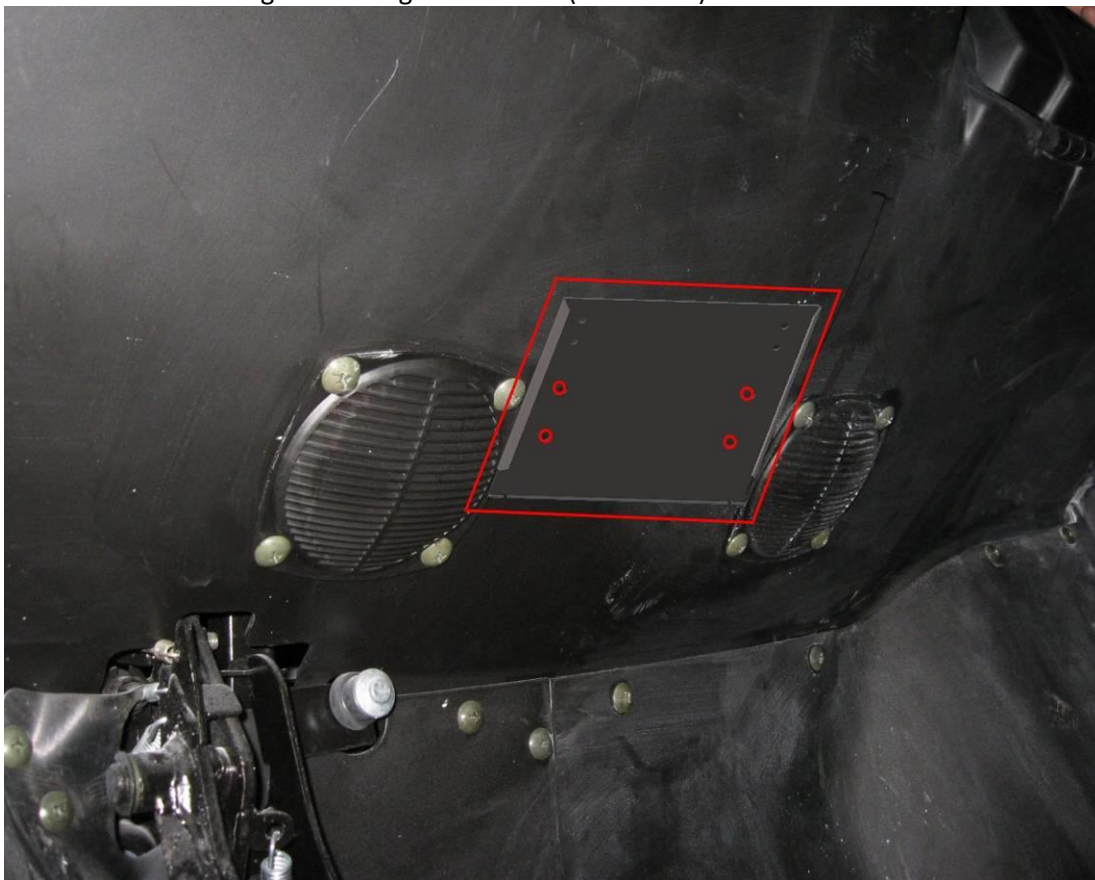

Take off the heater holder and drill 4holes  $\phi 8\text{mm}$  onto the panel under the dashboard (cabin engine cover).



Drill 1 hole  $\phi 15\text{mm}$  (in red circle) for harness 50mm left from the left holes for the heater holder.



Place the heater holder on position in cabin and place the heater holder ledges on the cabin engine cover from outside (the engine space).

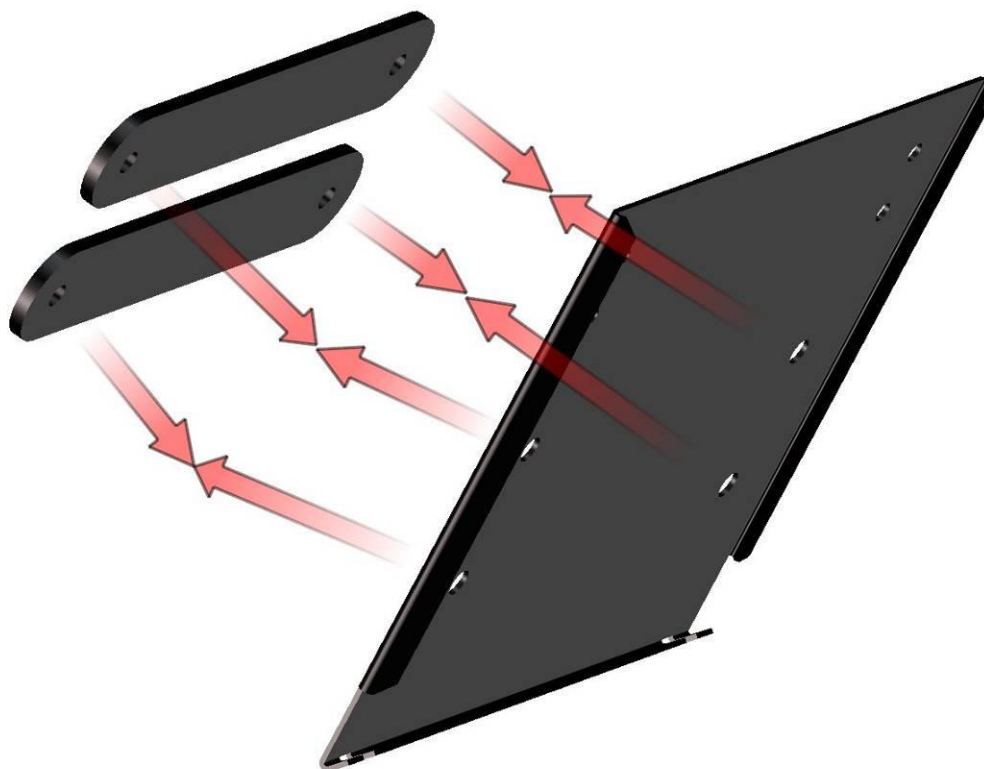

Fix the heater holder with the heater holder ledges to dashboard by screws, washers and self-locking nuts.

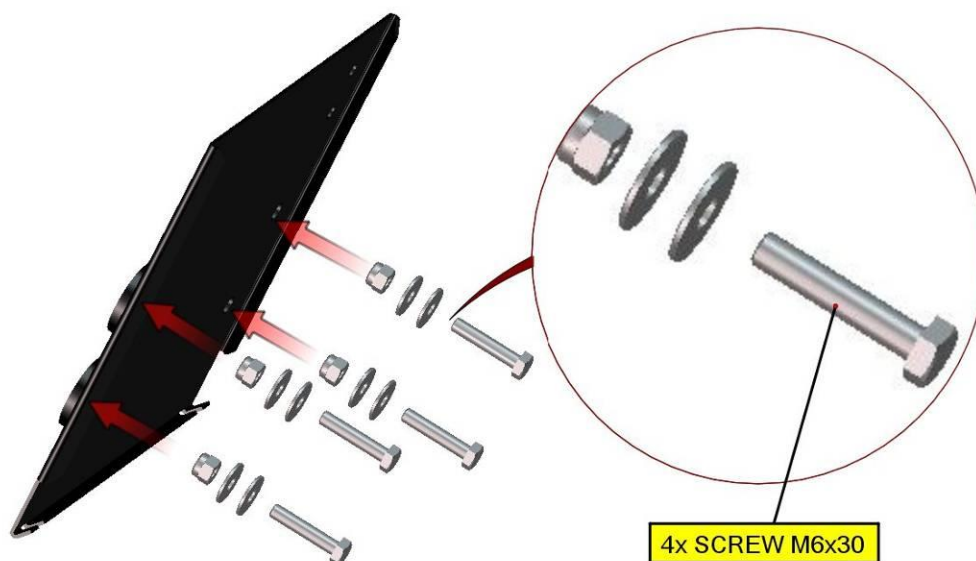

Connect the 2 hoses with heater and fix these with tightening strap.  
The heater body from behind.





Pull the branch no.: 3 through the hole  $\phi 15\text{mm}$  near the heater holder.  
Connect the branch no.: 3 with heater connector (detail of connection).



Insert the heater into the heater holder.



Connect the harness branch no.: 4+ and 4- with UTV's battery. (See next picture.)

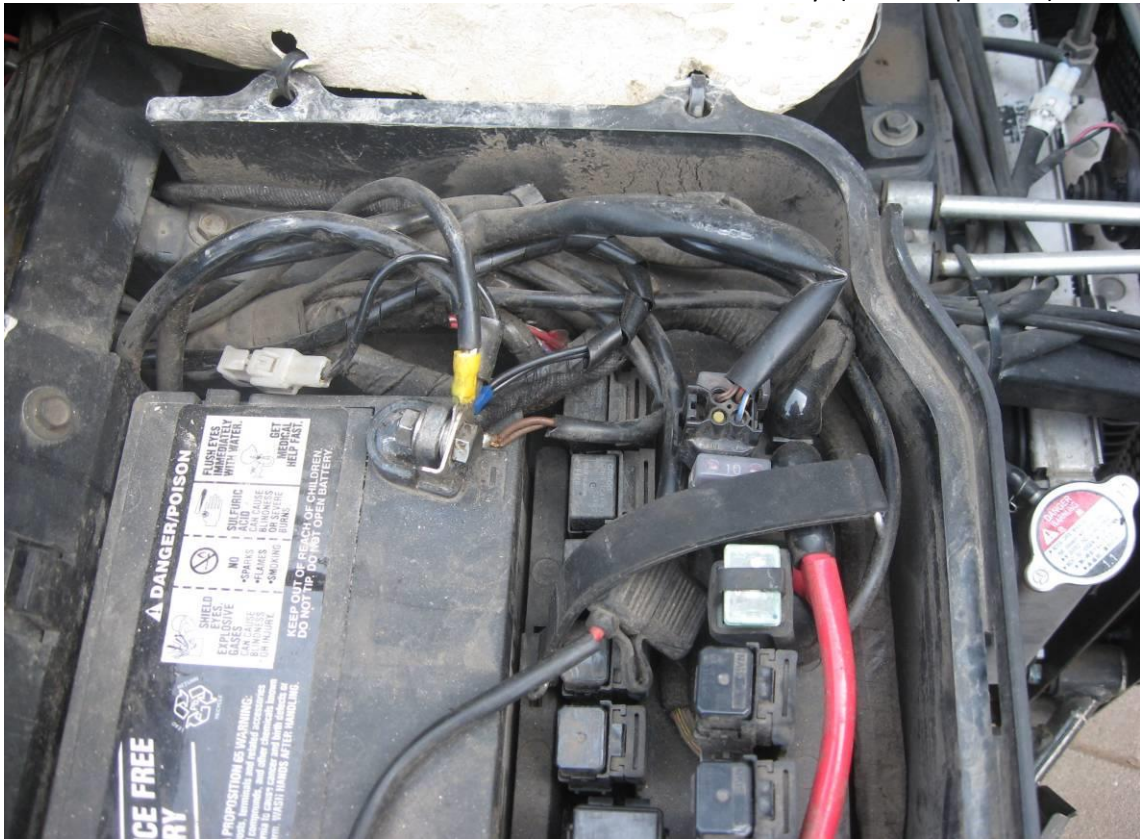

Uninstall the floor cover. Drill 2 holes  $\phi 25\text{mm}$  into the roof below the heater (in red circle).





Pull the hoses trough the holes and place the floor cover back.



Principle involved:

Hot water heating system connected to the primary (short) circuit of the cooling system.  
Cut the cooling system hoses and attach the "T" insets to connect the heater hoses and fix with straps.  
View to front right part of engin.

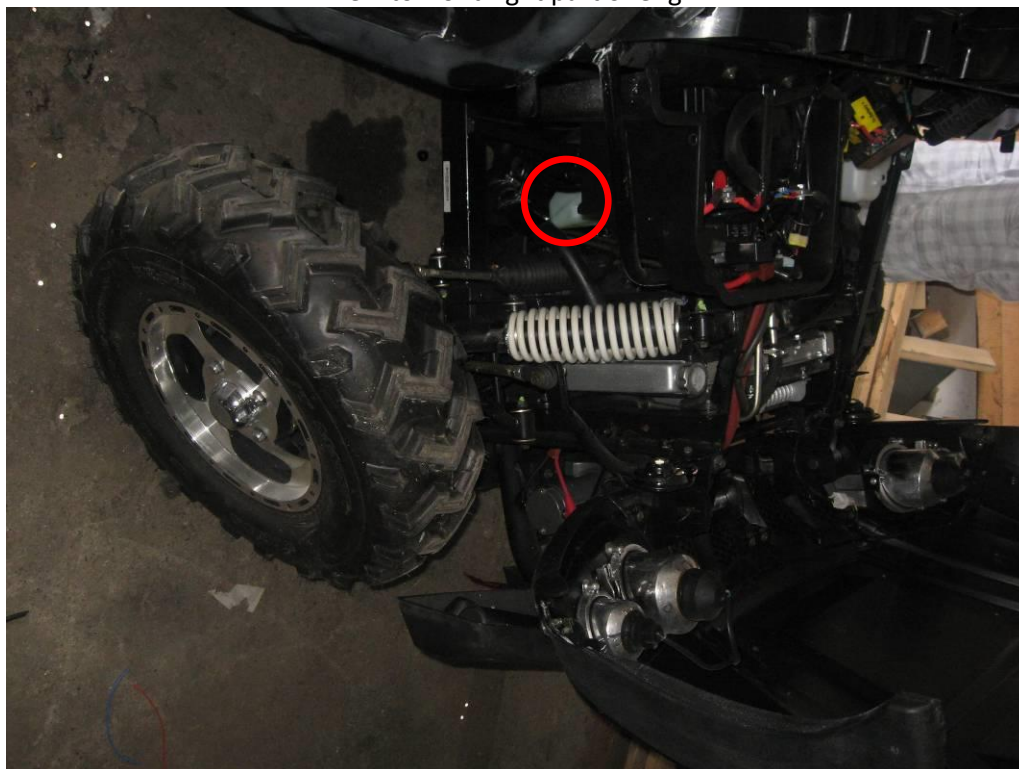

Detail of connection



**Important notice:**

1. Before the first turning on the hot water heater it is necessary to check the tightness of the cooling circuit of the hot water heater.
2. Insert more cooling liquid to the cooling circuit.
3. Turn heater on and wait for the maximum temperature. Turn off and insert cooling liquid to the cooling circuit.

In cab units where you are installing the glove compartment heater provided in the standard DFK Cab Kit, it is important to check the coolant level regularly at least 4-5 times during the first several days of operation and fill as necessary until the coolant level has stabilized.

The heater will draw and retain coolant, sometimes at the expense of coolant to the engine.

This can cause engine overheating if not managed properly.