

HardCabs

A DFK AMERICA COMPANY

INSTALLATION INSTRUCTIONS

HISUN

Sector 550-750



SAFETY INSTRUCTIONS

Warning: Failure to heed all safety and operating instructions and warnings regarding use of this product can result in serious bodily injury.

READ PROPERLY COMPLETE ASSEMBLY INSTRUCTIONS BEFORE STARTING OF ASSEMBLY

Install all parts indicated in assembly instructions. Failure to fully assemble product before use could result in personal injury.

Assembly of product requires use of hand or power tools. If you are not experienced in using these types of tools, have product dealer do the install for you.

Some parts contain sharp edges, wear protective gloves if necessary.

Always keep your assembly area clean, uncluttered and well lit.

Keep visitors and children a safe distance away from the assembly area. Visitors should wear the same safety equipment described under.

Never operate your UTV with the cab doors open. Failure to properly latch the doors before moving the vehicle could result in serious injury.

Dress for safety. DO NOT wear loose clothing, gloves, neckties or jewelry if using power tools to assemble this product.

Insert all nut covers after you finish installation.

Never drive your UTV with the cab front window in open position. Failure to properly latch/lock front window before driving the vehicle could result in serious injury.

Please be careful not to break the plastic washers, if you're tightening screws with plastic washers use max torque of 3.7 foot-pound force (5 Nm)!!!

WARNING: For safety purposes, if the DFK Cab doors are removed, it is mandatory that the OEM manufactured Half Doors or Nets are **REINSTALLED** before operating the vehicle.

MAINTENANCE AND CLEANING

To clean polycarbonate surface use soapy water solution or other subtle means.

Dirt and dust wash by gently water stream and swipe only with wet or damp means in the direction from top to bottom.

The recommended frequency of cleaning of polycarbonate part is about 1 time per month or according to the actual degree of pollution.

*Do not use detergents that could scratch the surface plates.
(abrasives, harsh fabrics, etc.)*

*Do not use solvents or alkaline detergents or cleaners with ammonia
(ammonium hydroxide).*

Do not remove the impurities from the surface of the razor blades or other sharp items.

Do not clean cab when the polycarbonate plates are heated by the sun.

Do not use the squeegee, it could be scratched surface plates.

Do not clean the water current strength greater than 50 bar (WAP)

The manufacturer is not responsible for scratching the surface in case of failure to comply with the above instructions.

All bolted connections of cab must be by user at regular intervals checked and tightened.

PREPARATION FOR INSTALLATION:

Uninstall all additional systems from the roller cages (work lights, rear mirrors, drink holders etc.)

[CAB PREVIEW](#)



4

REAR PANEL

Loosen the original bolts from UTV roller cage on both sides. DON'T remove the bolts.

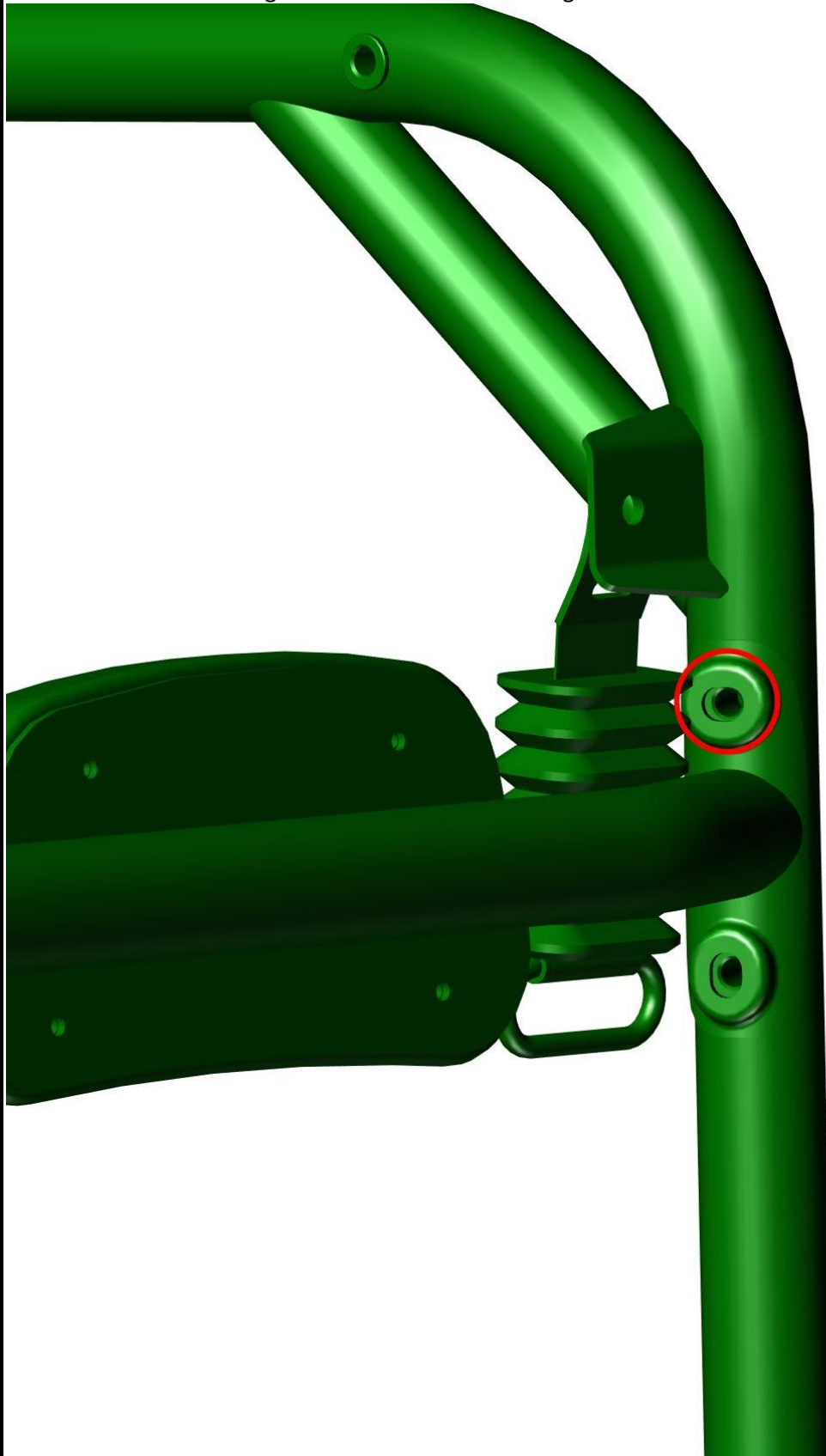

Align the rear panel into correct position.

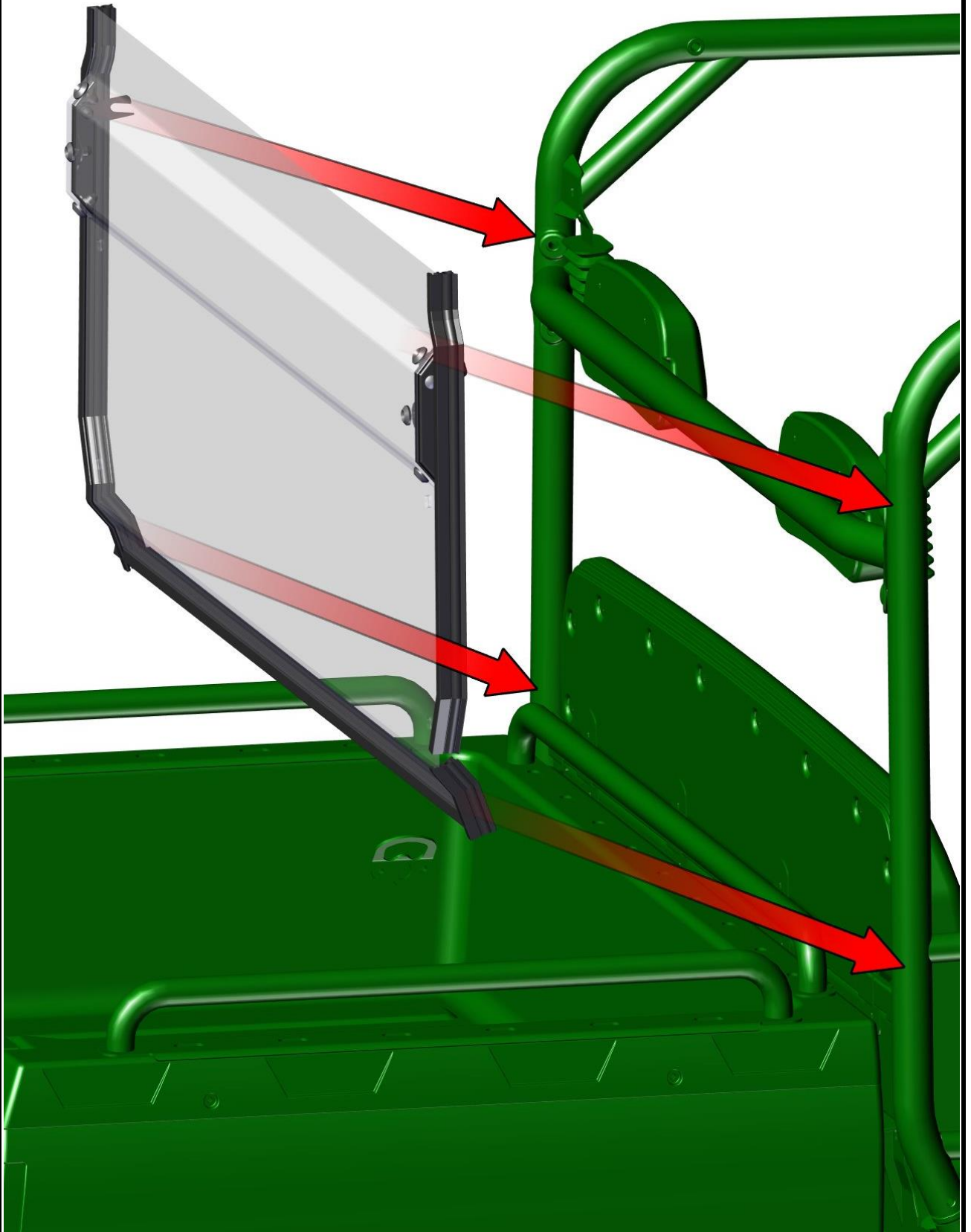

Place the rear panel side holder onto the rear panel and fix with included fixing assemblies on both sides.

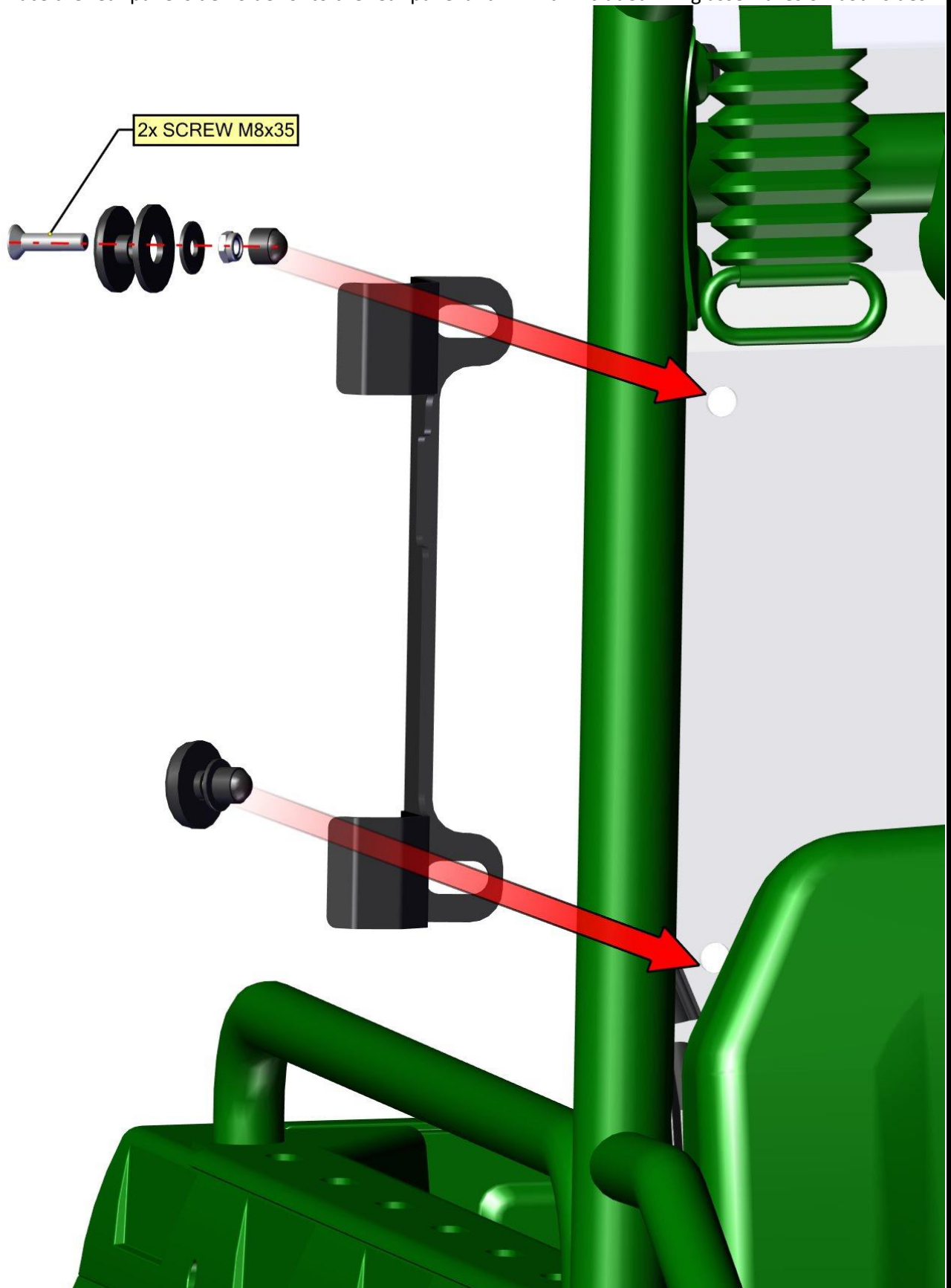

Mount the rear panel to the UTV roller cage with original screws from page 5 on both sides.

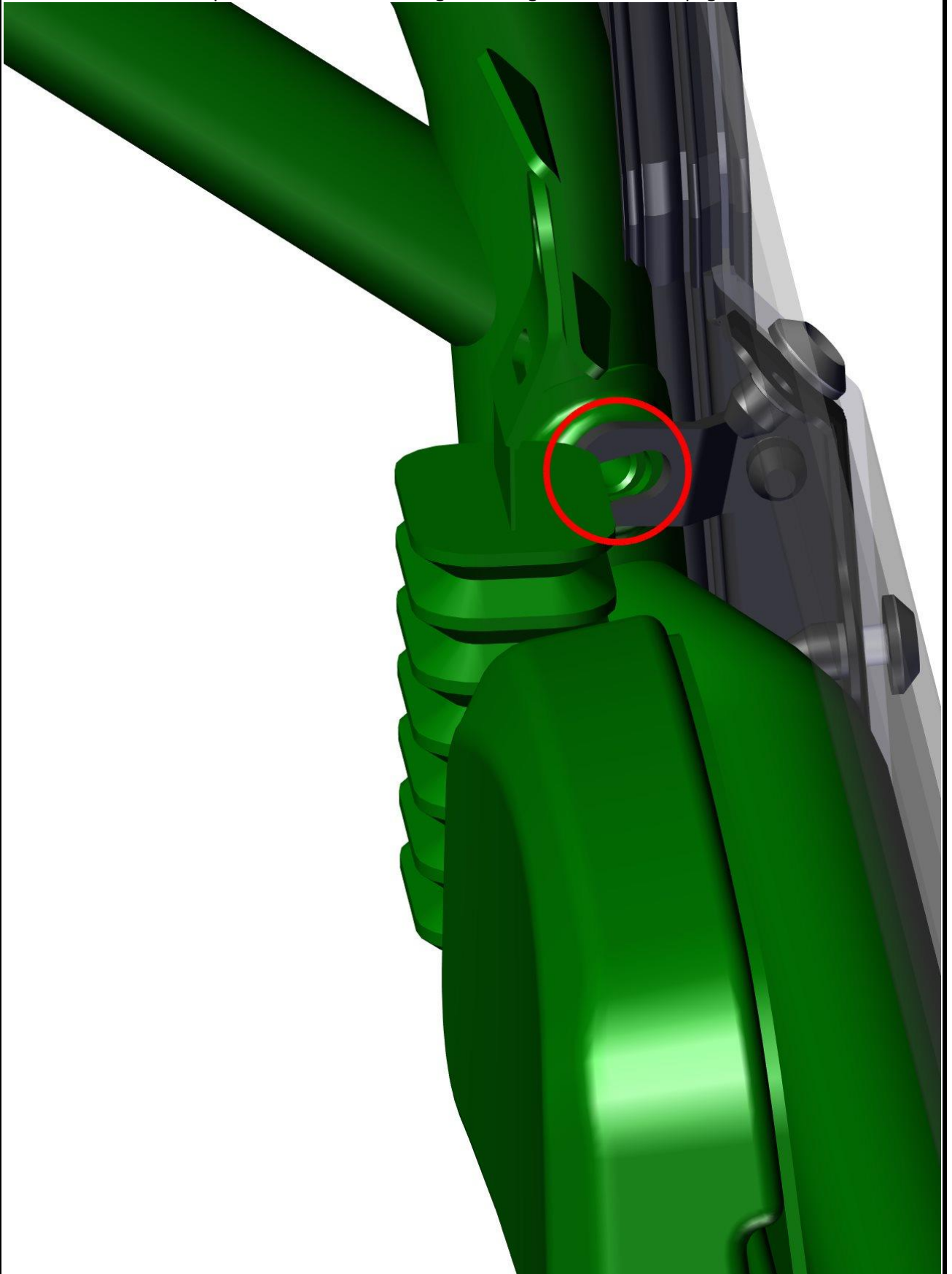

FRONT PANEL

Uninstall original screws from UTV roller cage (red circles).

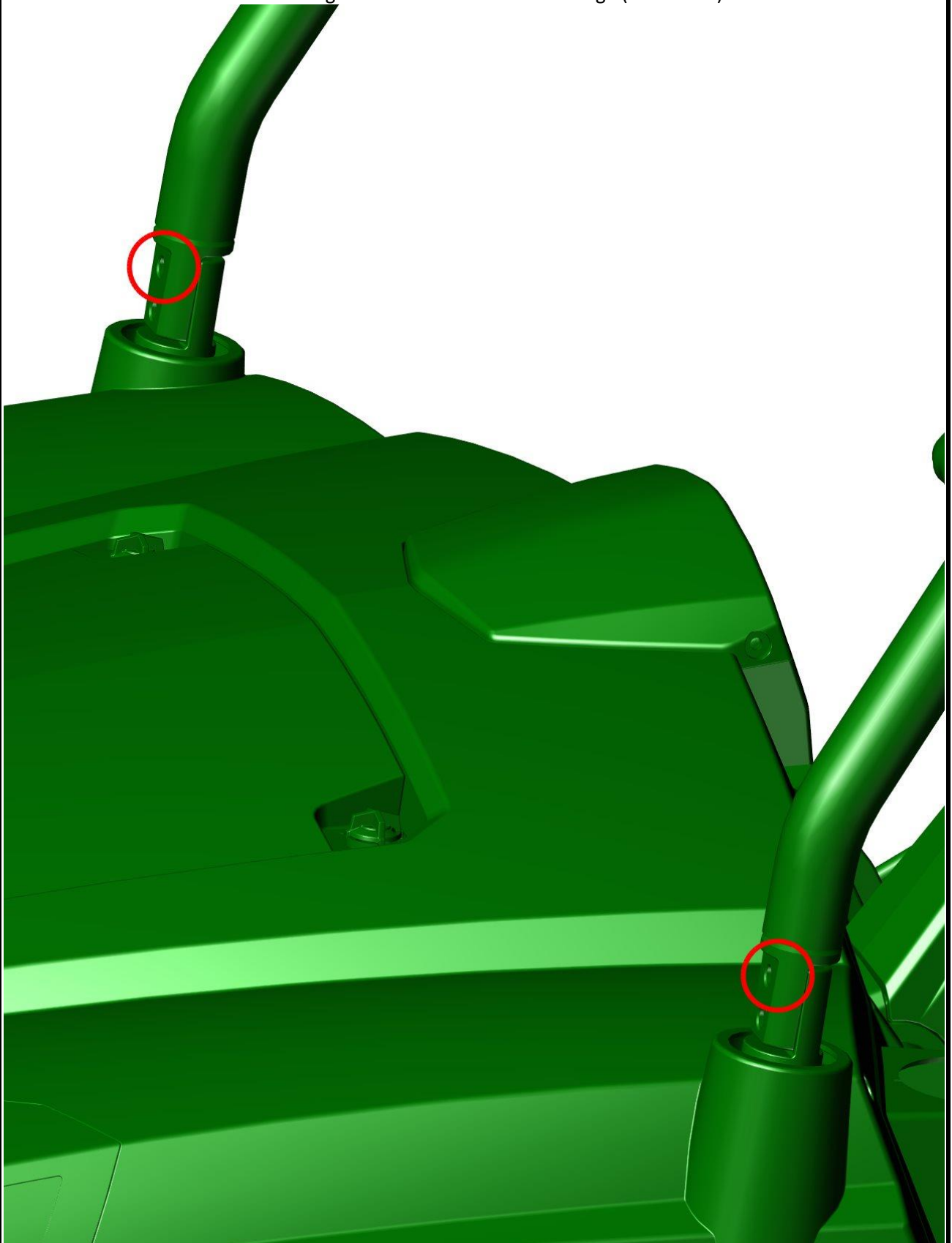

Align the front bottom ledge to the position.

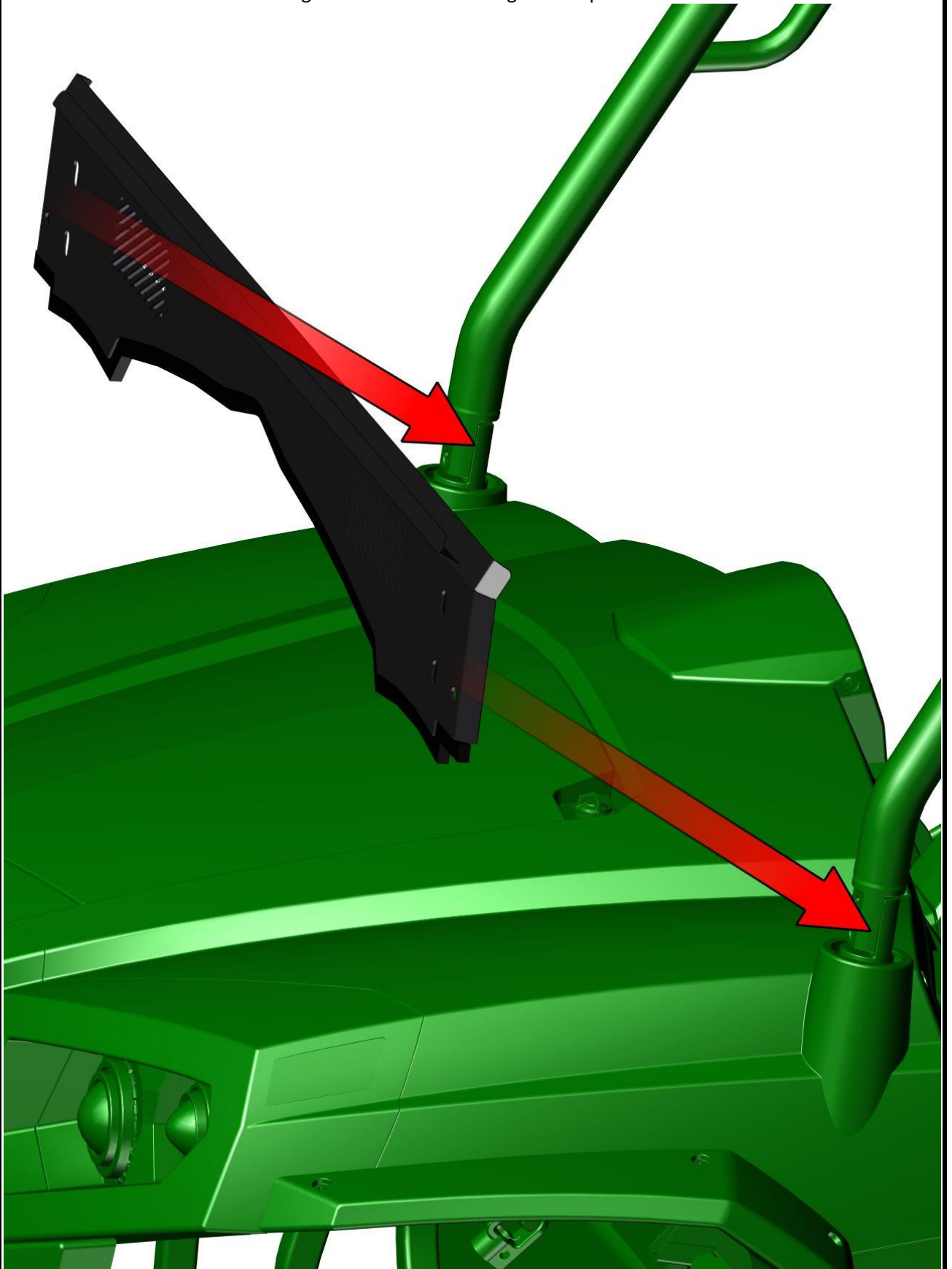

10

Mount the left front bottom ledge holder assembly together with included screws, washers, nuts and covers.

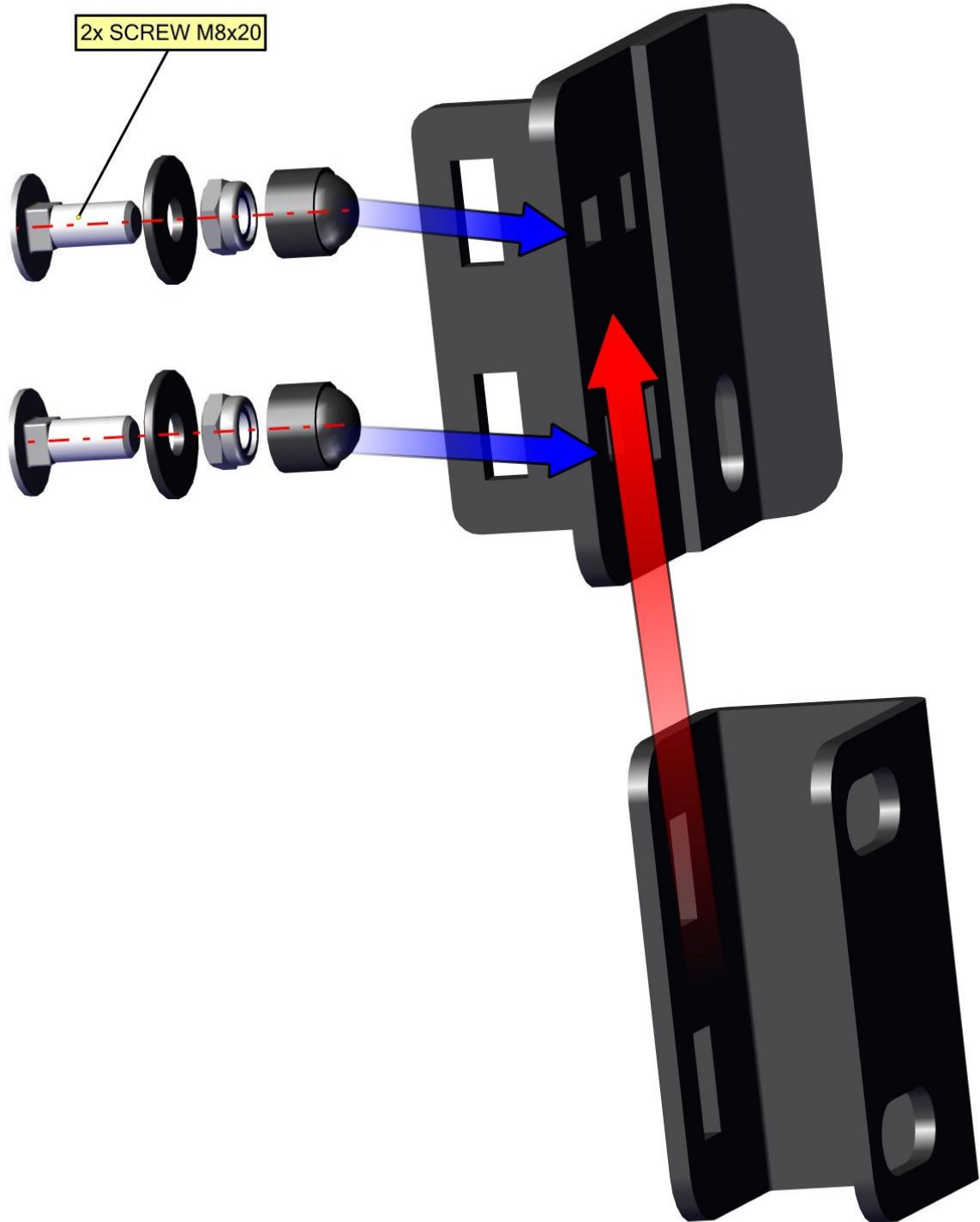

Mount the left front bottom ledge holder to the front bottom ledge with included fixing assemblies.

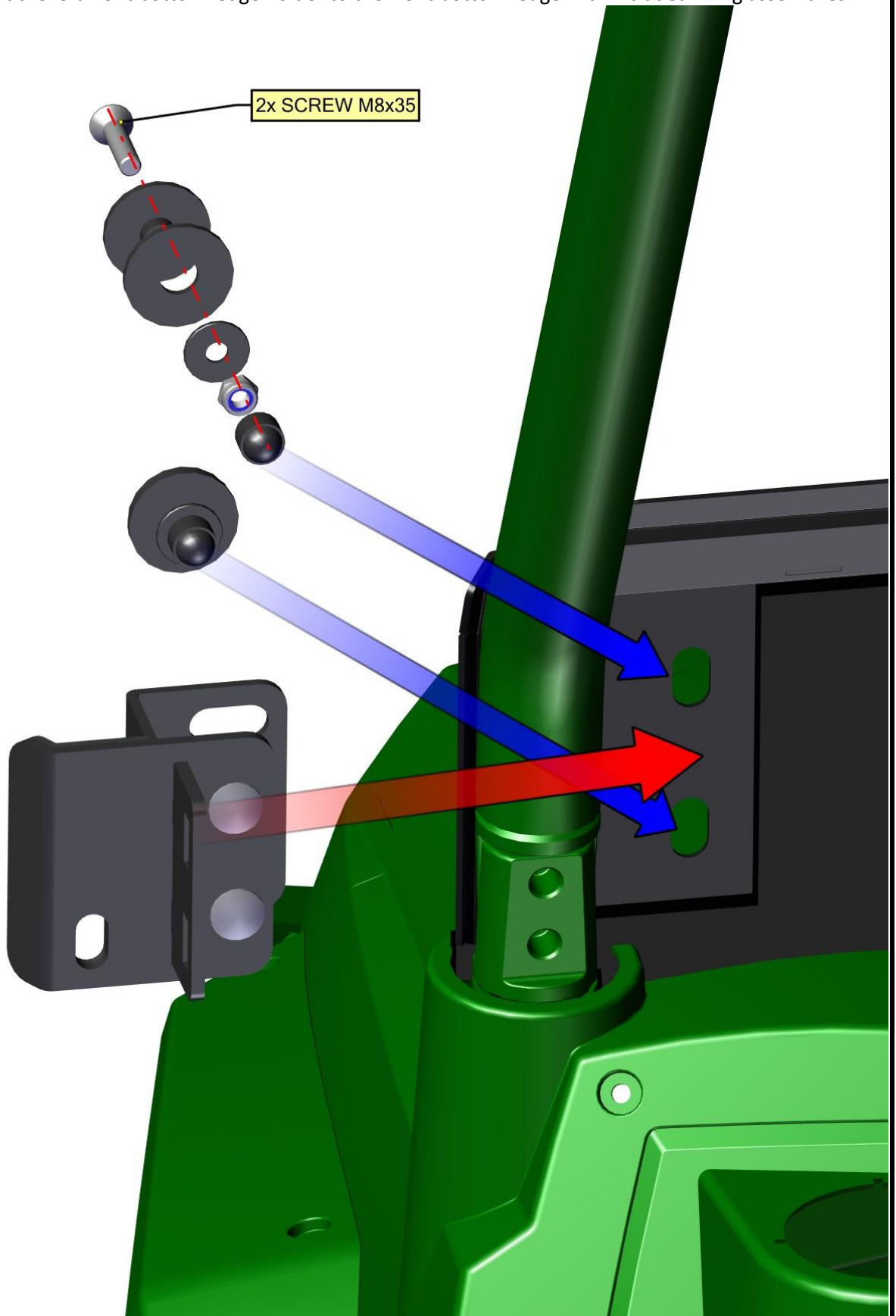

Mount the front bottom ledge and left front bottom ledge holder to UTV roller cage with included fixing assembly.

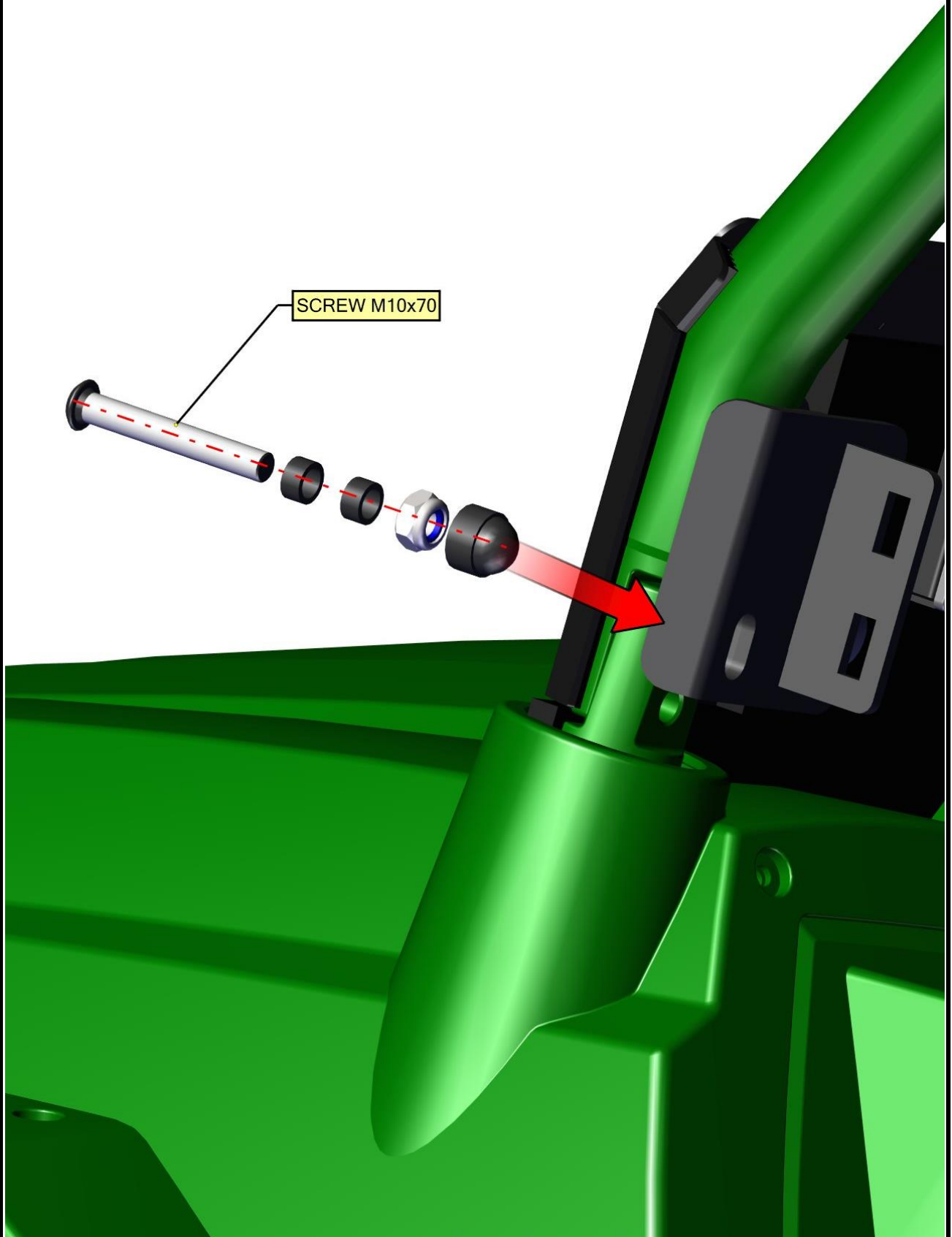

13

Repeat previous steps with right front bottom ledge holder.



14

Loosen the front glass holders screw and turn the holders out of the way.
Align the front glass assembly in the position.

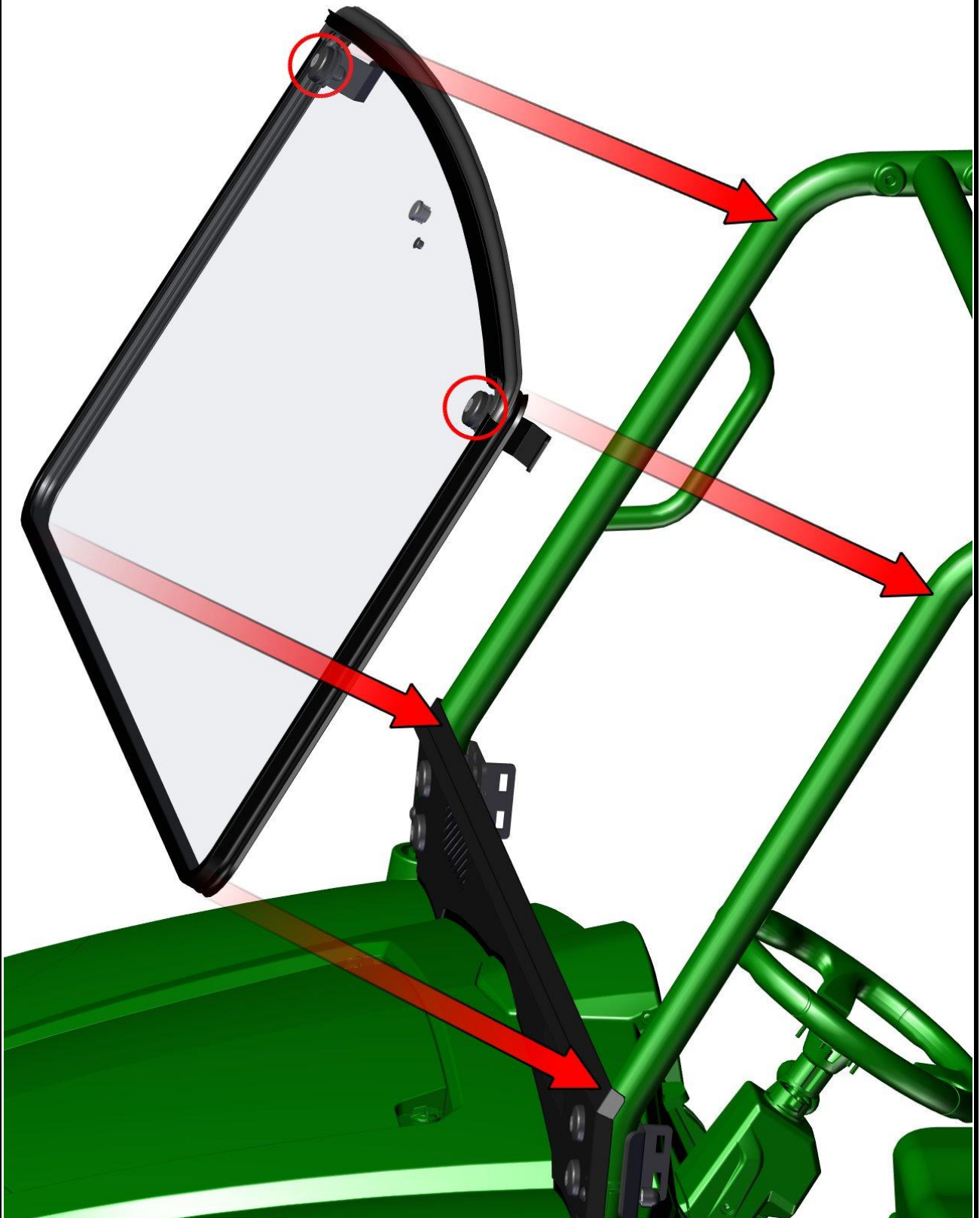

15

Turn the holder to the correct position and tighten screws correctly.

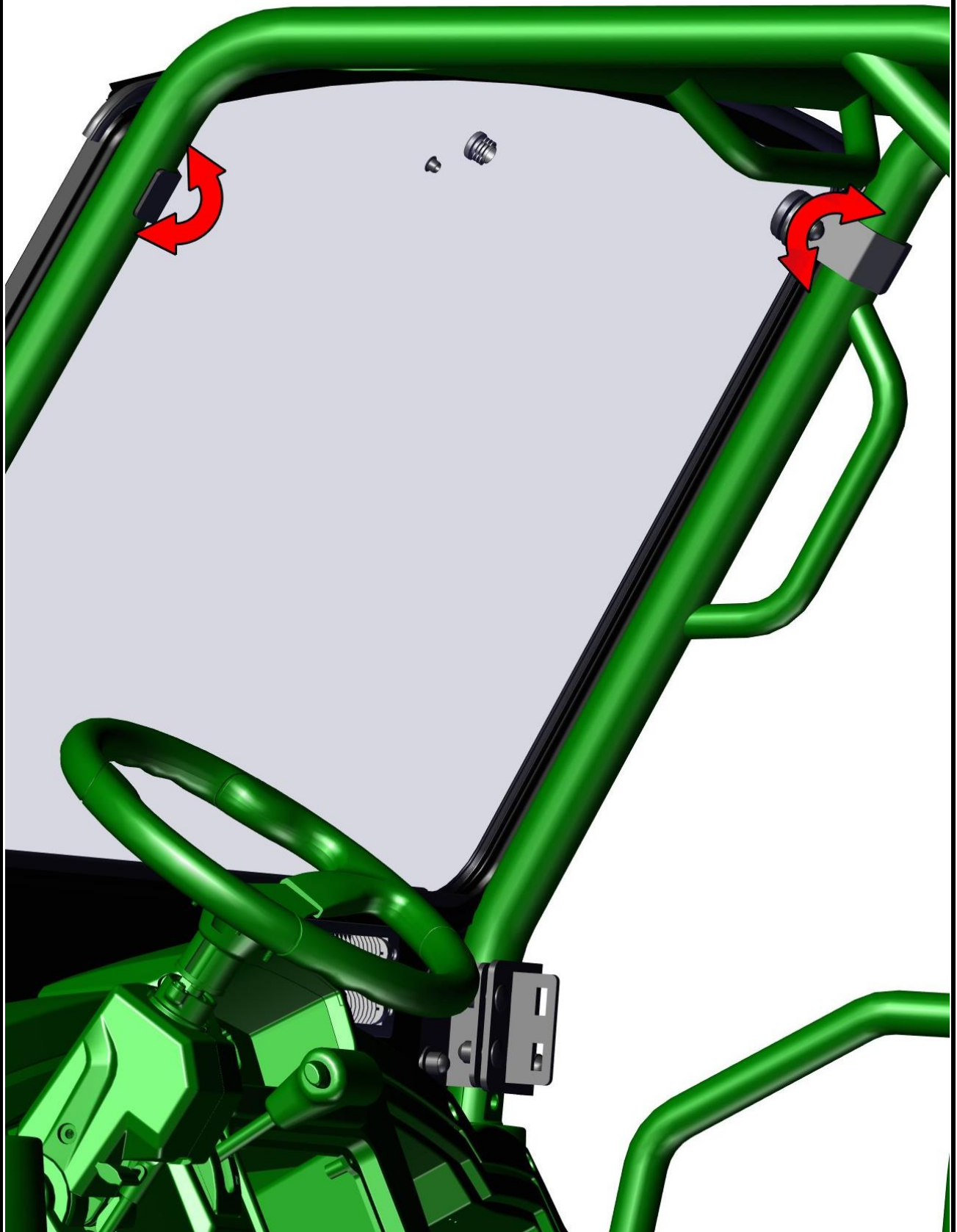

ROOF

Loosen the roof ledges original screws (red circles) on both sides.



Loosen the roof front holder screw and align the roof panel onto the UTV roller cage.



Tighten the roof ledges screws hard on both sides. Turn the front roof holder to the correct position and tighten correctly.

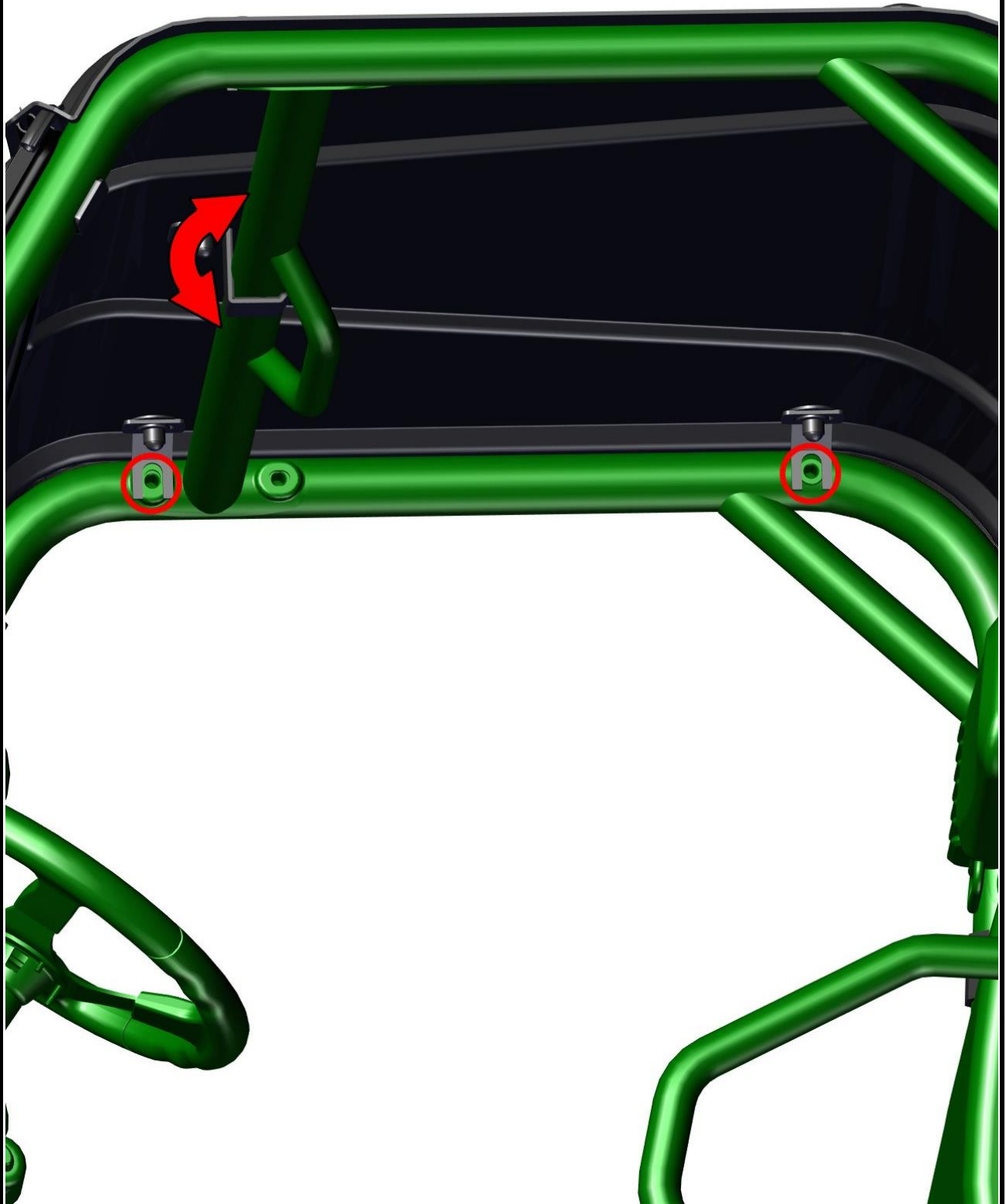

LEFT DOOR + RIGHT DOOR

Loosen the left door base holders screws and turn the holders out of the way.
Align the left door base onto the UTV roller cage.

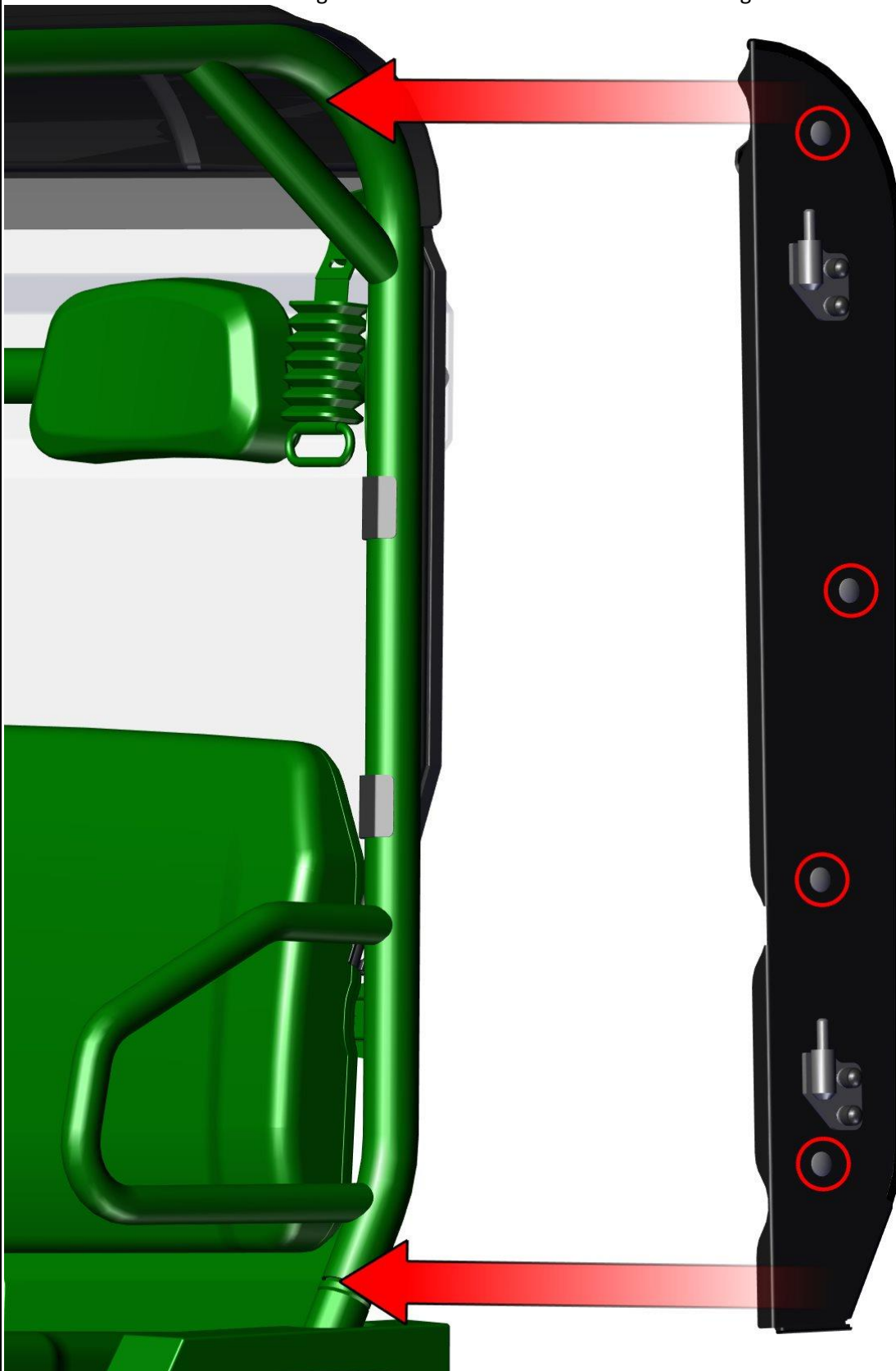

Turn the holders to the correct position and tighten screws correctly.

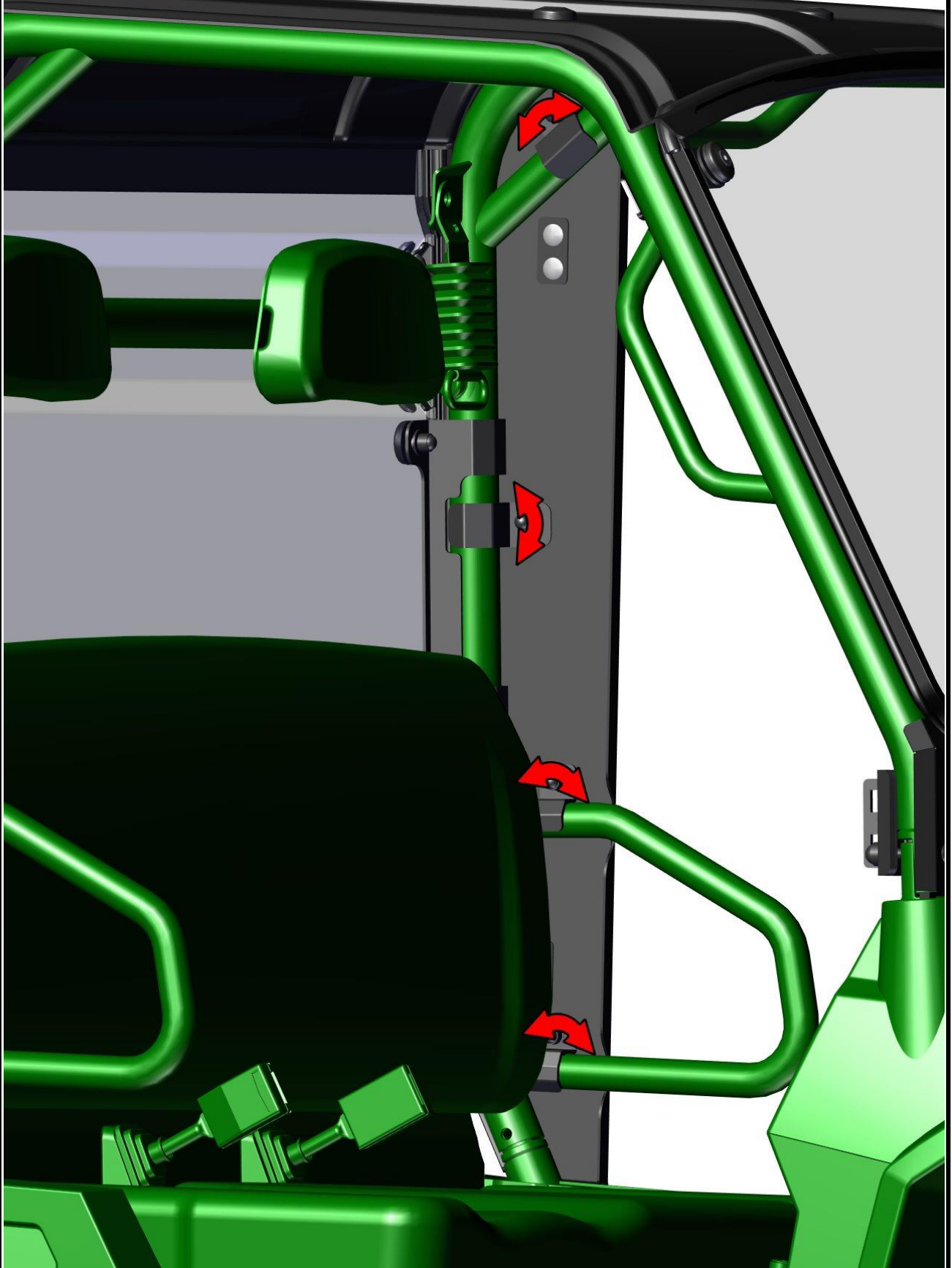

Install the door stop assembly into the left door stop holder.

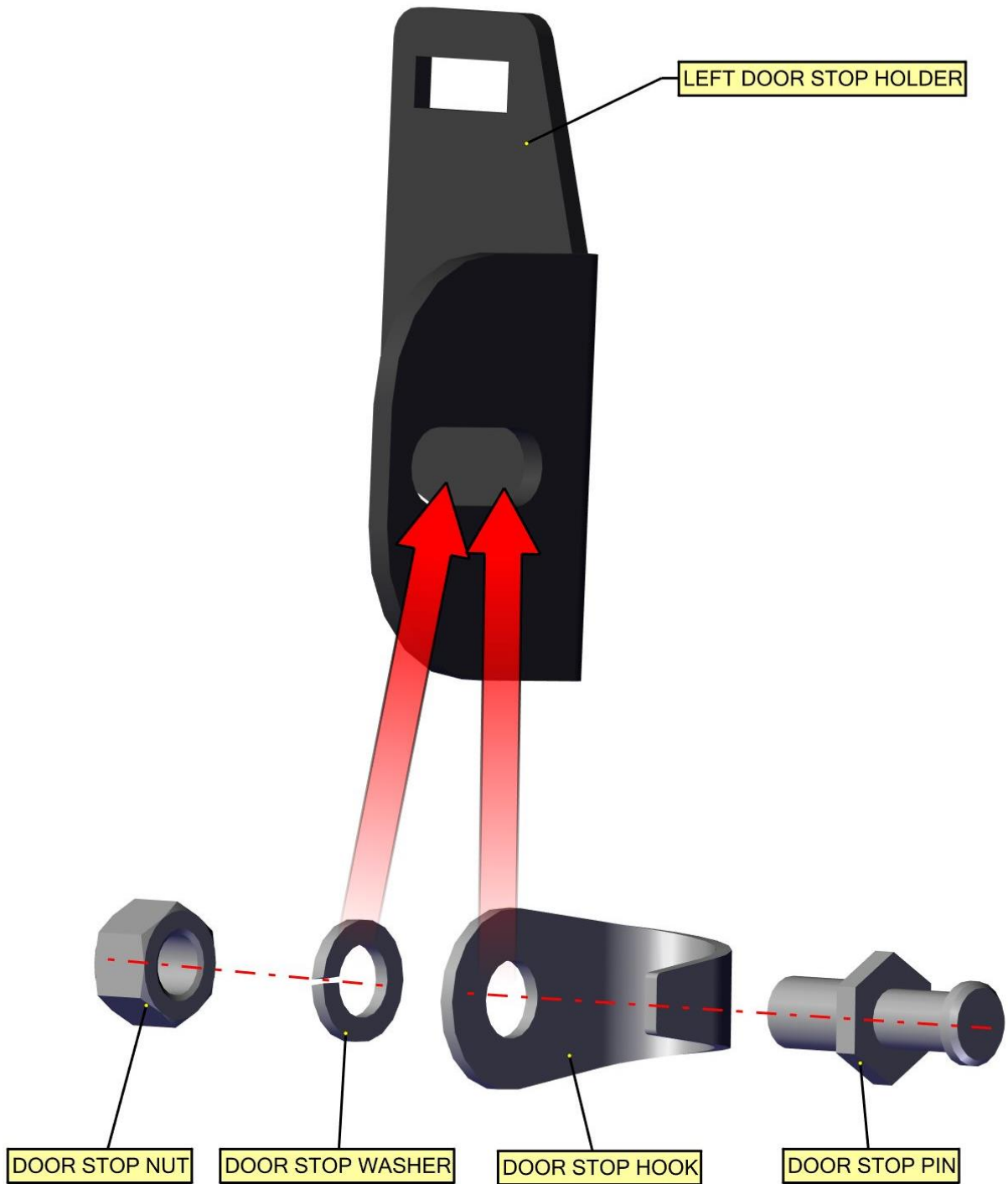

Mount the left door stop assembly to the left front bottom ledge holder with included fixing assemblies.

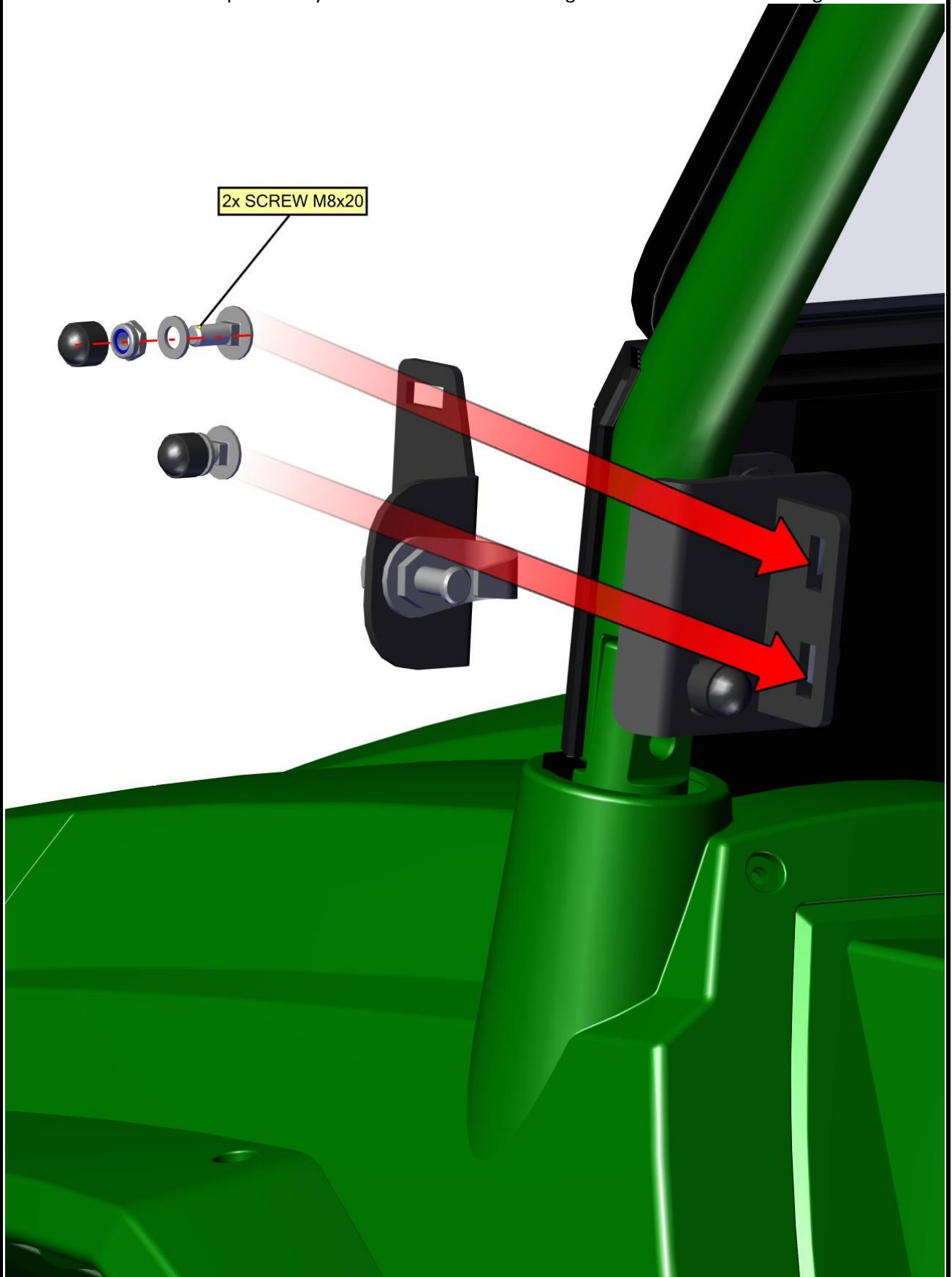

Mount the original hinges cover ledge to the original hinge bases with included fixing assemblies.

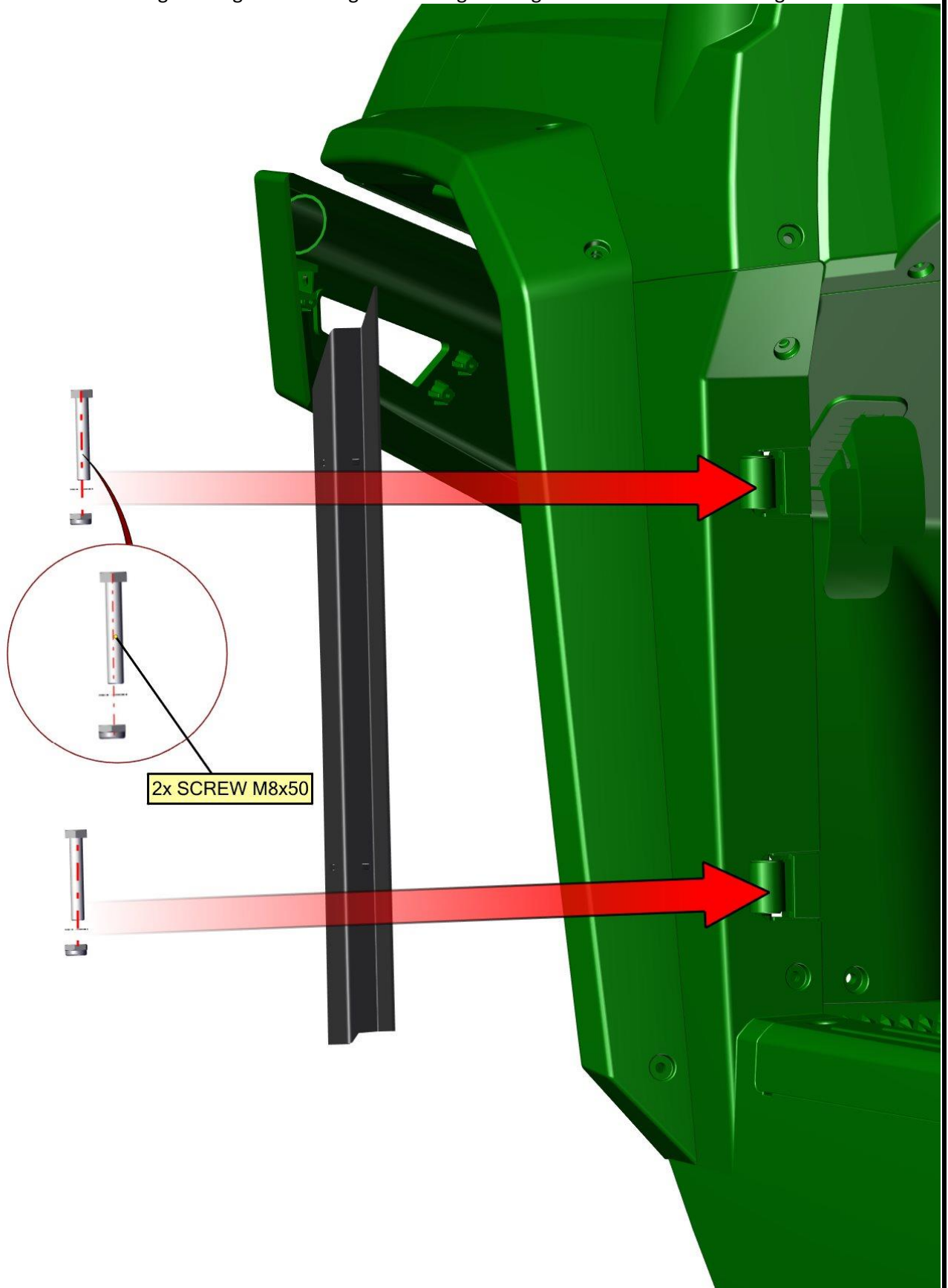

Lubricate the hinges pins and place the left door onto the left hinges.

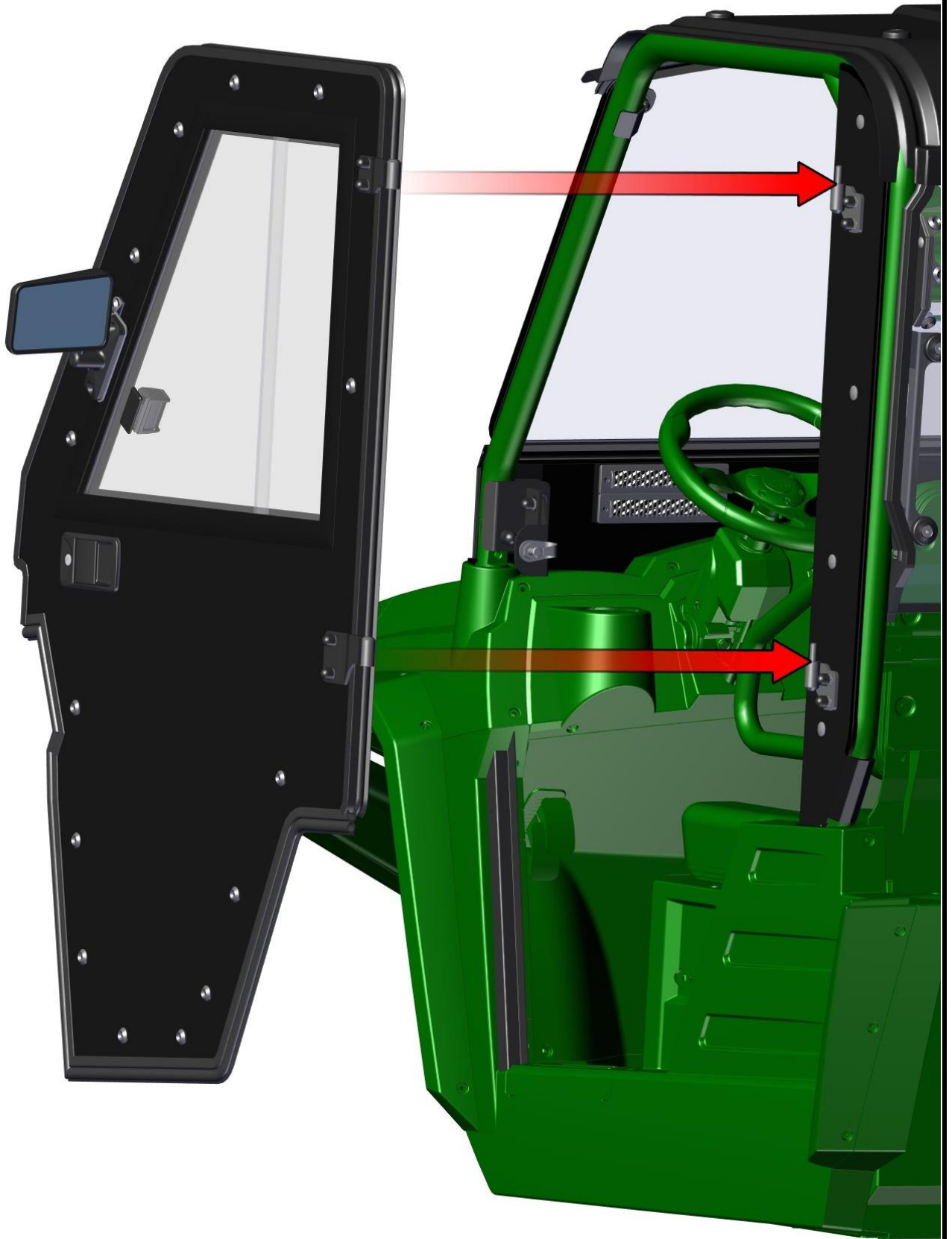

25

Adjust the left door into the best position by hinges and tighten hinges screws correctly.



Adjust the left door stop assembly into the best position and tighten hard.
IF YOU ADJUSTED CORRECTLY, YOU CAN HEAR TWO CLEAR METALIC CLICK WHEN YOU
CLOSE DOOR SLOWLY.

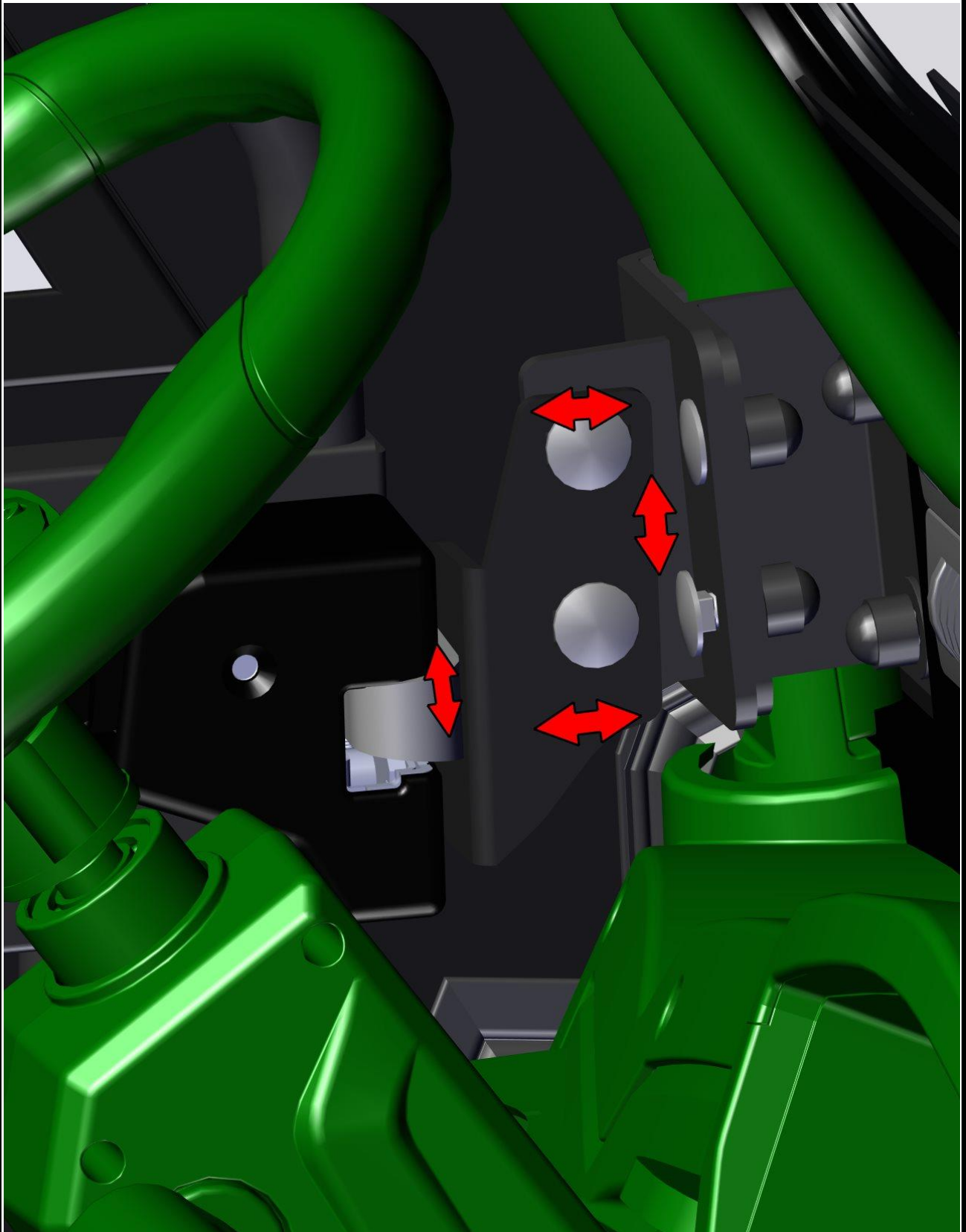

Repeat previous steps with the right door assemblies.



ELECTROINSTALLATION

IMPORTANT

COOLANT FROM THE ENGINE COOLING SYSTEM SHOULD BE DRAINED.
IT IS ABSOLUTELY NECESSARY TO TAKE OUT THE RUBBER PLUGS FROM THE HEATER TUBES!!!

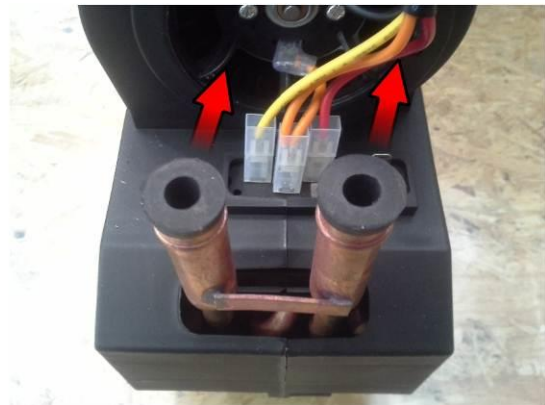
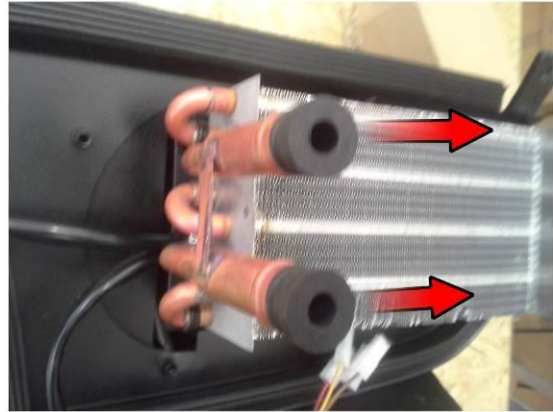

Install the heater with the holder into the UTV to the best position and connect the hoses to the heater. Connect the heater hoses to the engine cooling system by included couplings or pins into the best position. Remember, one hose run the hot water to the heater and second hose run the water from the heater back to the engine cooling system.

Be very careful with correct installation. If you are not sure how to connect couplings or pins, please ask your dealer for help.

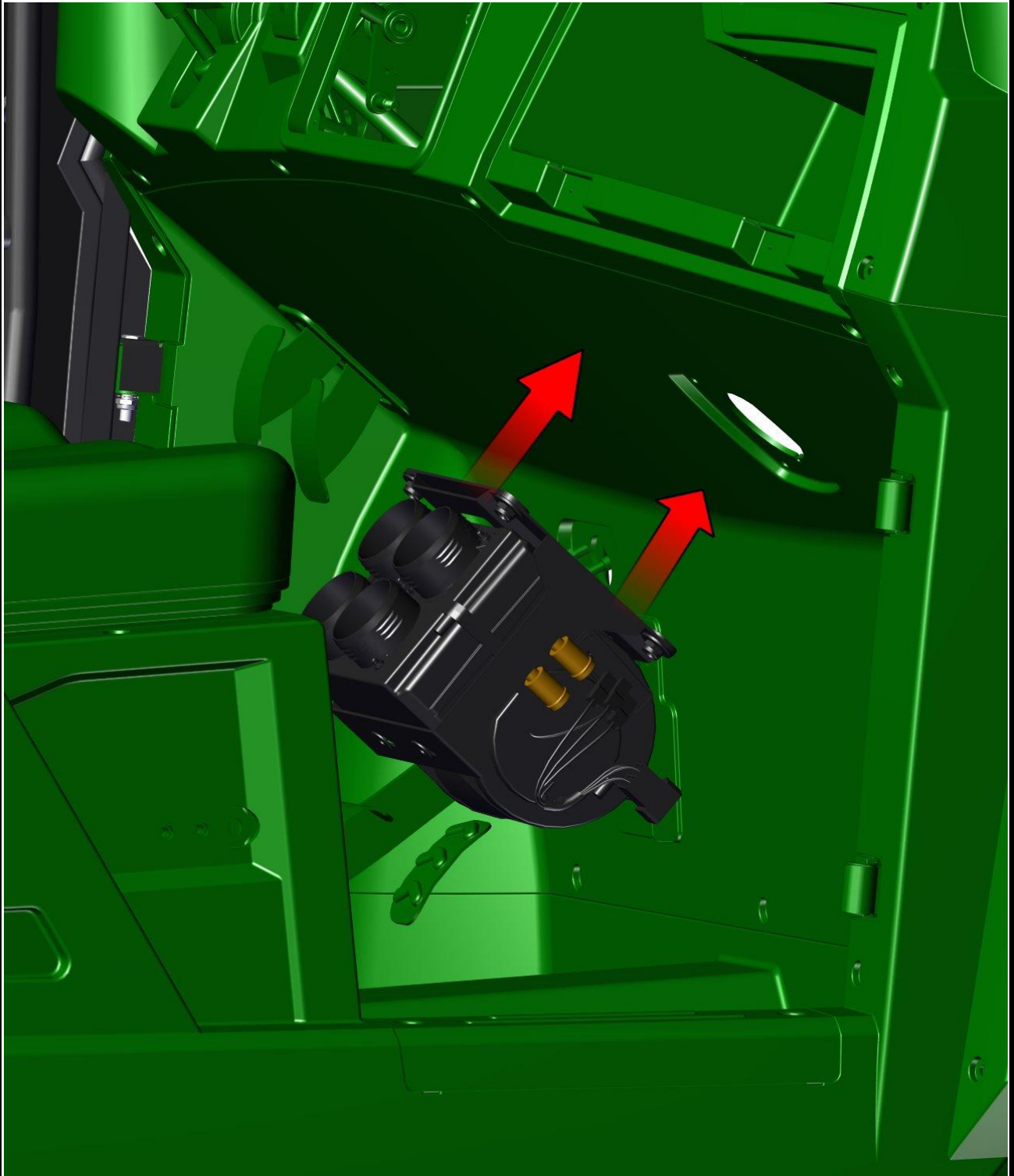

30

Connect the hot air hoses PVC to the air vents and fix with tightening straps.
Connect the heater harness to the heater and valve switches and with the original UTV electro installation in accordance with the overall wiring diagram.

Overall wiring diagram

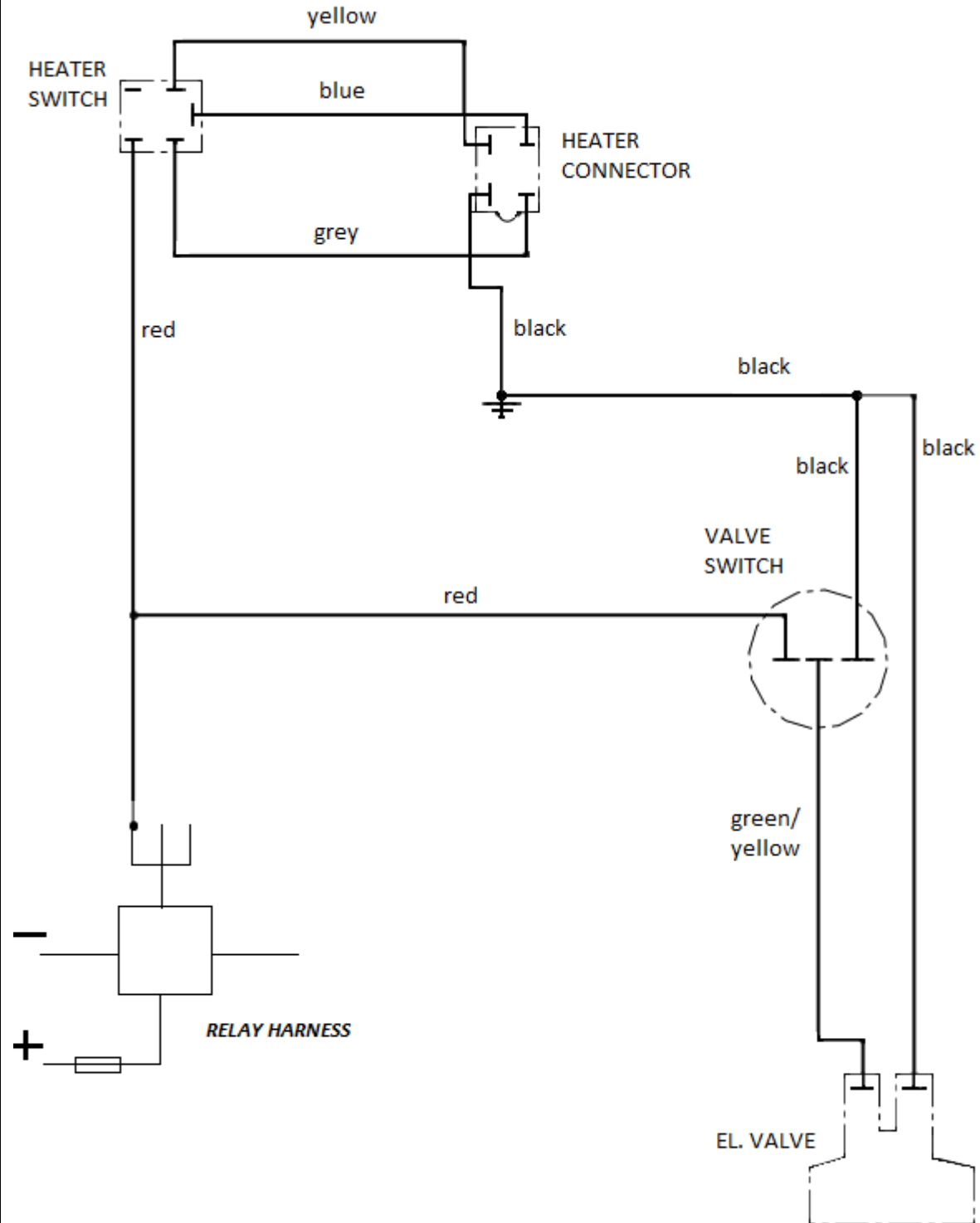

31

Connect the heater harness branch with the heater connector. Detail view.

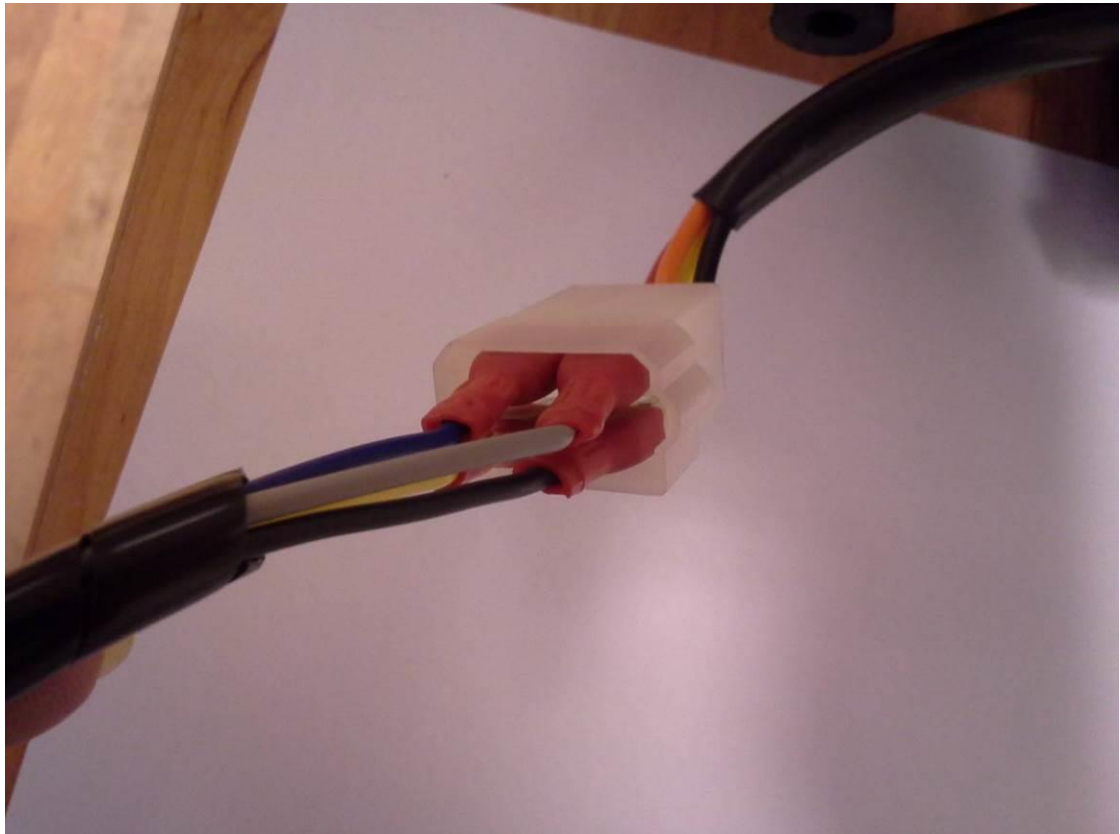

Connect the valve harness branch with the electromagnetic vent. Detail view.

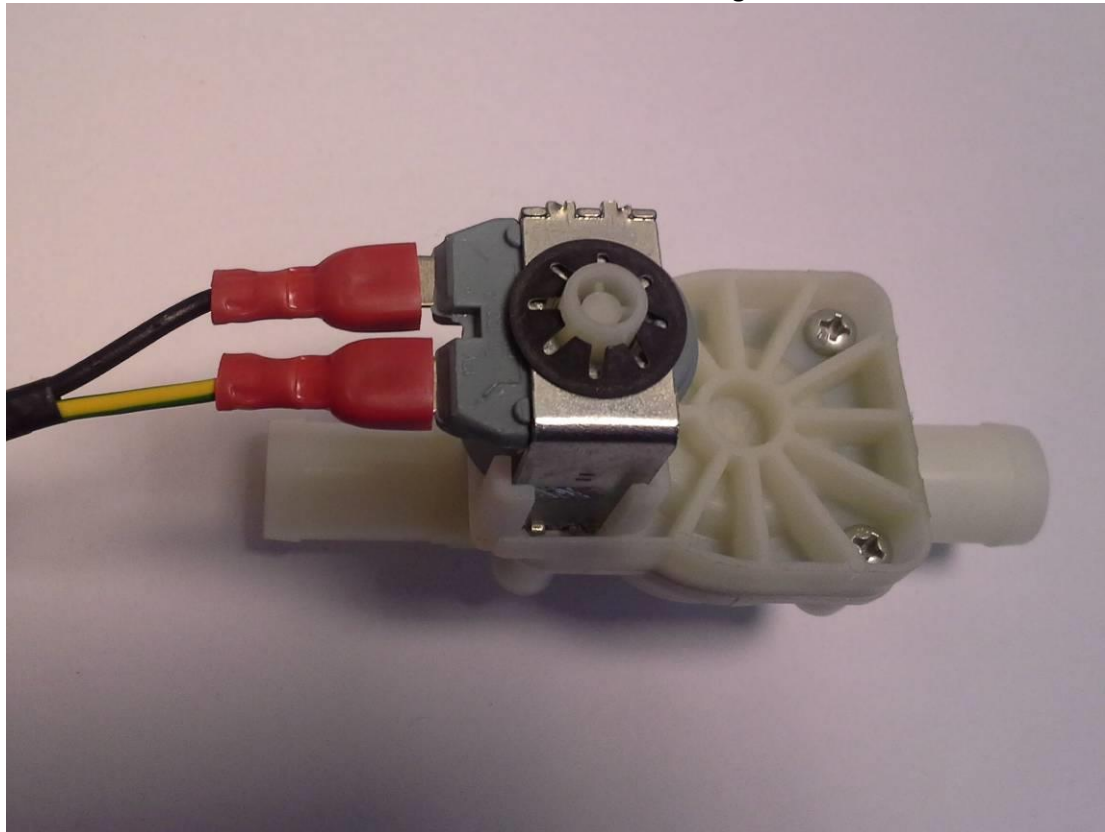

Connect the heater switch body with the harness branch. Detail view.

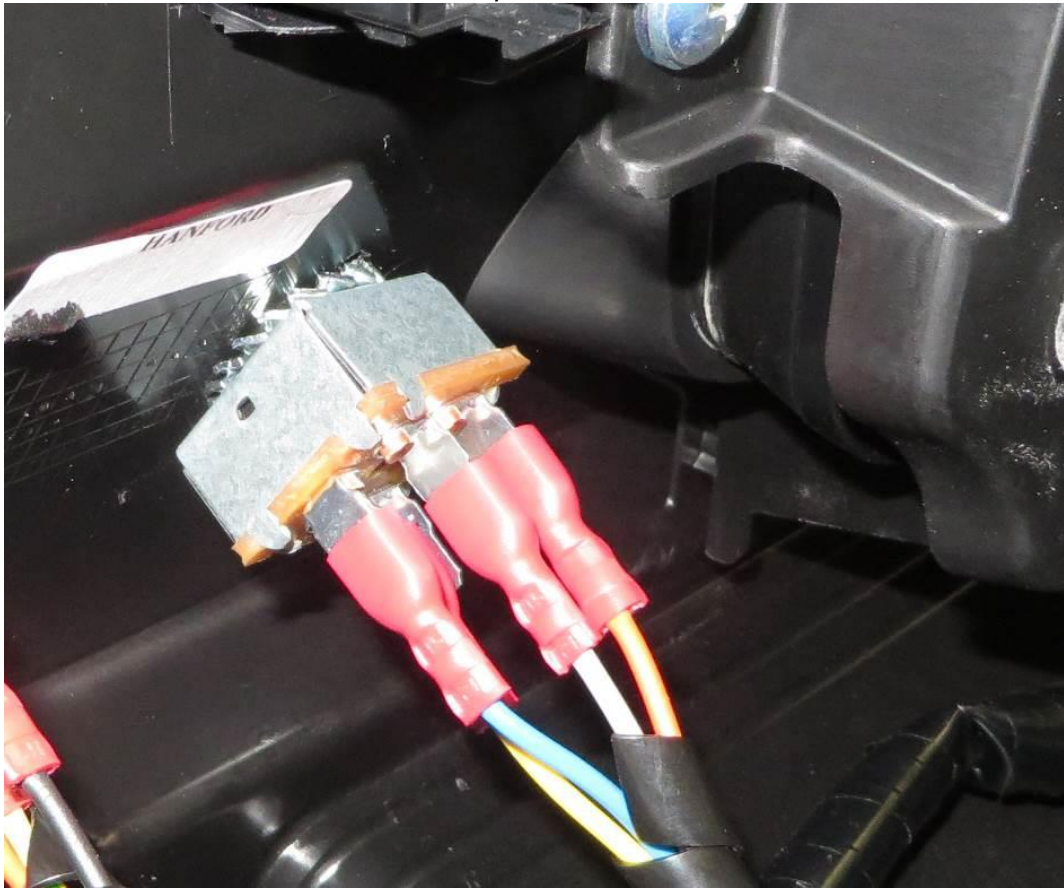

connect the valve switch branch with the switch. Detail of connection.

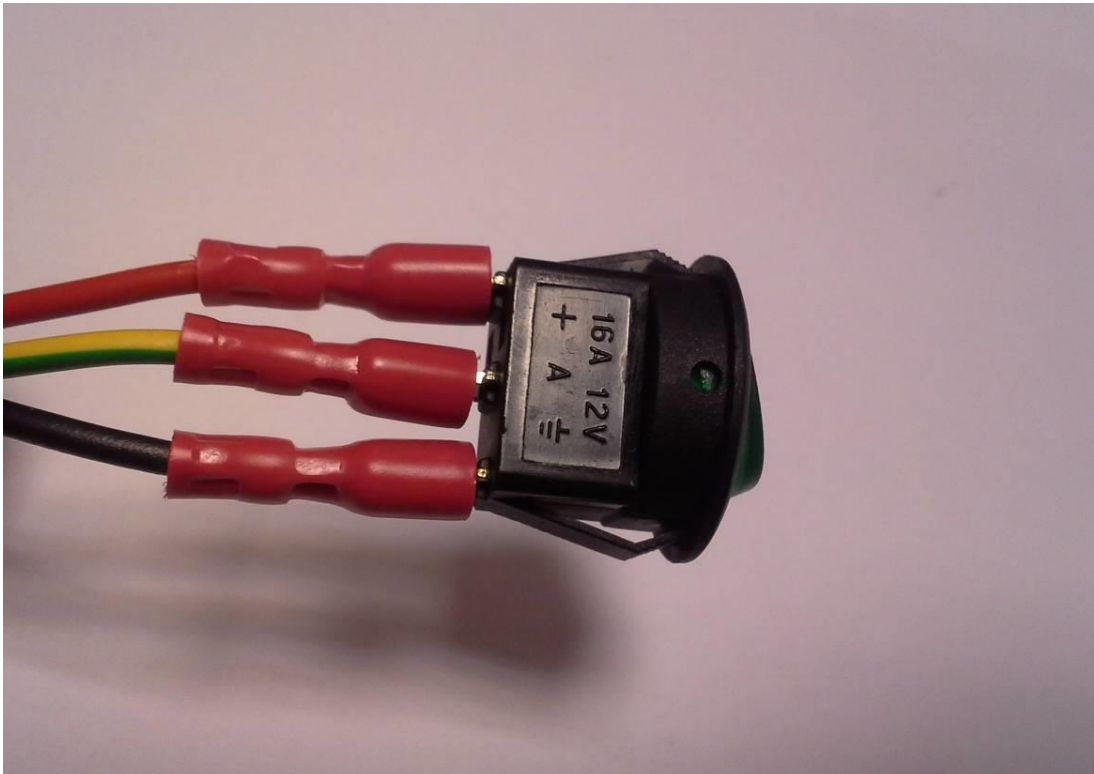

Install the heater cover to the position and fix to the dashboard with included rubber rivets.

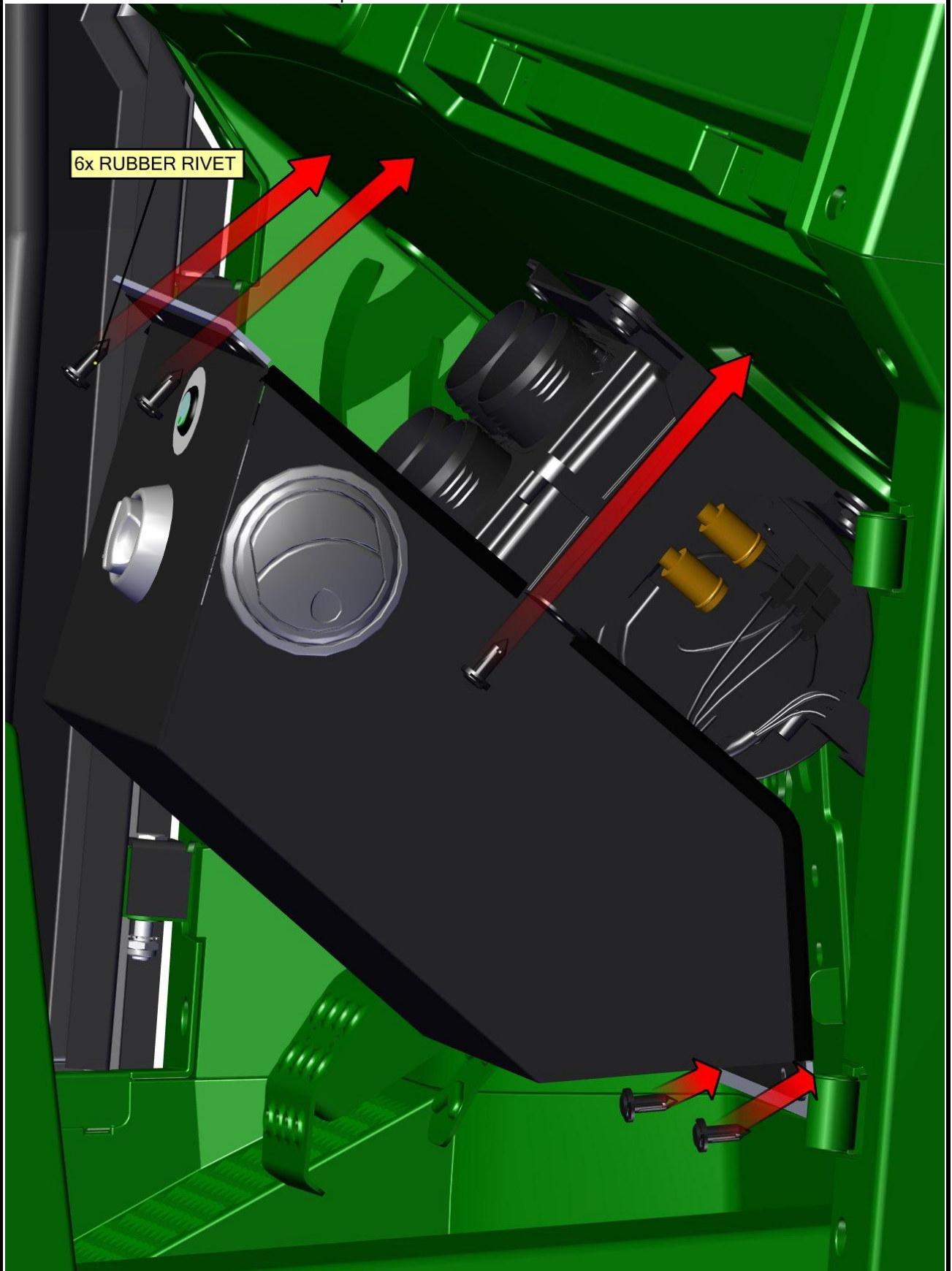

It is absolutely necessary to bleed the air out of the UTV's engine cooling system. Incomplete bleeding of cooling system can result in engine damage. If you don't have sufficient experience with this process, we strongly recommend professional service technician assistance. We are not responsible for damages when cooling system bled incompletely. Please note that additional heater system will absorb more than 2 liters of coolant fluid.

- 1. Important: After the heater system installed check the system for leaks. Turn on the electric vent switch and confirm that the engine is cold. Start the engine, open bleeding valve and wait until engine warms up. Important: Always check engine temperature – if it overheats turn off engine.***
- 2. To achieve engine operating temperature depress the accelerator to increase the engine RPM. This will increase the pressure and flow of the water pump forcing more coolant through the heater. After operating temperature reaches turn off engine and open it. Trapped air should come out from heater system throughout bleeding valve. Repeat this procedure until heater/cooling system is completely bled out.***

The DFK Cab heater, like the heater in a car, generates heat from the vehicle's engine.

In nearly all cases, the heater should generate enough heat from your UTV, side by side, or tractor engine that you may need to turn the heater off periodically otherwise the air in the cabin may be too hot.

It is important to check the coolant level regularly at least 4-5 times during the first several days of operation and fill as necessary until the coolant level has stabilized. The heater will draw and retain coolant, sometimes at the expense of coolant to the engine. This can cause engine overheating if not managed properly.