



INSTALLATION INSTRUCTIONS

POLARIS
RZR 1000 XP

SAFETY INSTRUCTIONS

Warning: Failure to heed all safety and operating instructions and warnings regarding use of this product can result in serious bodily injury.

READ COMPLETE ASSEMBLY INSTRUCTIONS BEFORE STARTING OF ASSEMBLY

Install all parts indicated in assembly instructions. Failure to fully assemble product before use could result in personal injury.

***Assembly of product requires use of hand or power tools.
If you are not experienced in using these types of tools,
have product dealer do the install for you.***

Some parts contain sharp edges, wear protective gloves if necessary.

Always keep your assembly area clean, uncluttered and well lit.

Keep visitors and children a safe distance away from the assembly area. Visitors should wear the same safety equipment described below.

Dress for safety. DO NOT wear loose clothing, gloves, neckties or jewelry if using power tools to assemble this product.

Never operate your UTV with the cab doors open. Failure to properly latch the doors before moving the vehicle could result in serious injury.

Insert all nut covers after you finish installation.

***Never drive your UTV with the cab front window in open position.
Failure to properly latch/lock front window before driving the vehicle could result in serious injury.***

Please be careful to not break the plastic washers. When tightening screws with plastic washers use maximal power 3.7 foot-pound force (5 Nm)!!!

WARNING: For safety purposes, if the DFK Cab doors are removed, it is mandatory that the OEM manufactured Half Doors or Nets are **REINSTALLED** before operating the vehicle.

MAINTENANCE AND CLEANING

To clean polycarbonate surface use soapy water solution or other subtle means.

Wash dirt and dust off with a gentle water stream and wipe only with wet or damp rag or sponge from top to bottom.

The recommended frequency of cleaning of polycarbonate panels is about 1 time per month or according to the actual degree of dirtiness.

*Do not use detergents that could scratch the surface plates.
(abrasives, harsh fabrics, etc.)*

*Do not use solvents or alkaline detergents or cleaners with ammonia
(ammonium hydroxide).*

Do not remove the impurities from the surface with razor blades or other sharp items.

Do not clean cabin when the polycarbonate plates are heated by the sun.

Do not use the squeegee, as it could scratch the surface plates.

Do not clean the water current strength greater than 50 bar (WAP)

The manufacturer is not responsible for scratching the surface in case of failure to comply with the above instructions.

All bolted connections of cab must be by user at regular intervals checked and tightened.

Please be careful to not break the plastic washers. When tightening screws with plastic washers use maximal power 3.7 foot-pound force (5 Nm)!!!

PREPARATION FOR INSTALLATION:

Uninstall all additional systems from the roller cages (work lights, rear mirrors, drink holders etc.)

CAB PREVIEW

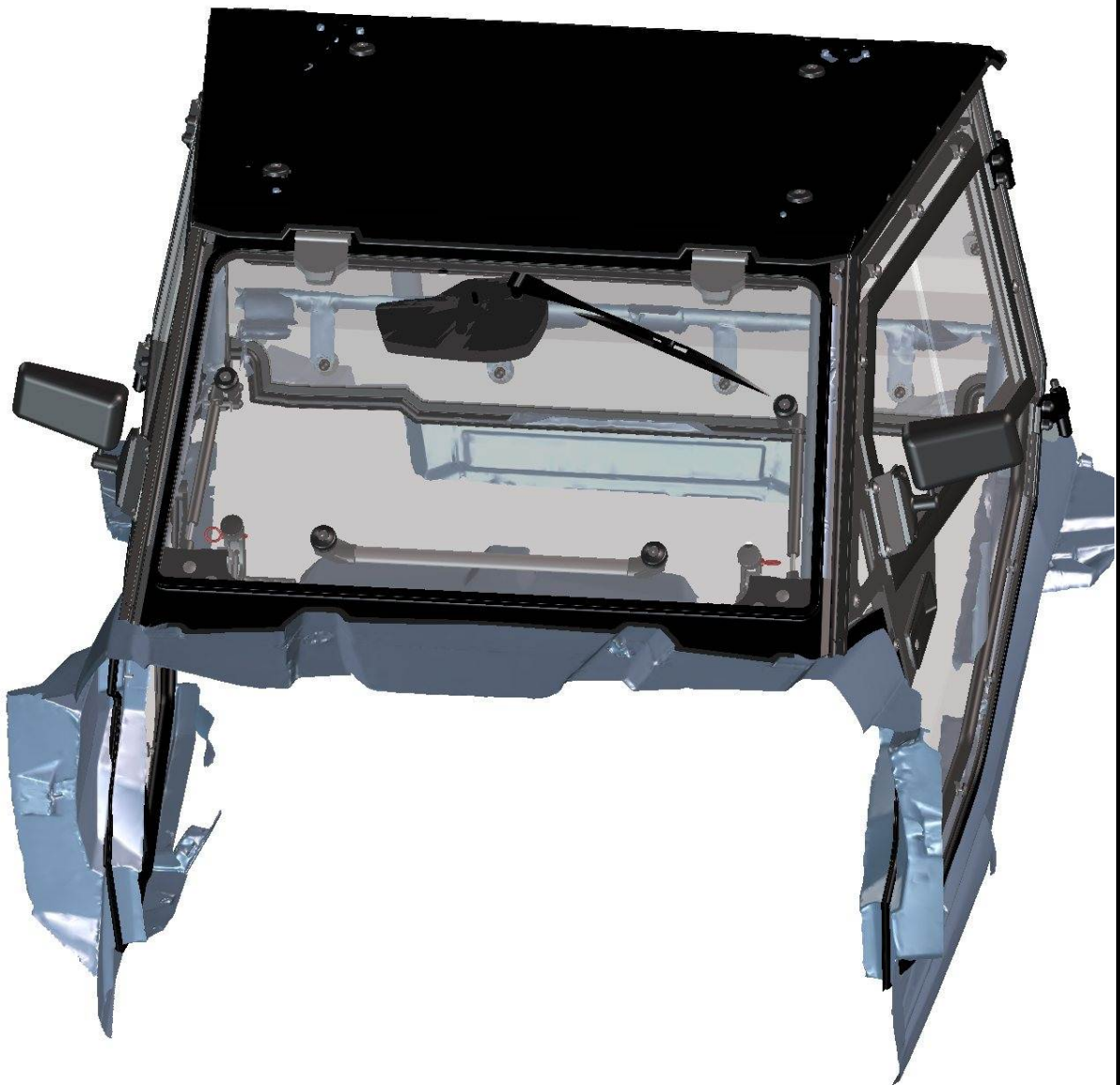

4

LEFT DOOR + RIGHT DOOR 1.

Uninstall original left door assembly and left safety ledge from the UTV roller cage (red circle).



5

Place the left door base onto the UTV roller cage and fix by included screws, washers, nuts and covers.

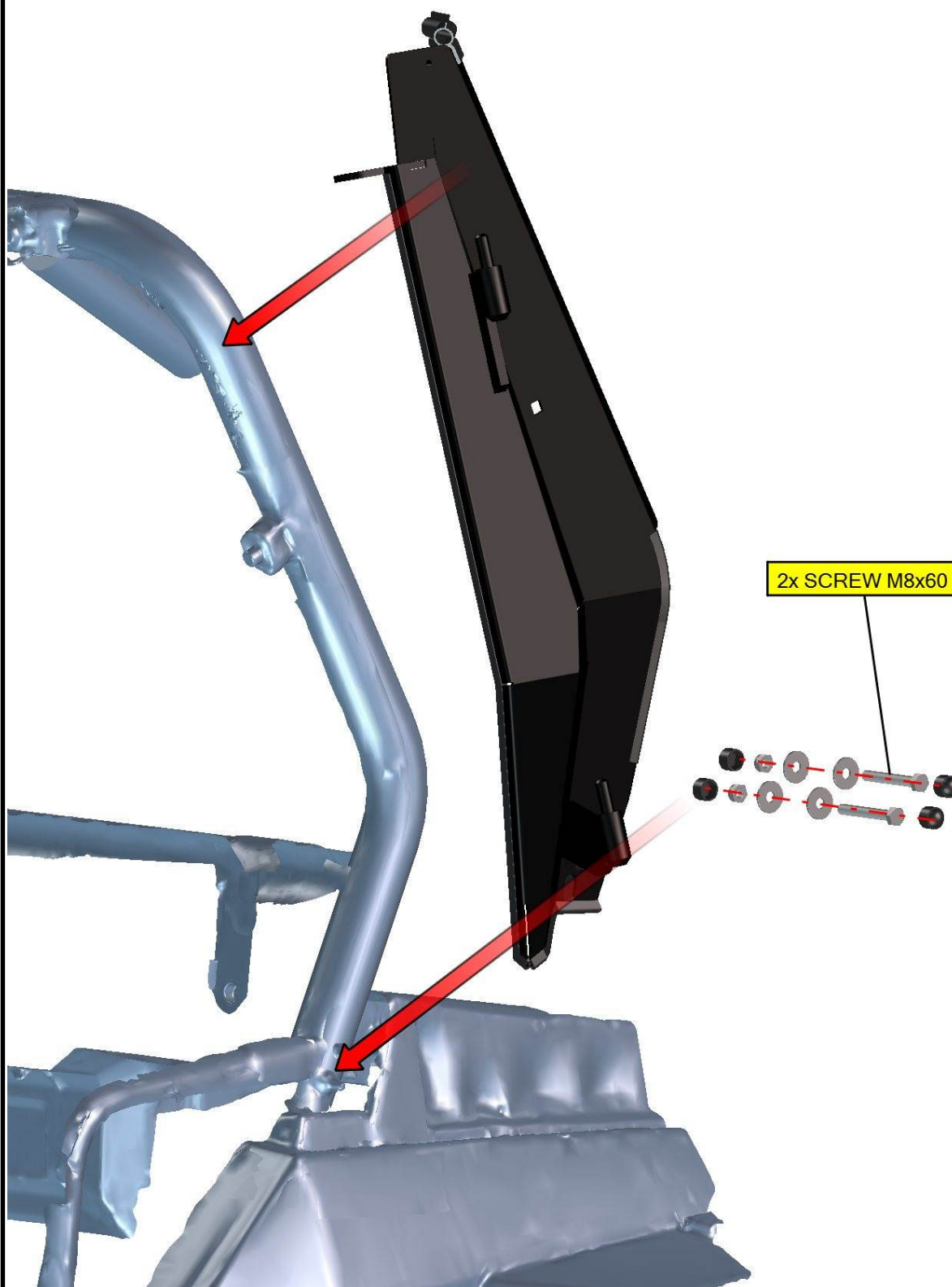

6

Place the door base holder onto the left door base and fix by included screw, washer, nut and cover.
Fix the door base holder with the UTV roller cage by original screw, washer and nut.

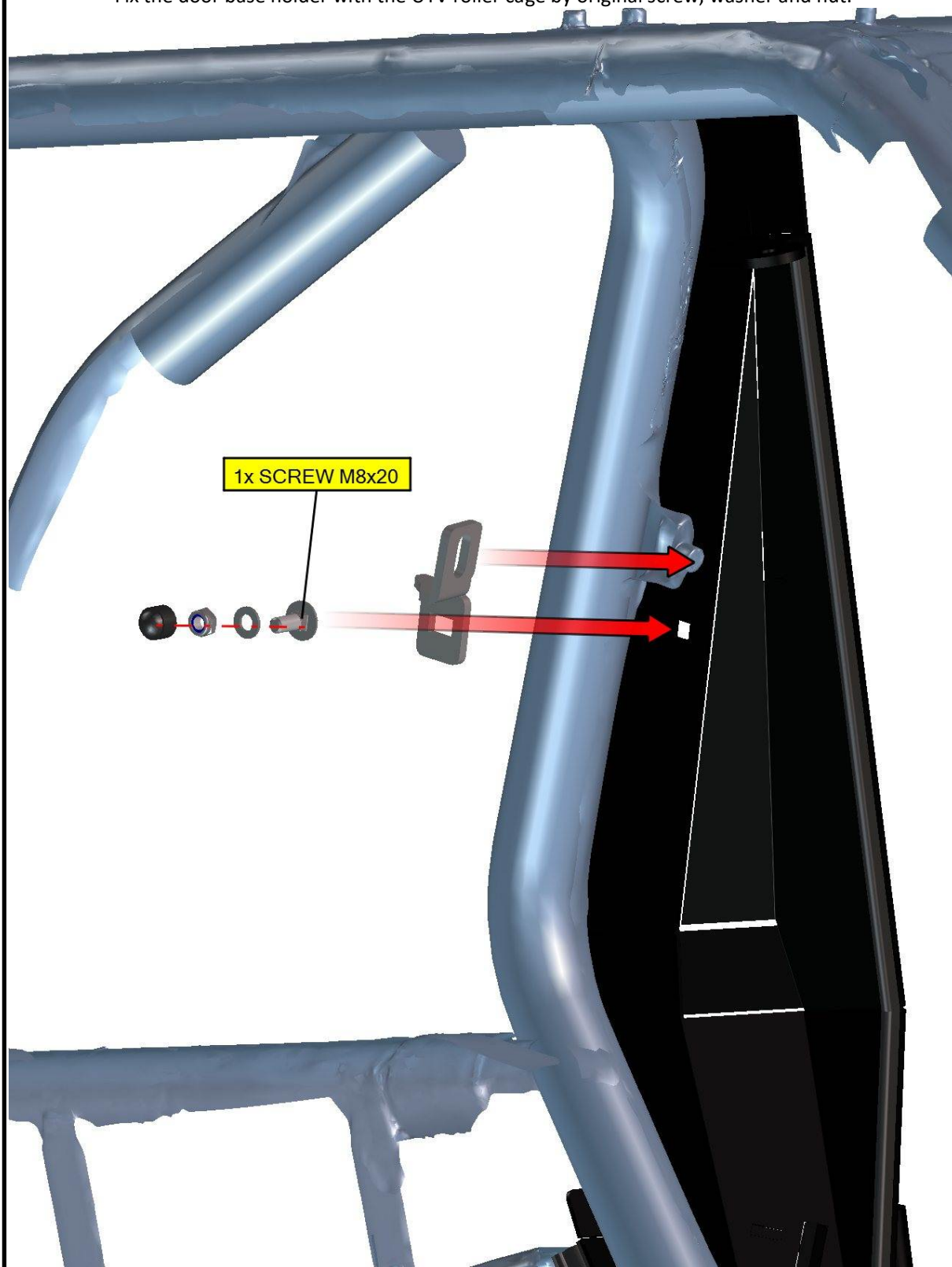

7

Repeat previous steps with the right door base.



8

REAR PANEL

Place the rear window poly onto the UTV rollcage. Carefully adjust the rear panel poly into the best position in order to fit the pipe sealing onto the frame pipes.

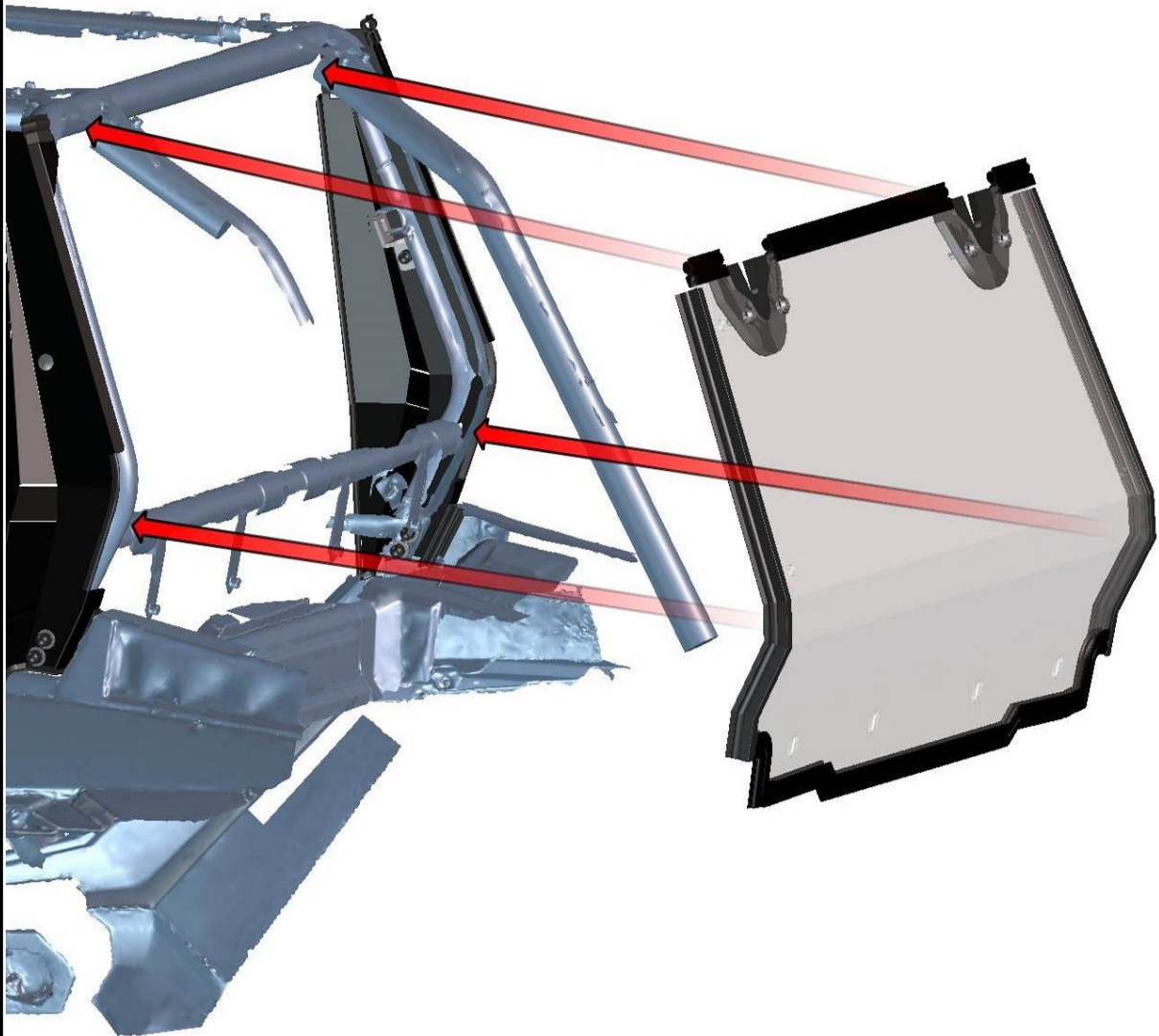

9

Fix the rear window poly with the UTV roller cage by included screws, washers, nuts and covers

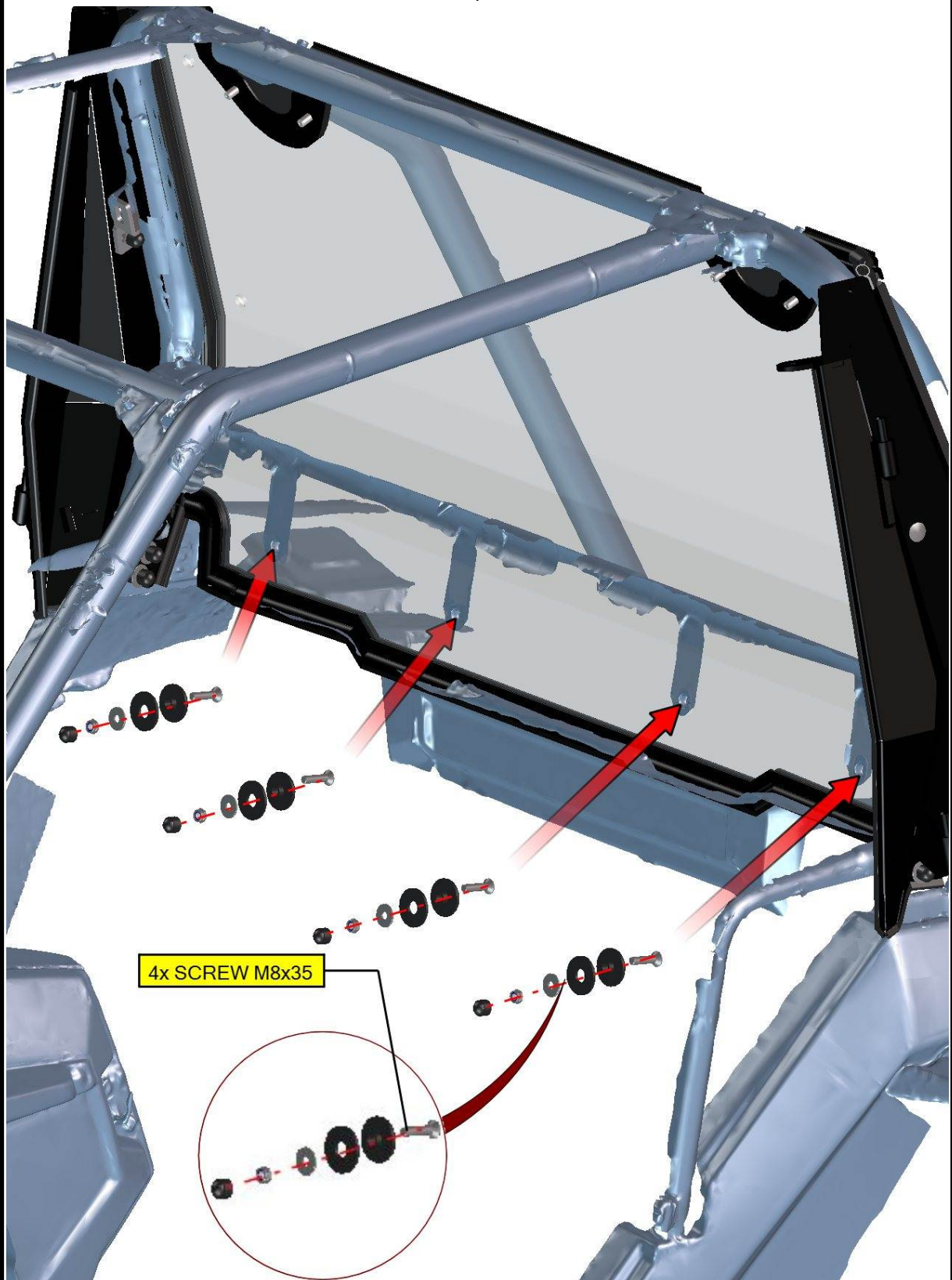

10

Fix the rear window poly with the UTV roller cage by included holders, screws, washers, nuts and covers on both sides.

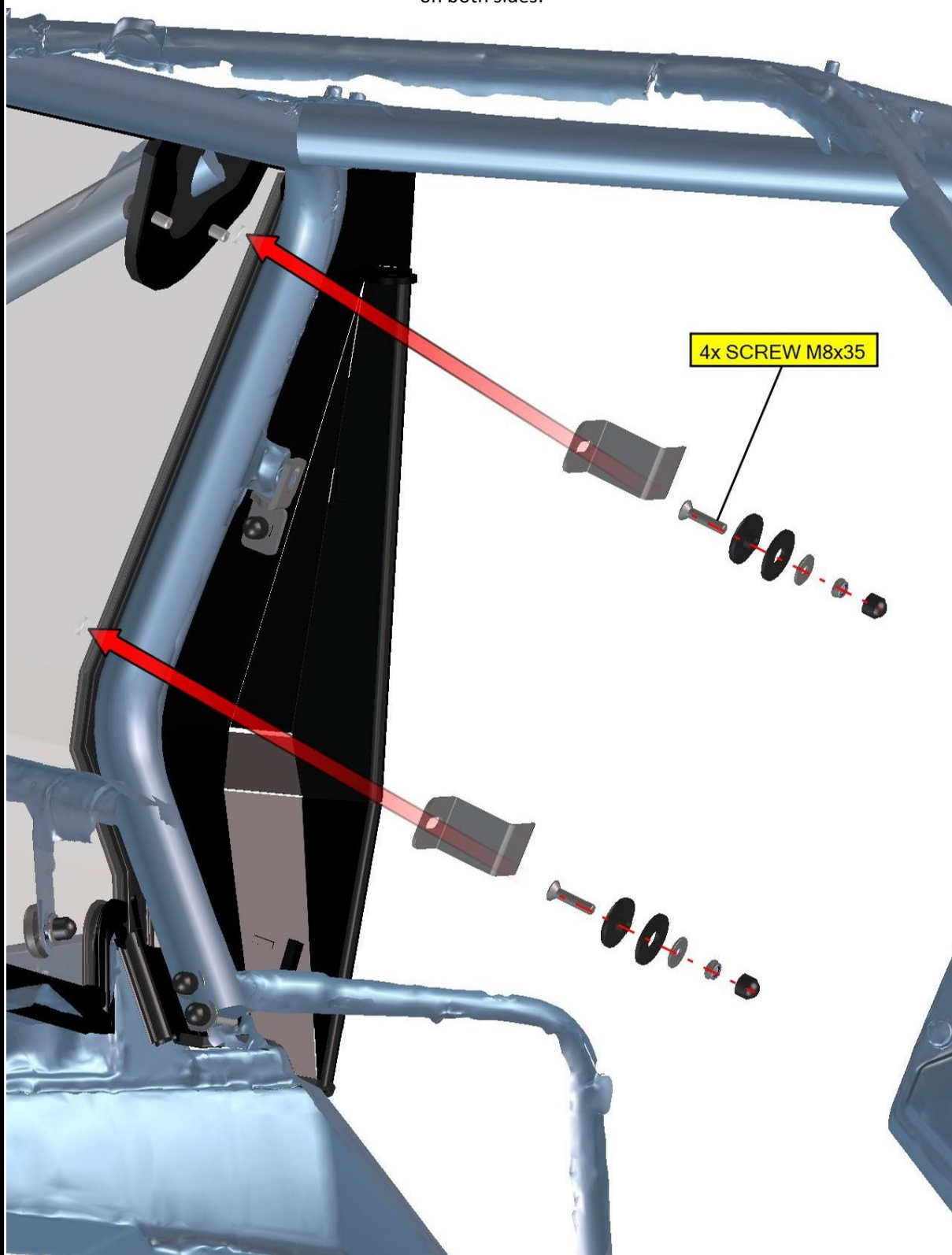

11

FRONT PANEL 1.

One by one uninstall original screws from UTV rollercage (red circle) and replace them from inner side on both sides. **DO NOT TIGHTEN.**



12

Place the front bottom ledge onto the UTV roller cage.

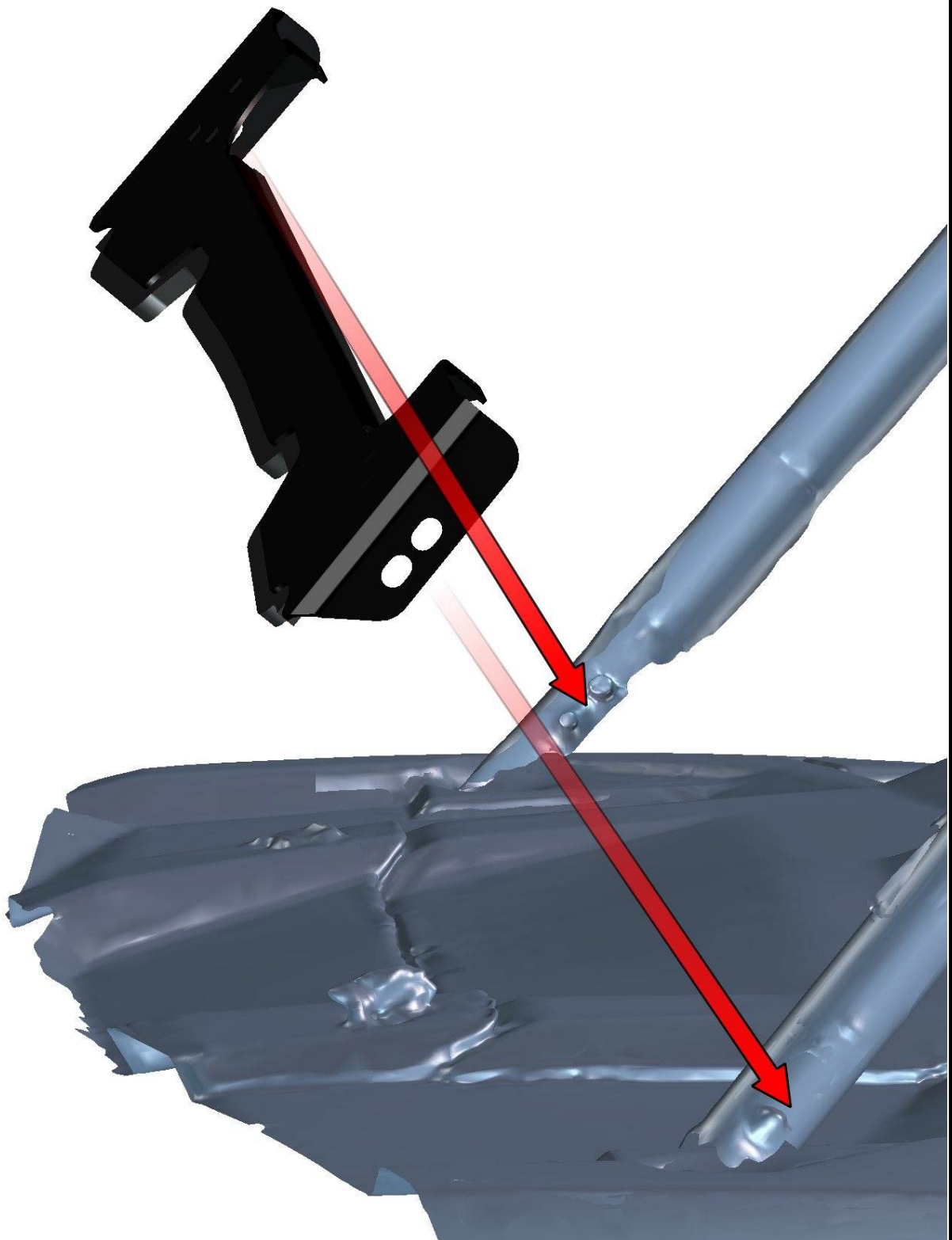

13

Fix the front bottom ledge with the UTV roller cage by original screws, washers and nuts on both sides.

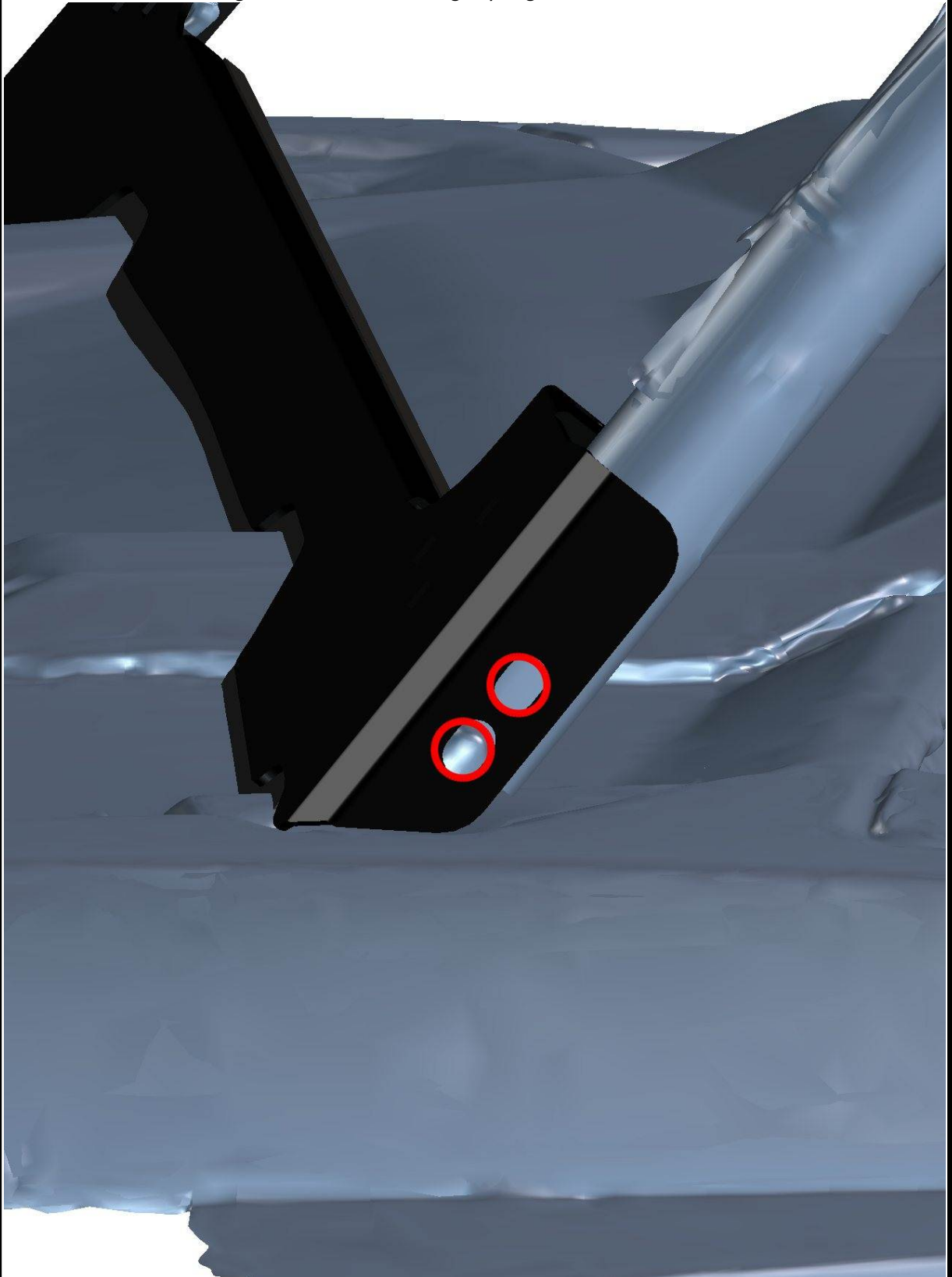

14

Place the front bottom ledge holder onto the front bottom ledge and fix by included screws, washers, nuts and covers.

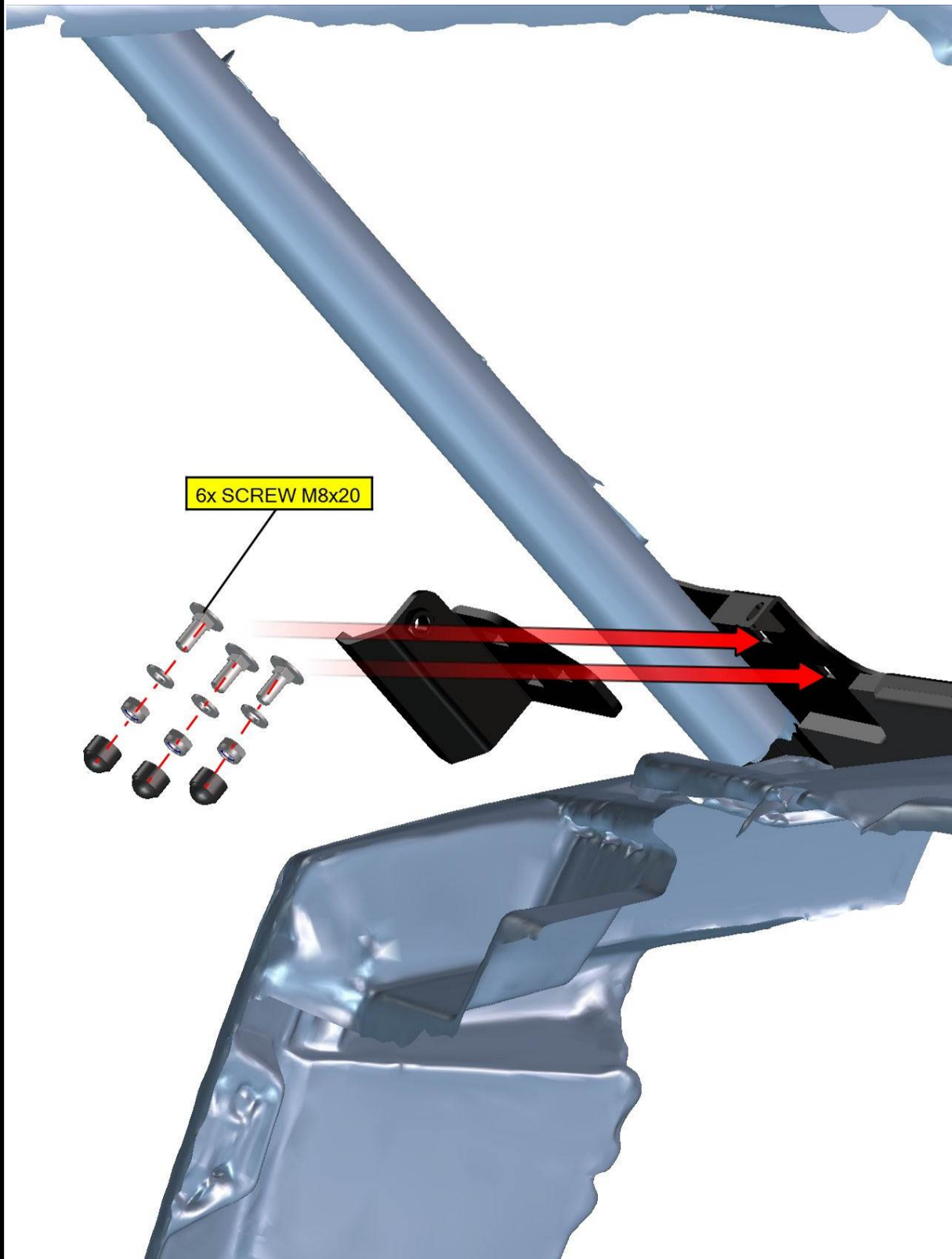

15

Place the front window lock assembly onto the front bottom ledge and fix by included screw, nut and washer.

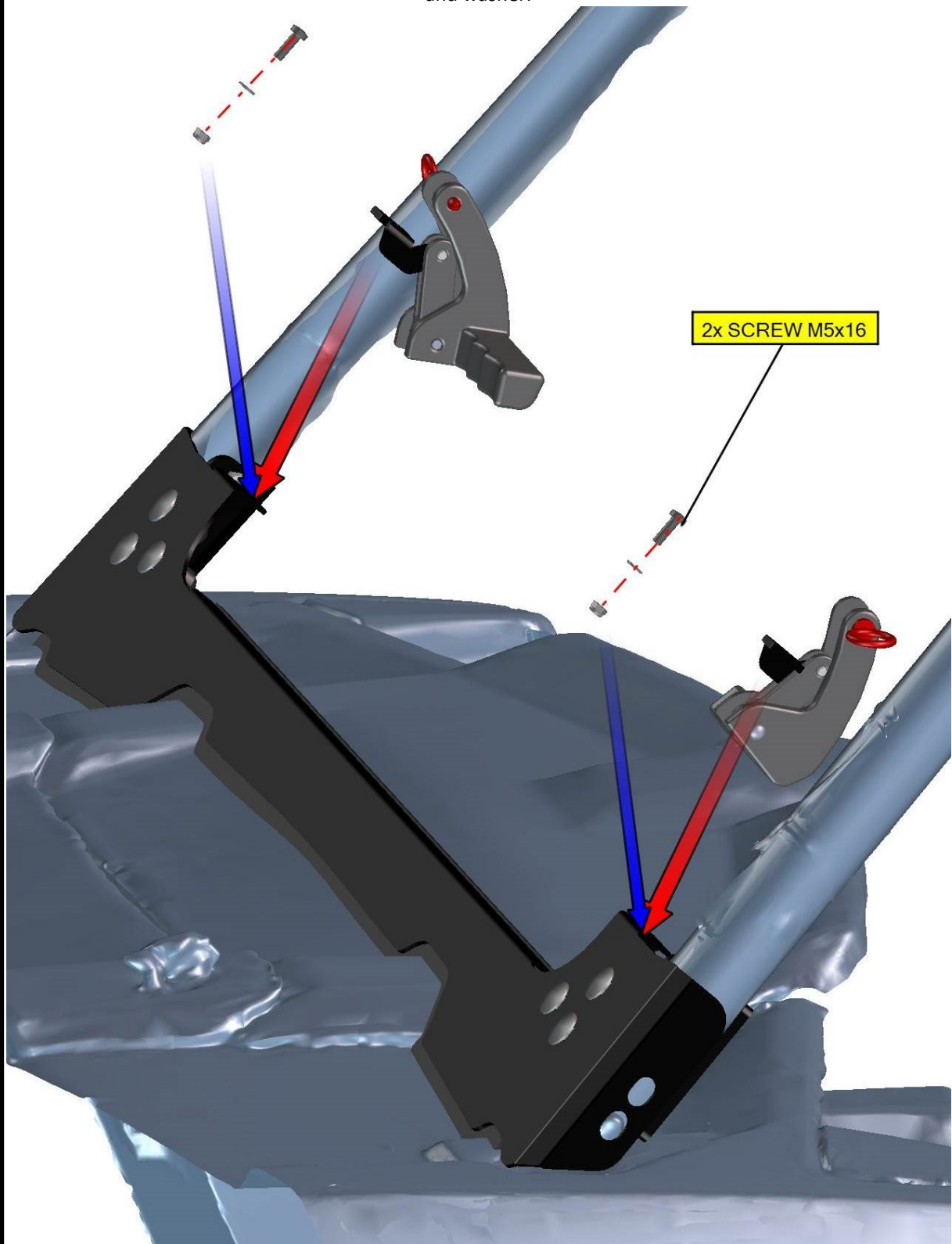

16

ELECTROINSTALLATION**WIPER SET**

View onto the wiper motor with the cover and with the middle ledge.



Place the washer onto the wiper longer pin.



Place the washer onto shorter wiper pin.



View onto installed washers.



18

Place the wiper assembly onto the front glass from inner side.
Insert these washers onto the wiper's pins and onto the glass from outer side.

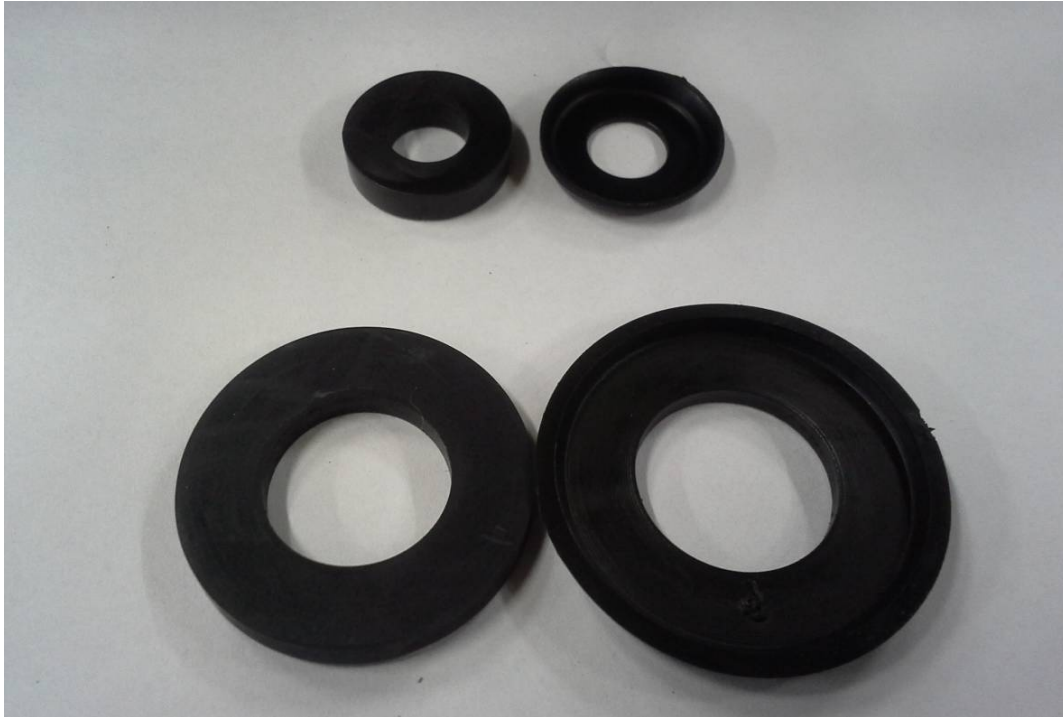

Fix the wiper motor with the front glass by included nuts and tighten these correctly.



FRONT PANEL 2.

Place the front glass assembly onto the front upper ledge by hinges and fix by included screws, washers, nuts and covers



20

Place the front window assembly onto the UTV roller cage and adjust into the best position.

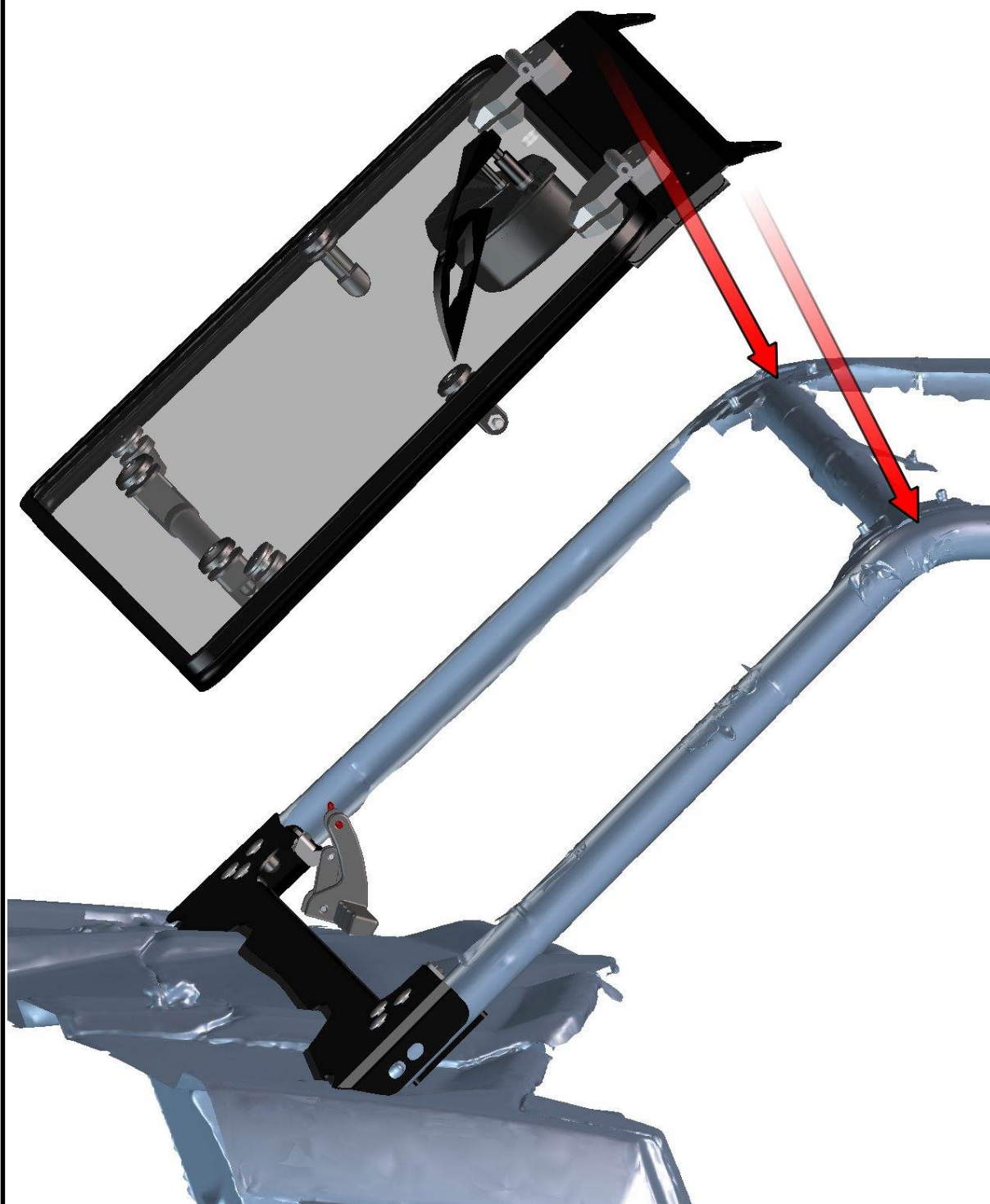

21

Fix the front upper ledge with the UTV roller cage by included screws, washers, nuts and covers.

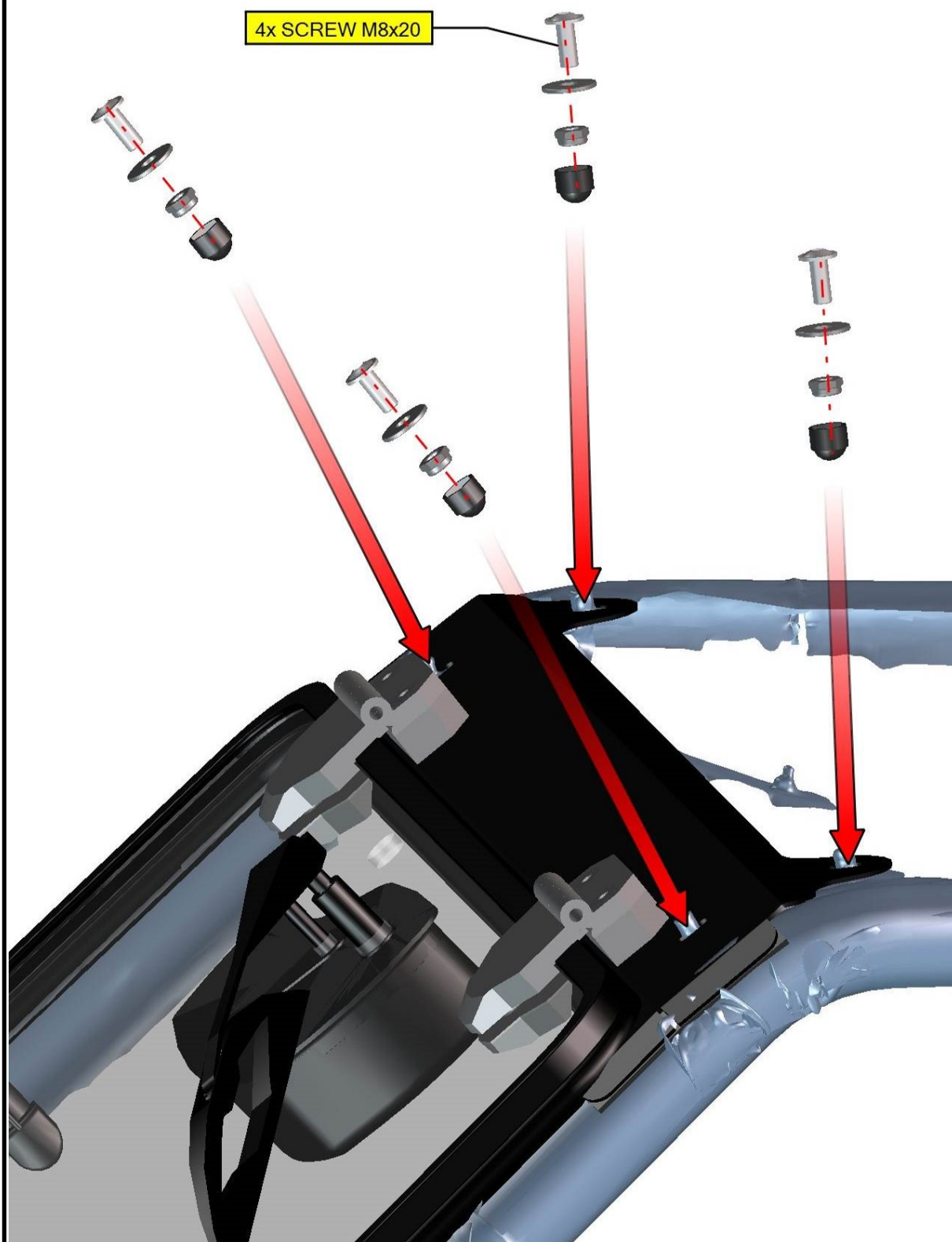

22

Adjust the front window lock into the best position by holder and tighten screw hard on both sides.

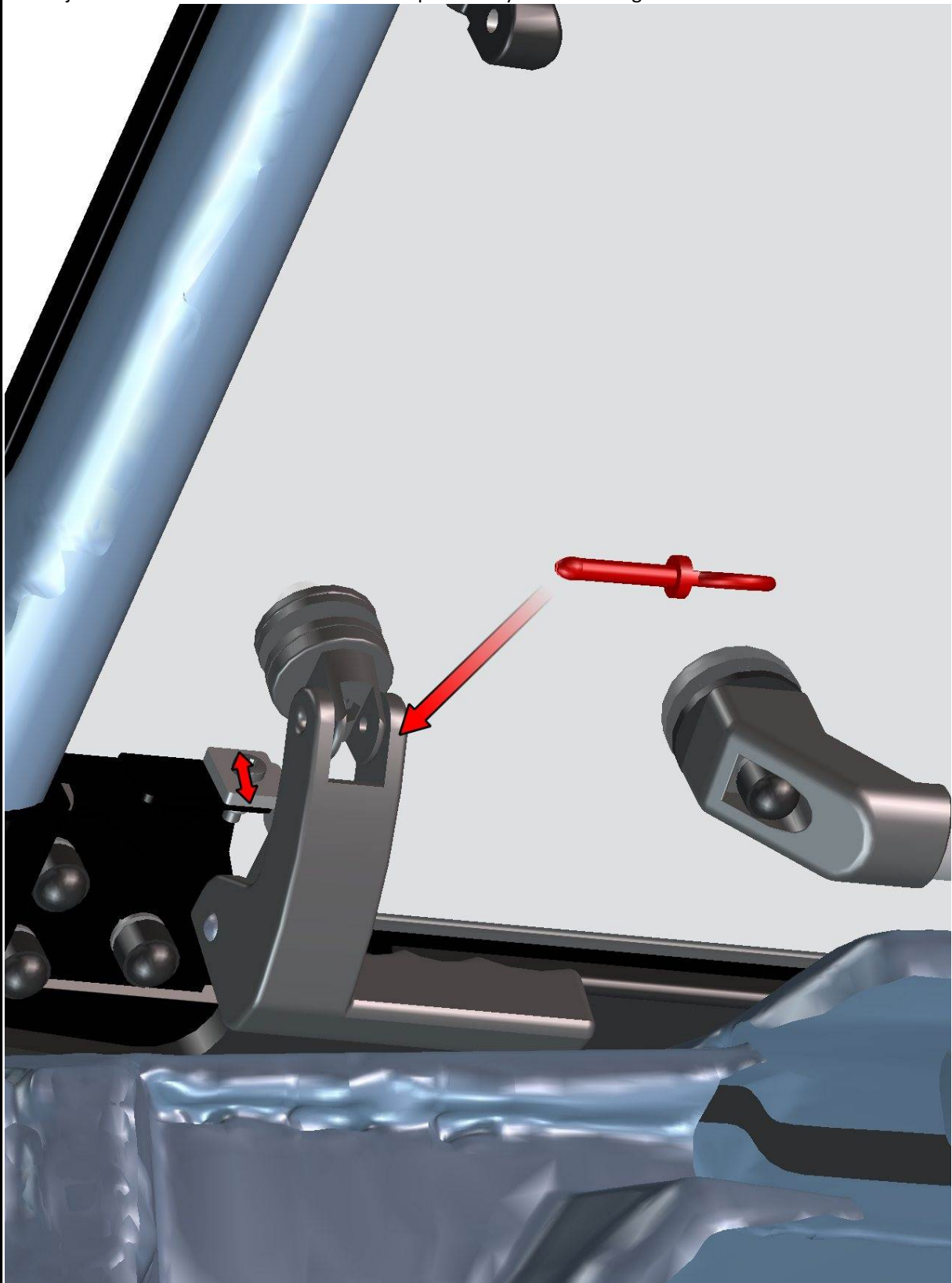

23

Install the front gas spring into the gas spring holders on both sides.



24

ROOF

Place the roof onto the UTV roller cage and adjust the roof into the best position.

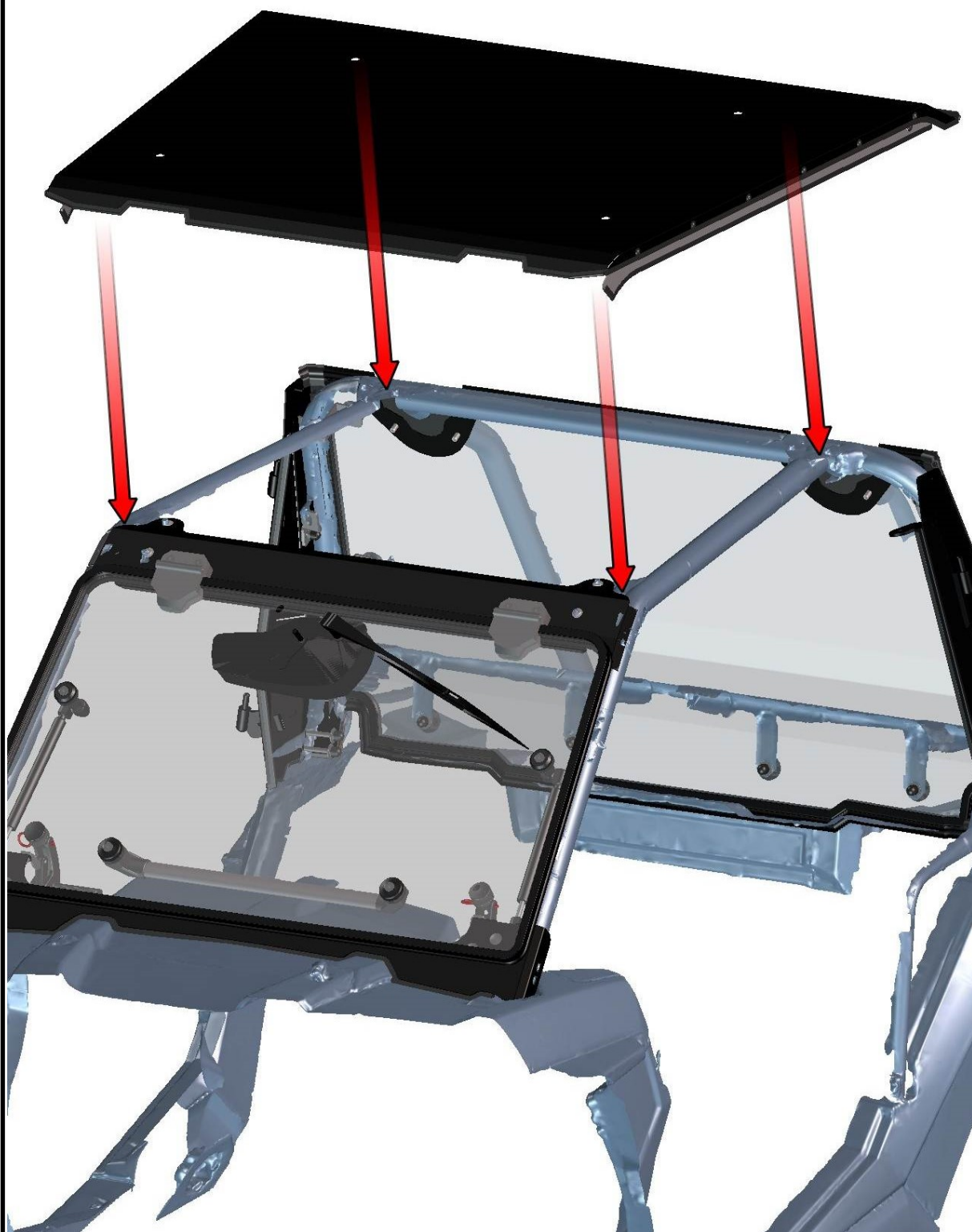

25

Fix the roof with the door base by included screw on both sides.

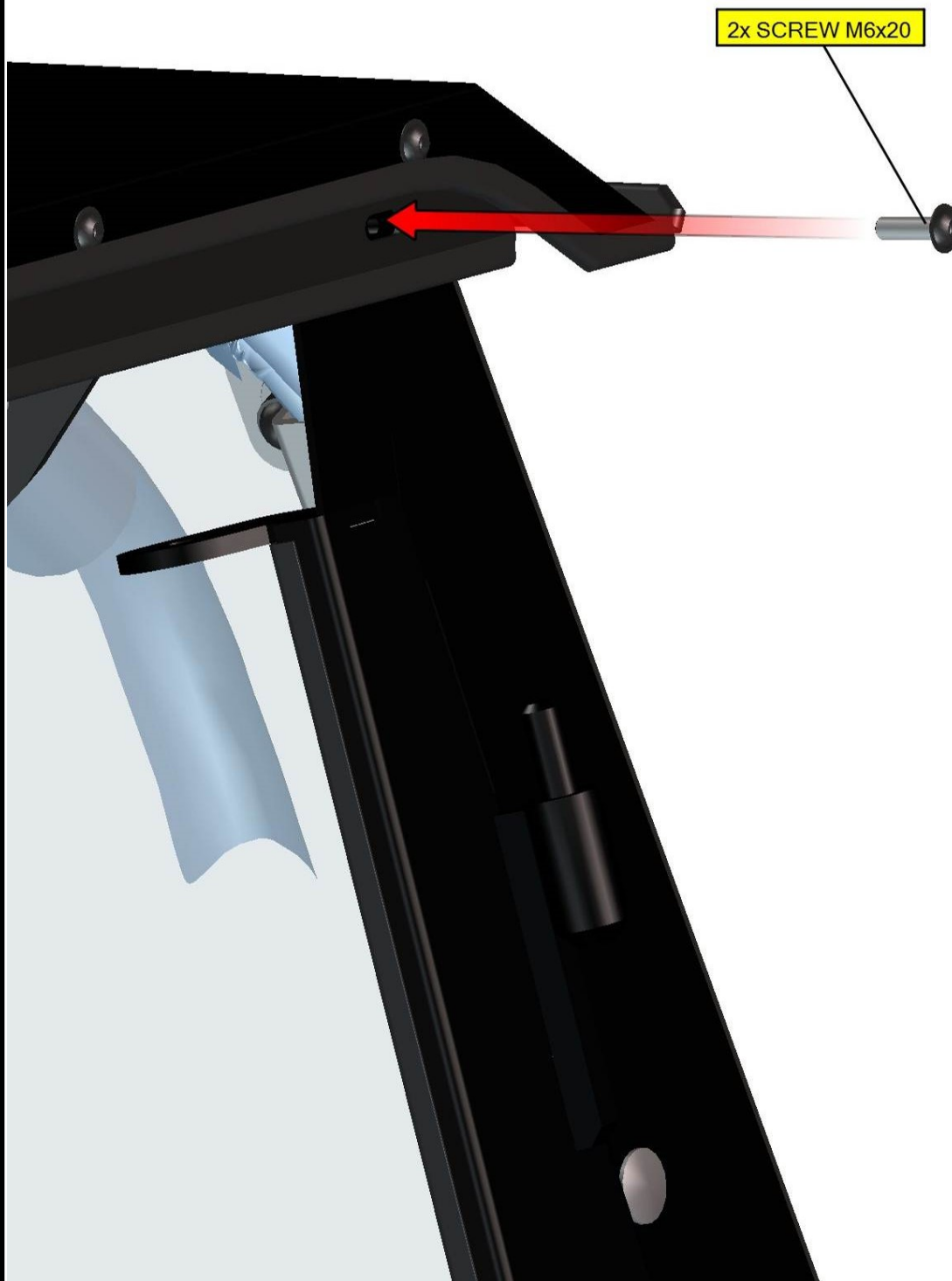

Fix the roof with the UTV roller cage by included holders, screws, washers and fast-lock handles on both sides.

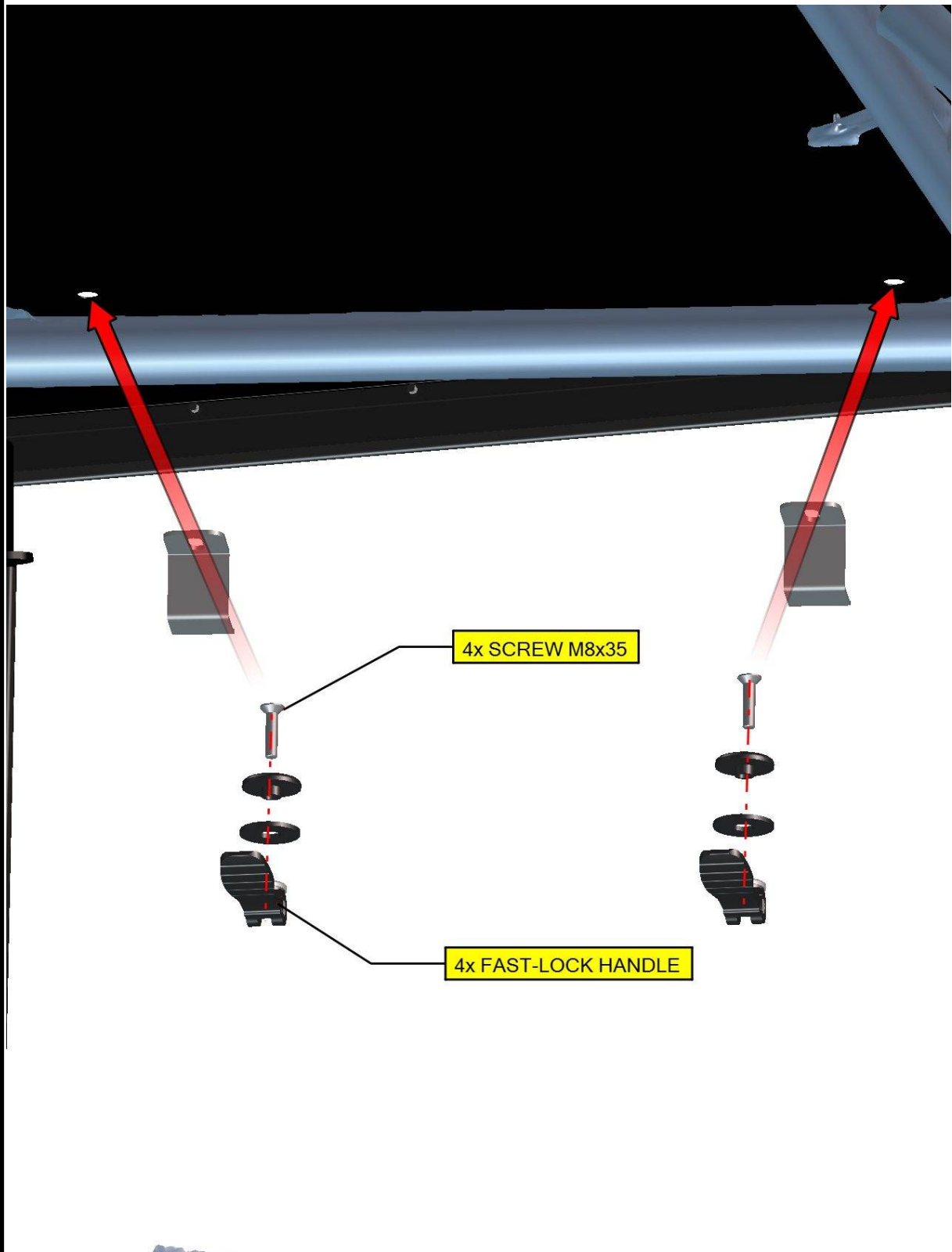

27

LEFT DOOR + RIGHT DOOR 2.

Install the door stop assembly into the left door stop holder. Fix the assembly with the door stop frame holder by included screws, washers, nuts and covers.

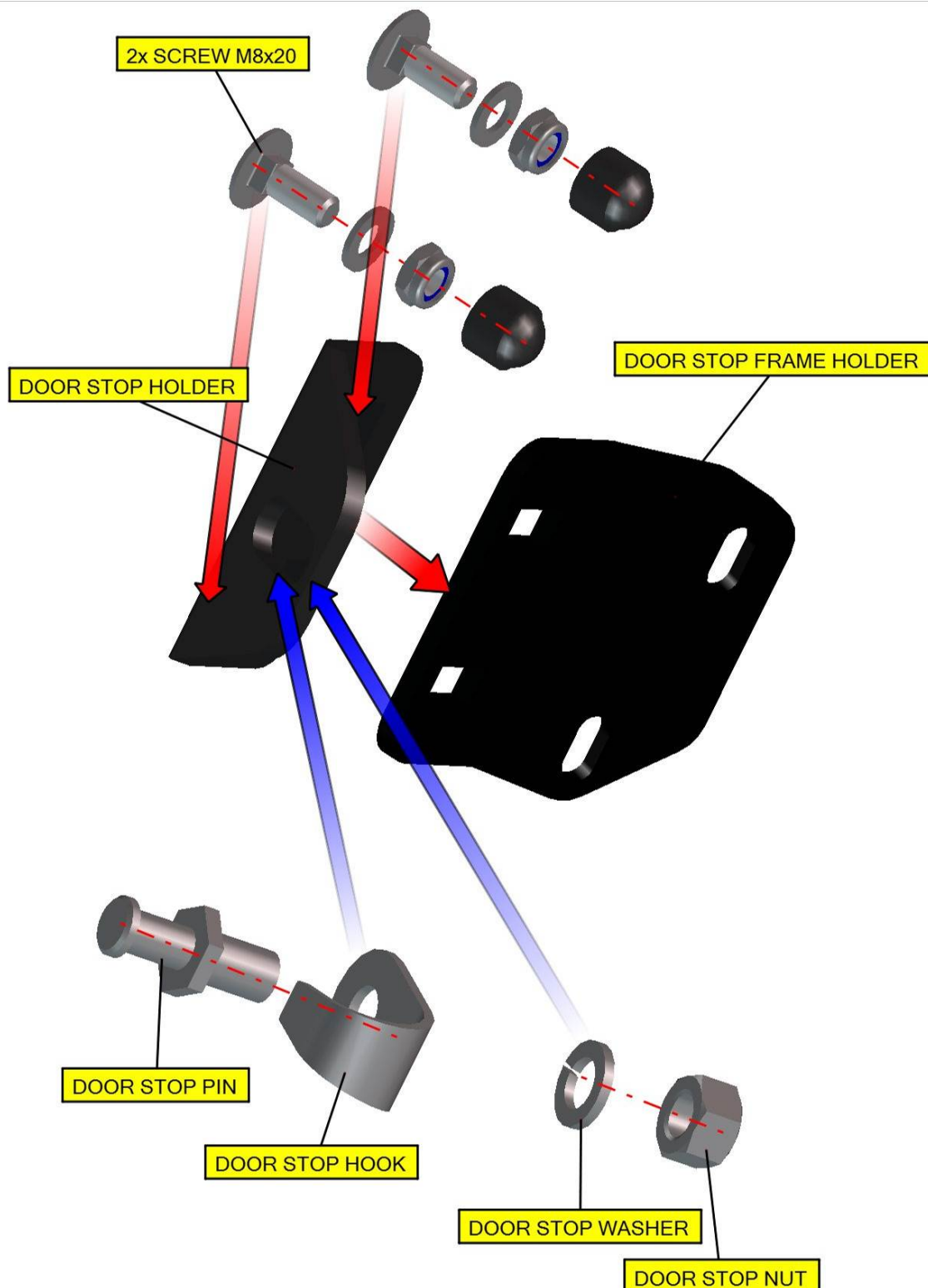

Place the left door stop assembly onto the UTV roller cage and fix by included, screws and washers.

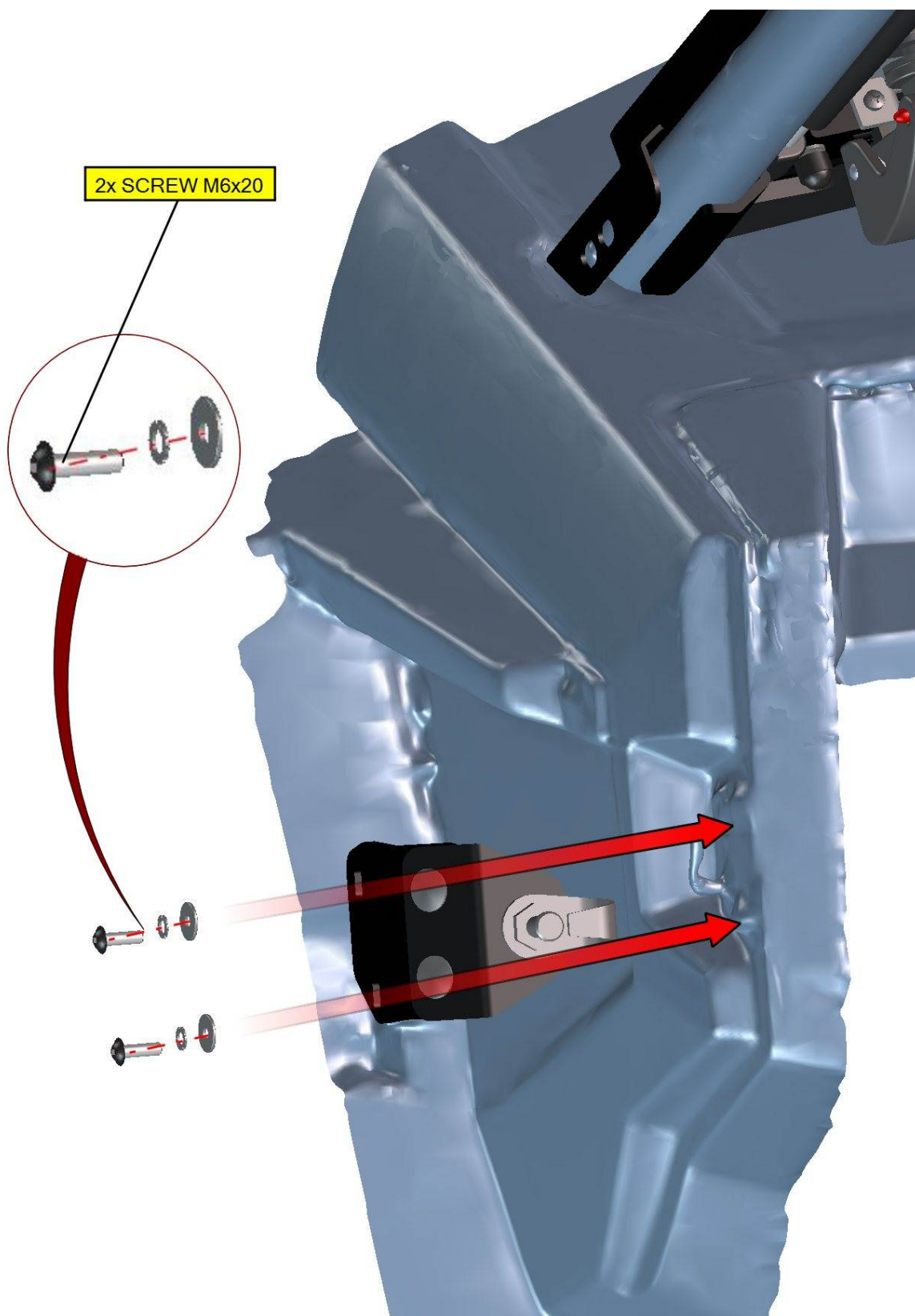

29

Lubricate the hinges pins and install washers onto the pins. Place the left door onto the hinges.

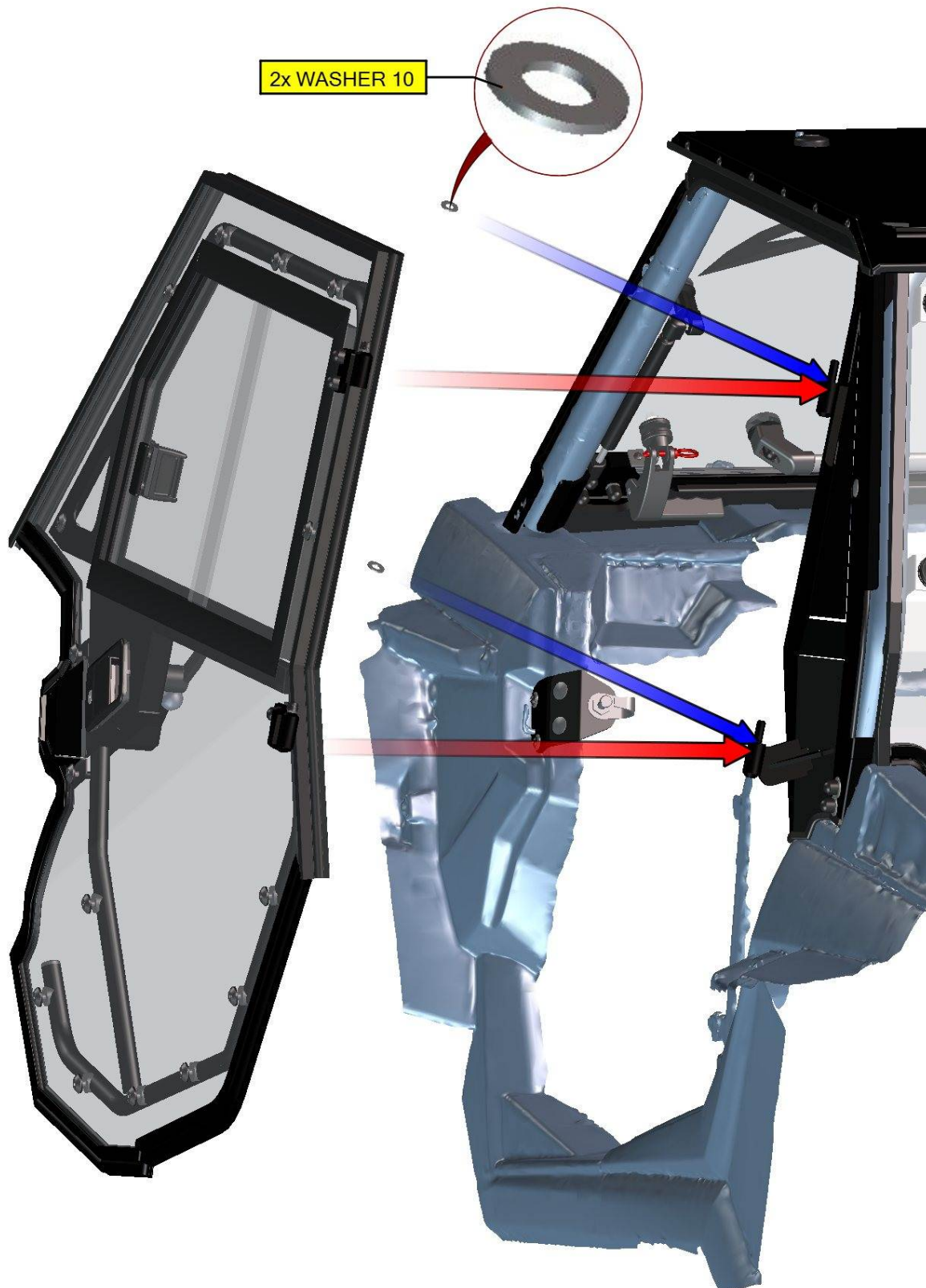

30

Adjust the left door into the best position by hinges and tighten screws carefully.

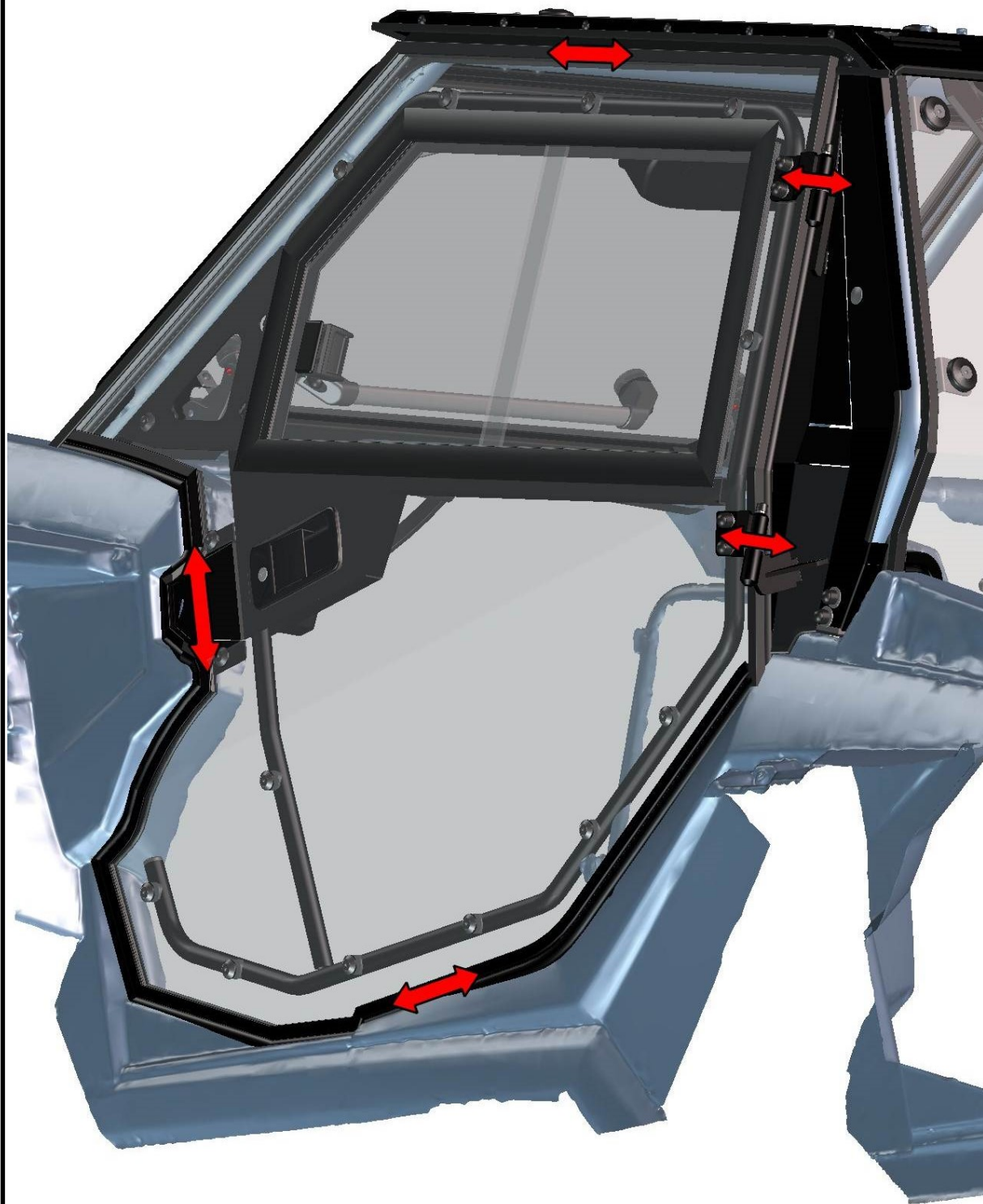

31

Adjust the door stop assembly into the best position.

If you close the door slowly and holder has been adjusted correctly, you can hear clear 2 metallic click.

If you have problems with adjusting the pin holders, you can adjust the door hinges again to better position.

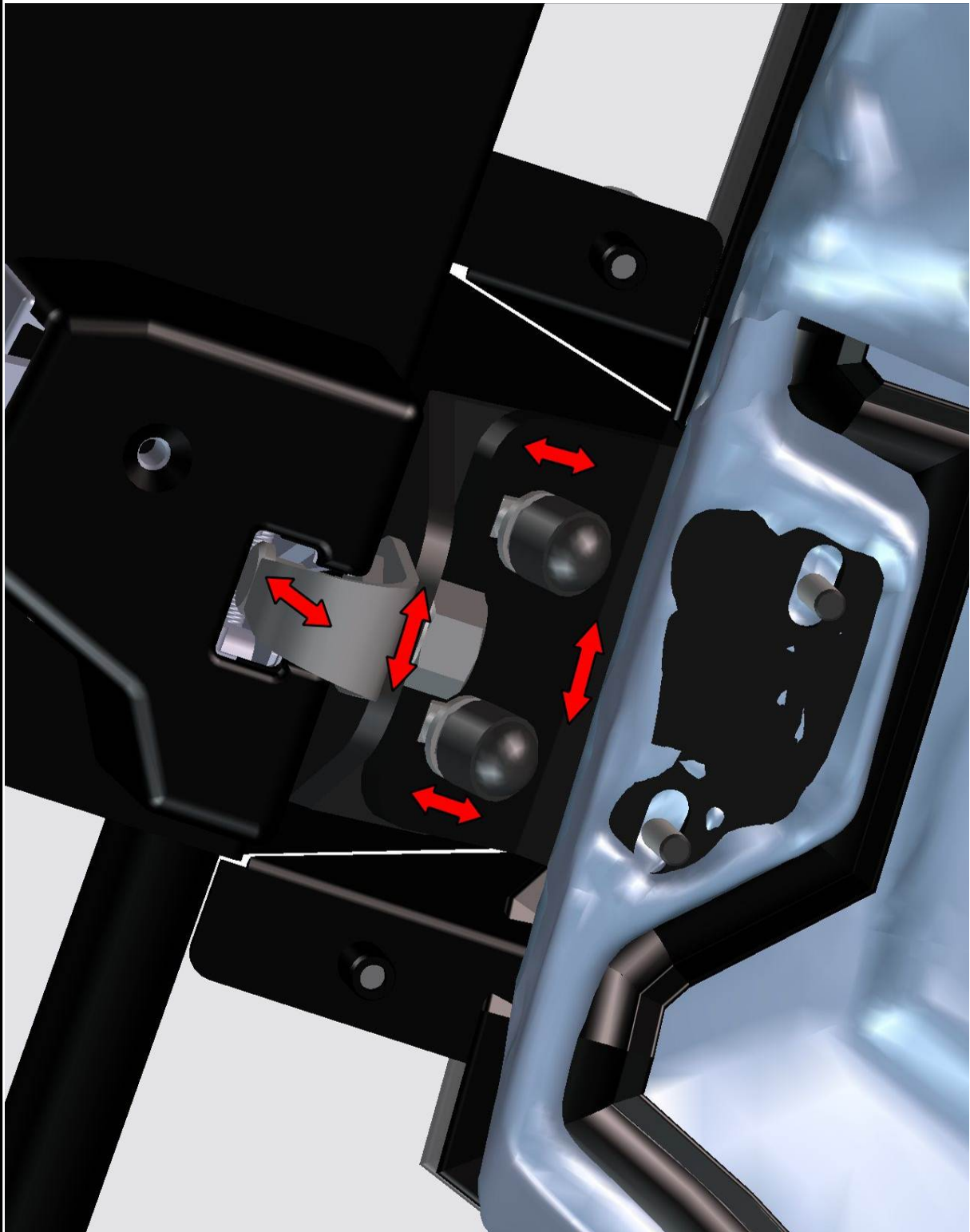

32

Install the door gas spring into the gas spring holders and fix by included nuts and covers.

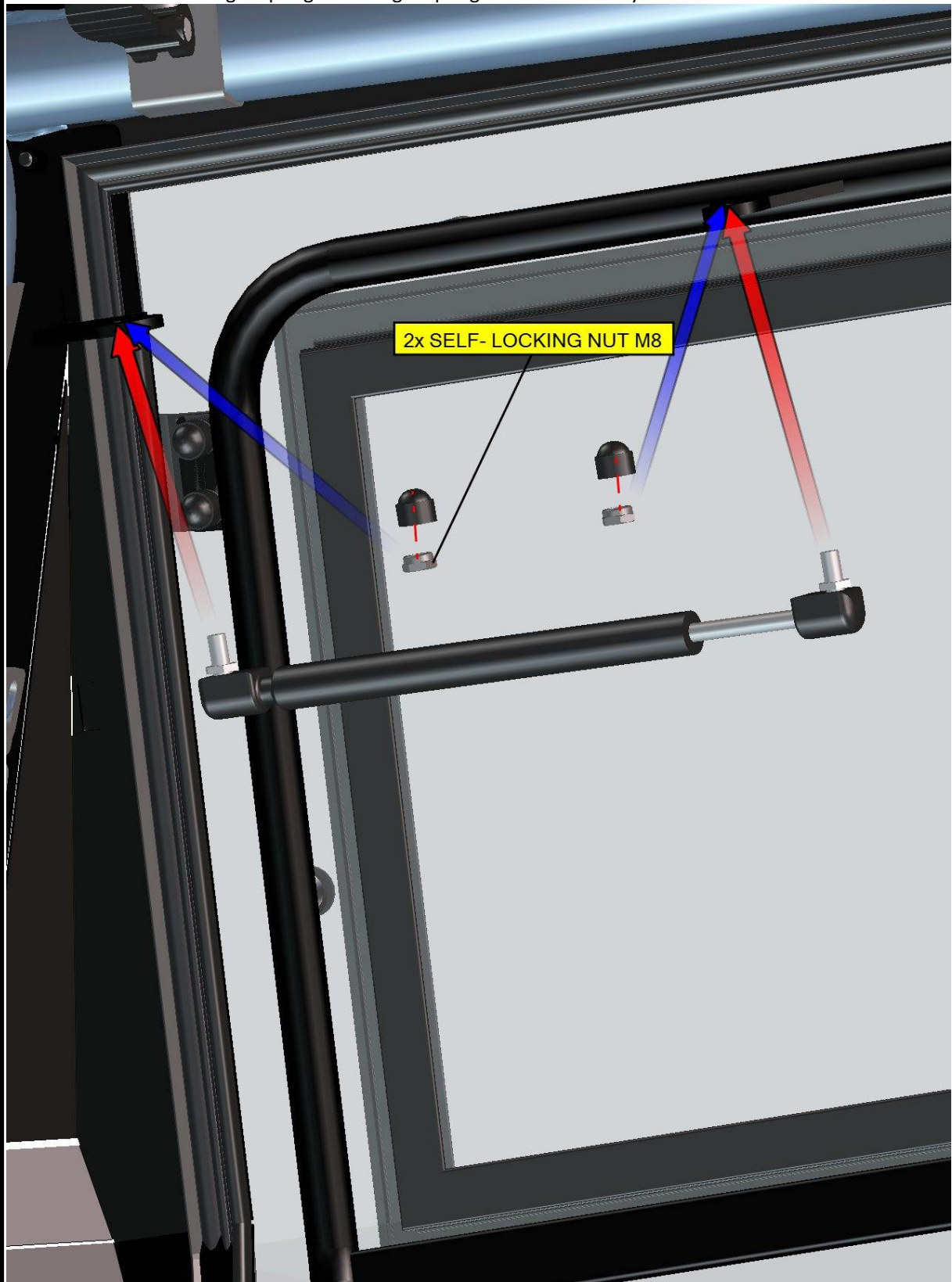

33

Place the left mirror onto the left mirror holder and fix by included screws, washers, nuts and covers.

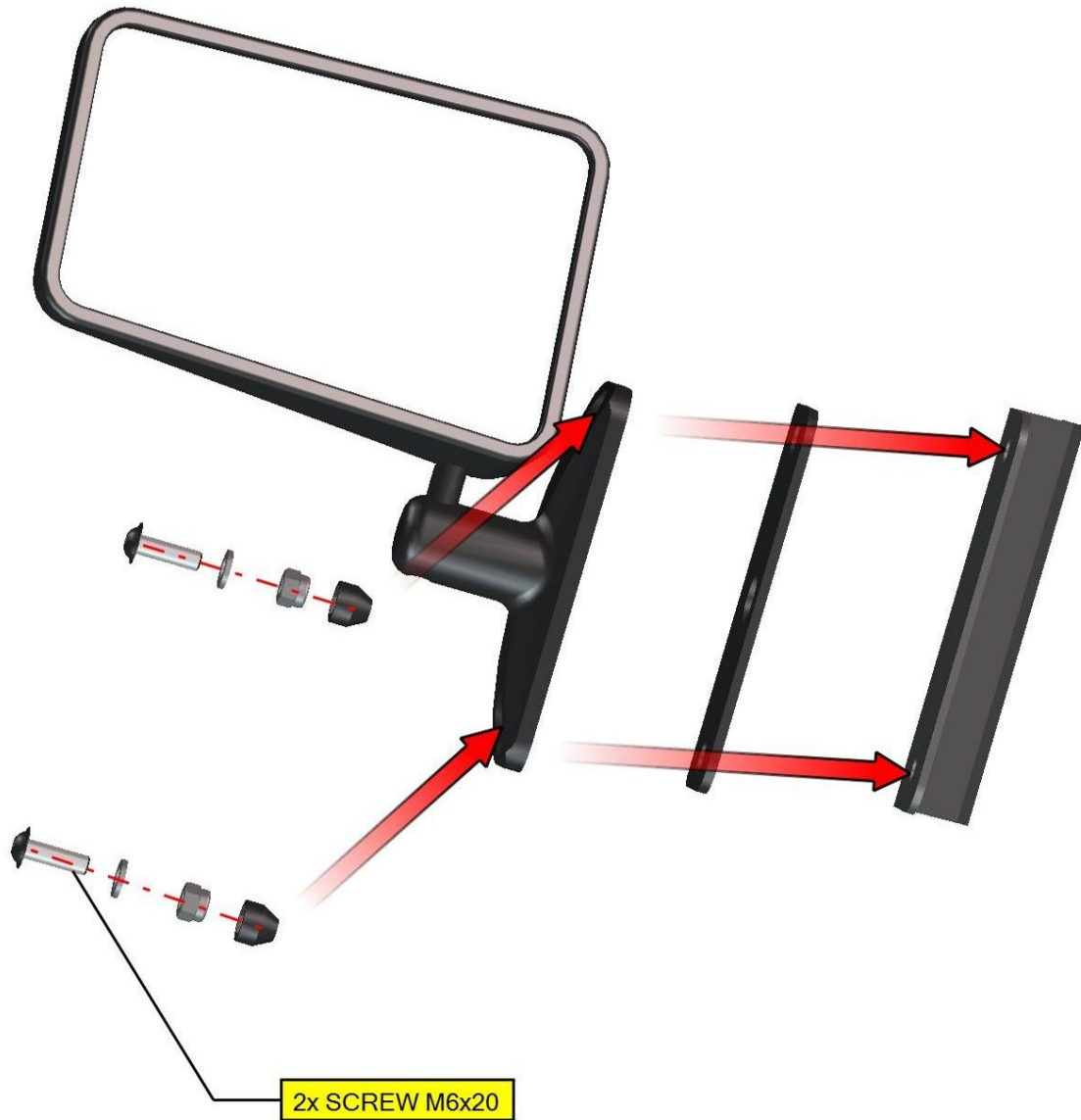

34

Place the mirror assembly onto the left door and fix by included screws and washers.

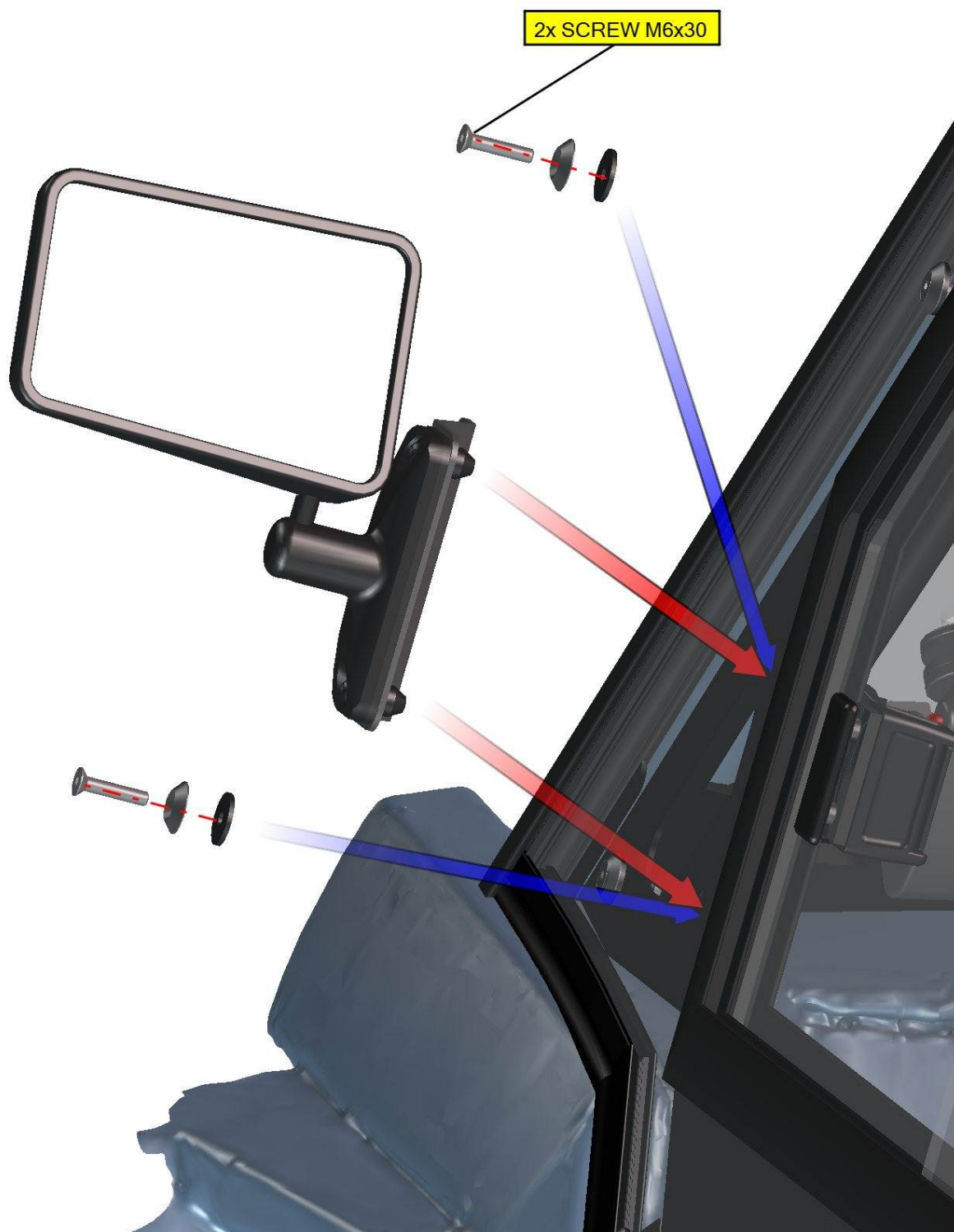

35

Repeat previous steps with the right door.

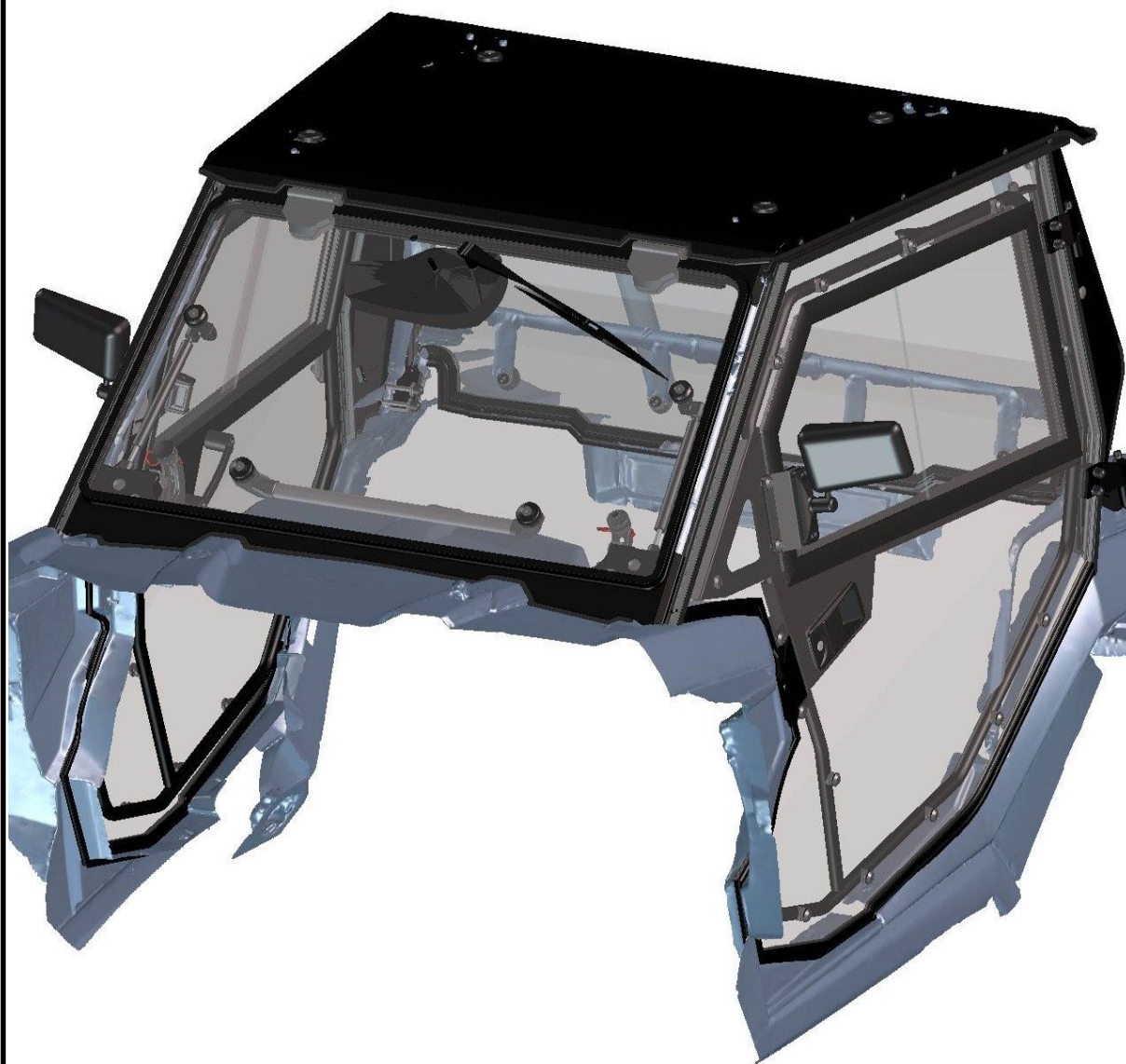

36

WIPER/WASHER

FRONT WIPER MOTOR

BLACK

GREEN

RED

YELLOW

WHITE

510

+ **-**

Parts needed (Included)

Washer tube



Switch wiper/washer/off



Harness and washer tank



Install the washer tank to the UTV by washer tank holder and correct screw, washers and nut (included).

Run the harness branch No.: 2 from the harness to the dashboard inner space.

Find the best place for wiper/washer switch and cut rectangle hole for that.

Connect the harness branch No.: 2 with the switch and insert that into the hole.

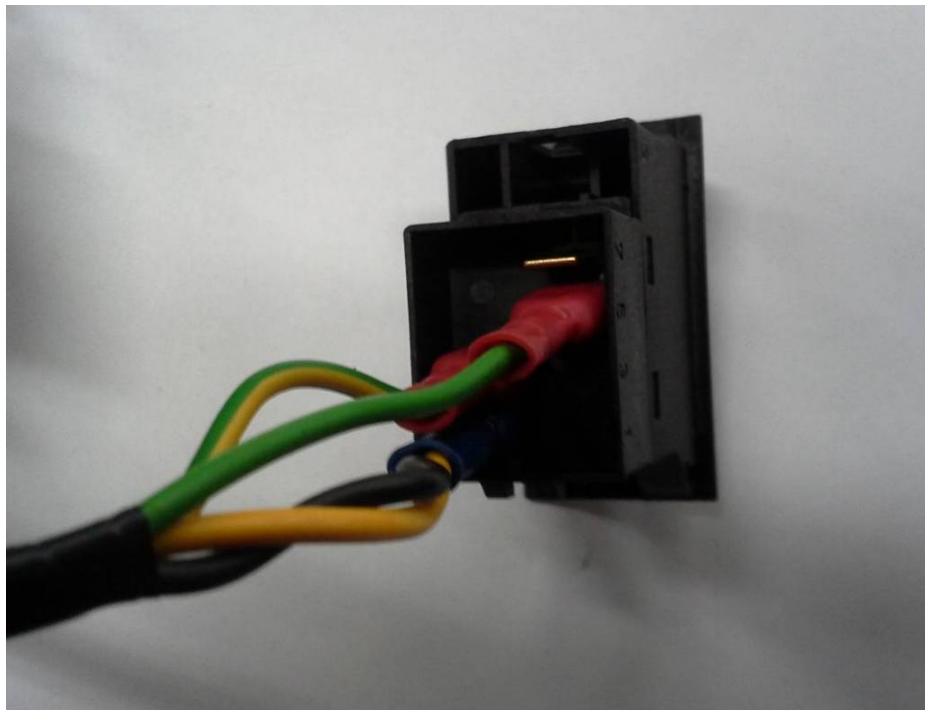

Run the harness branch No.:1 around the roller cage to the wiper motor.

Connect the harness branch No.:1 with the wiper motor and stretch the washer hose through the bushing.

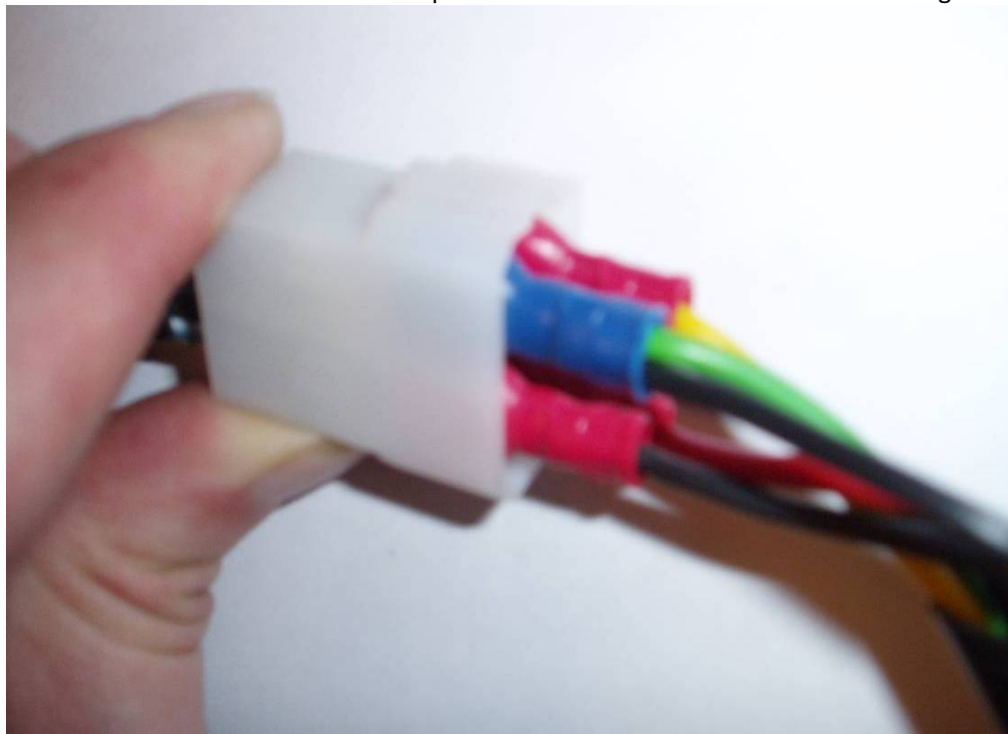

Run the harness branch No.: 4 from the harness to the UTV's main electrification.

Find the original cable where is 12V+ after you turn on the main UTV's switch.

Connect the harness cables, red to 12V+original electrification and black to UTV's skelet.

If you don't find connection for connectors installed on harness branch, you can use other connectors (included). Fill the washer liquide into the washer tank before first usage.

SEE NEXT PAGES

Now you can turn on wiper switch and look on the larger wiper pin.
If you connect all harness connectors correctly, pin is turning. Find the ends of turning and install the wiper arm on correct position.



Fix the wiper arm with the wiper motor pin by included nut.
Insert plastic holder onto the wiper latch pin in correct position



Push onto the installed plastic holder.



Insert the wiper arm hook onto the wiper latch plastic holder and press it into the correct position.



Push onto installed wiper arm hook.



Connect the washer hose from the harness with the washer hose from wiper arm by included tube.



HEATER

Overall wiring diagram (heater)

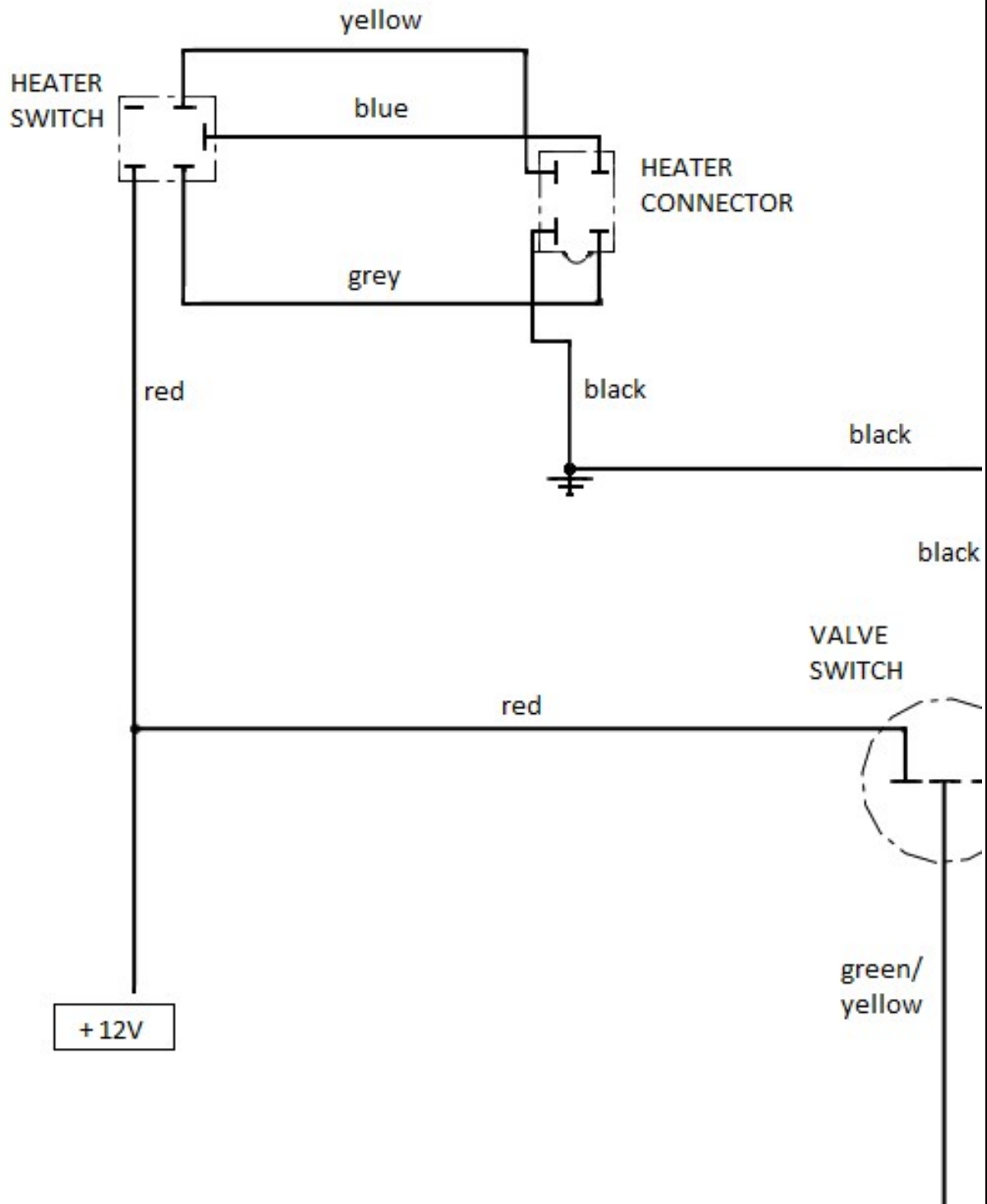

44

Parts needed (included)

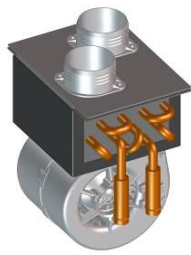

Heater with cover



Bleeding valve

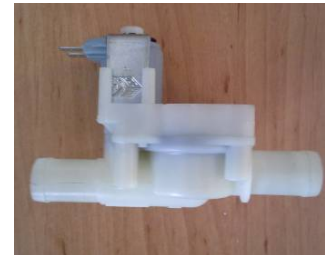

Electric vent



Tightening straps
Small, medium and large



Hot water hose



Air vent



Hot air hose



AL tape



Curved hose

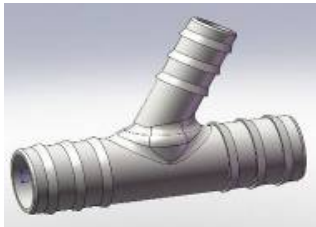

Y couplings



El. Vent switch



**Heater switch
assembly**



Heater harness

46

IMPORTANT

IT IS ABSOLUTELY NECESSARY TO TAKE OUT THE RUBBER PLUGS FROM THE HEATER TUBES!!!

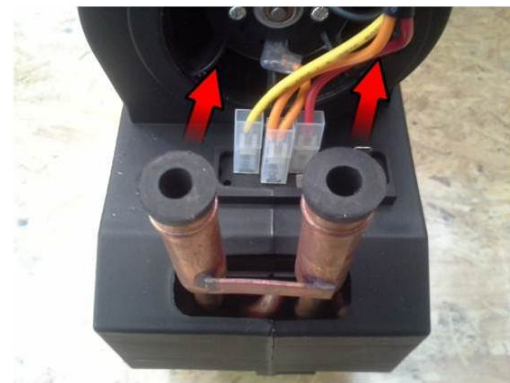
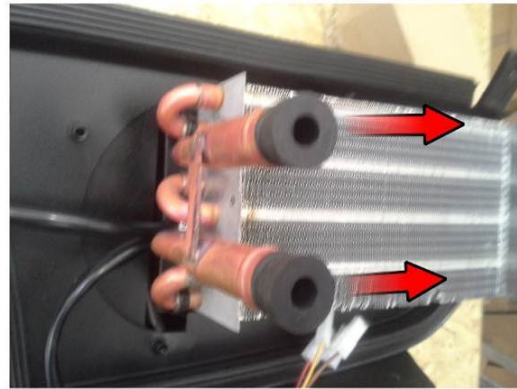
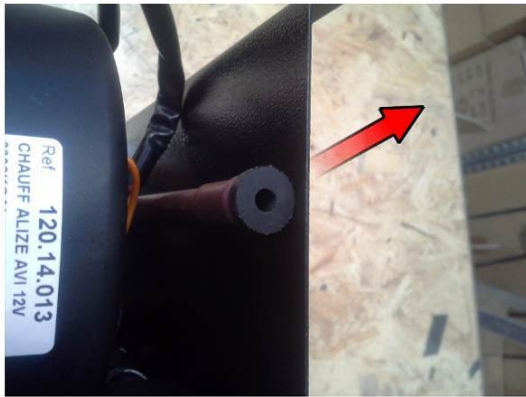

Install the heater with the heater holder to best position (where you like these) and fix these with the UTV's body by correct screws. Connect harness branch No.: 3 with the heater connector.

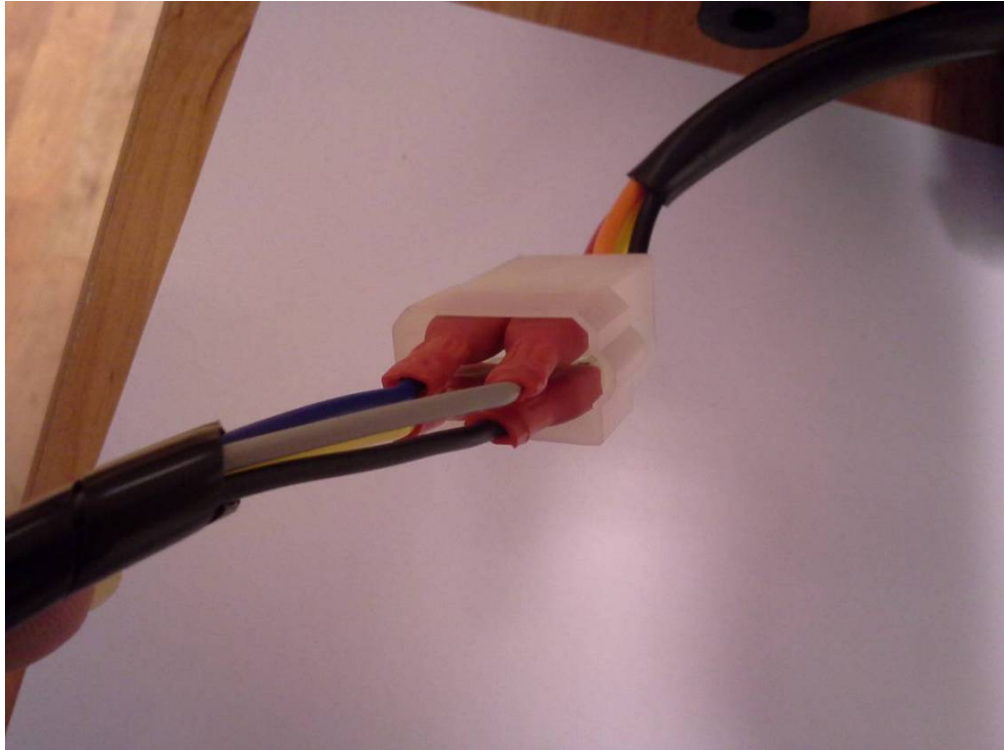

Connect the harness branch No.: 4 with the electromagnetic vent.

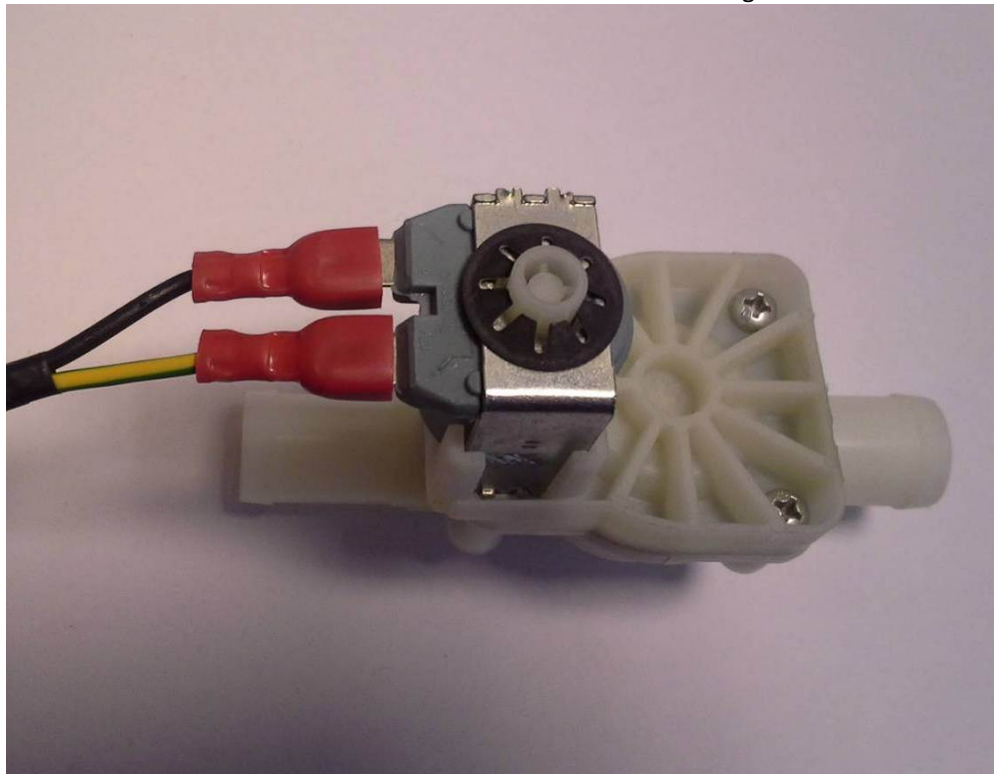

Drill 1 hole \varnothing 11,5-14mm (0,45-0,55 in) and 2 holes \varnothing 2,5-4 mm (0,1- 0,16 in) into the dashboard in accordance with the ventilator switch base. Be very carefull to find best place for switches.

Lead the harness branches No.:1 and 2 from the heater to the UTV switch panel.

Connect the heater switch body with the harness branch No.:1. Detail view.

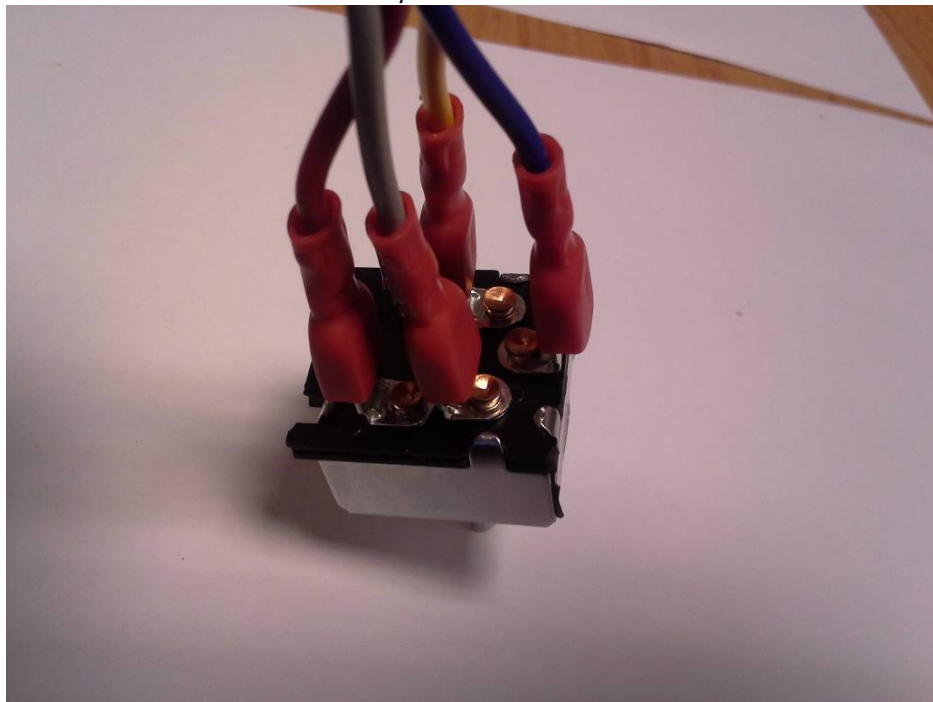

Drill hole \varnothing 21 mm for electromagnetic vent switch into the dashboard.

Pull the harness branch No.: 2 through the hole from previous step and connect the branch with the switch. Detail of connection.

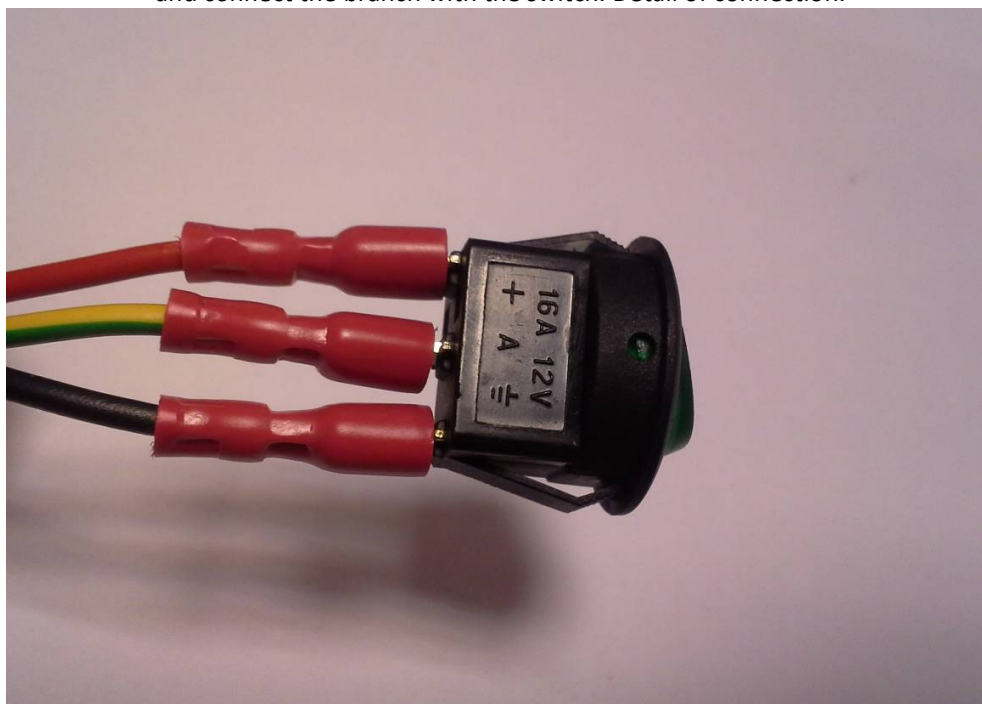

Run the harness branch No.: 5 from the harness to the UTV's main electrification.

Find the original cable where is 12V+ after you turn on the main UTV's switch.

Connect the harness cables, red to 12V+original electrification and black to UTV's skelet.

If you don't find connection for connectors installed on harness branch, you can use other connectors (included).

Connect hot water hoses with the UTV's cooling circuit near the cooler by pair of "Y" coupling (included).
If you have detailed information about engine cooling circuite and you are sure about correct connection, you can make that.

SEE NEXT PAGE

It is absolutely necessary to bleed the air out of the UTV's engine cooling system. Incomplete bleeding of cooling system can result in engine damage. If you don't have sufficient experience with this process, we strongly recommend professional service technician assistance. We are not responsible for damages when cooling system bled incompletely. Please note that additional heater system will absorb more than 2 liters of coolant fluid.

- 1. Important: After the heater system installed check the system for leaks. Turn on the electric vent switch and confirm that the engine is cold. Start the engine, open bleeding valve and wait until engine warms up. Important: Always check engine temperature – if it overheats turn off engine.***
- 2. To achieve engine operating temperature depress the accelerator to increase The engine RPM. This will increase the pressure and flow of the water pump forcing more coolant through the heater. After operating temperature reached turn off engine and open it. Trapped air should come out from heater system throughout bleeding valve. Repeat this procedure until heater/cooling system is completely bled out.***

The DFK Cab heater, like the heater in a car, generates heat from the vehicle's engine.

In nearly all cases, the heater should generate enough heat from your UTV, side by side, or tractor engine that you may need to turn the heater off periodically otherwise the air in the cabin may be too hot.

It is important to check the coolant level regularly at least 4-5 times during the first several days of operation and fill as necessary until the coolant level has stabilized. The heater will draw and retain coolant, sometimes at the expense of coolant to the engine. This can cause engine overheating if not managed properly.