



INSTALLATION INSTRUCTIONS

KYMCO

500I, 700I SE

TOOLS NEEDED

Not included



Ratchet handle



**Socket beg 13 mm
(0,51 in)**



Hex key 5 and 6mm



Metric wrench 13mm



Screwdriver philips



Utility knife



**Isolating tape
clear OR black**

PREPARATION FOR INSTALLATION:

Uninstall all additional systems from the roller cages (work lights, rear mirrors, drink holders etc.)

Uninstall the original seats from the UTV, and install seats back by second holes (in red circles).
This change will move the seats about 1 inch closer to driving-wheel



CAB PREVIEW

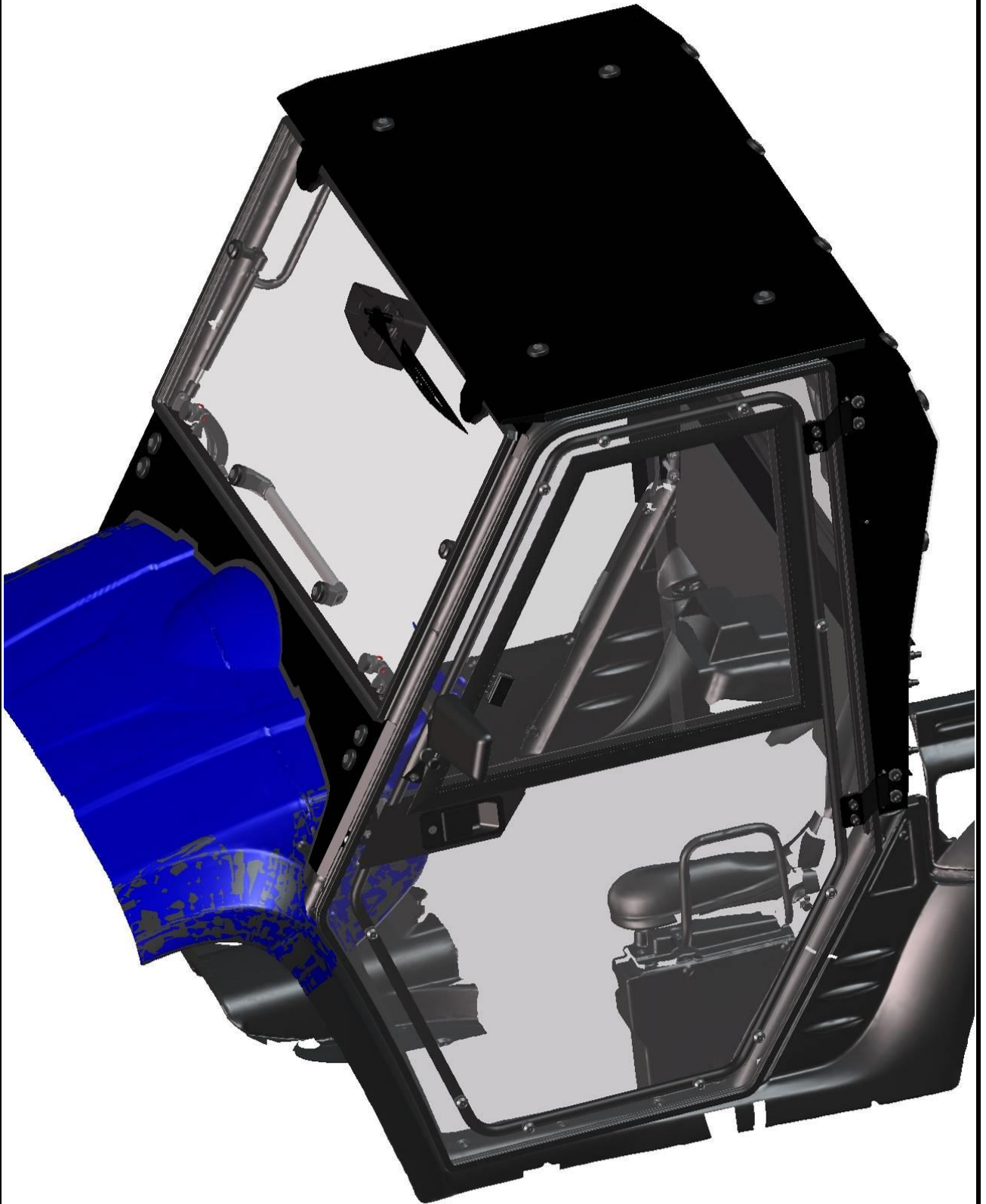

DOOR BASE (LEFT + RIGHT)



FOR ALL TECHNICAL QUESTIONS, PLEASE CALL
DFK AMERICA INC.
(630) 324-6793

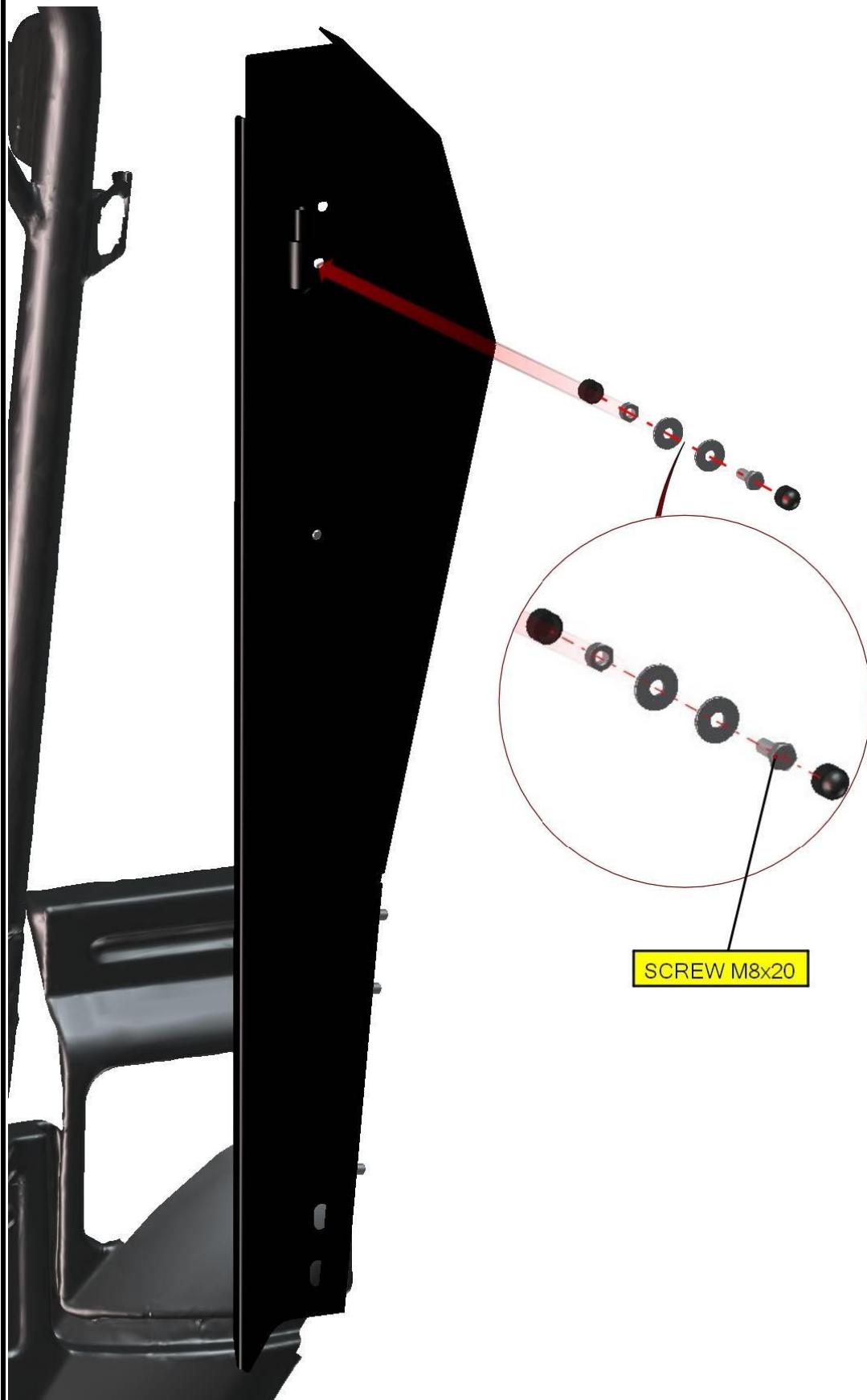



FOR ALL TECHNICAL QUESTIONS, PLEASE CALL
DFK AMERICA INC.
(630) 324-6793





FOR ALL TECHNICAL QUESTIONS, PLEASE CALL
DFK AMERICA INC.
(630) 324-6793



10

FOR ALL TECHNICAL QUESTIONS, PLEASE CALL
DFK AMERICA INC.
(630) 324-6793

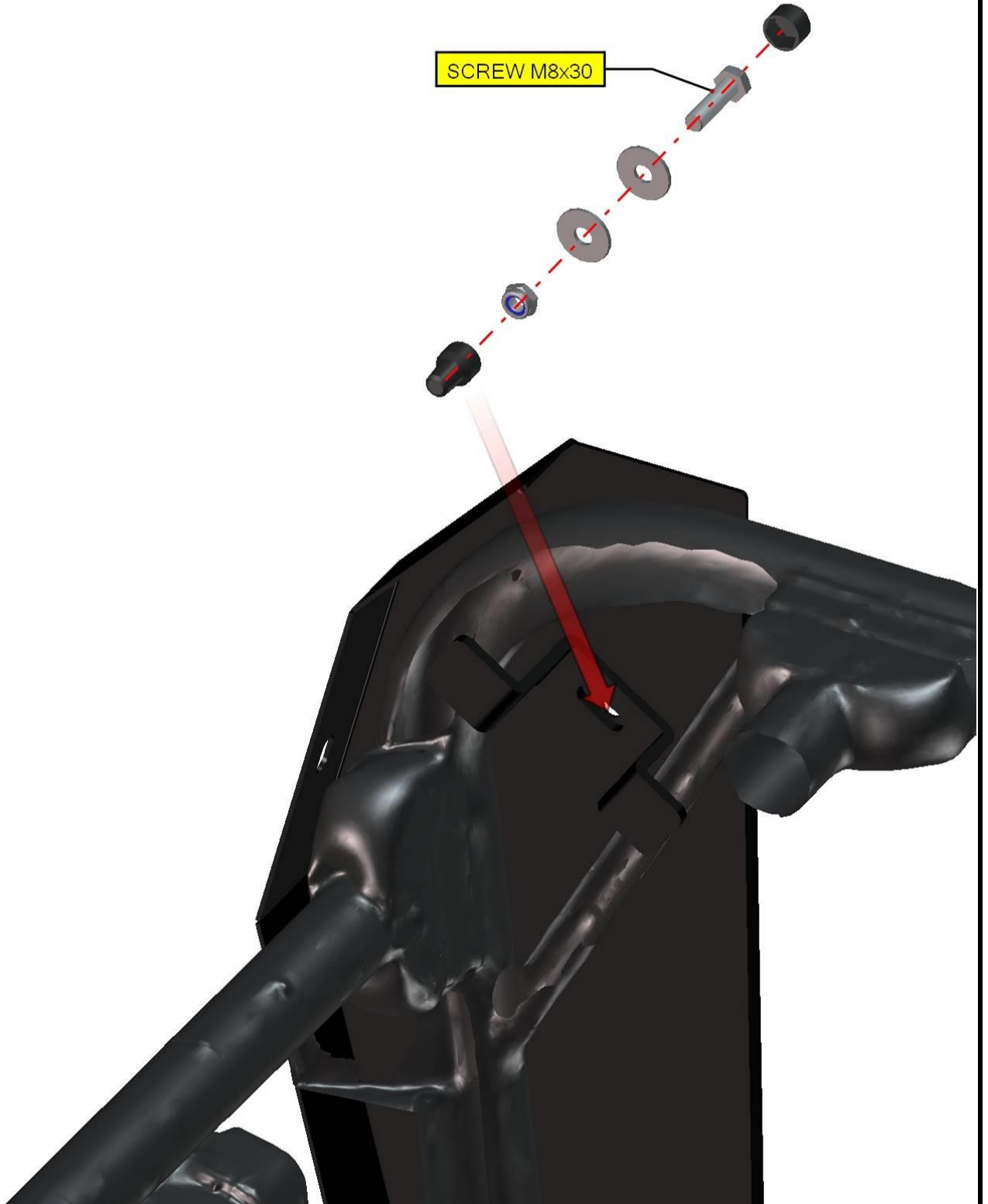

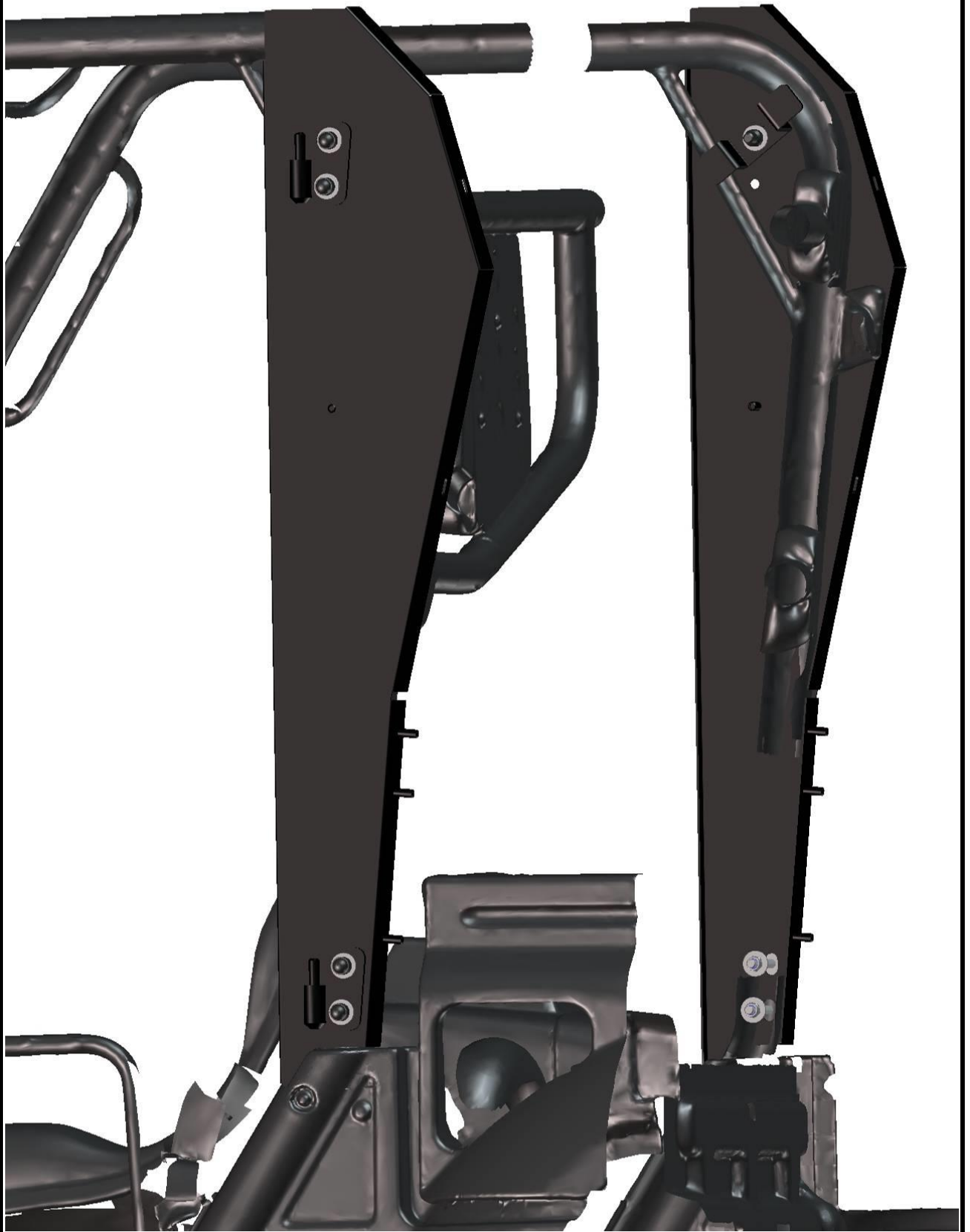

FOR ALL TECHNICAL QUESTIONS, PLEASE CALL
DFK AMERICA INC.
(630) 324-6793

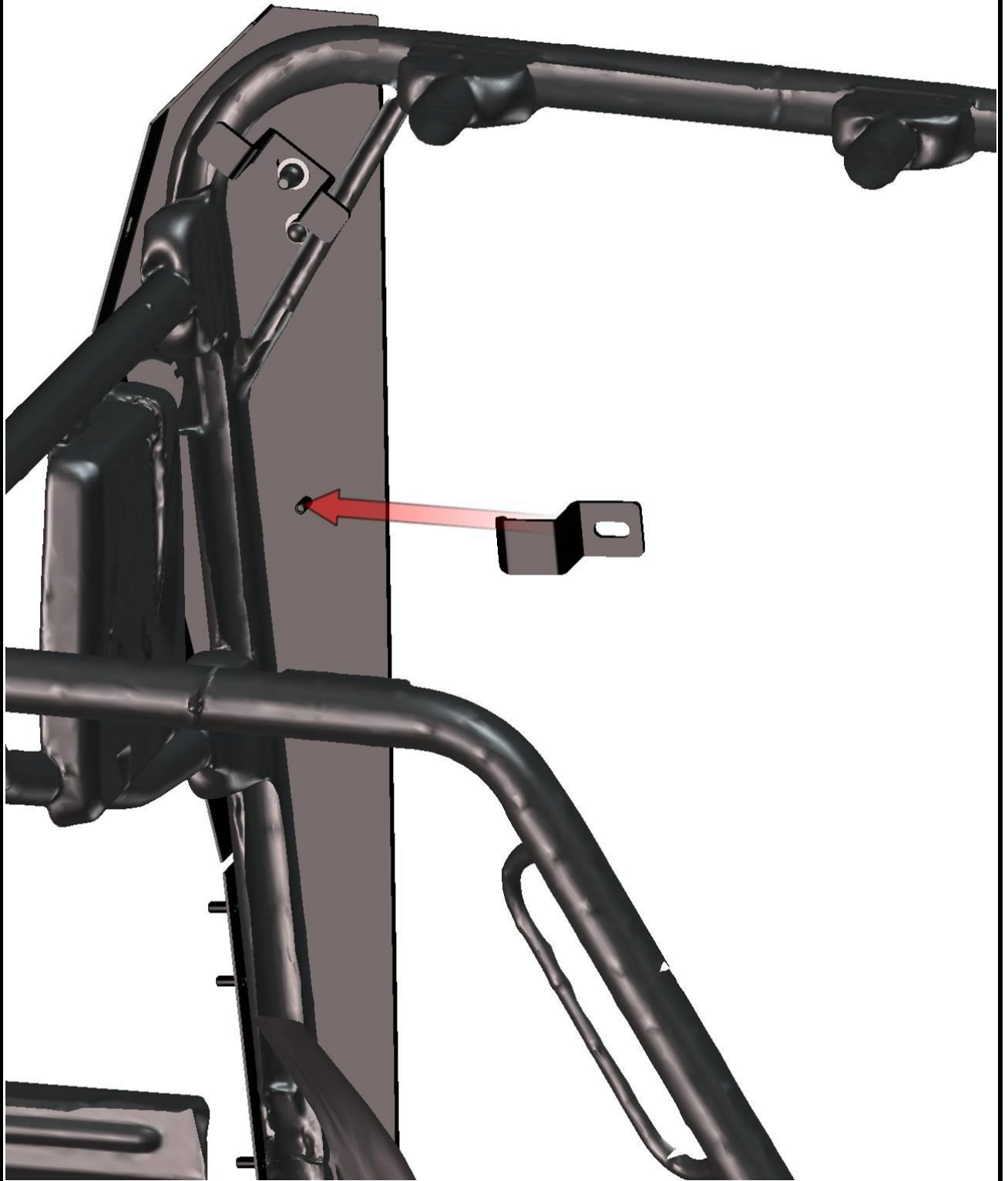

FOR ALL TECHNICAL QUESTIONS, PLEASE CALL
DFK AMERICA INC.
(630) 324-6793

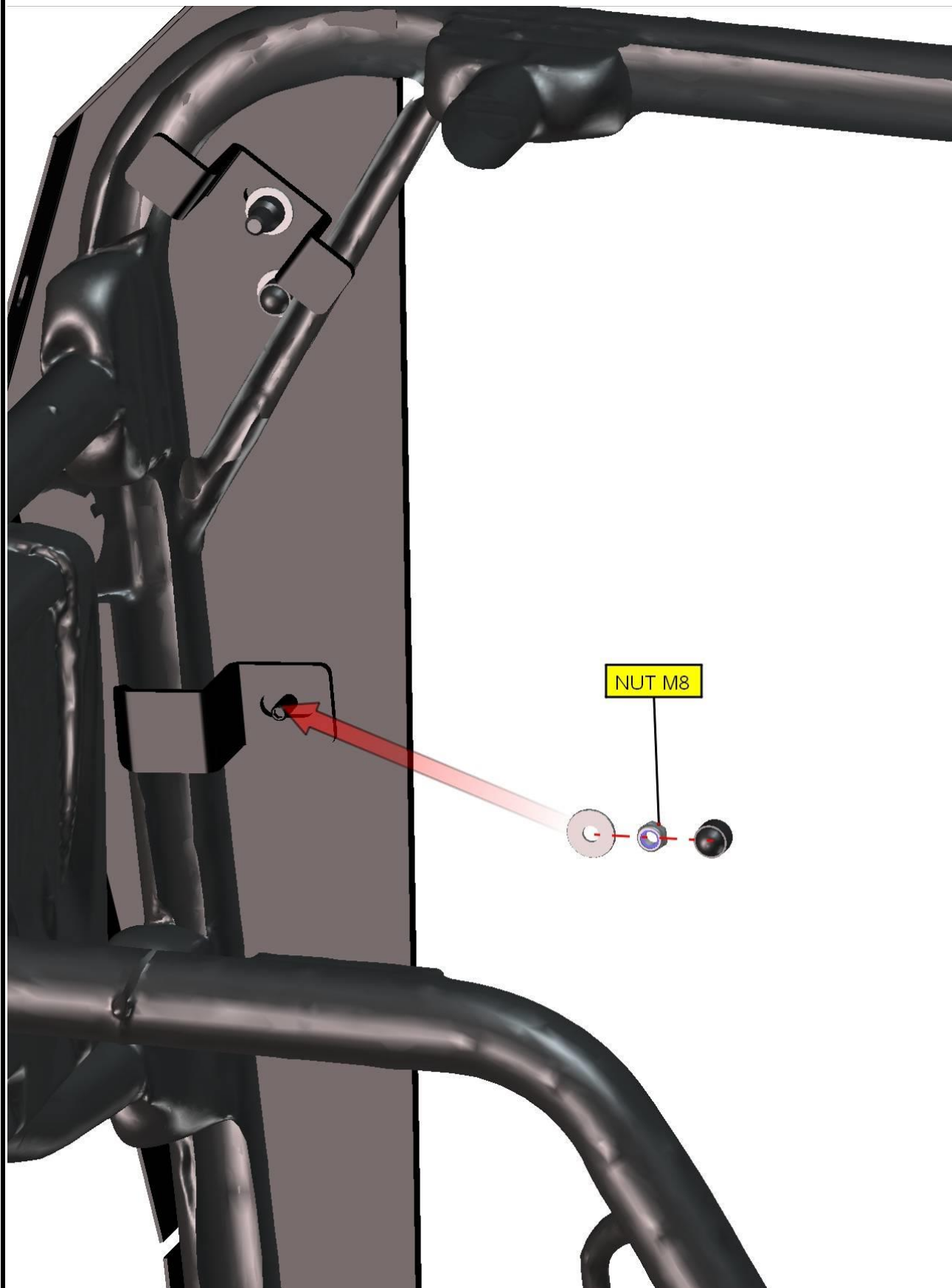

REAR PANEL

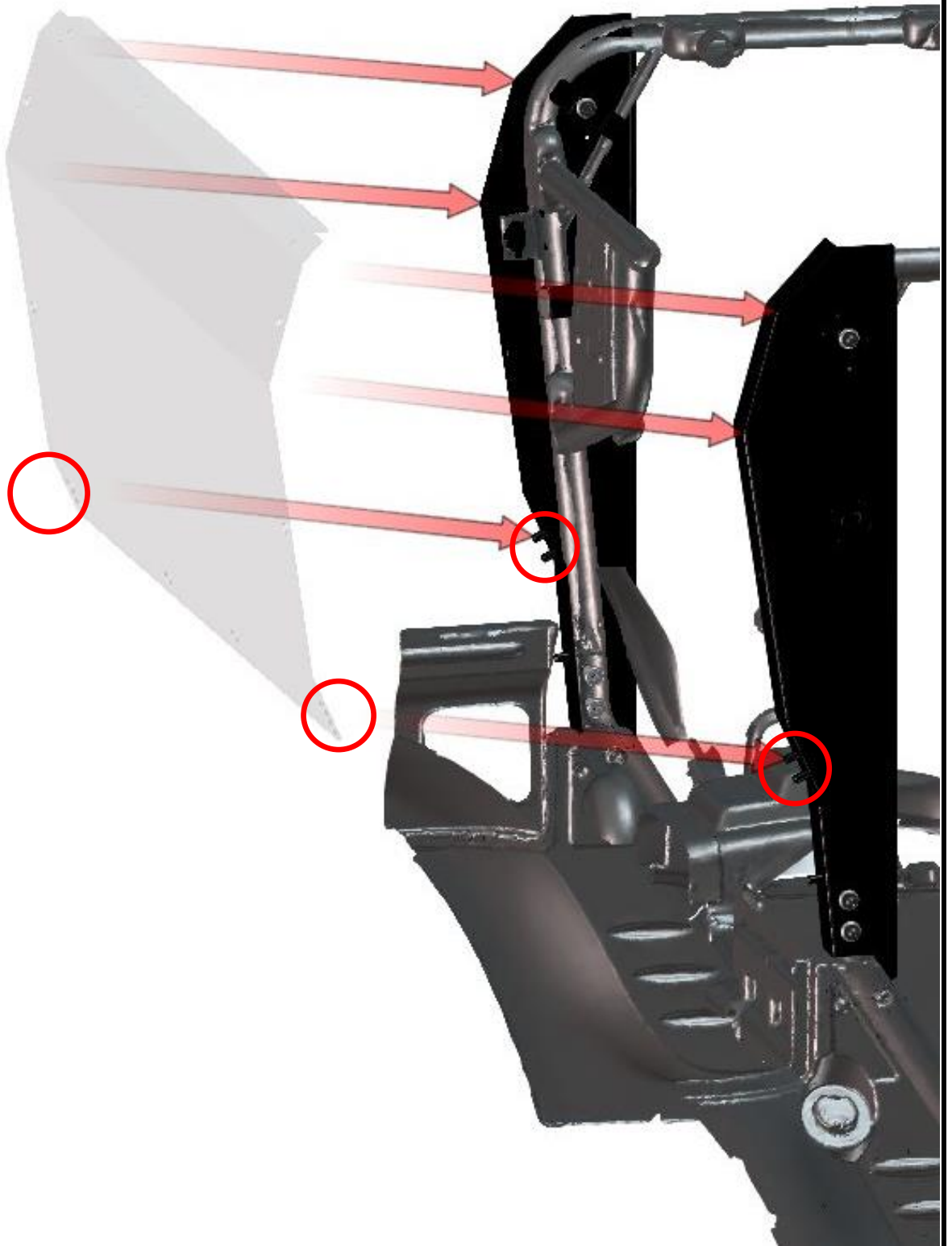

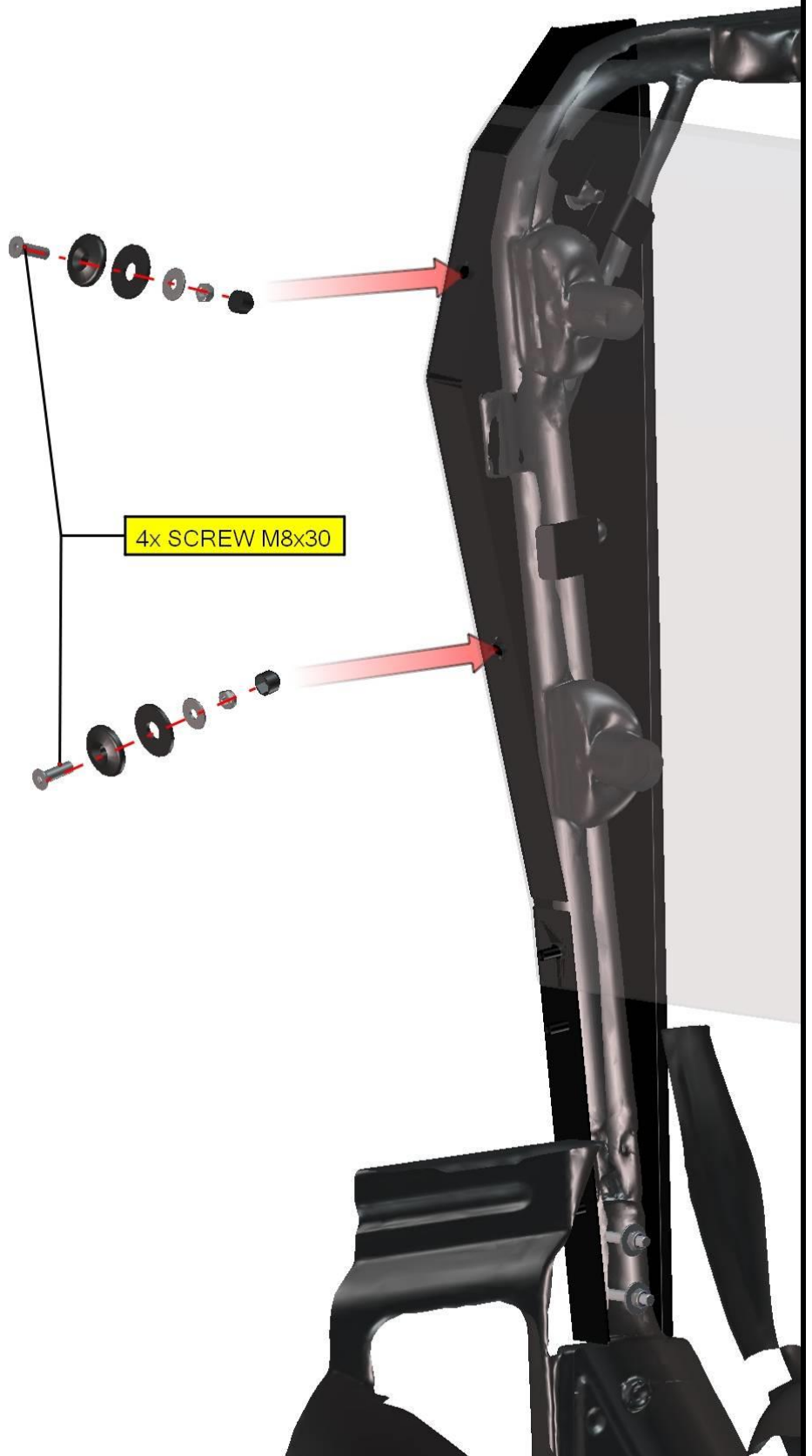

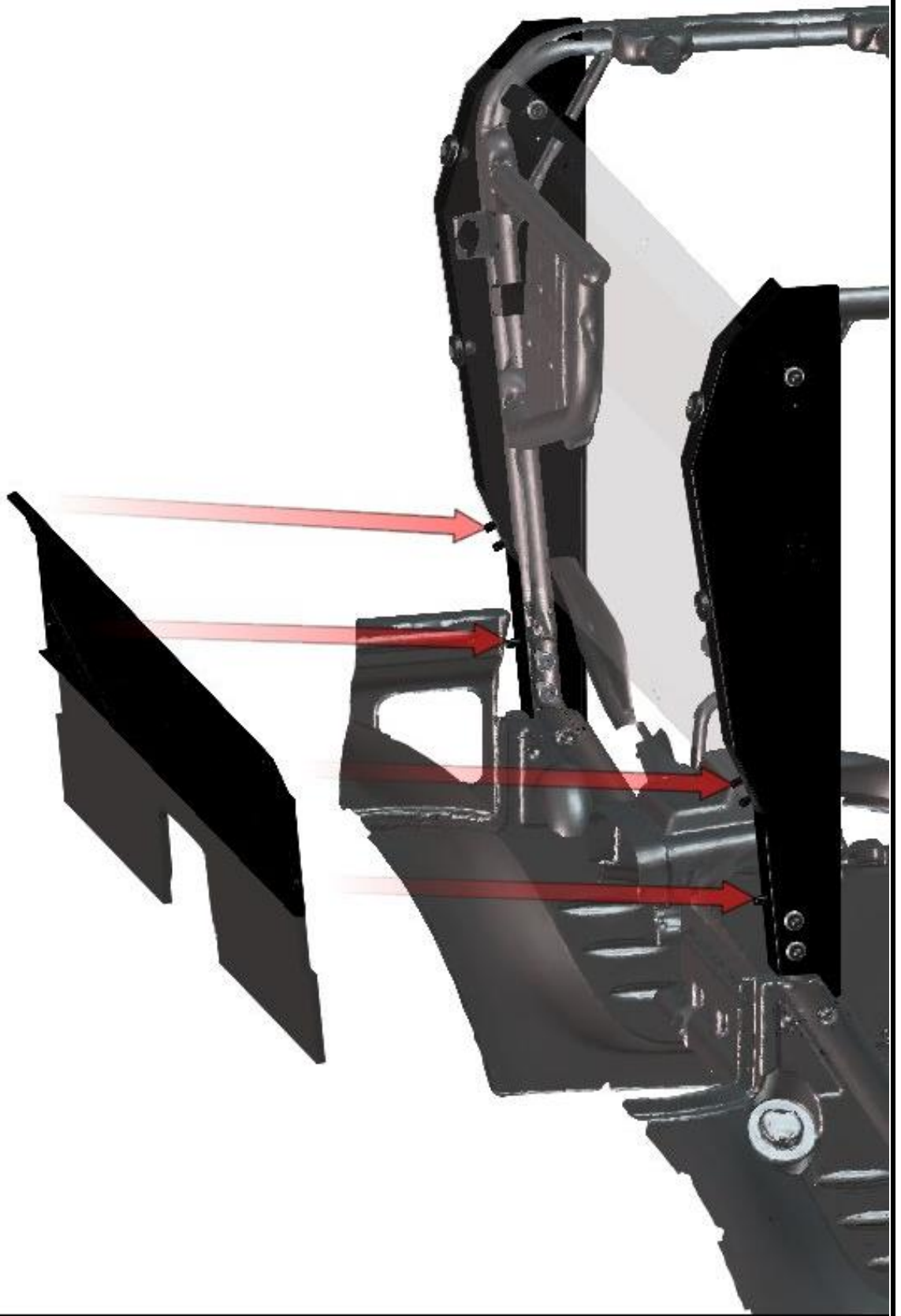

6x NUT M8



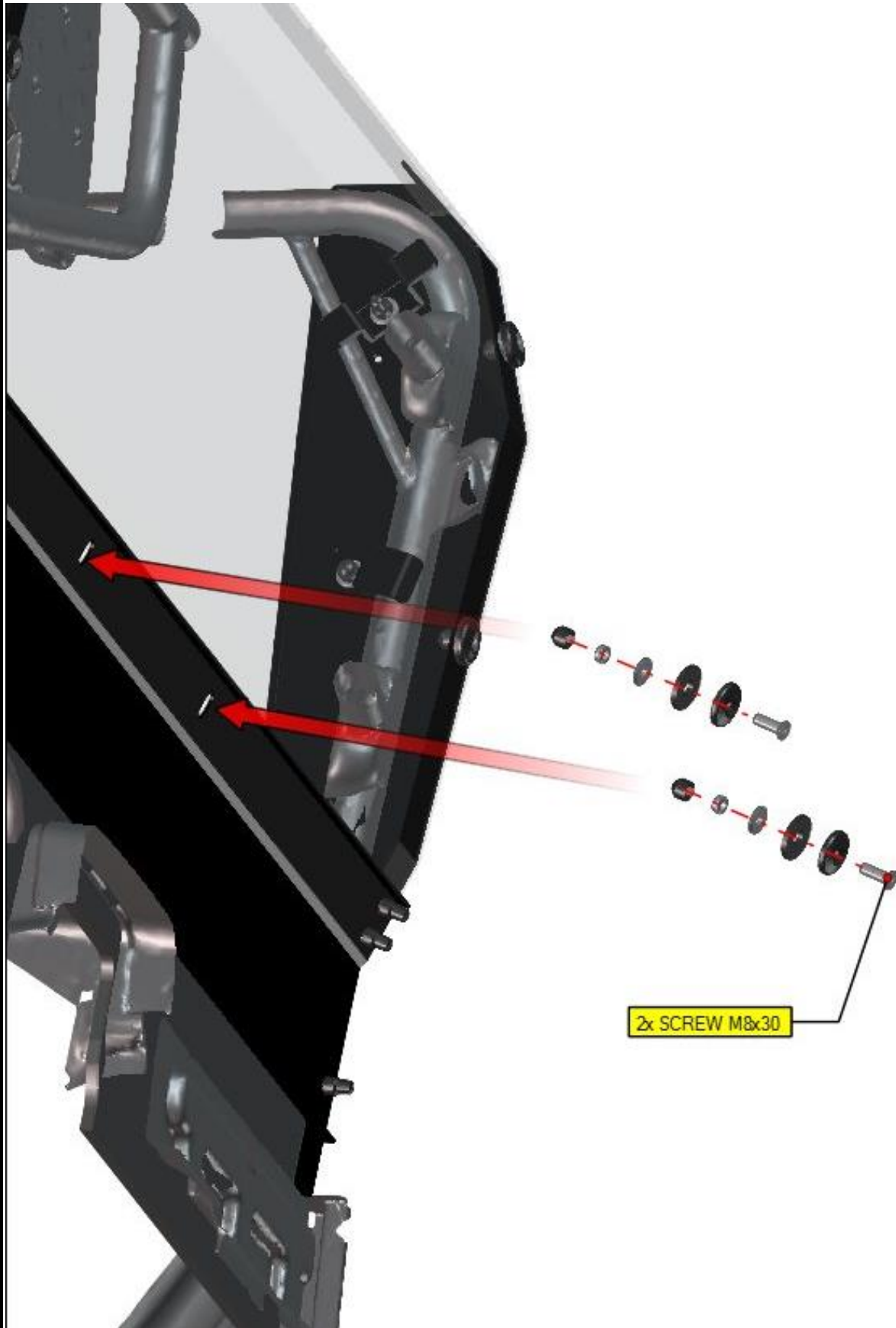

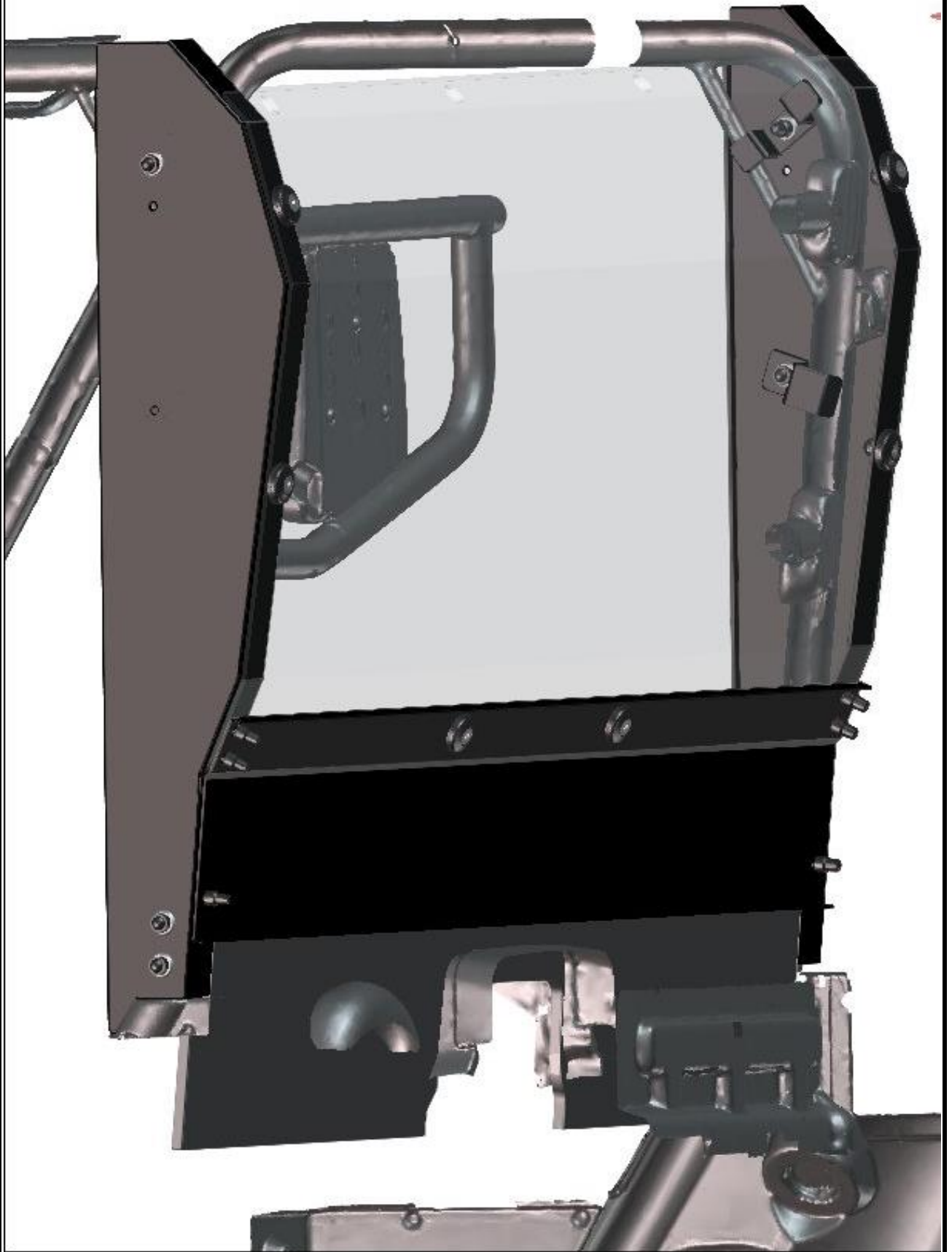



FRONT PANEL

**Use the left door stop holder and left front ledge holder (on picture) on left side of the UTV's roller cage.
YOU CAN'T MAKE MISTAKE BETWEEN LEFT AND RIGHT PARTS, IF YOU MAKE MISTAKE,
YOU ARE GOING TO HAVE BIG PROBLEM WITH DOOR STOP ADJUSTING**

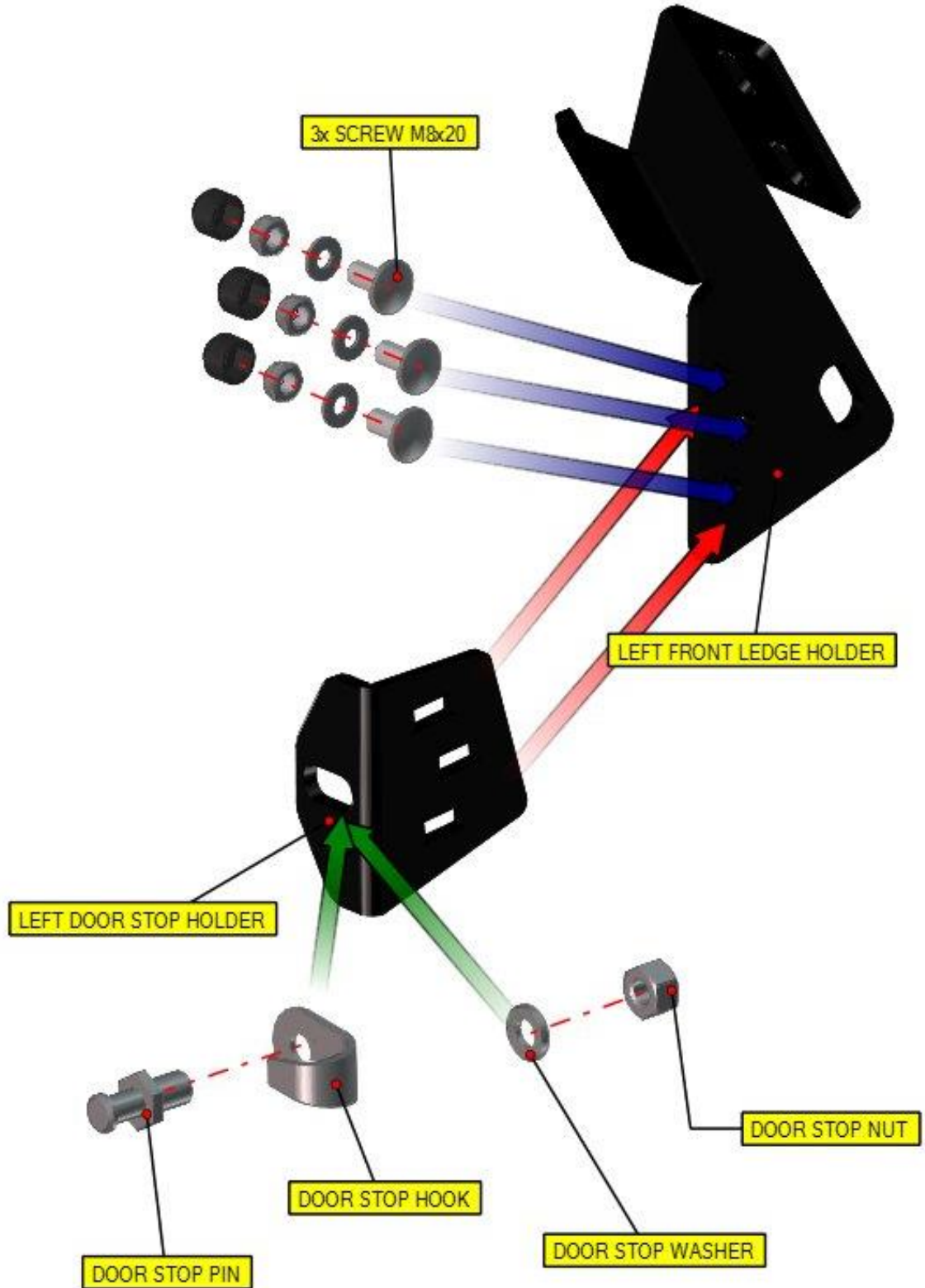

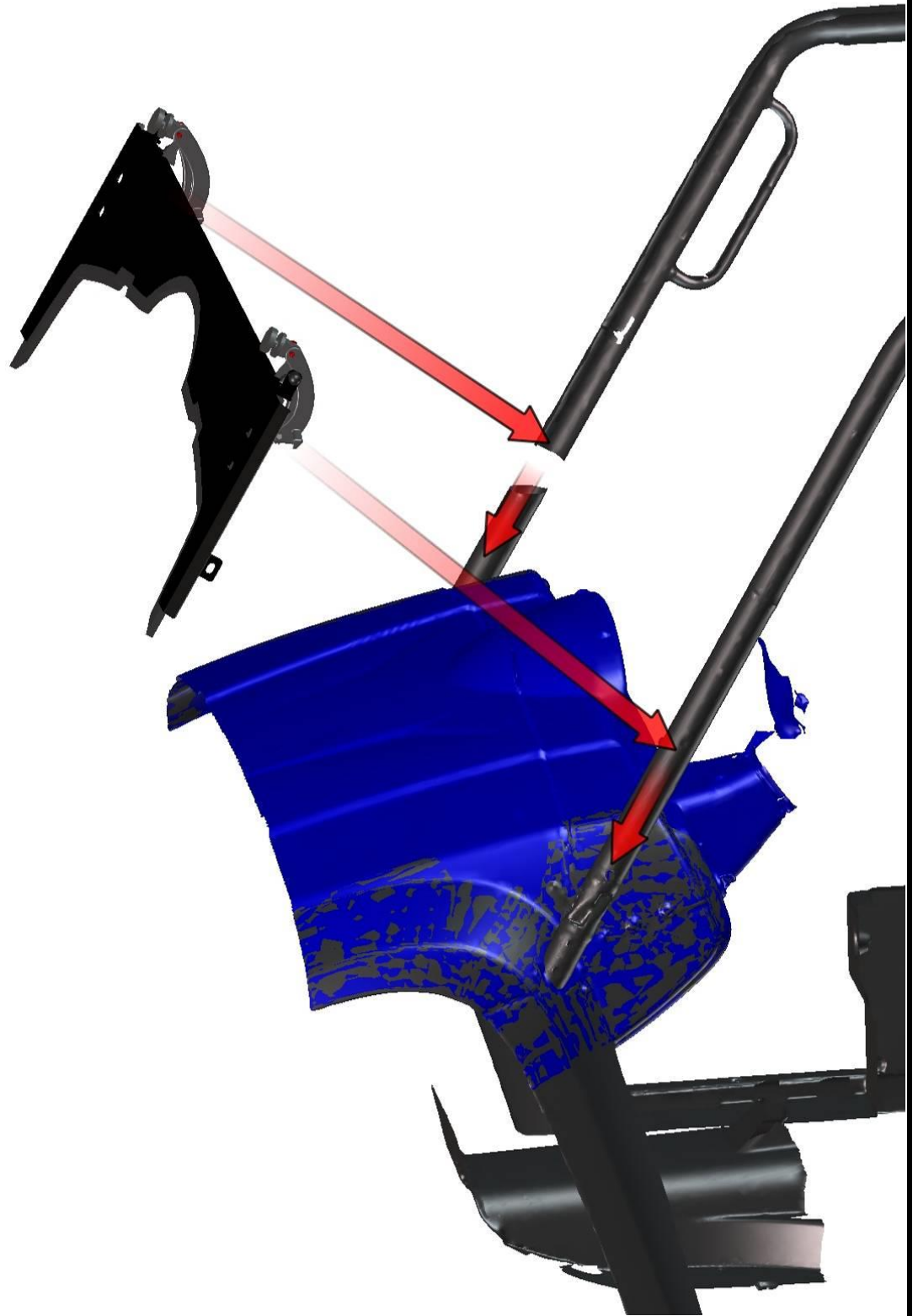



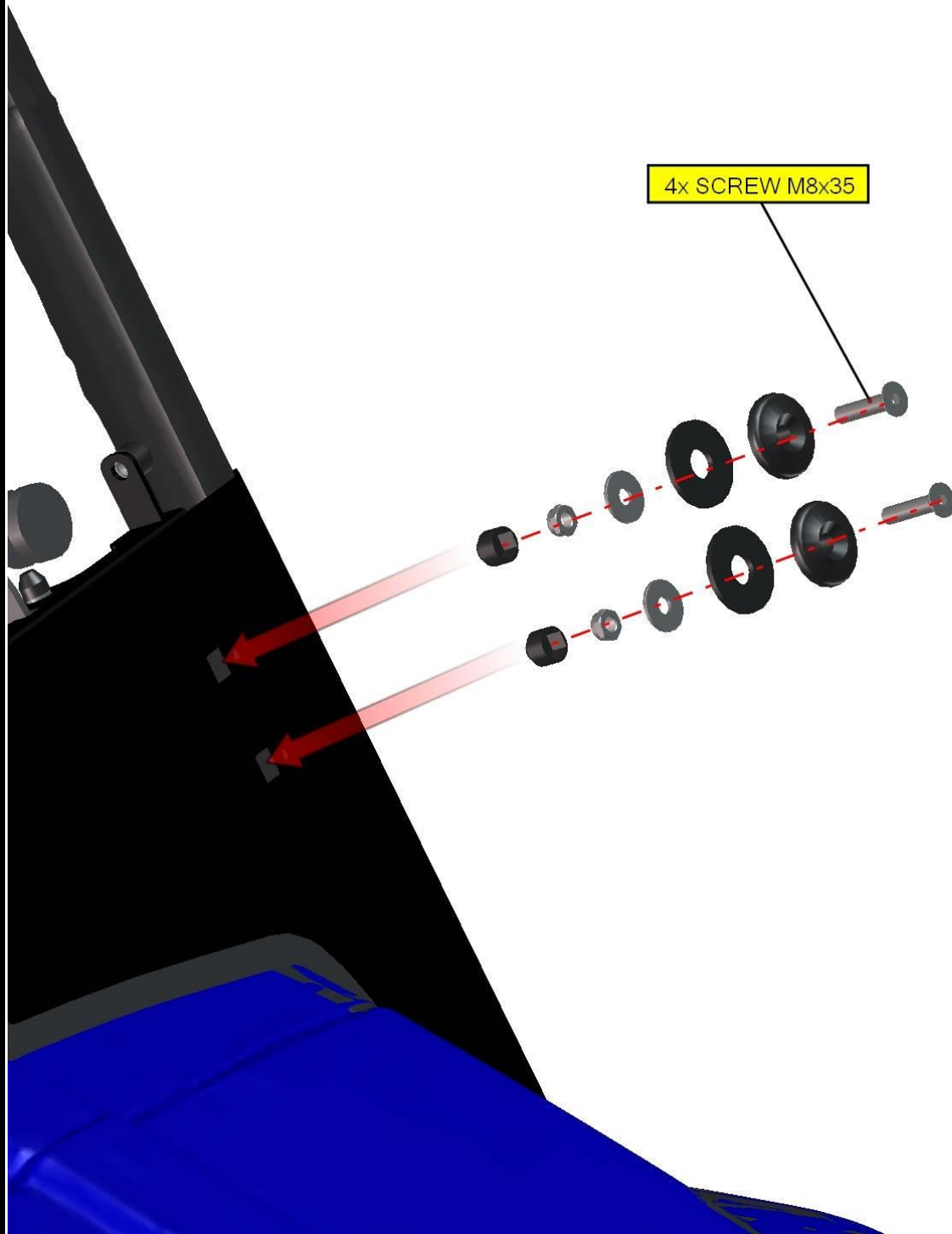

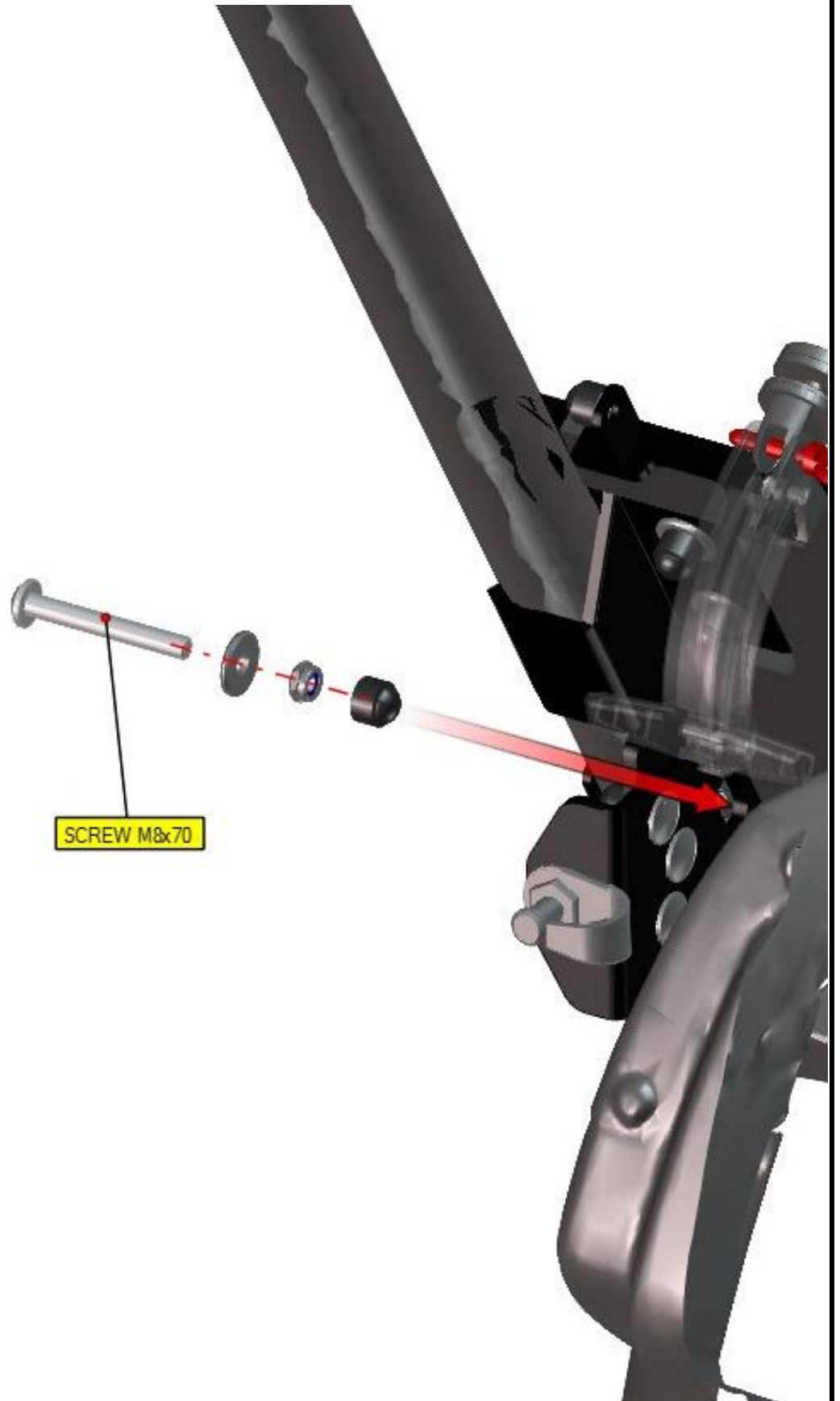

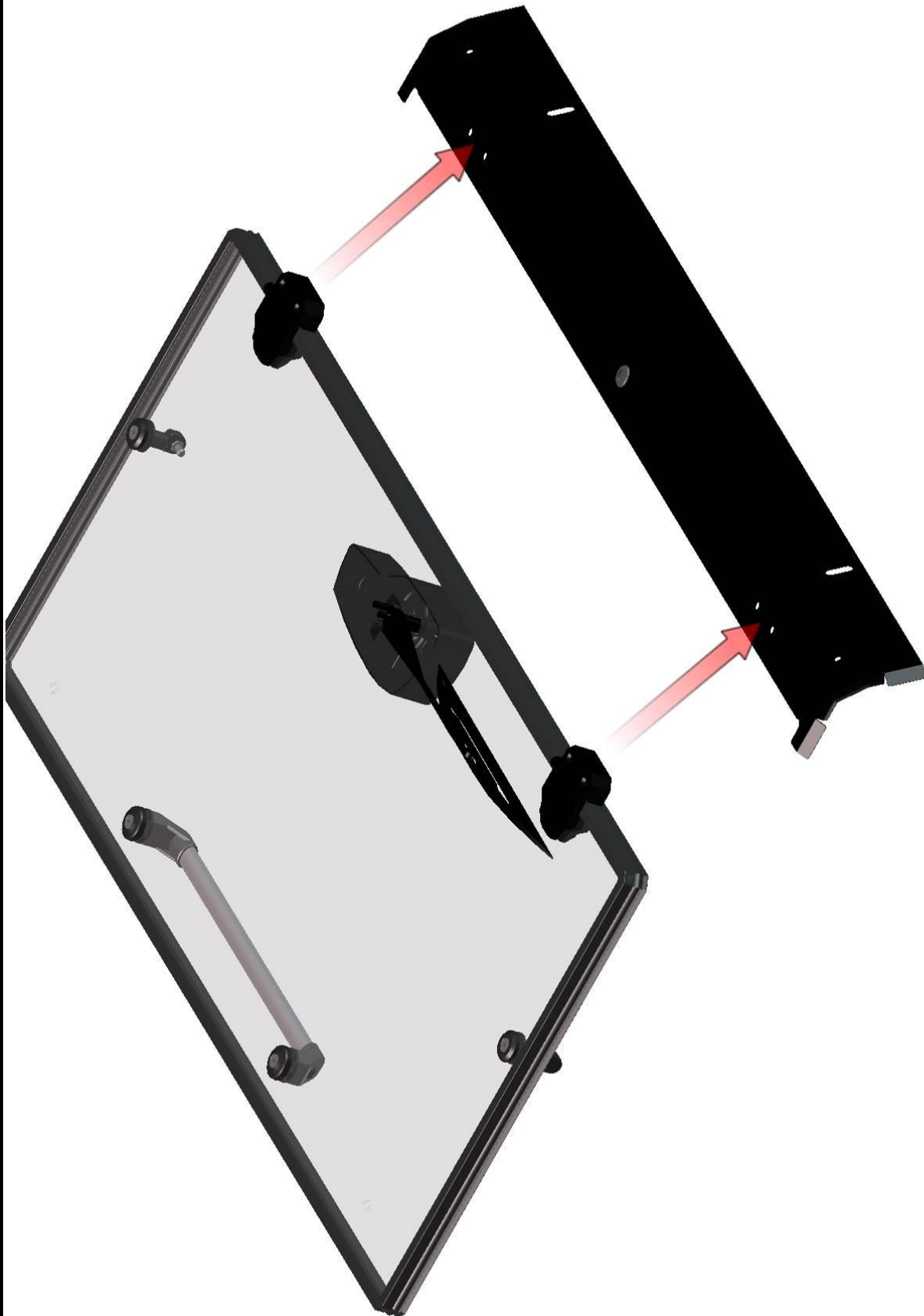

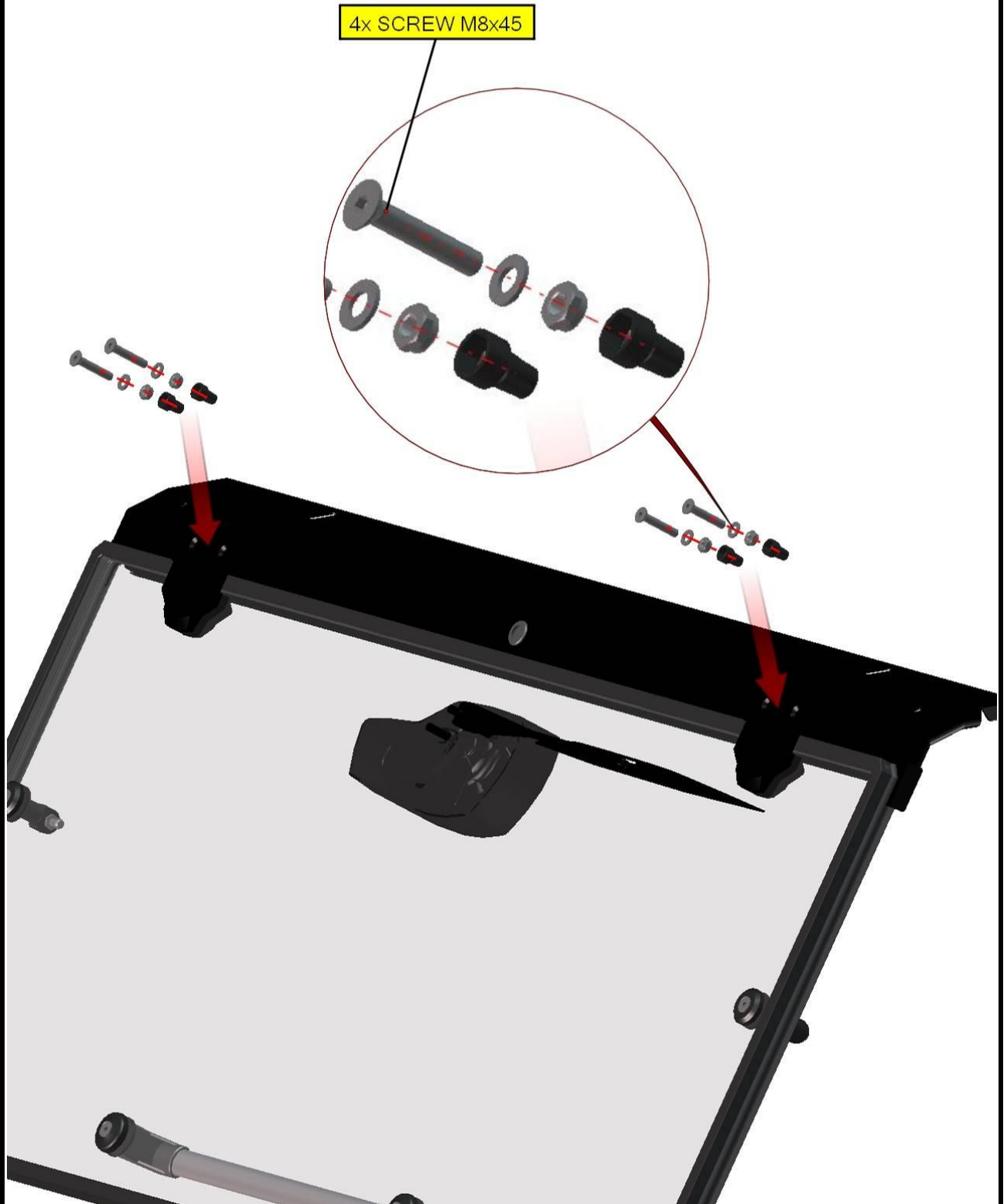

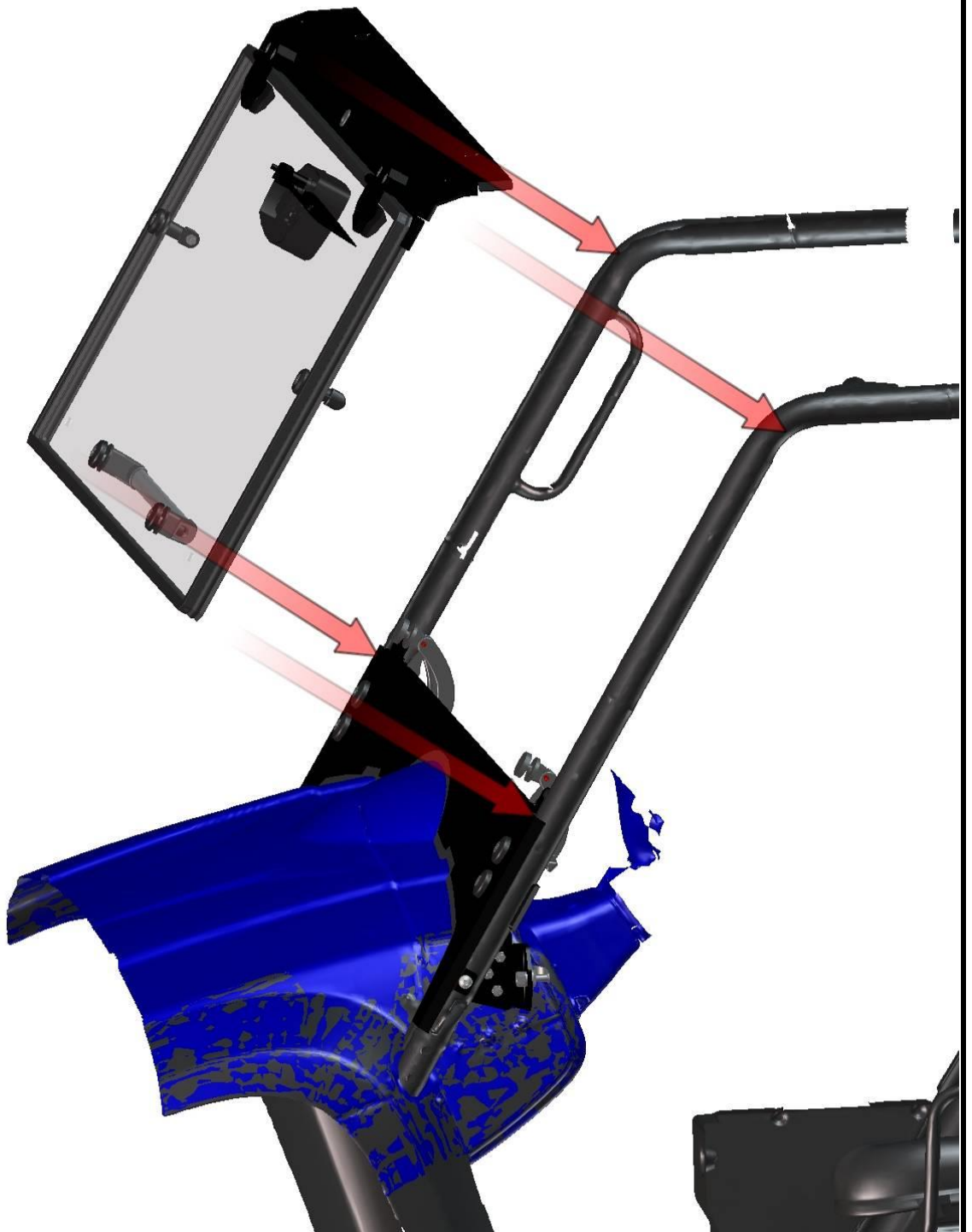

FOR ALL TECHNICAL QUESTIONS, PLEASE CALL
DFK AMERICA INC.
(630) 324-6793

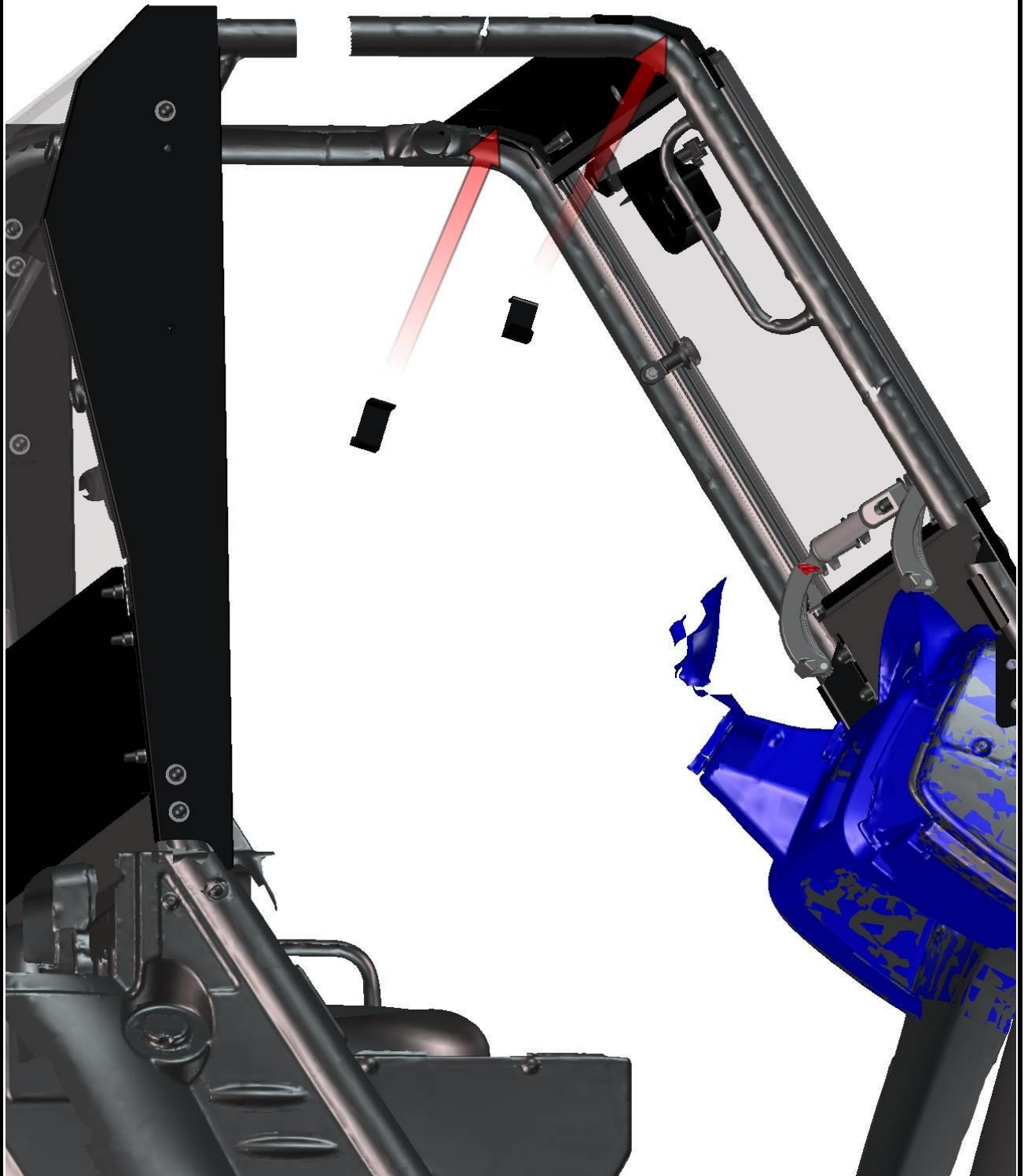

30

FOR ALL TECHNICAL QUESTIONS, PLEASE CALL
DFK AMERICA INC.
(630) 324-6793

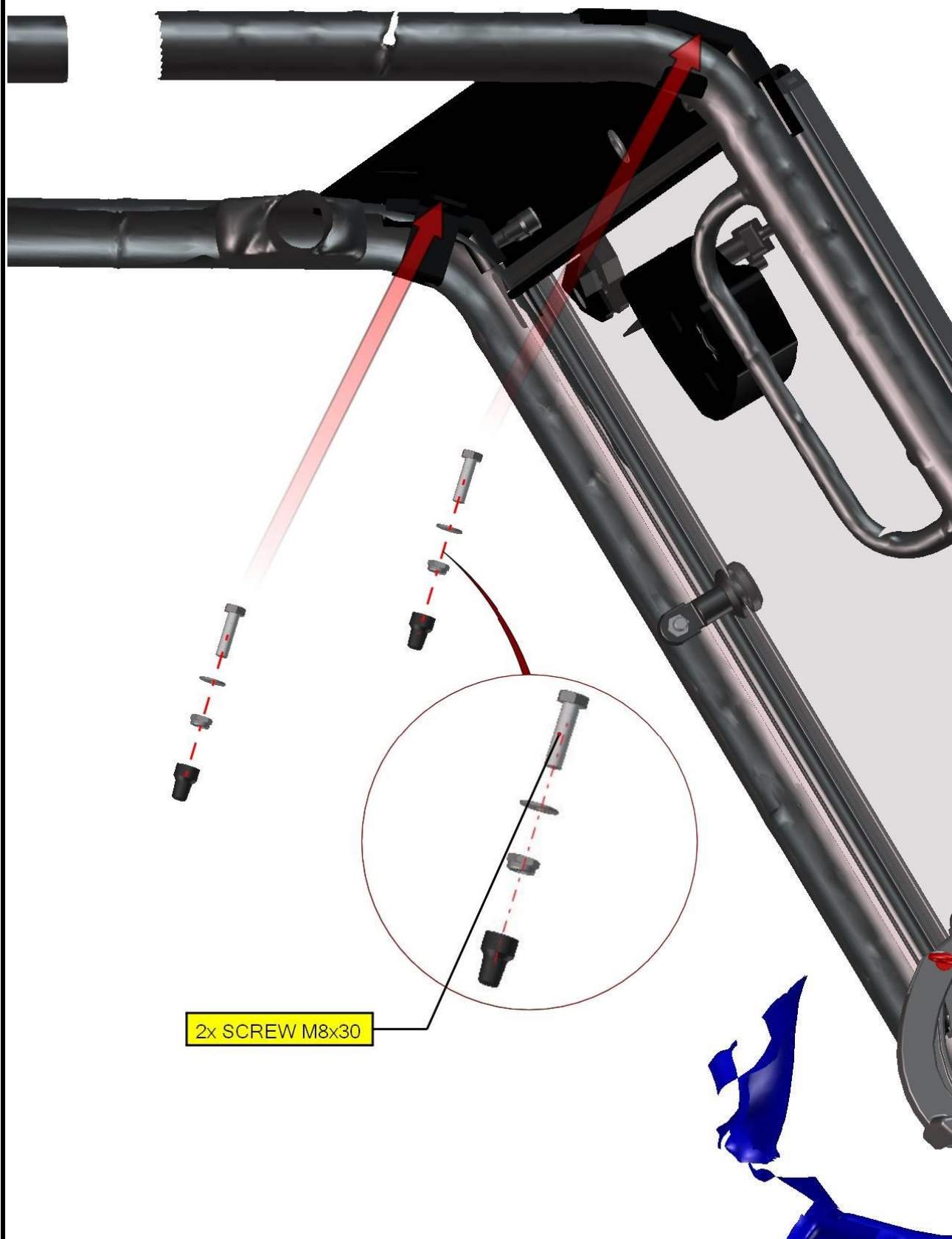

ROOF



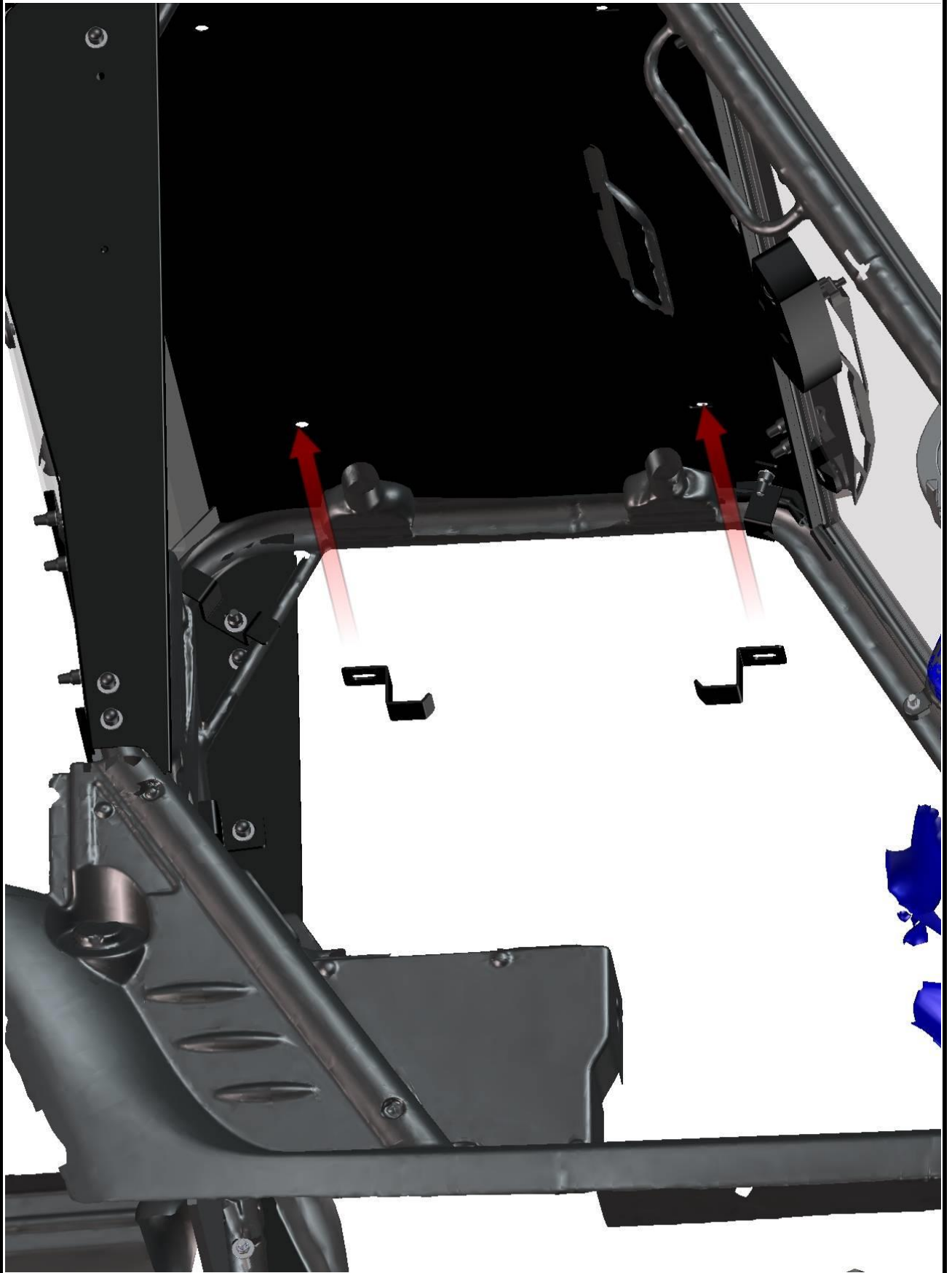

FOR ALL TECHNICAL QUESTIONS, PLEASE CALL
DFK AMERICA INC.
(630) 324-6793

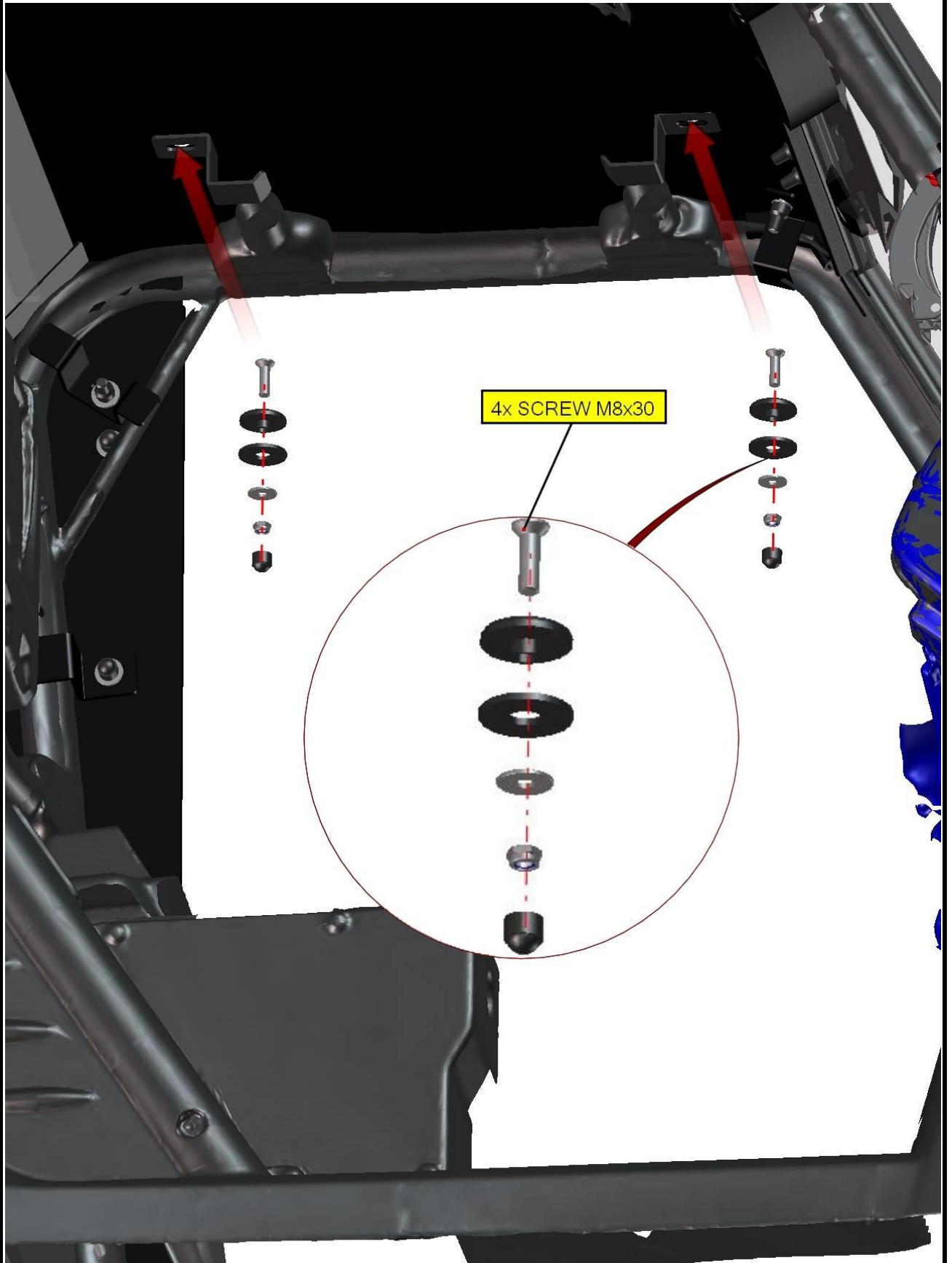

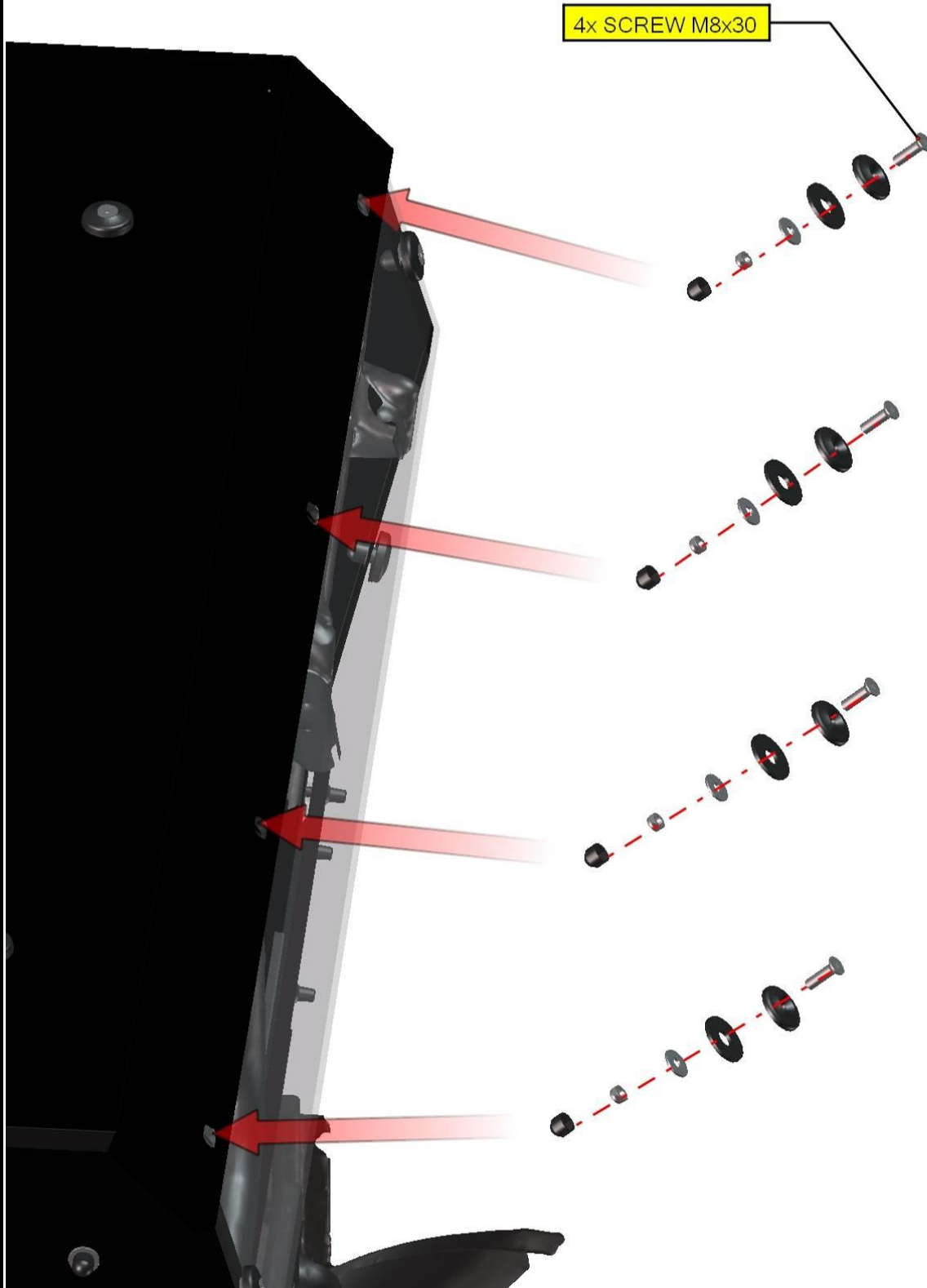

FRONT PANEL

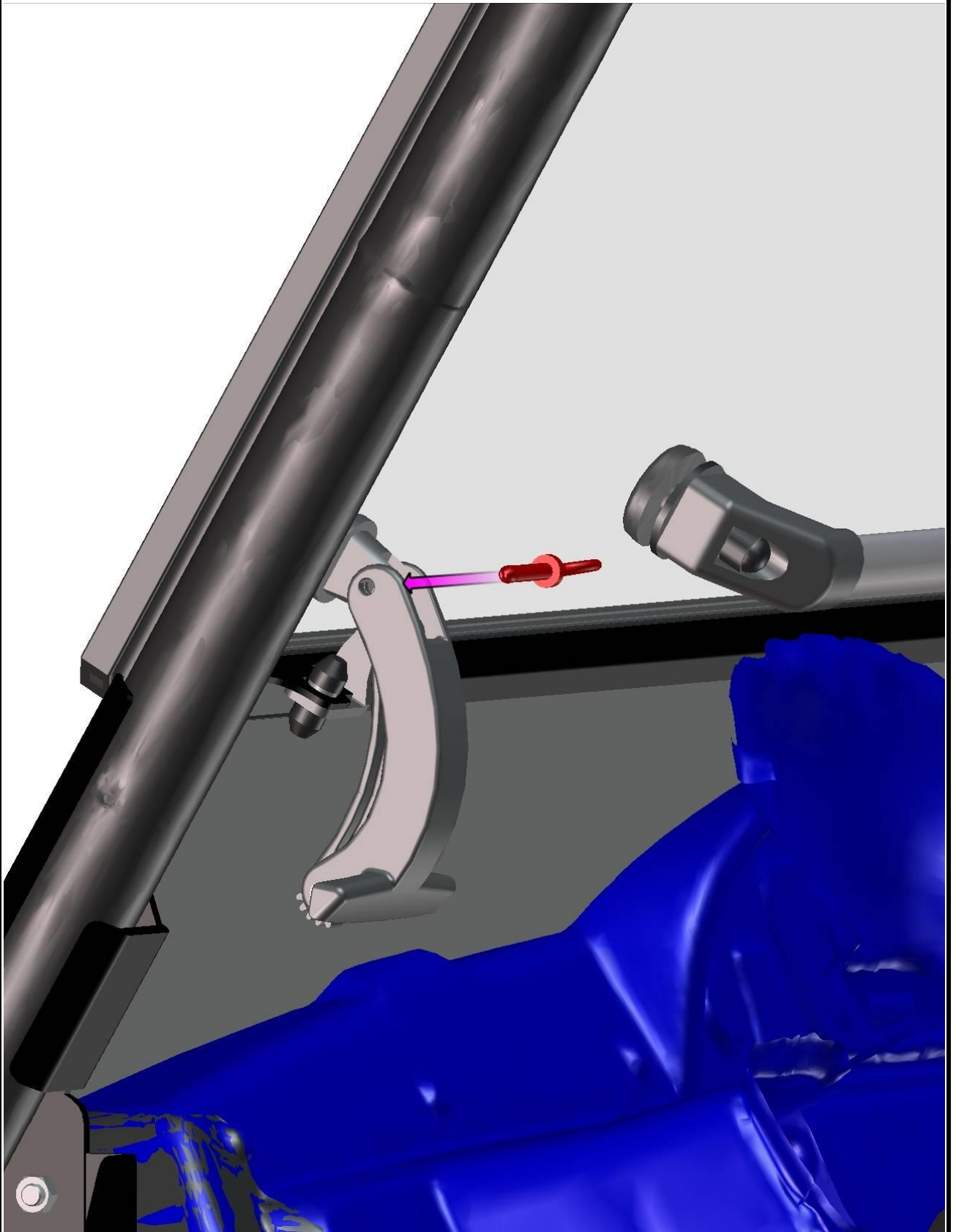

36

FOR ALL TECHNICAL QUESTIONS, PLEASE CALL
DFK AMERICA INC.
(630) 324-6793

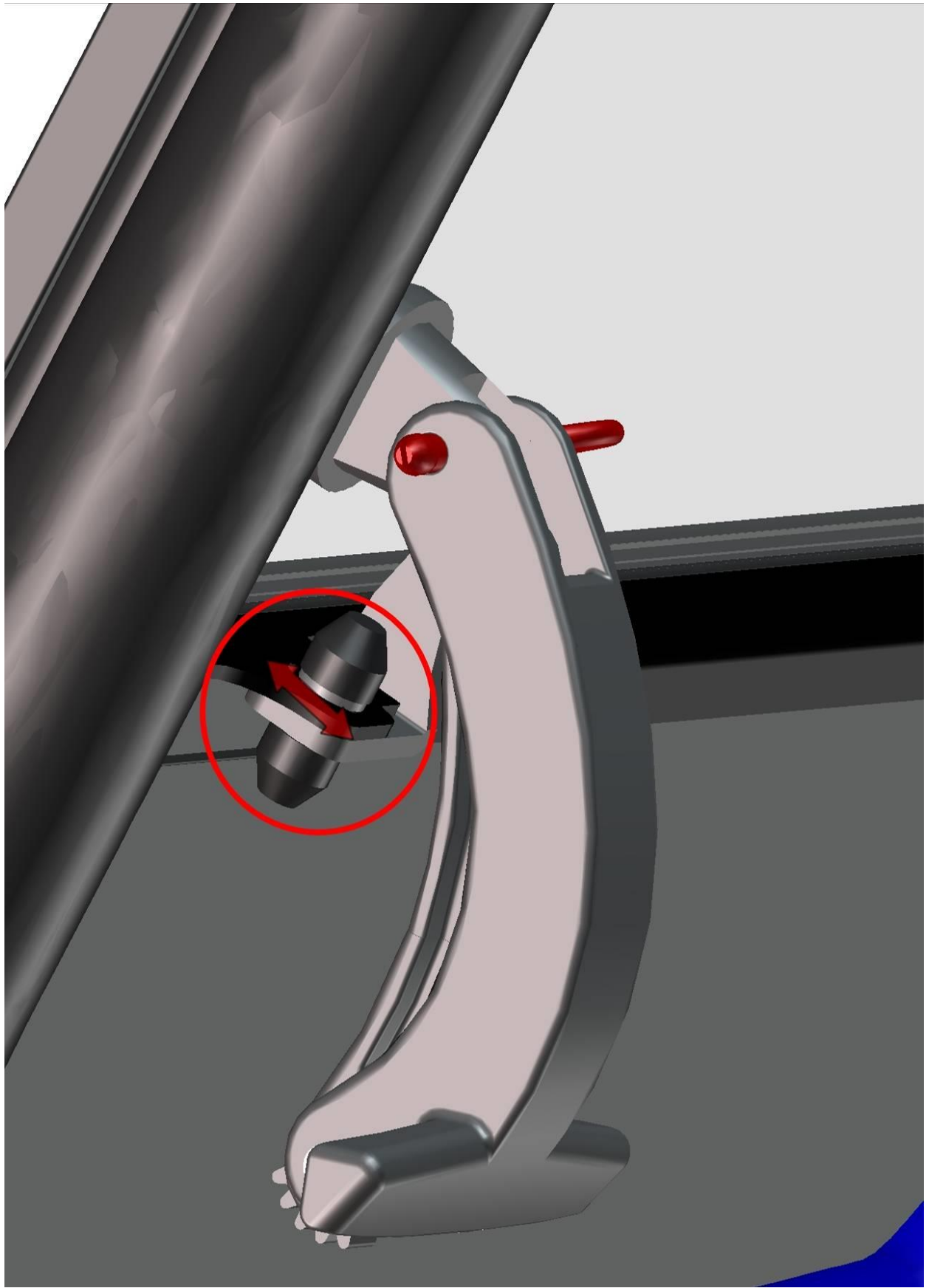

FOR ALL TECHNICAL QUESTIONS, PLEASE CALL
DFK AMERICA INC.
(630) 324-6793

It's necessary to install the gas springs in same position like on picture.



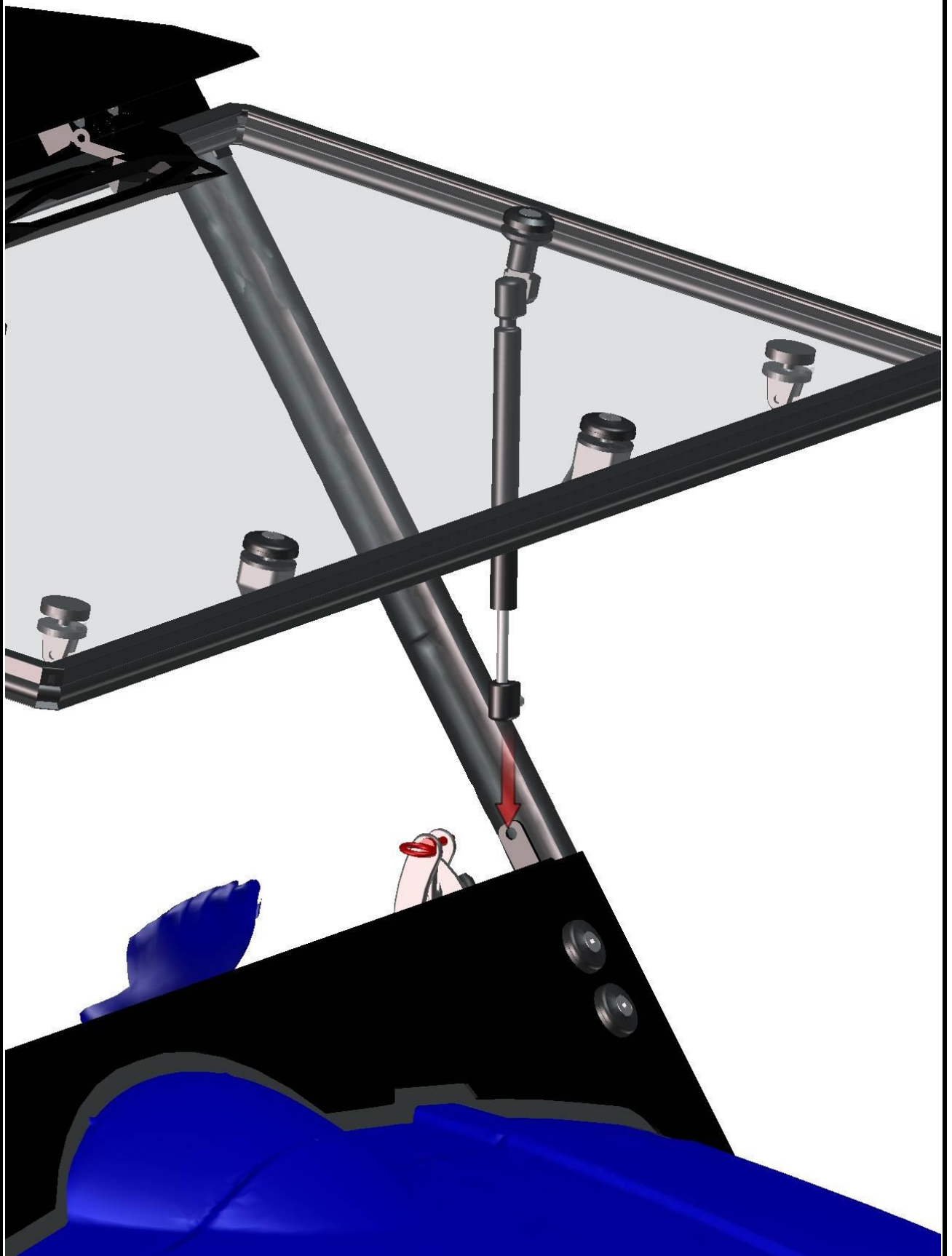

FOR ALL TECHNICAL QUESTIONS, PLEASE CALL
DFK AMERICA INC.
(630) 324-6793

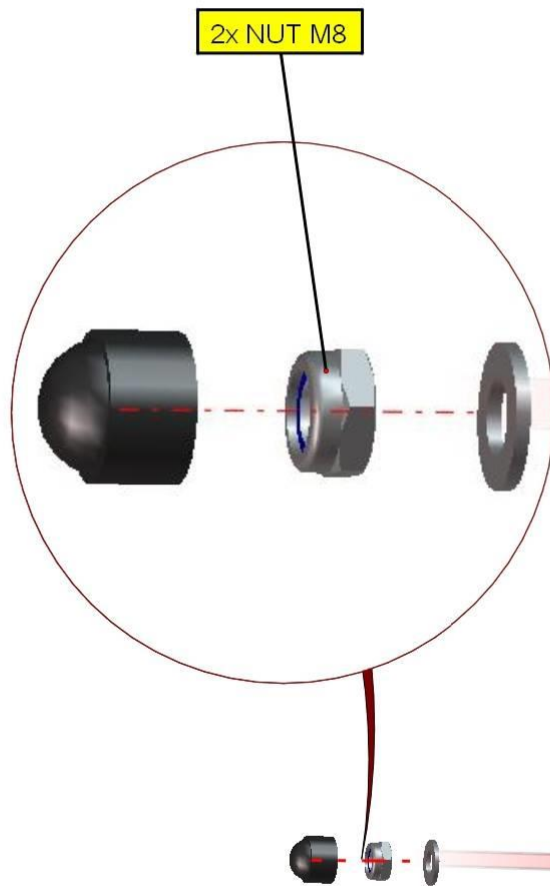

LEFT DOOR + RIGHT DOOR



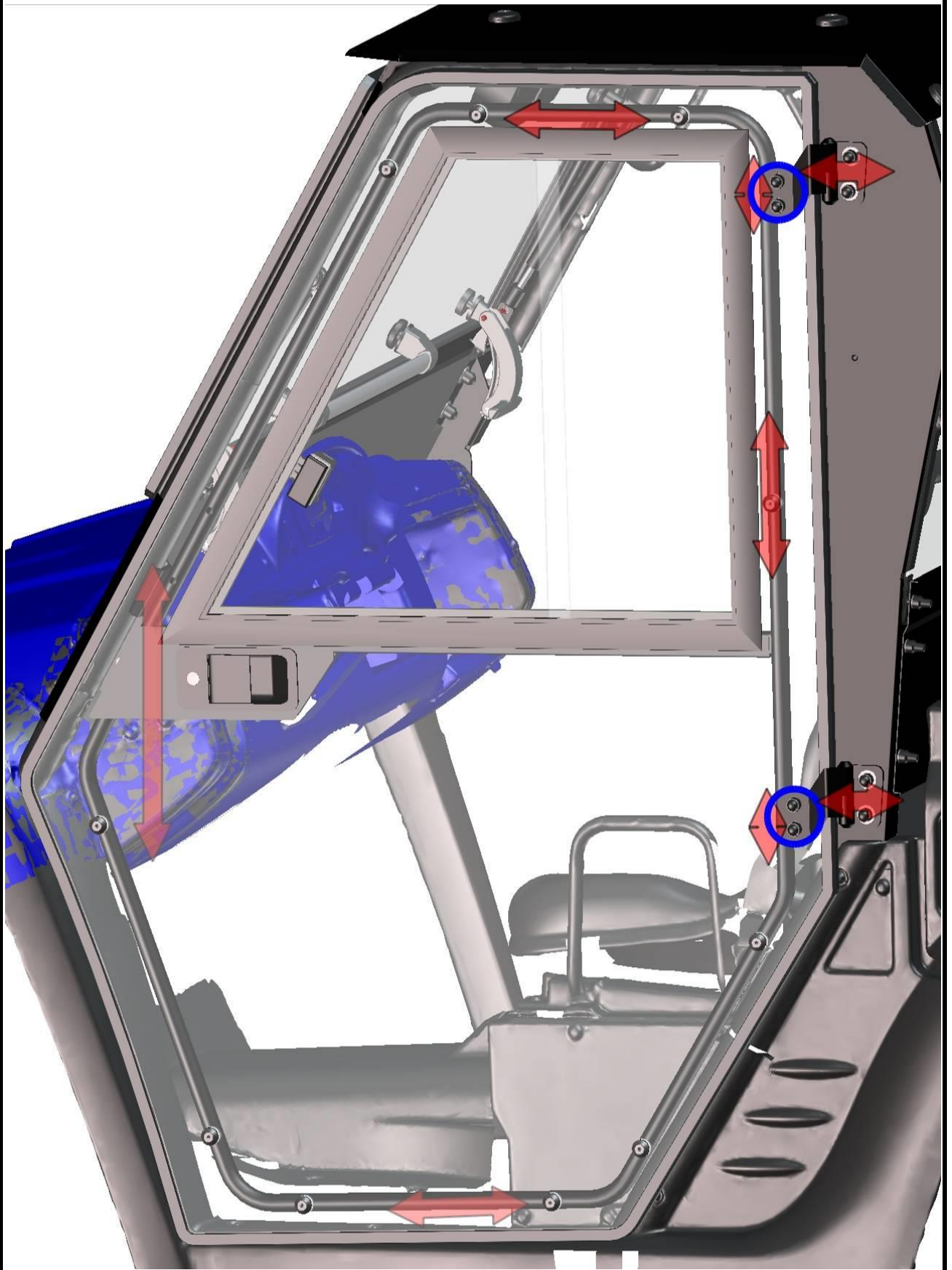

FOR ALL TECHNICAL QUESTIONS, PLEASE CALL
DFK AMERICA INC.
(630) 324-6793

If you close the door slowly and adjust the door stop correctly, you can hear 2 clear metallic click.

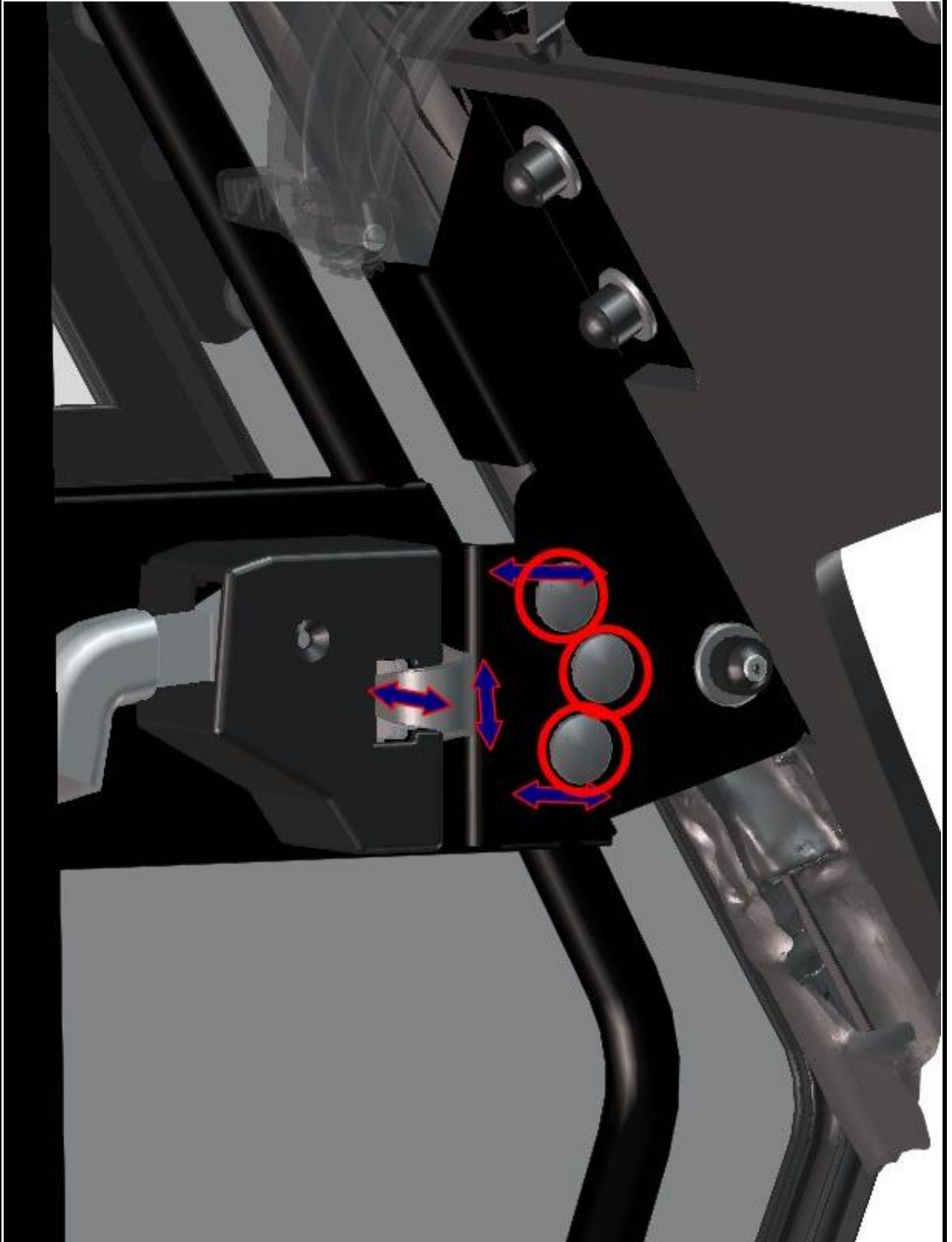

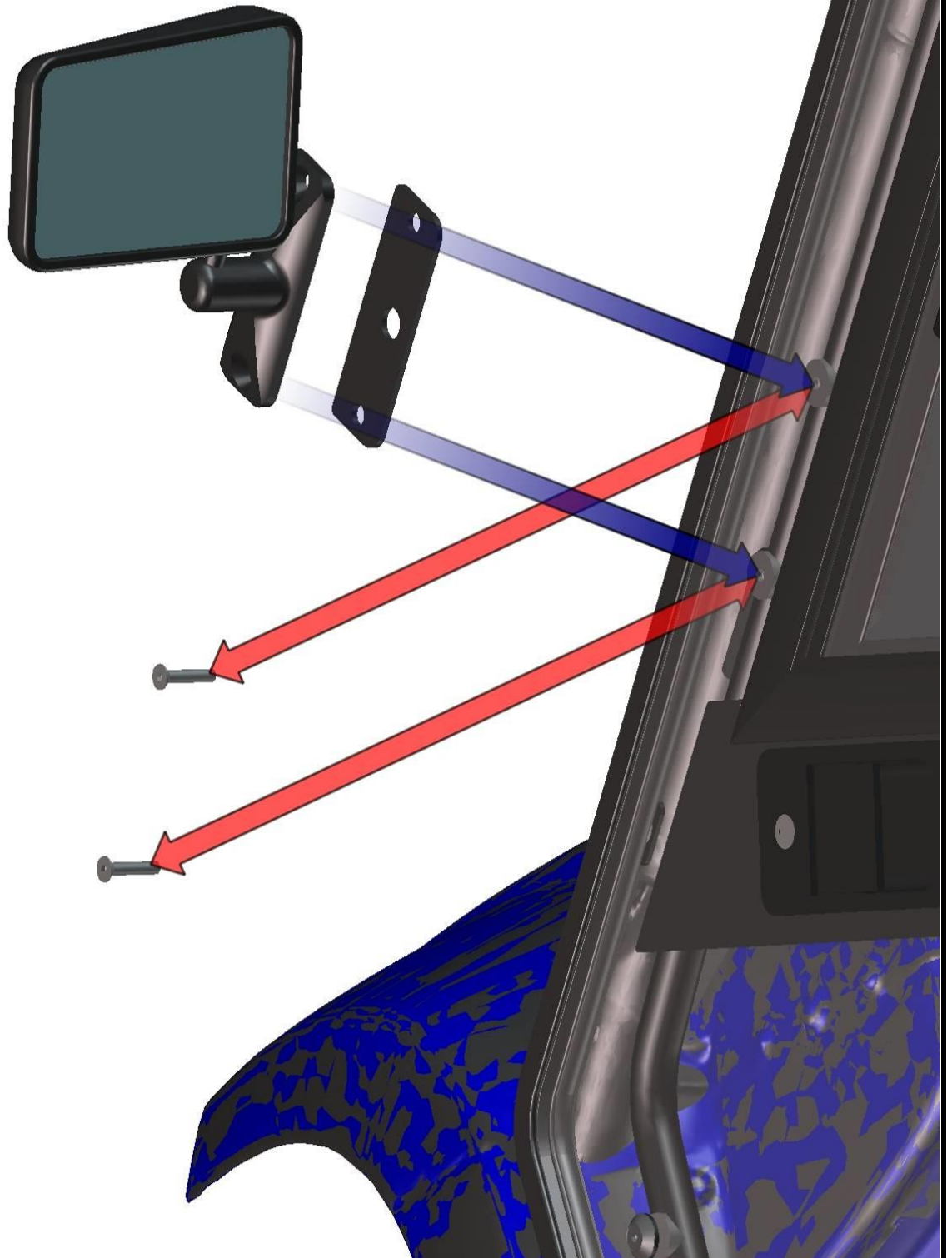

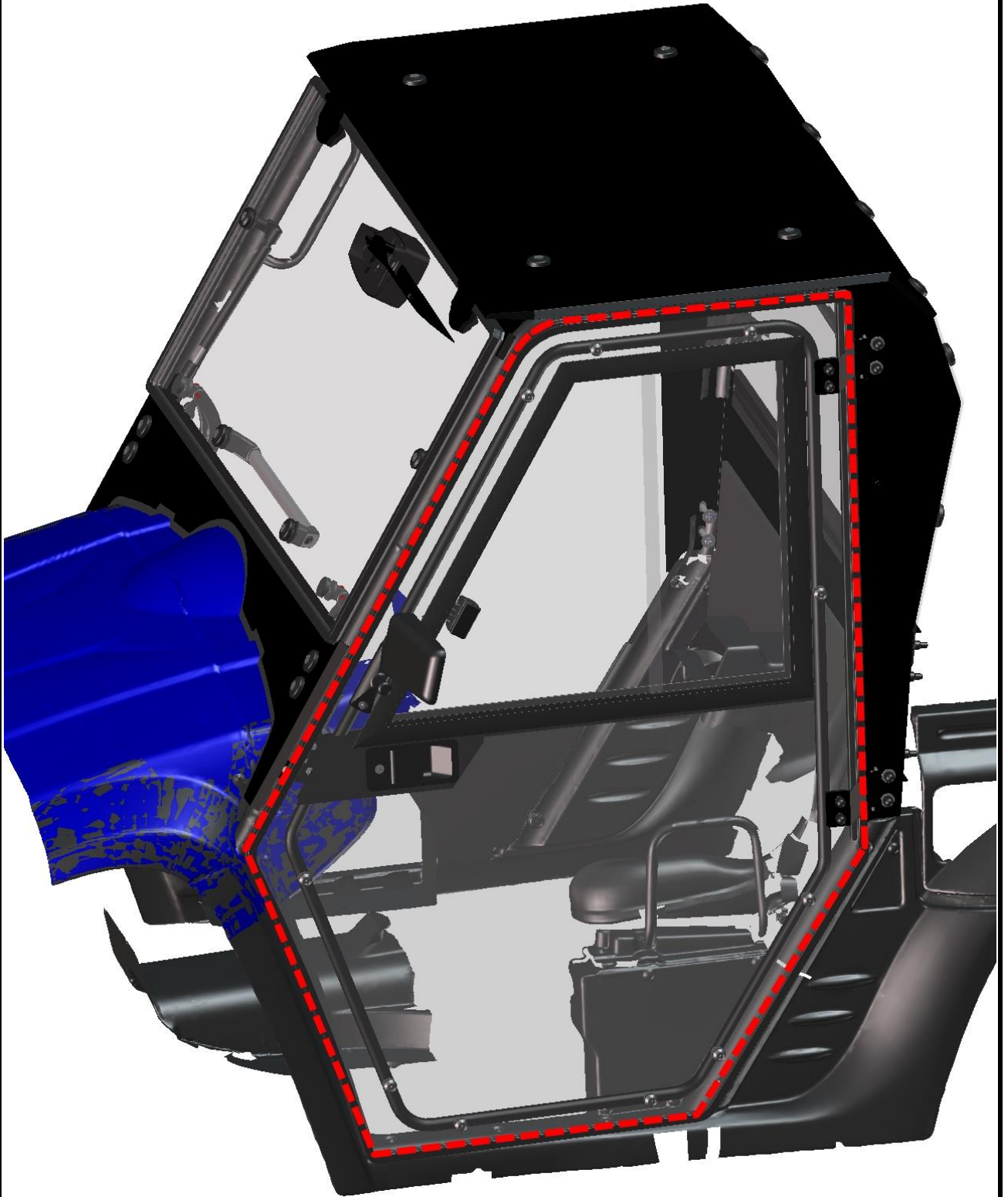

See next page.

FOR ALL TECHNICAL QUESTIONS, PLEASE CALL
DFK AMERICA INC.
(630) 324-6793

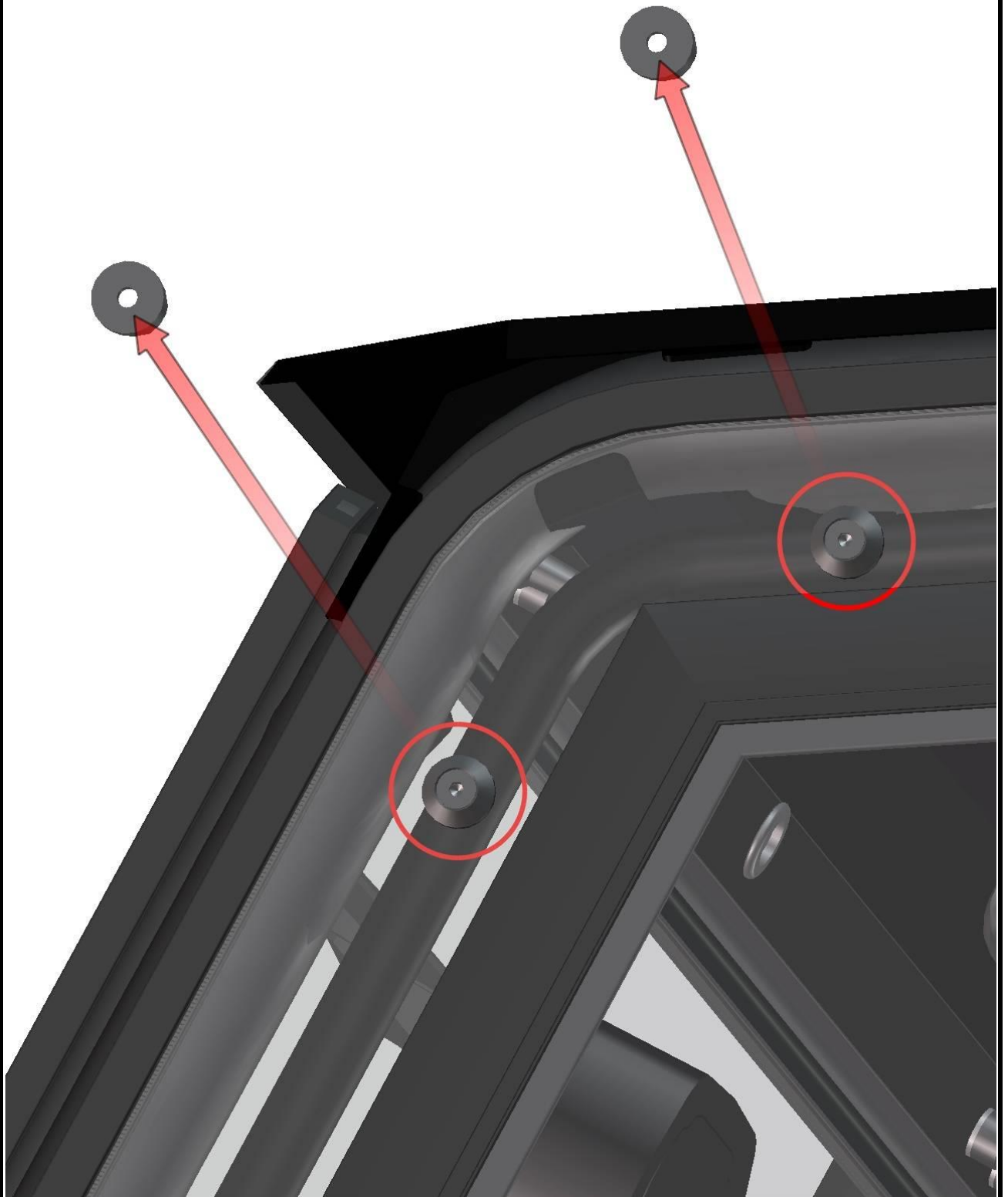

FOR ALL TECHNICAL QUESTIONS, PLEASE CALL
DFK AMERICA INC.
(630) 324-6793



ELECTROINSTALLATION WIPER/WASHER

Parts needed

Included

Washer tube



Switch wiper/washer/off



Harness and washer tank



Install the washer tank by washer tank holder and by screw, washers and nut (included) to best position near front left wheel.

HERE



OR HERE



FOR ALL TECHNICAL QUESTIONS, PLEASE CALL
DFK AMERICA INC.
(630) 324-6793

Lead the harness branch No.:1 from the dashboard to the front wiper motor around the right roller cage. You may have to drill hole to the dashboard for the harness branch. Fix the harness branch to the roller cage by included plastic tightening straps.

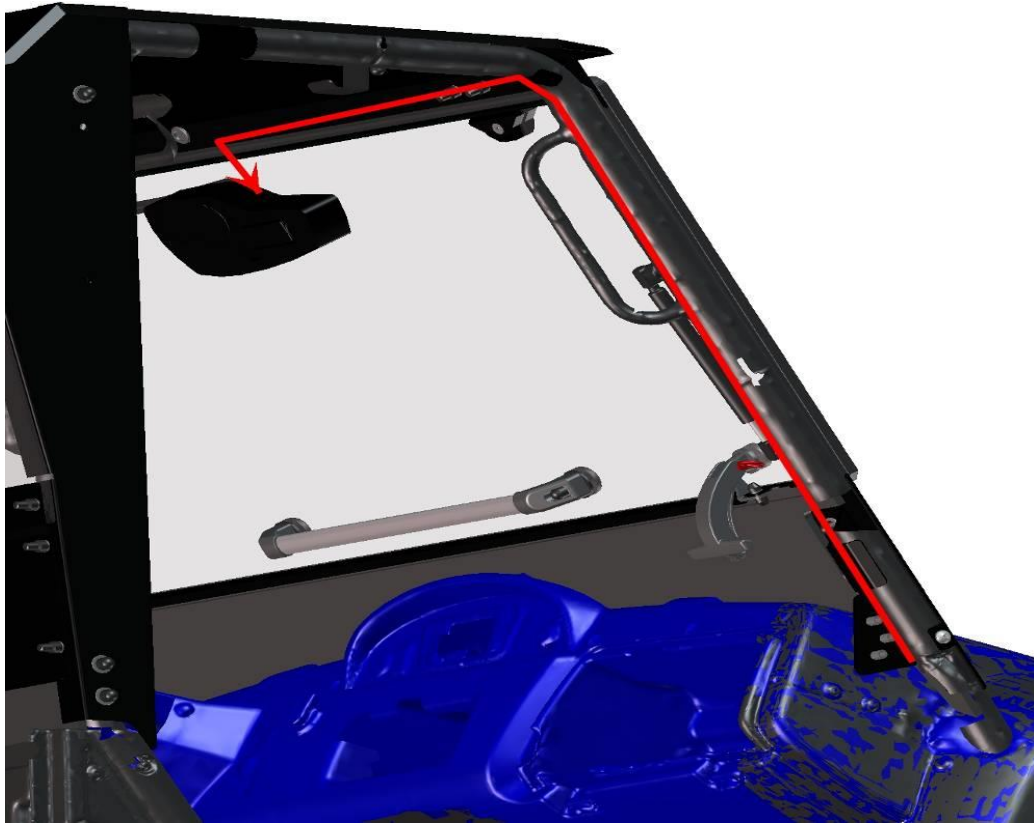

50

Connect the harness branch No.:1 with the wiper motor and stretch the washer hose through the bushing.

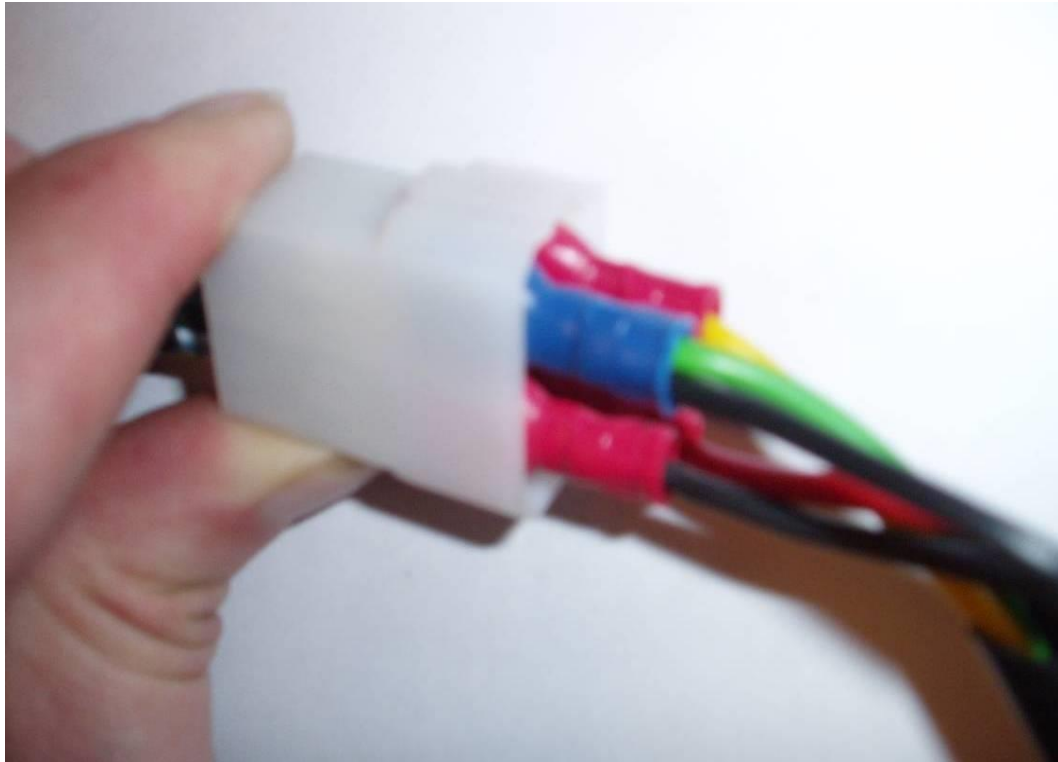

Connect the washer hose from the harness with the washer hose from wiper arm by included tube.



Run the harness branch No.: 2 under the dashboard. Find the best place for the switch (be careful for metal reinforcement under the dashboard). Cut the rectangle hole for the switch and connect the harness branch No.: 2 with the switch.

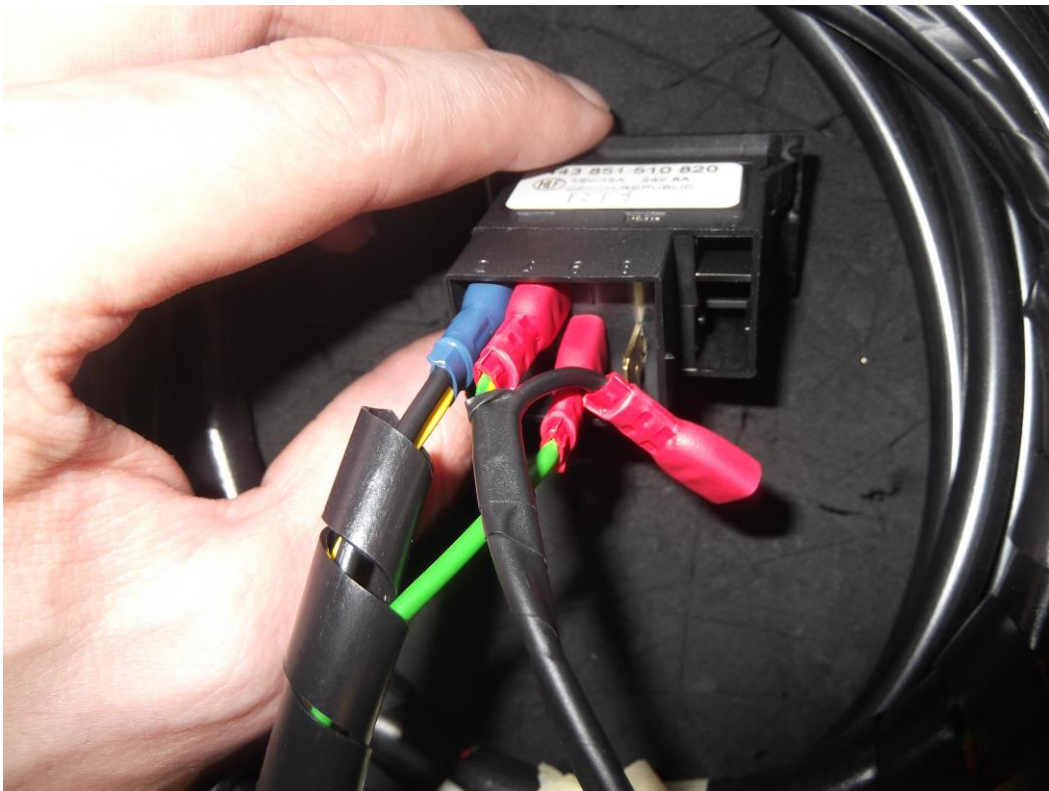

Press the switch into the dashboard.

FOR ALL TECHNICAL QUESTIONS, PLEASE CALL
DFK AMERICA INC.
(630) 324-6793

Connect (earth) the harness branch No.: 4 with the UTV metal body by original screw.
Find the UTV's main electification and find the original cable where is 12V+ after you turn on the main UTV's switch. Connect the harness branch No.: 3 with the original cable from previous step.
You may be have to use different connectors instead of the connectors in the end of harness branch No.:3.

Fill the washer liquide into the washer tank before first usage.

Isolate the washer motor connection by isolating tape very good.



FOR ALL TECHNICAL QUESTIONS, PLEASE CALL
DFK AMERICA INC.
(630) 324-6793

ELECTROINSTALLATION HEATER

Harness



heater holder



Heater

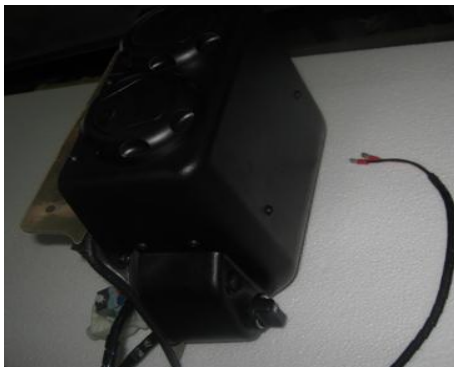

tightening strap



Tube

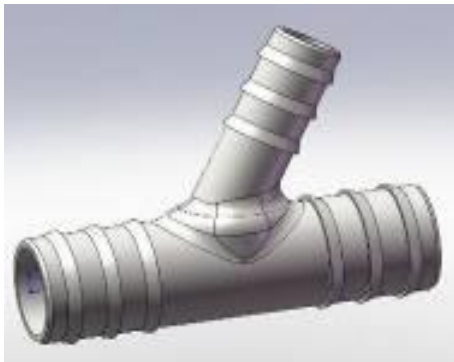

screw rivets



Air vent valve



water pump



Heater is designed to be inside the glove box at the dashboard.

Drill holes (red circle) into the glove box wall and run the heater hoses from the glove box to the engine cooler (under front dashboard).



Connect the heater hoses with the heater assembly. Install the air vent valve onto the hose (without the electric valve) in 10 inch distance of the glove box. **Don't insert the heater assembly into the glow box now!**



FOR ALL TECHNICAL QUESTIONS, PLEASE CALL
DFK AMERICA INC.
(630) 324-6793

Connect the harness branch No.: 1 with the heater harness.

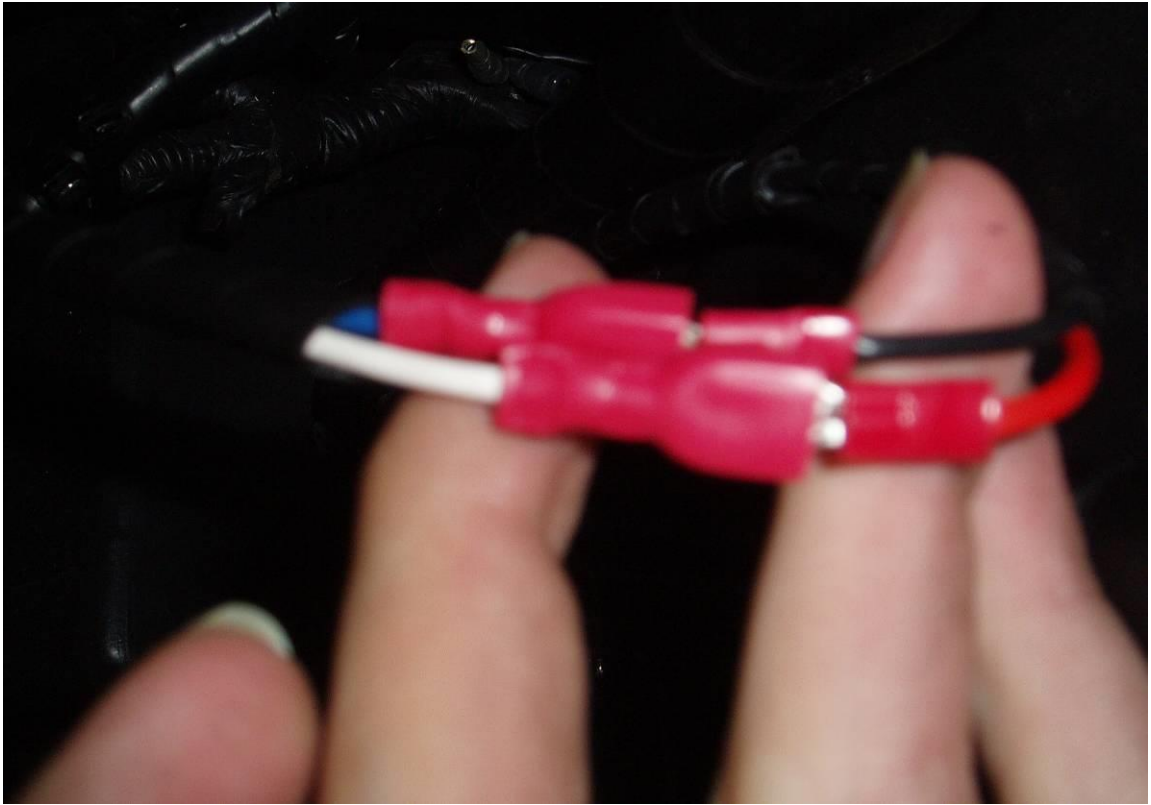

Install the heater hose with air vent valve into the cooling hose by correct "Y" coupling near front cooler.



FOR ALL TECHNICAL QUESTIONS, PLEASE CALL
DFK AMERICA INC.
(630) 324-6793

Install the heater hose with the electric valve into the cooling hose by correct "Y" coupling near front cooler.

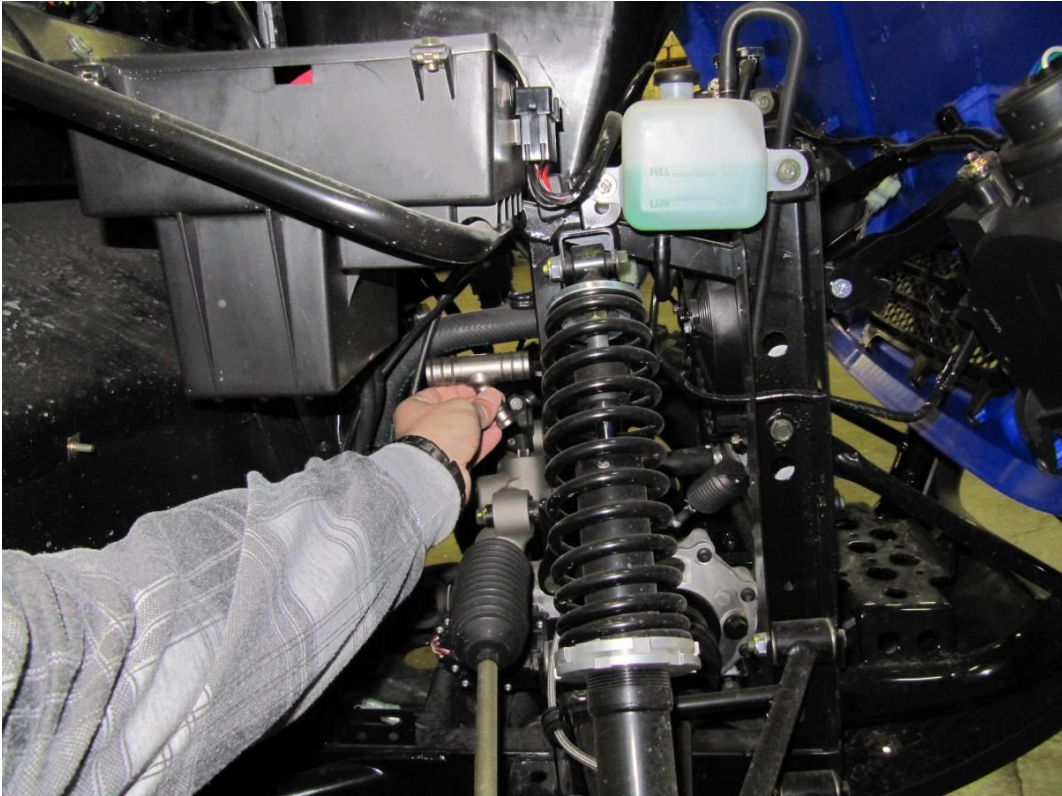

Install the water pump into the hose with the el. valve and tighten straps hard. You can fix the pump by included plastic tapes or by metal tape.



FOR ALL TECHNICAL QUESTIONS, PLEASE CALL
DFK AMERICA INC.
(630) 324-6793

Run the pump harness from the pump to the el. valve.
Connect the pump harness with the el. valve in accordance with the picture.

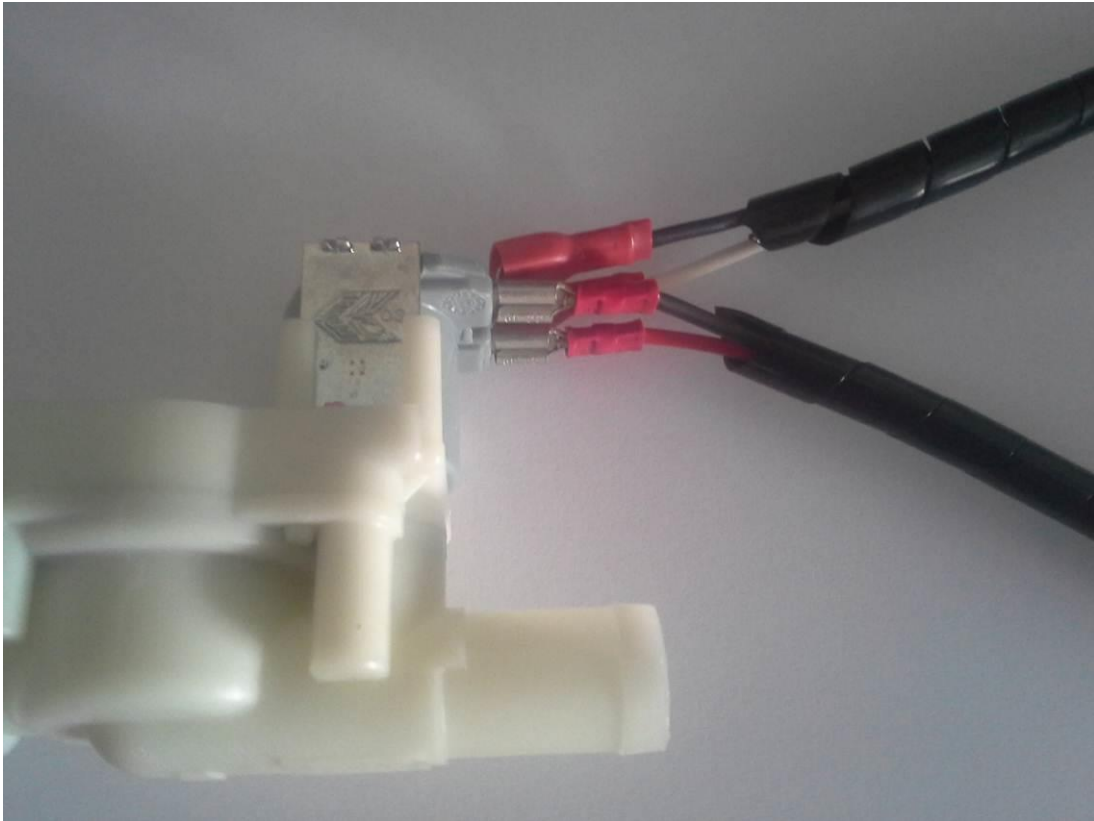

Connect (earth) the harness branch No.: 3 with the UTV metal body by original screw.
Find the UTV's main electification and find the original cable where is 12V+ after you turn on the main UTV's switch. Connect the harness branch No.: 2 with the original cable from previous step.
You may be have to use different connectors instead of the connectors in the end of harness branch No.:2.

- 1. Before the first turning on the hot water heater it is necessary to check the tightness of the cooling circuit of the hot water heater.**
 - 2. Add about 1,5 liter (or more) cooling liquid to the cooling circuit.**
 - 3. Turn UTV's engine on and open the air vent valve.**
 - 4. Turn heater on and wait for the maximum temperature.**
- Move heater down and turn that down to run the air out from heater.**
When the cooling liquid starts to leak from the air vent valve close the valve.
Turn off heater and add more cooling liquid to the cooling circuit if need it.

After you perfectly bleed the air out of the UTV's engine cooling system and heater system, you can insert the heater into the glove box and fix the heater holder by the plastic rivet screws.

SEE NEXT PAGES

Important notice:

In cab units where you are installing the glove compartment heater provided in the standard DFK Cab Kit, it is important to check the coolant level regularly at least 4-5 times during the first several days of operation and fill as necessary until the coolant level has stabilized.

The heater will draw and retain coolant, sometimes at the expense of coolant to the engine.

This can cause engine overheating if not managed properly.

Heater assembly installed.

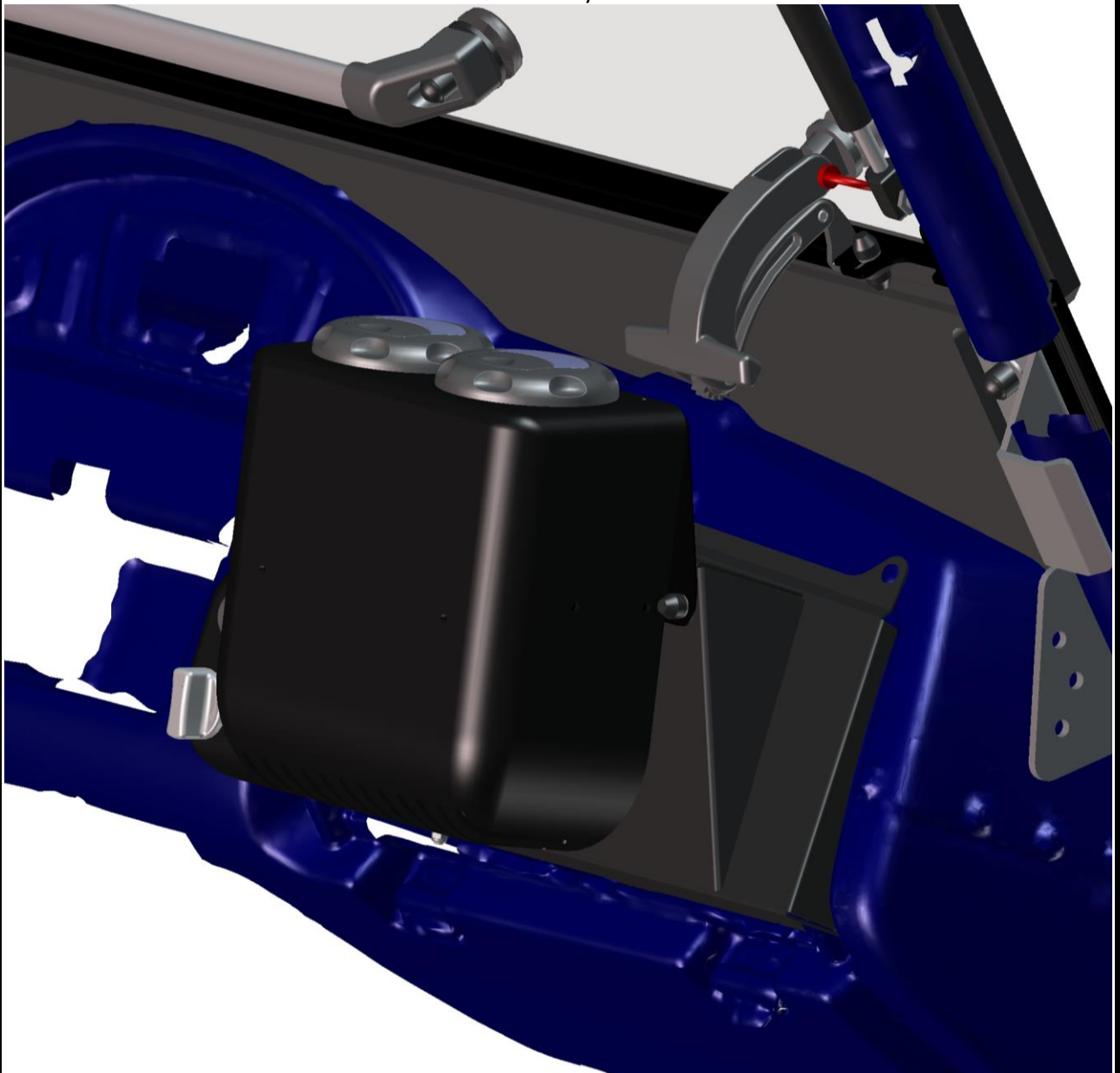

58