



*INSTALLATION INSTRUCTIONS*

**KAWASAKI**

**MULE FX(DX)**





## **SAFETY INSTRUCTIONS**

***Warning: Failure to heed all safety and operating instructions and warnings regarding use of this product can result in serious bodily injury.***

### ***READ PROPERLY COMPLETE ASSEMBLY INSTRUCTIONS BEFORE STARTING OF ASSEMBLY***

***Install all parts indicated in assembly instructions. Failure to fully assemble product before use could result in personal injury.***

***Assembly of product requires use of hand or power tools.  
If you are not experienced in using these types of tools,  
have product dealer do the install for you.***

***Some parts contain sharp edges, wear protective gloves if necessary.***

***Always keep your assembly area clean, uncluttered and well lit.***

***Keep visitors and children a safe distance away from the assembly area. Visitors should wear the same safety equipment described under.***

***Never operate your UTV with the cab doors open. Failure to properly latch the doors before moving the vehicle could result in serious injury.***

***Dress for safety. DO NOT wear loose clothing, gloves, neckties or jewelry if using power tools to assemble this product.***

***Insert all nut covers after you finish installation.***

***Never drive your UTV with the cab front window in open position.  
Failure to properly latch/lock front window before driving the vehicle could result in serious injury.***

***Please be careful not to break the plastic washers, if you're tightening screws with plastic washers use maximum torque of 3.7 foot-pound force (5 Nm)!!!***

**WARNING: For safety purposes, if the DFK Cab doors are removed, it is mandatory that the OEM manufactured Half Doors or Nets are REINSTALLED before operating the vehicle.**

### **MAINTENANCE AND CLEANING**

***To clean polycarbonate surface use soapy water solution or other subtle means.***

***Dirt and dust wash by gently water stream and swipe only with wet or damp means in the direction from top to bottom.***

***The recommended frequency of cleaning of polycarbonate part is about 1 time per month or according to the actual degree of pollution.***

***Do not use detergents that could scratch the surface plates.  
(abrasives, harsh fabrics, etc.)***

***Do not use solvents or alkaline detergents or cleaners with ammonia  
(ammonium hydroxide).***

***Do not remove the impurities from the surface of the razor blades or other sharp items.***

***Do not clean cabin when the polycarbonate plates are heated by the sun.***

***Do not use the squeegee, it could be scratched surface plates.***

***Do not clean the water current strength greater than 50 bar (WAP)***

***The manufacturer is not responsible for scratching the surface in case of failure to comply with the above instructions.***

***All bolted connections of cab must be by user at regular intervals checked and tightened.***

**PREPARATION FOR INSTALLATION:**

Uninstall all additional systems from the roller cages (work lights, rear mirrors, drink holders etc.)

**CAB PREVIEW**

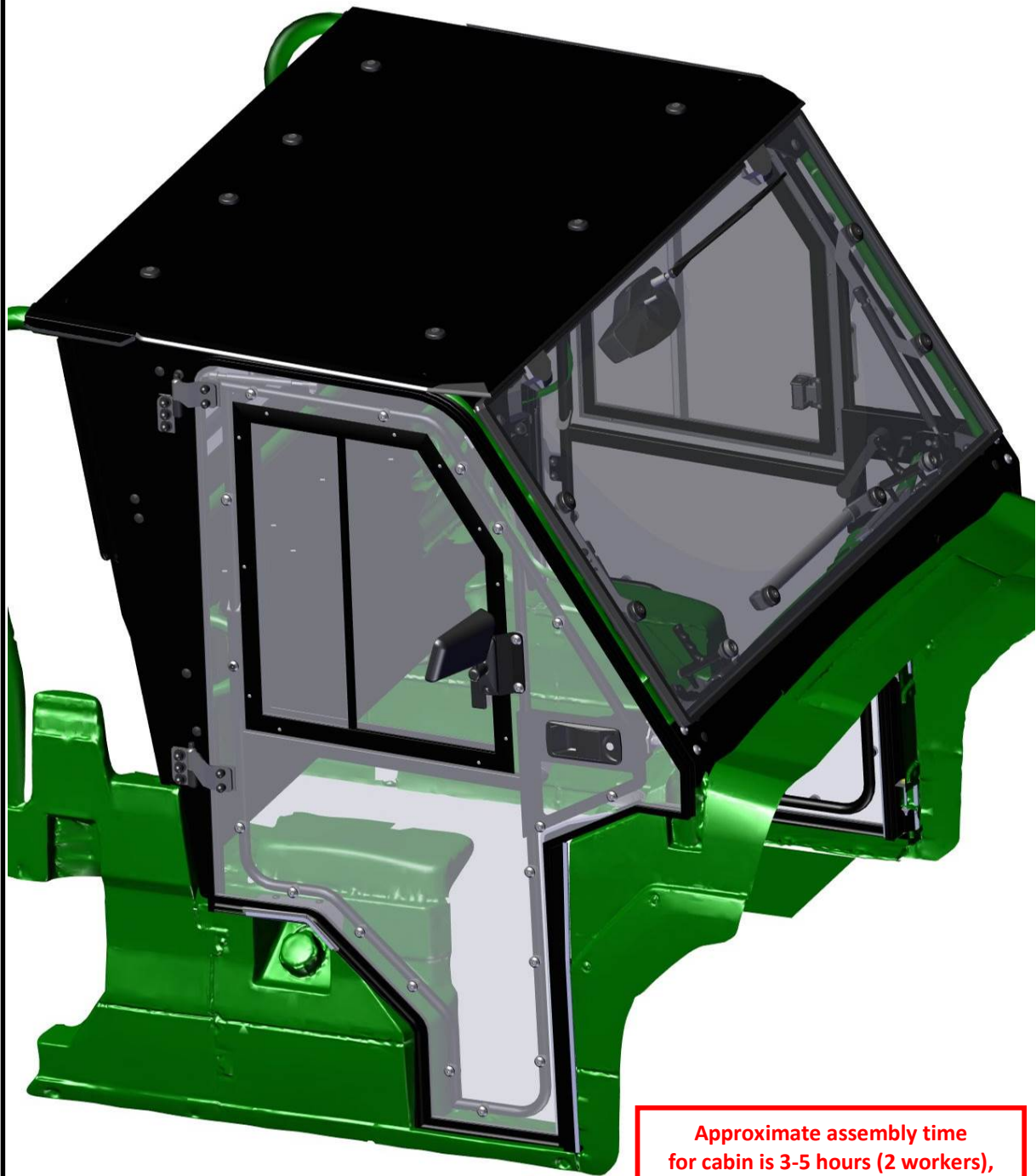

Approximate assembly time  
for cabin is 3-5 hours (2 workers),  
for heater 3-4 hours (1 worker).



**WIPER/WASHER 1.**

Overall wiring diagram.

WASHER

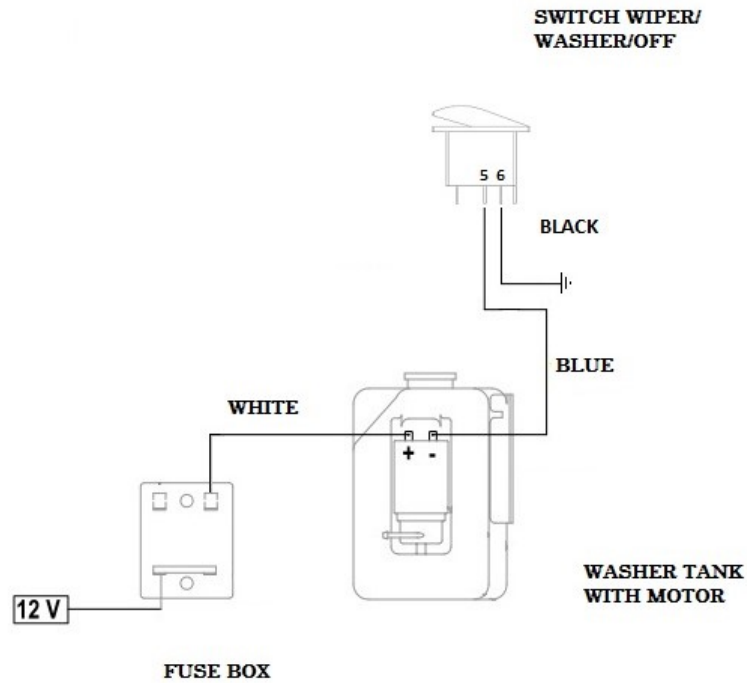

WIPER

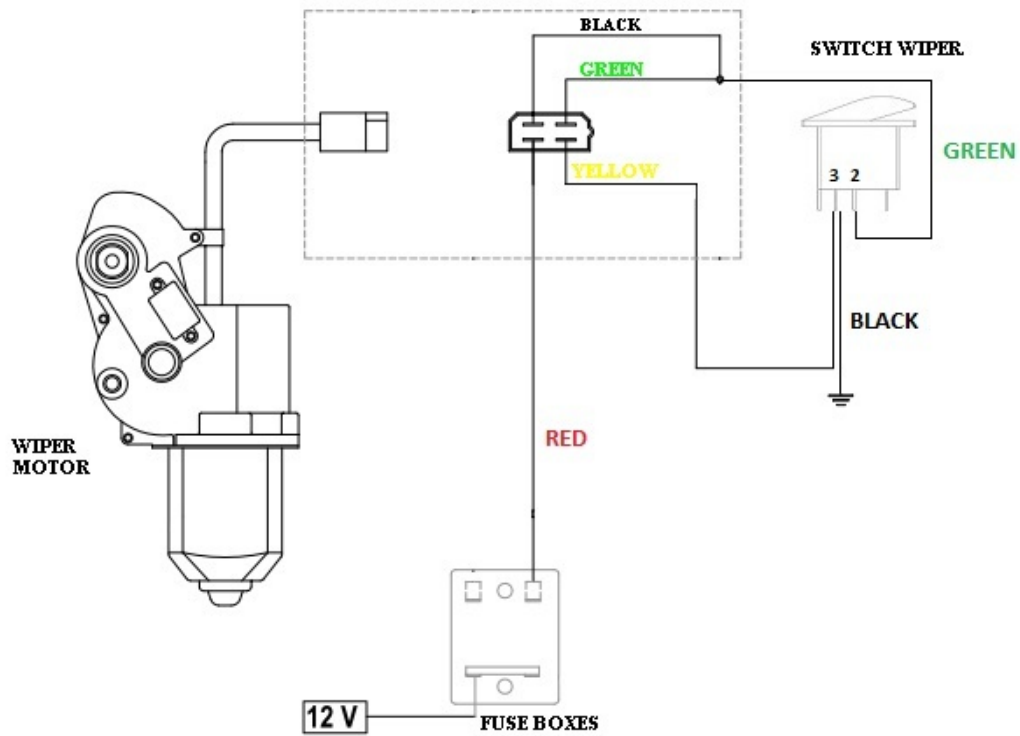

FOR ALL TECHNICAL QUESTIONS, PLEASE CALL

DFK AMERICA INC.

(630) 324-8585

Connect the washer harness branch to the washer motor.  
Install the washer tank into the front boot space.



6

Lead the wiper harness branch with the washer tube alongside the right roller cage ledge.



FOR ALL TECHNICAL QUESTIONS, PLEASE CALL  
DFK AMERICA INC.  
(630) 324-8585

Lead the wiper/washer switch branch through the dashboard and connect the harness to the switch.



Press the switch into the dashboard. **INSTALL ALL PLASTIC COVERS BACK.**





**REAR PANEL 1.**

Uninstall original screws from the UTV roller cage, bottom screws on the sides and upper in the middle (red circles), save these for later use.

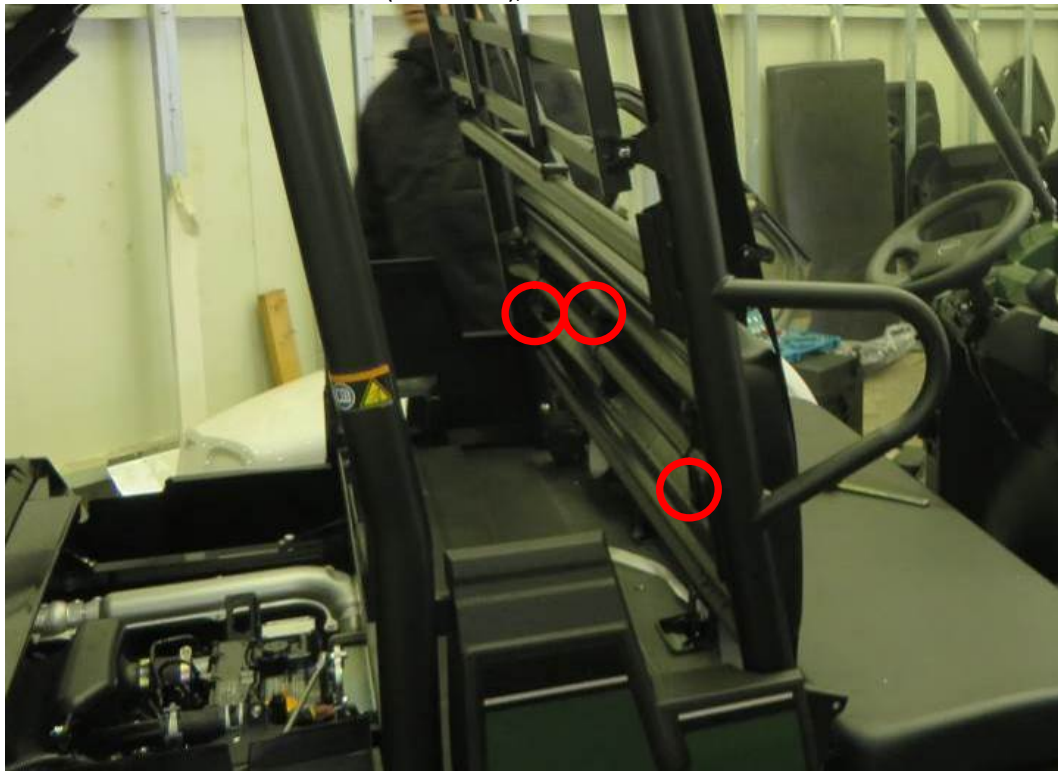

Uninstall original rear grill from UTV roller cage.



FOR ALL TECHNICAL QUESTIONS, PLEASE CALL  
DFK AMERICA INC.  
(630) 324-8585



Loosen the rear bottom panel holders screws and place the rear bottom panel onto the UTV roller cage.

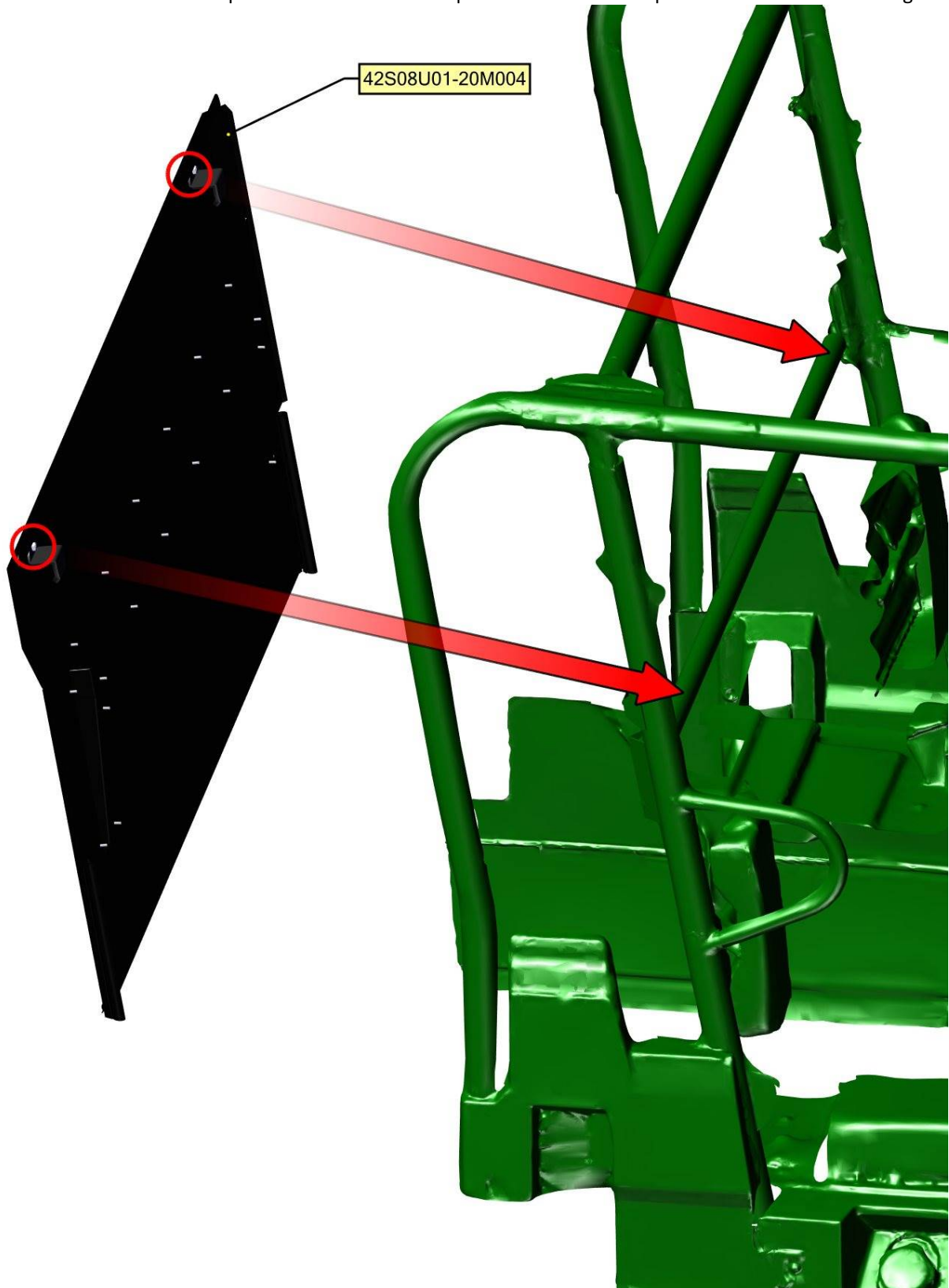

Adjust the rear bottom panel holders into correct position and tighten screws correctly.



10

Fix the rear bottom panel with the UTV roller cage by original screws from previous steps and included washers.



11

DETAILED VIEW



12



LEFT DOOR + RIGHT DOOR 1.

Uninstall the pre-installed door base holder "Ω" from the right door base.

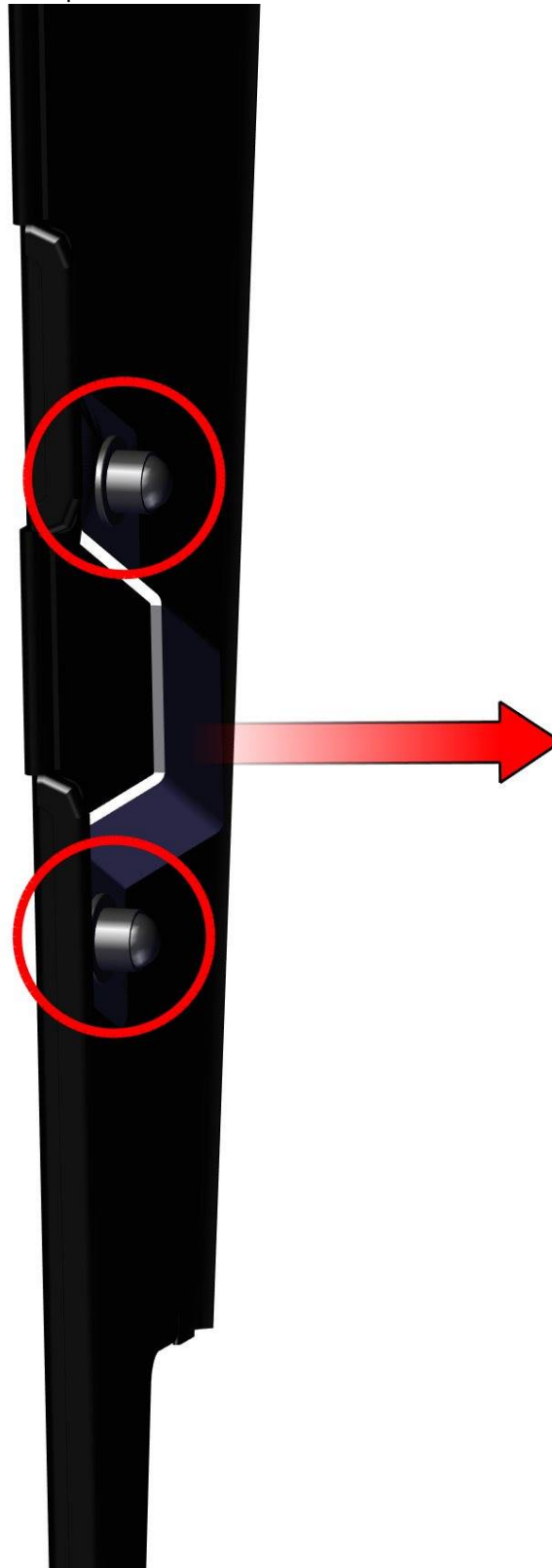

Loosen the upper door base holders screws and place the right door base onto the UTV roller cage.

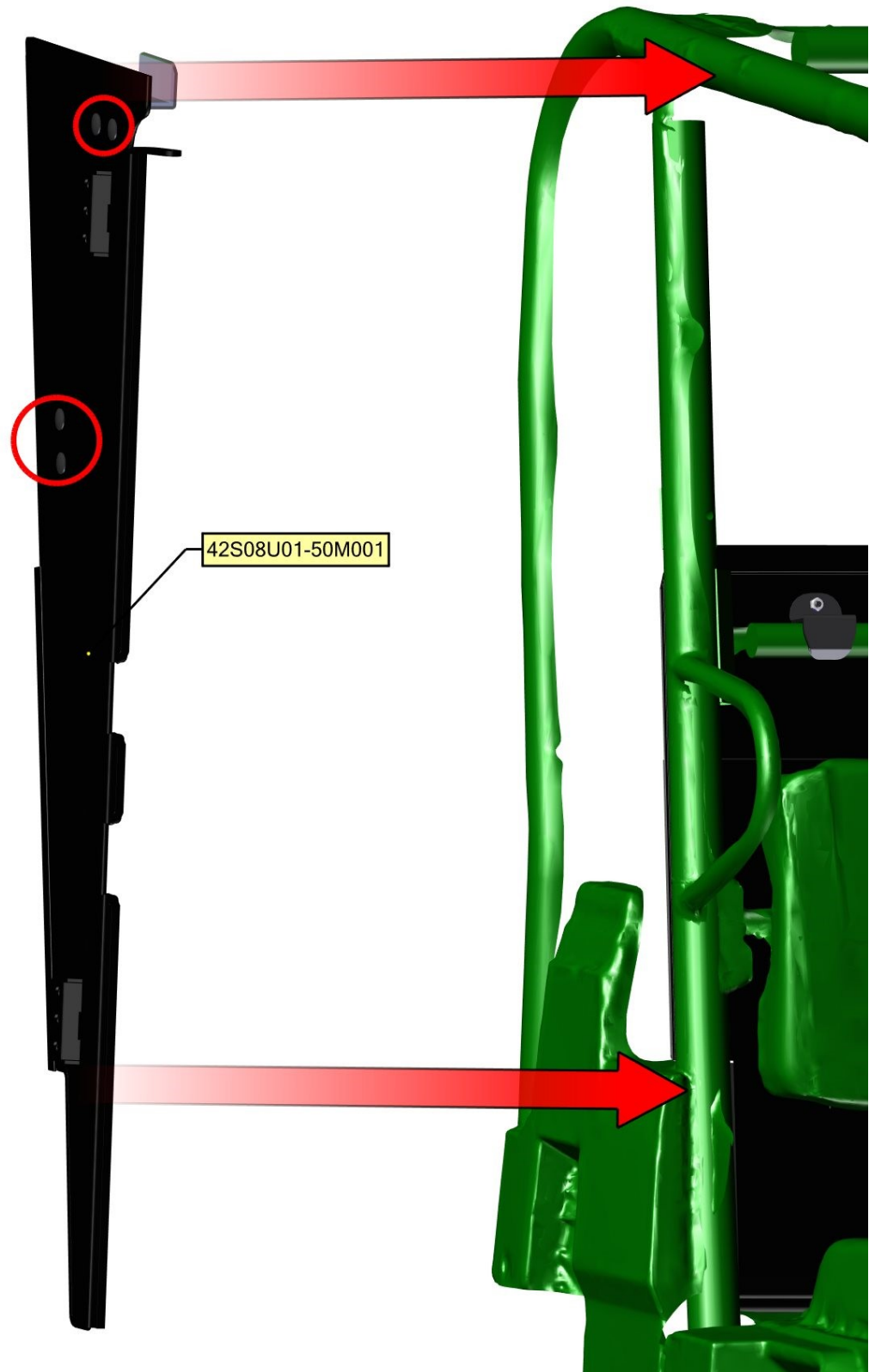

14

Adjust the right door base into correct position and tighten screws correctly.

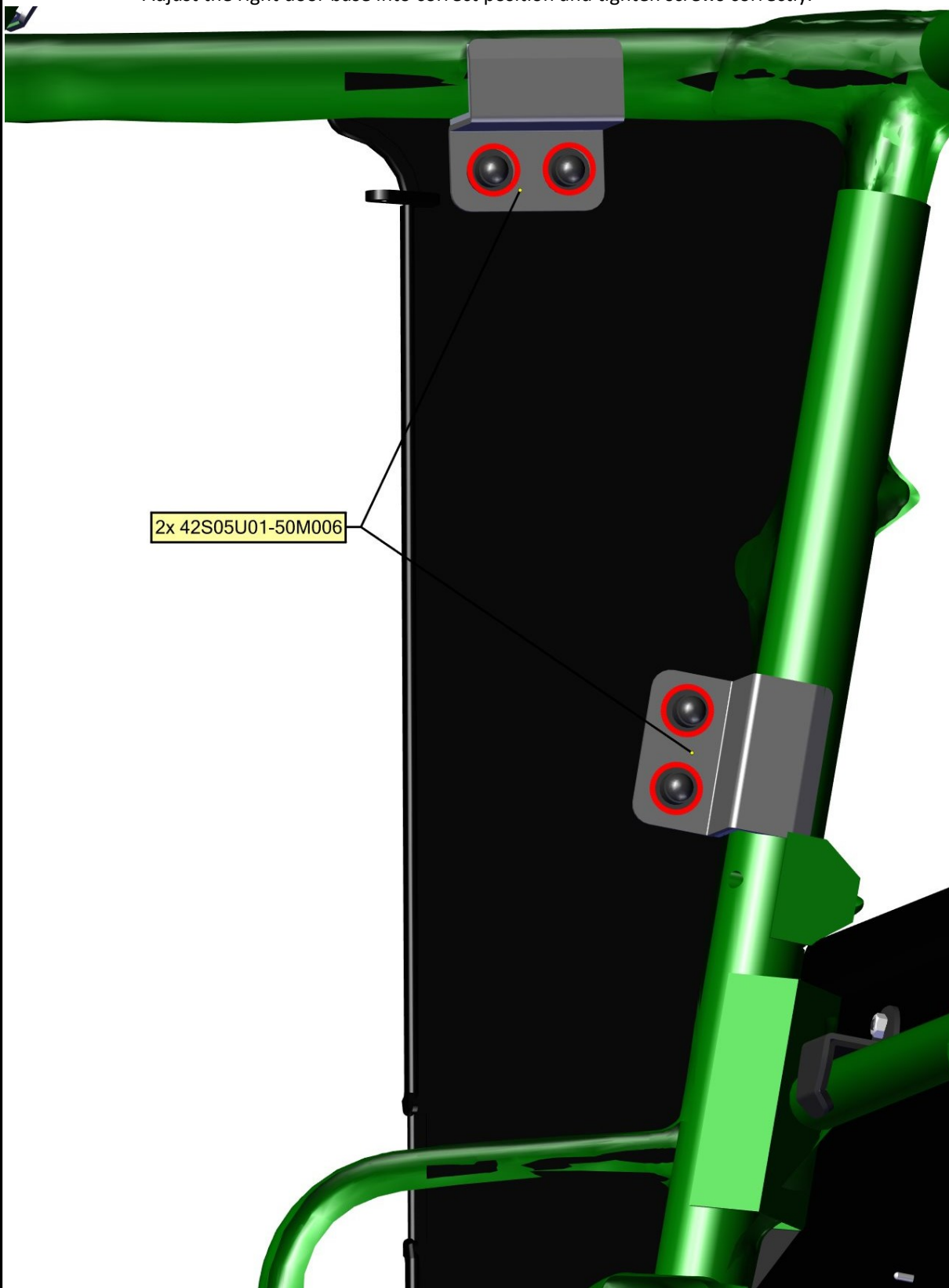

15

Place the door base holder "Ω" into the position and fix by included fixing assemblies.

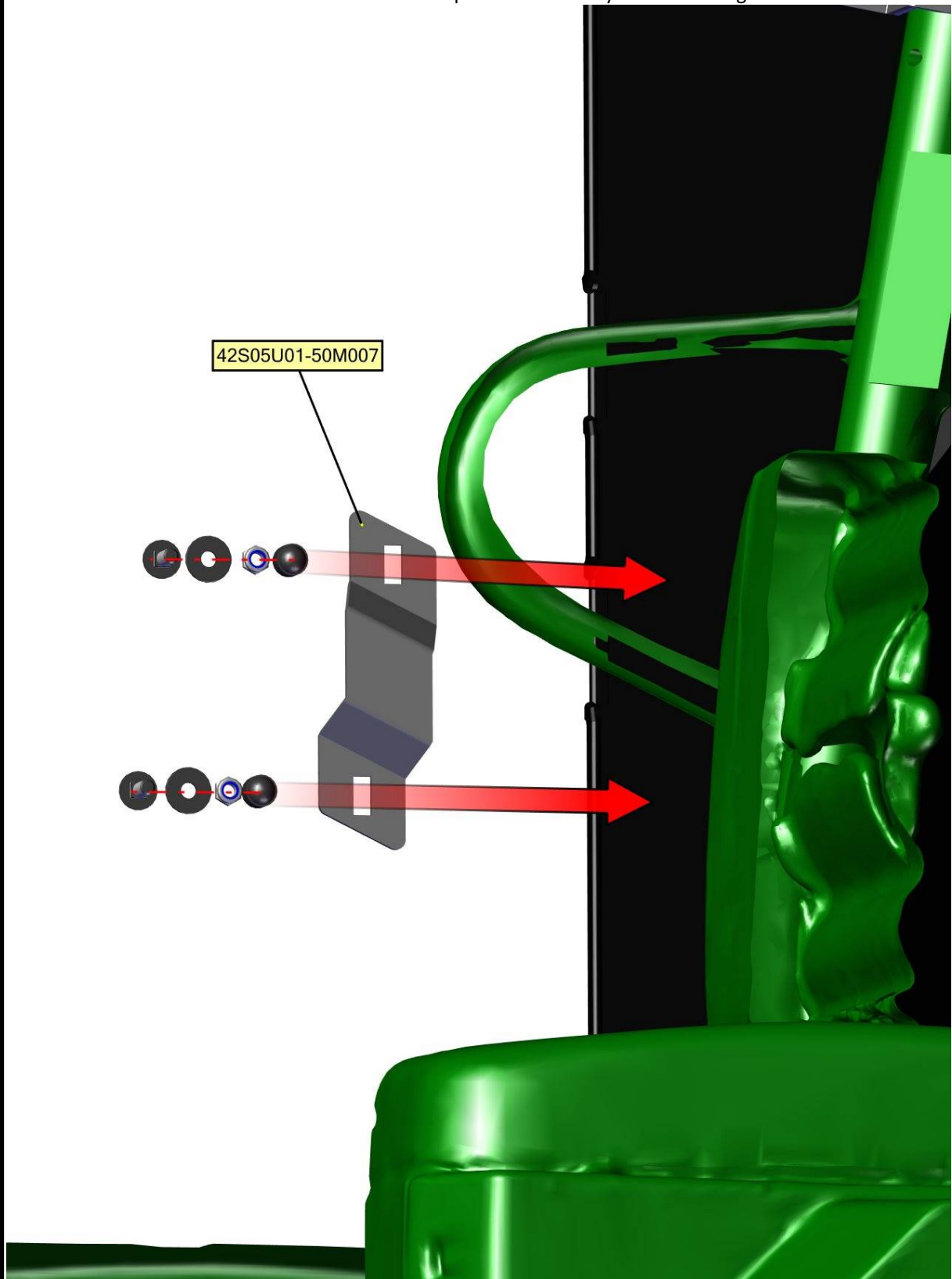

16



## DETAILED VIEW



17

FOR ALL TECHNICAL QUESTIONS, PLEASE CALL  
DFK AMERICA INC.  
(630) 324-8585

Repeat previous steps with the lefto door base assembly.



18



REAR PANEL 2.

Loosen the rear upper panel holder screws and place the rear upper panel onto the UTV roller cage.

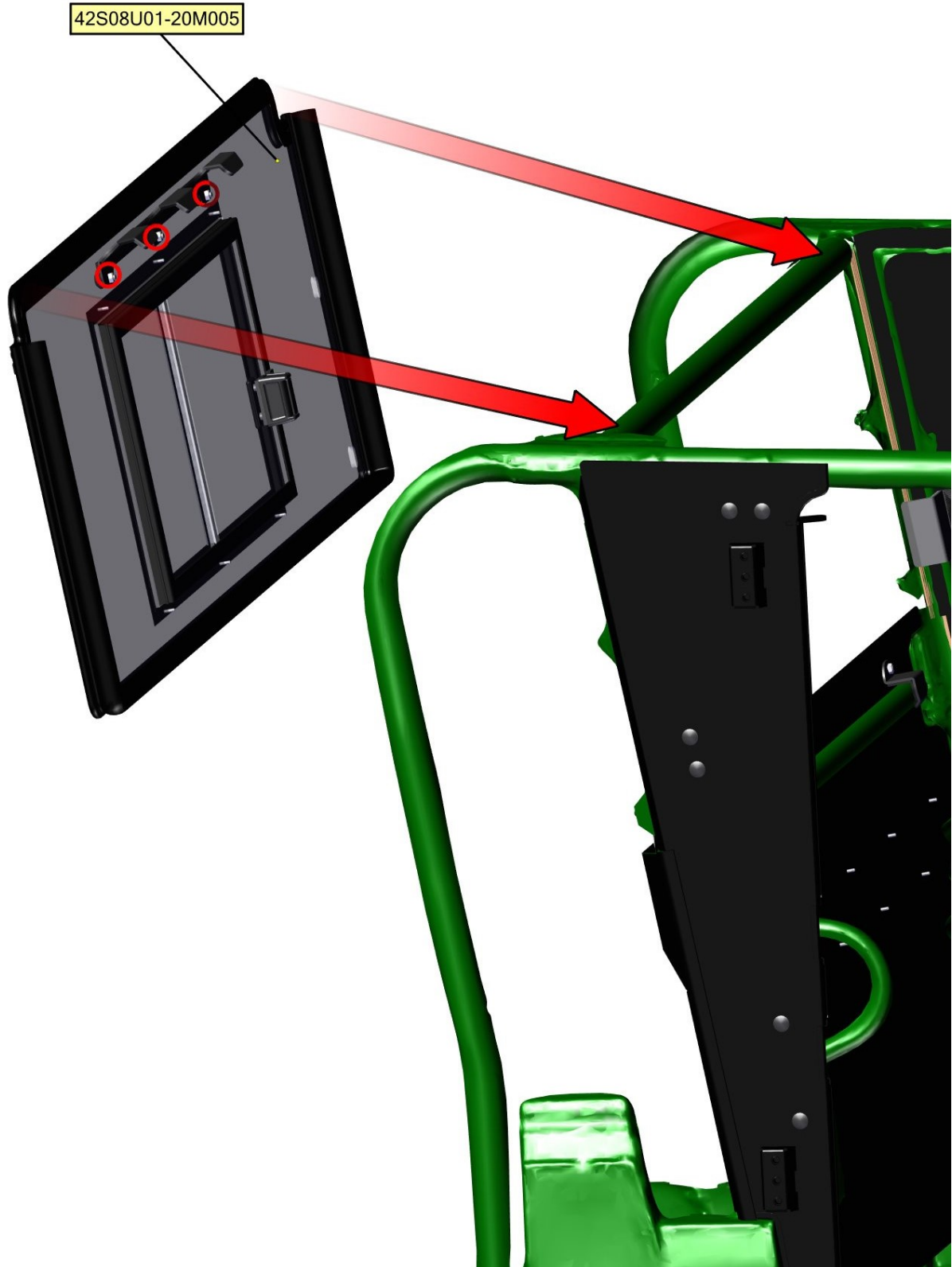

19

Adjust the rear upper panel into the best position and tighten holders screws correctly.

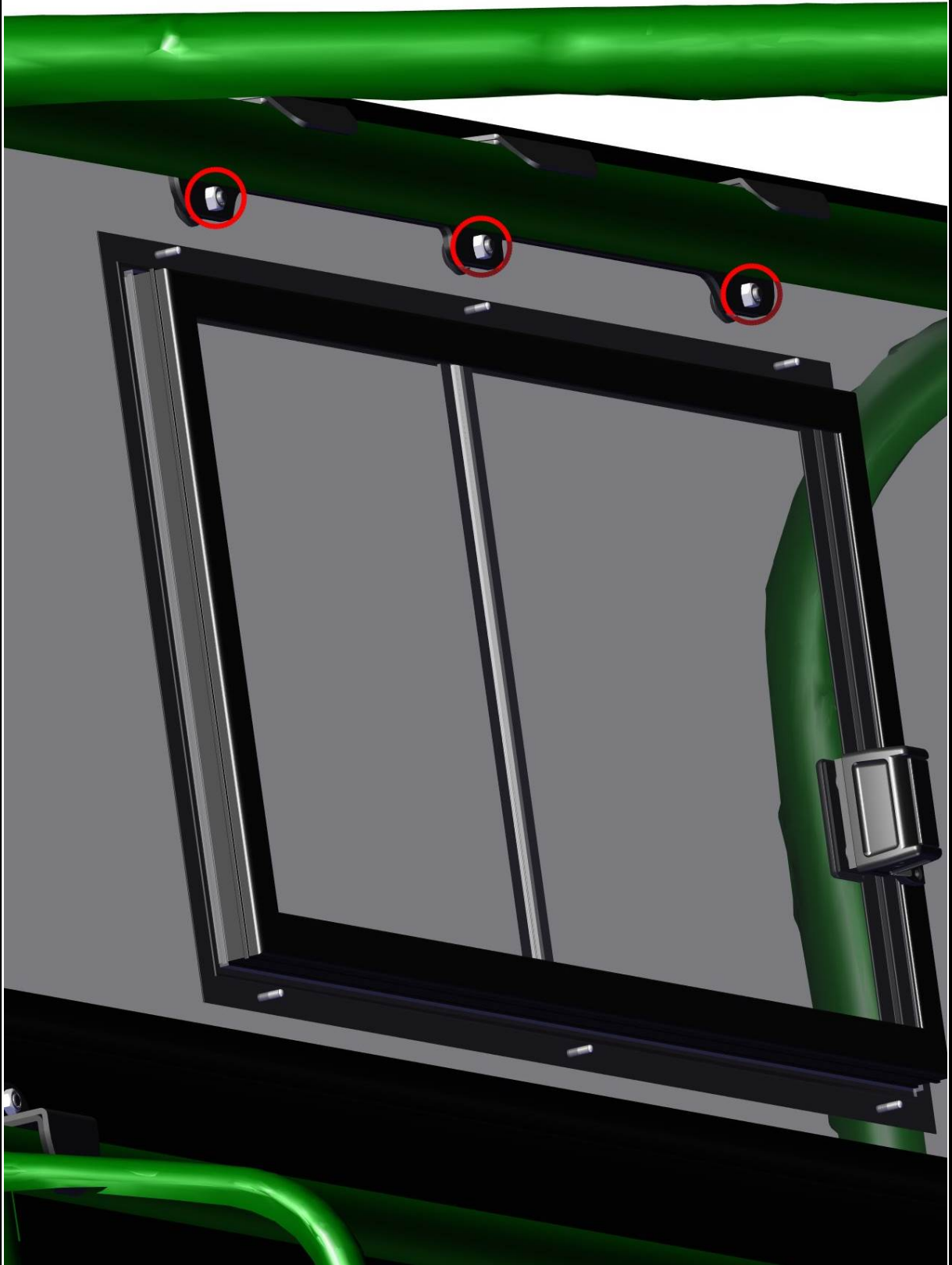

20

FOR ALL TECHNICAL QUESTIONS, PLEASE CALL  
DFK AMERICA INC.  
(630) 324-8585



**WITHOUT THE REAR GRILLE**

Fix the rear polycarbonate with the UTV roller cage by included fixing assemblies on both sides, using original holes.

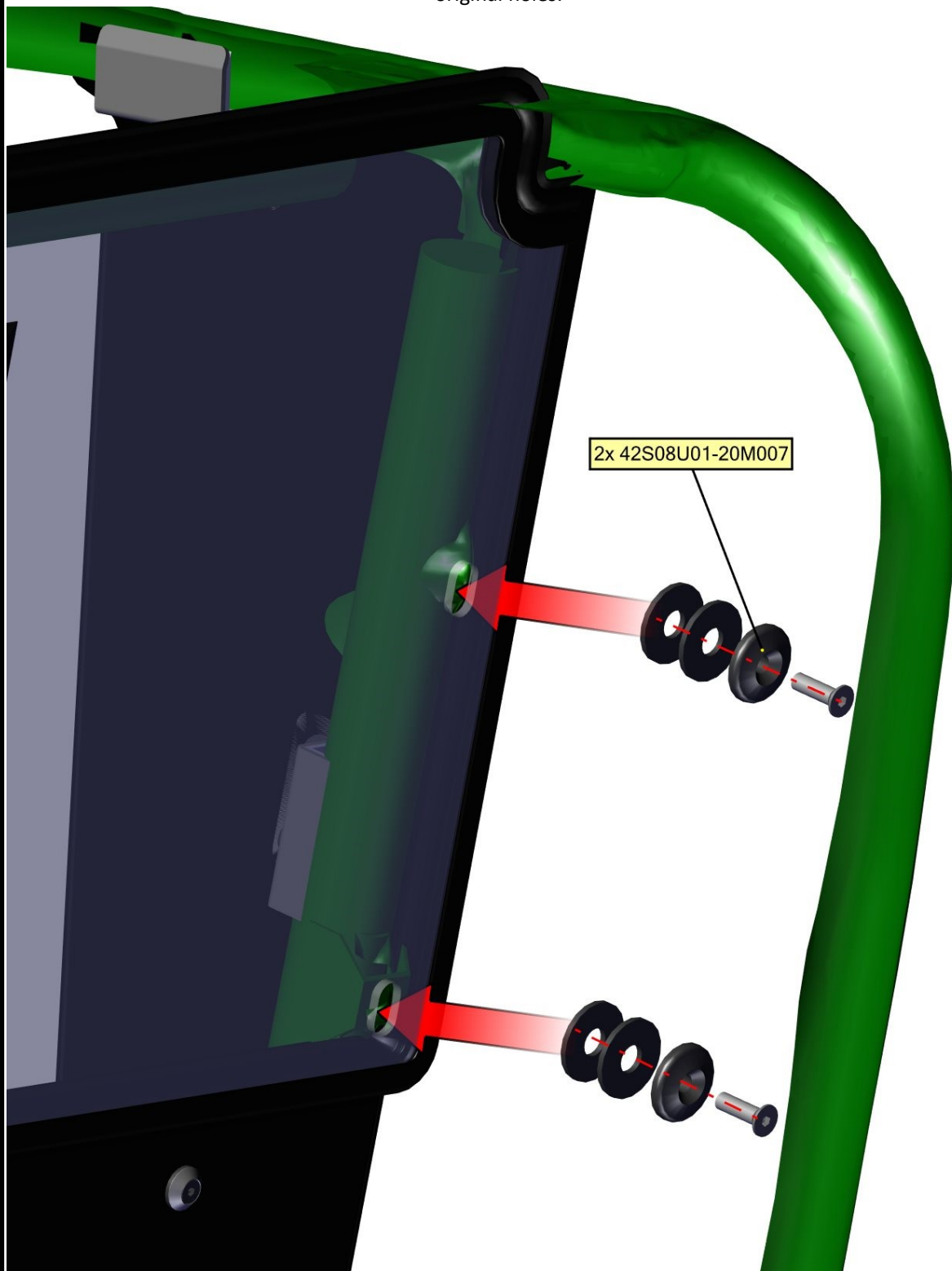

21

**WITH THE REAR GRILLE**

Place the rear grille into the position.

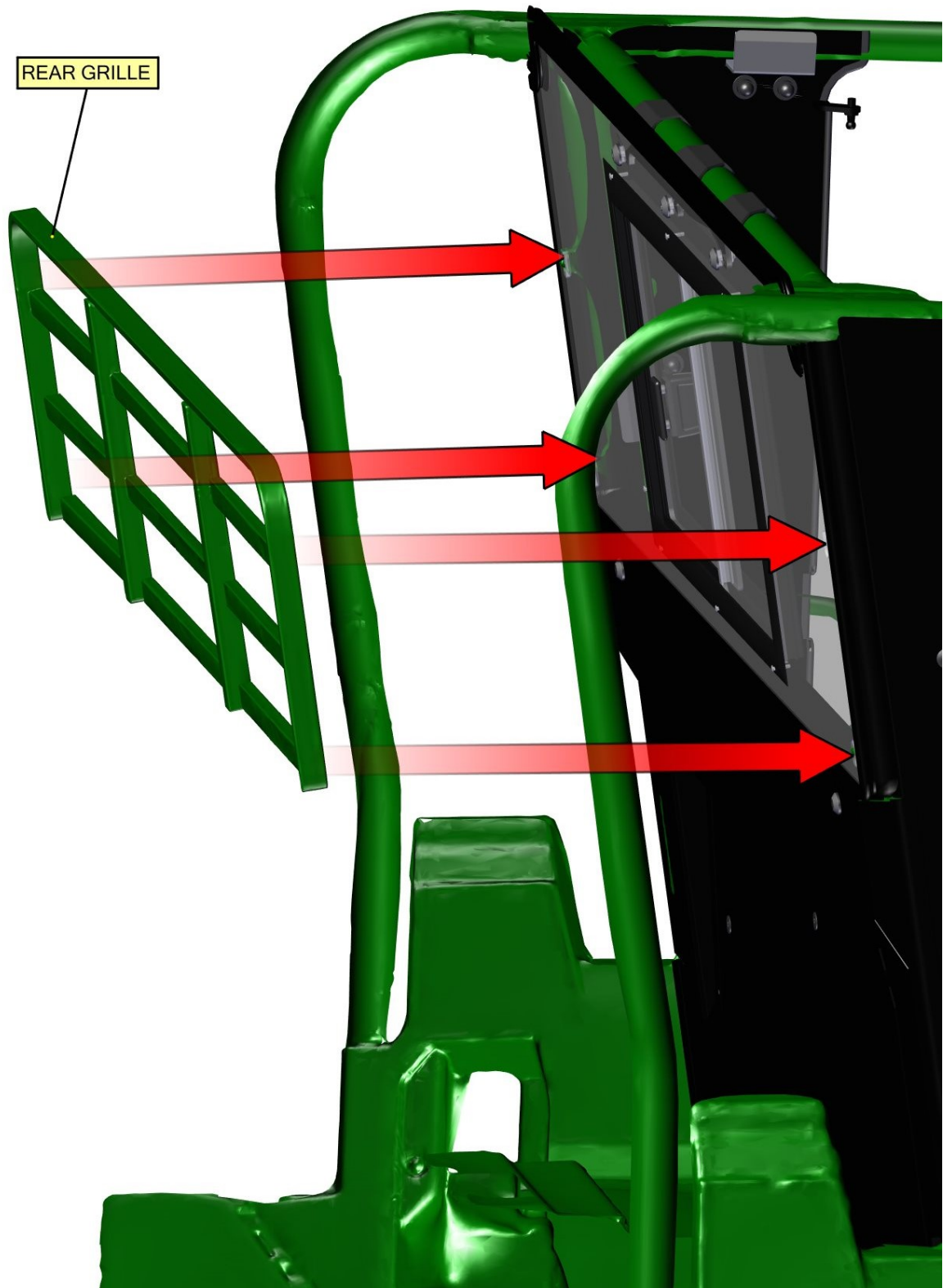

Fix the rear polycarbonate and the rear gille with the UTV roller cage by included fixing assemblies on both sides, using original holes.

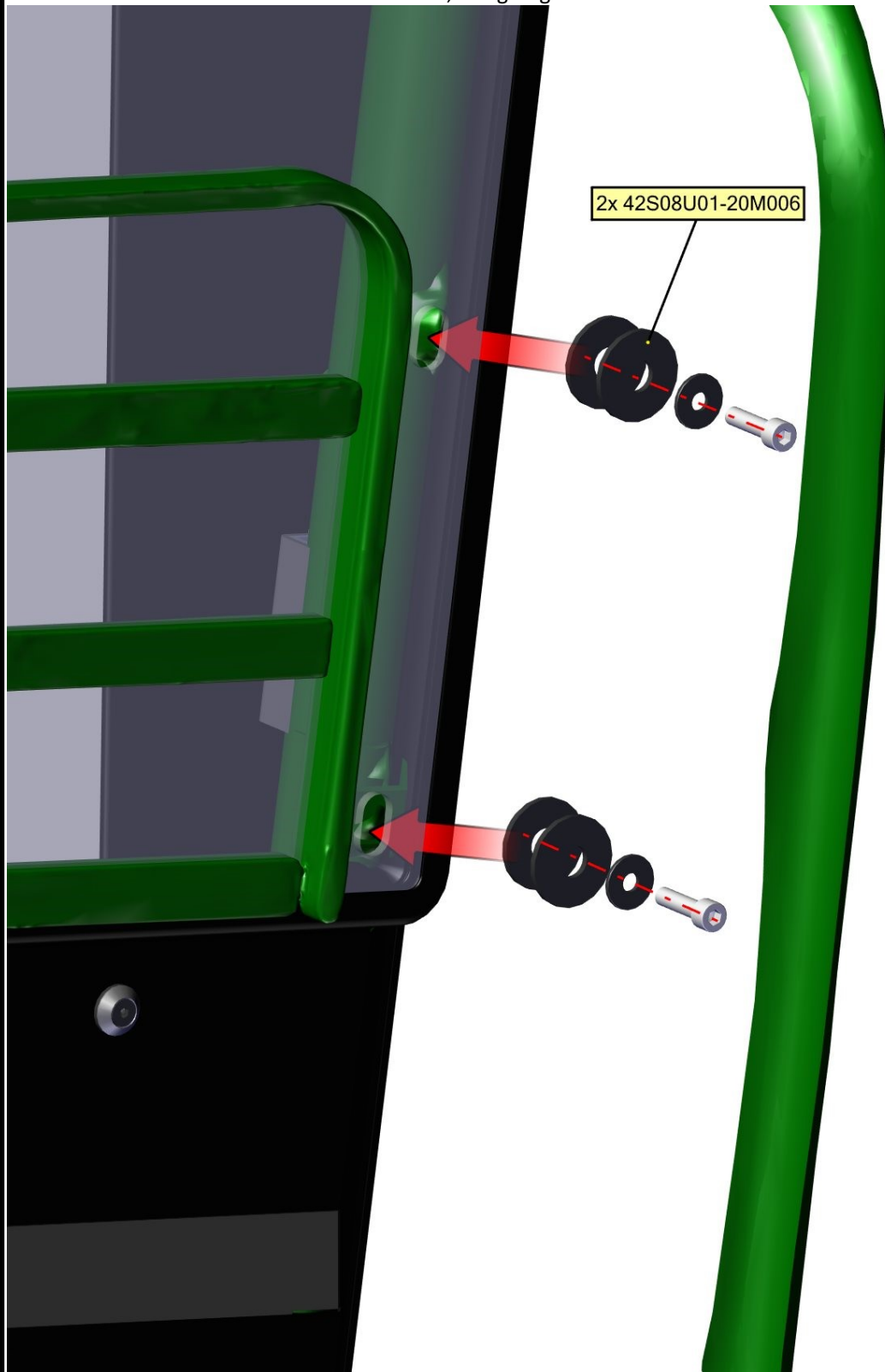

FRONT PANEL 1.

**One by one** replace the original screws (red circle) by included screws from inner side (next page) on both sides.





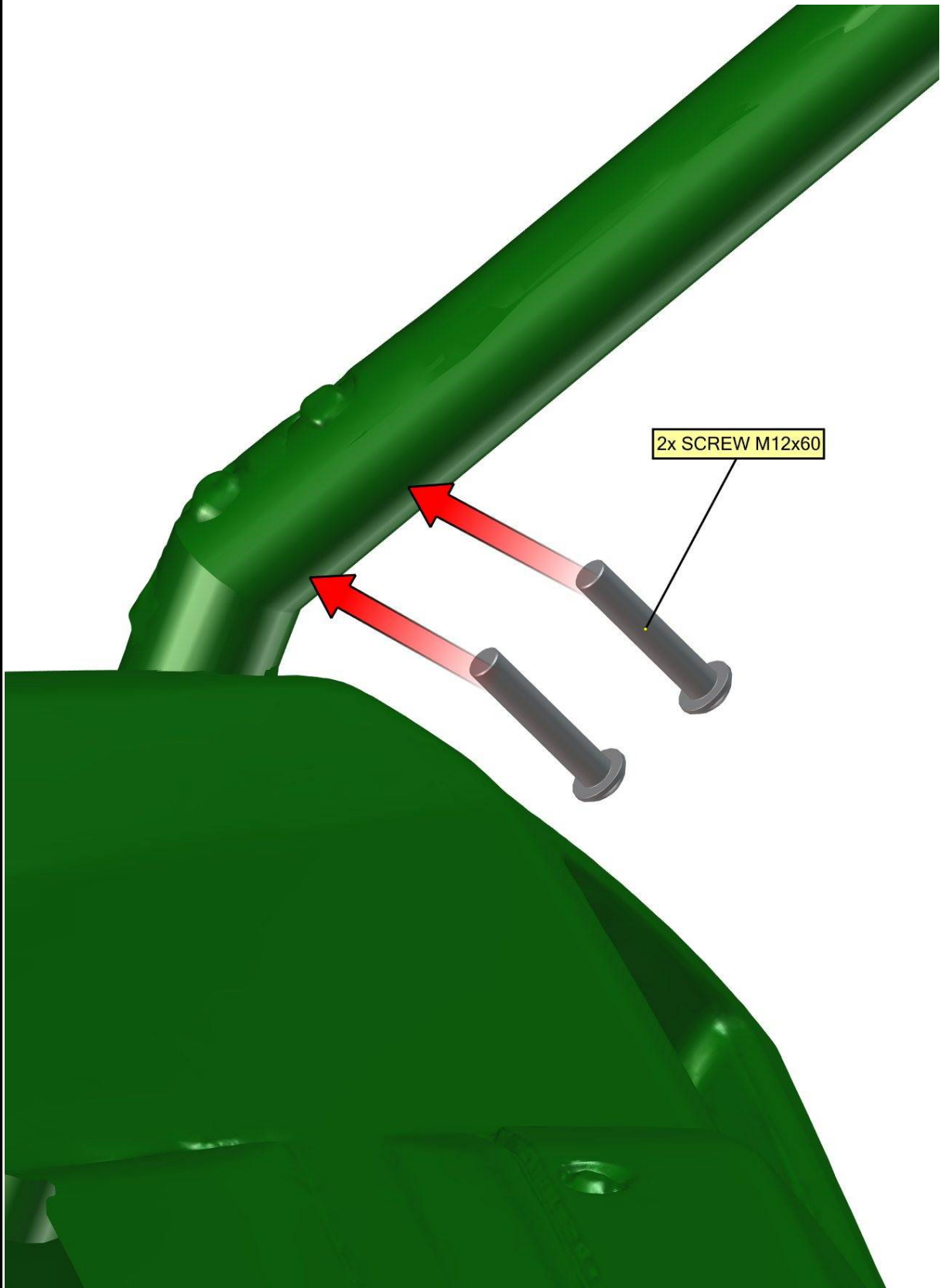

Place front bottom ledge onto the UTV roller cage.

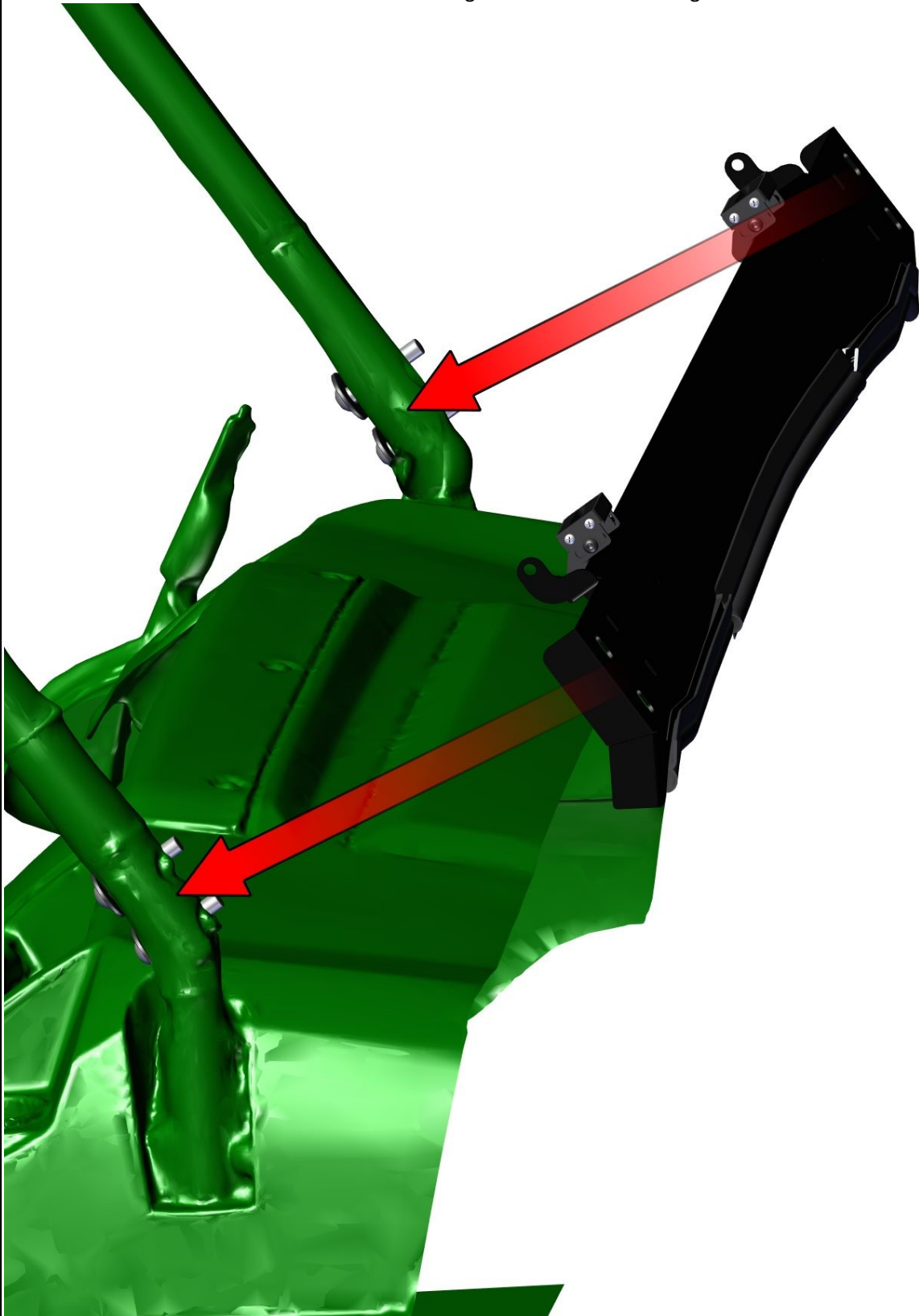

**One by one** replace the screws from the outer side and fix the front bottom ledge with the UTV roller cage on both sides.

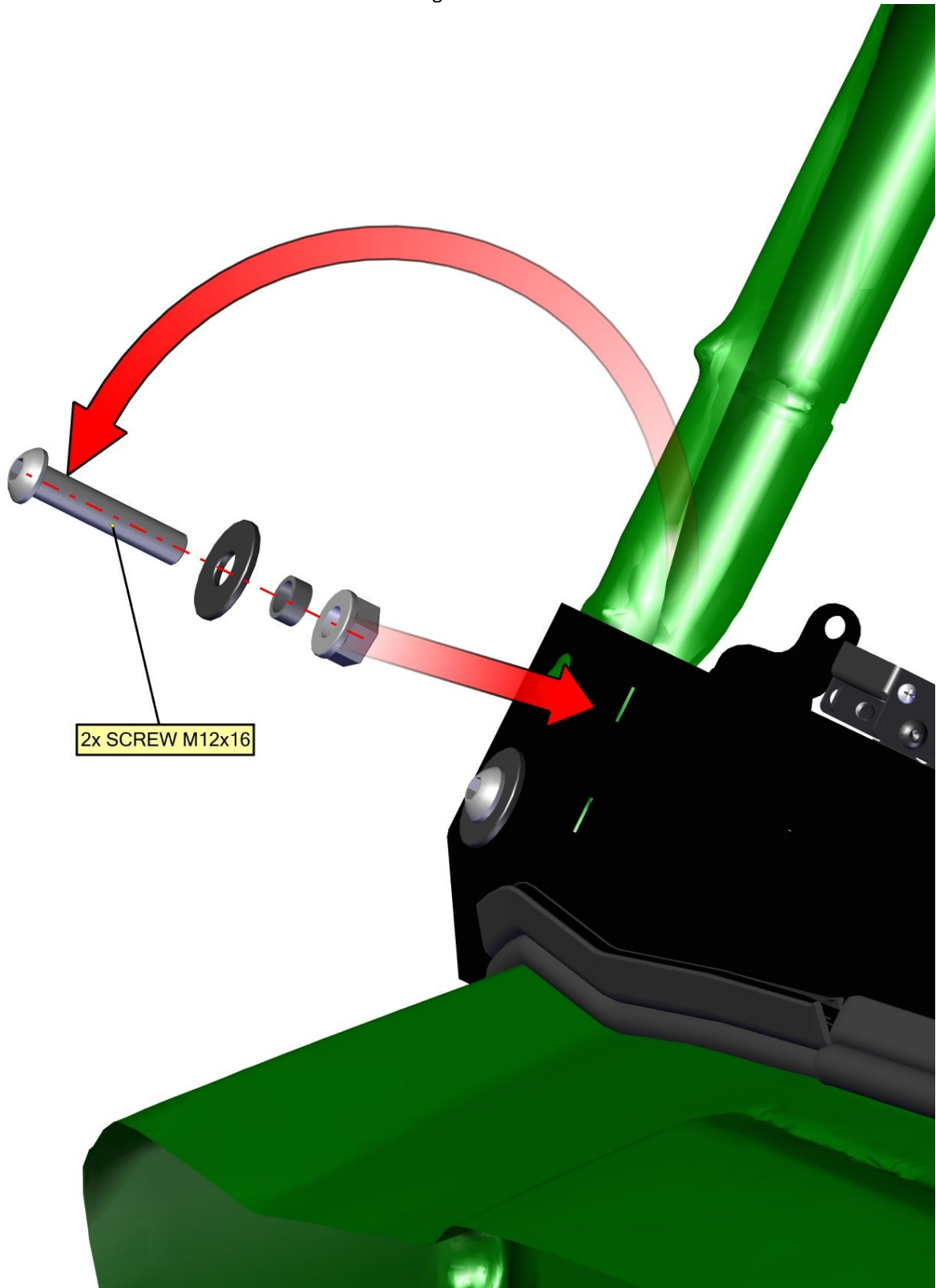

Insert the included front door stop holder screws into the front bottom ledge holder holes.

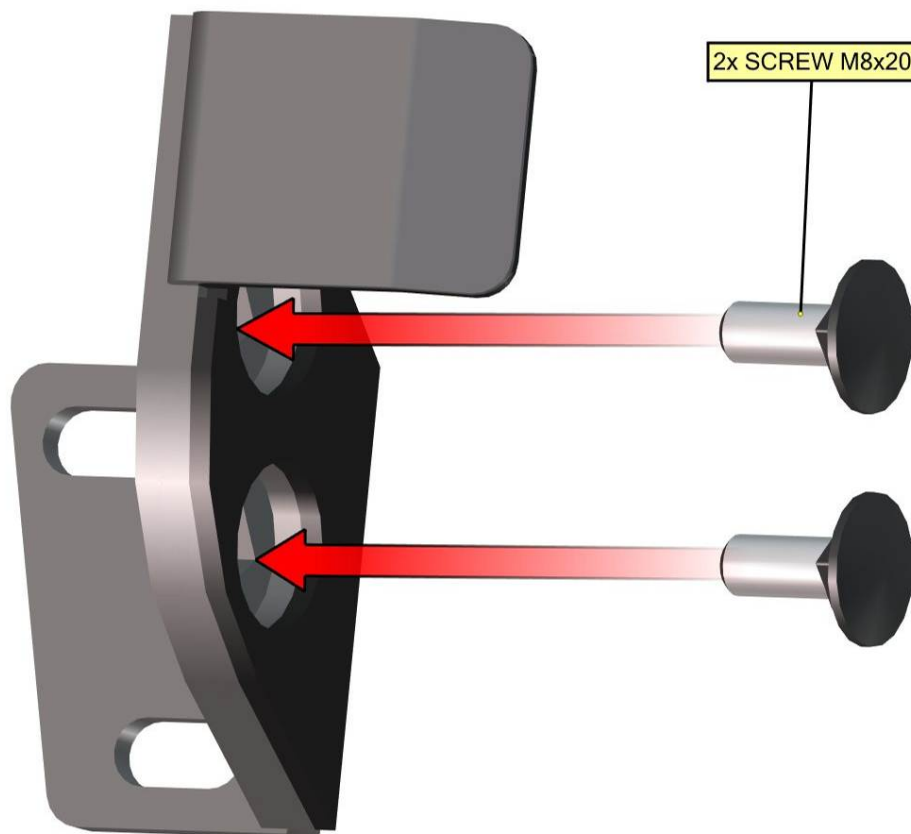



Place the front bottom ledge holder with the screws onto the front bottom ledge and fix by included screws, washers, nuts and covers on both sides.

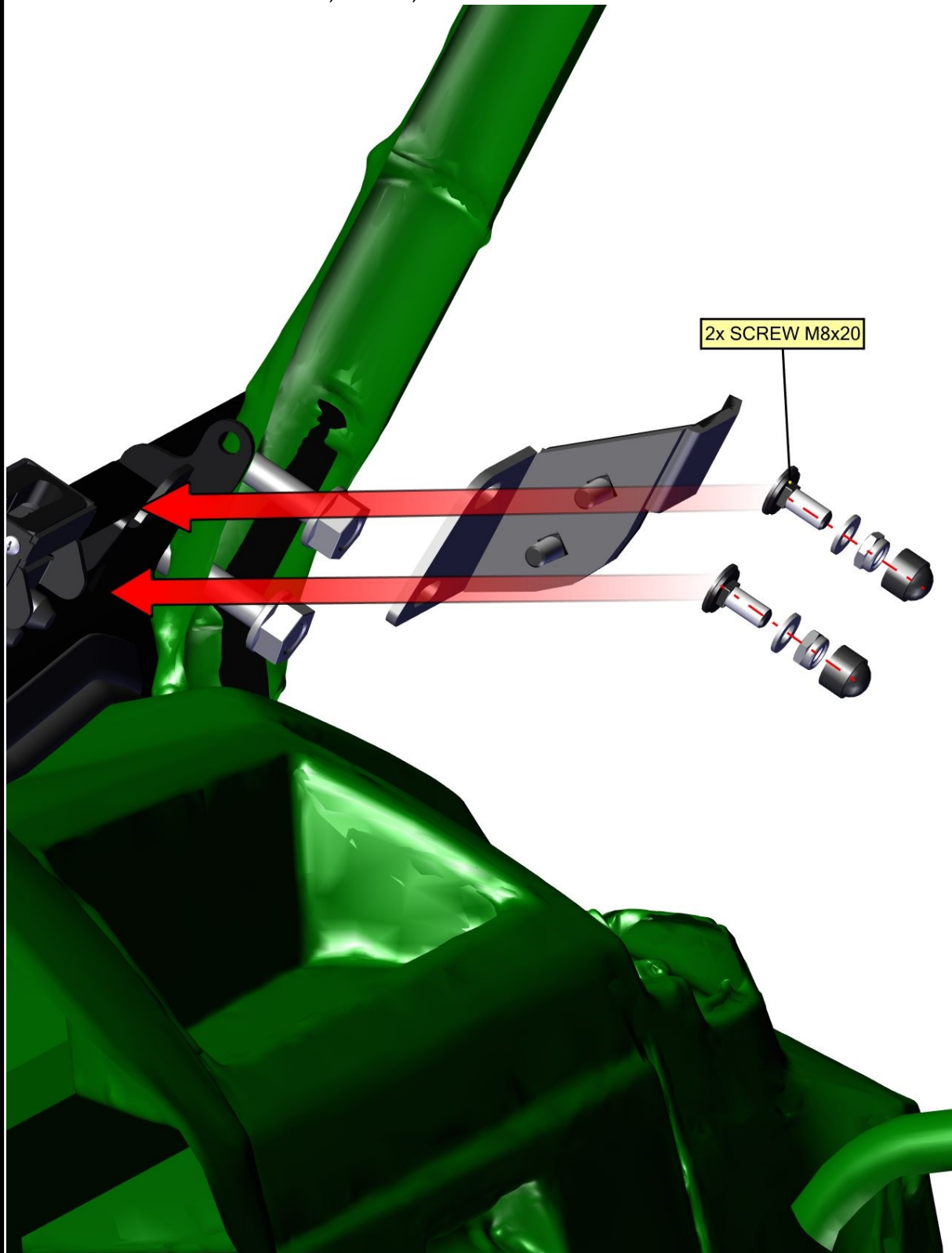

29

Place the front upper ledge onto the UTV roller cage.

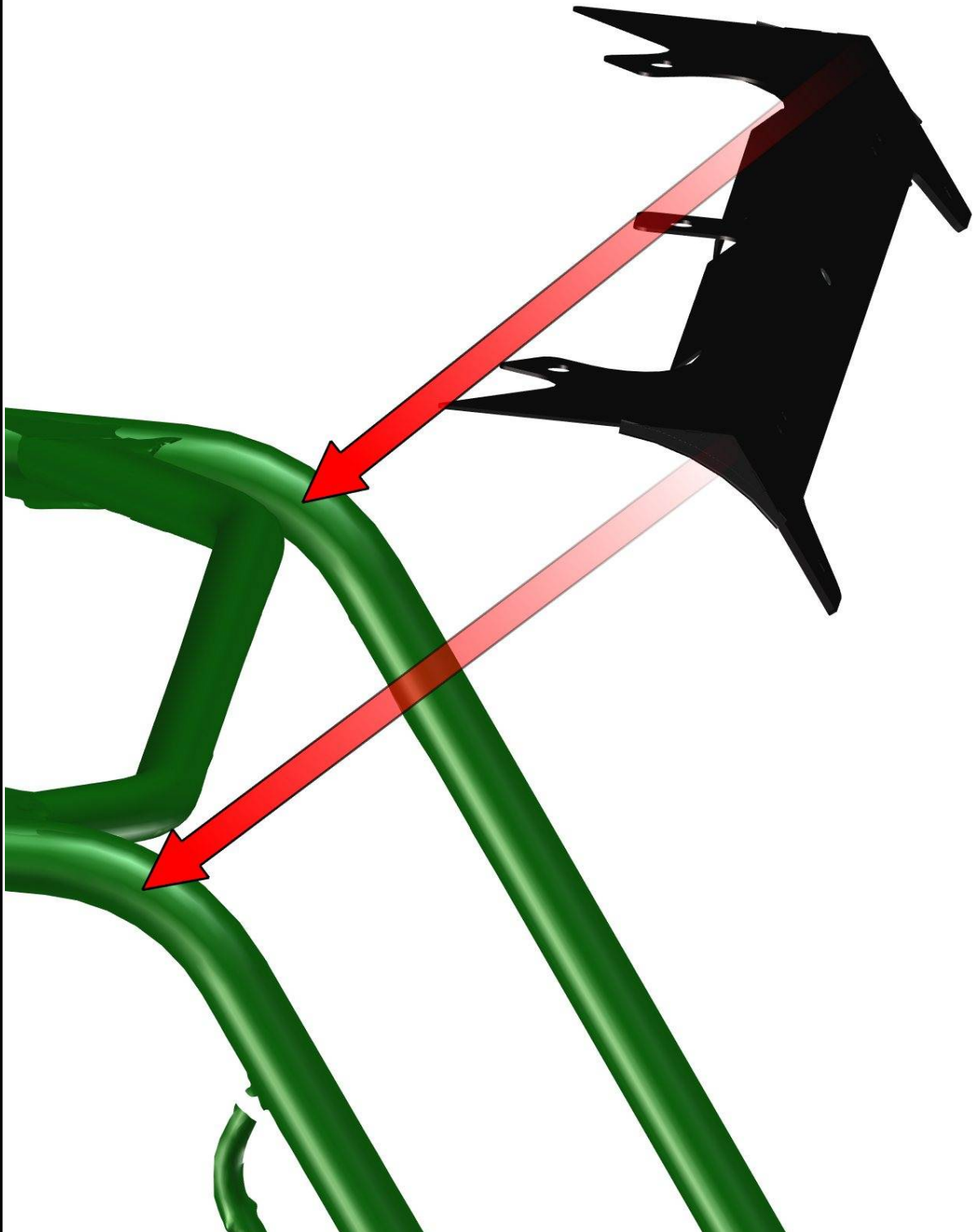

30

Place the front upper ledge side holder onto the front upper ledge and fix by included screw, washer, nut and cover on both sides.

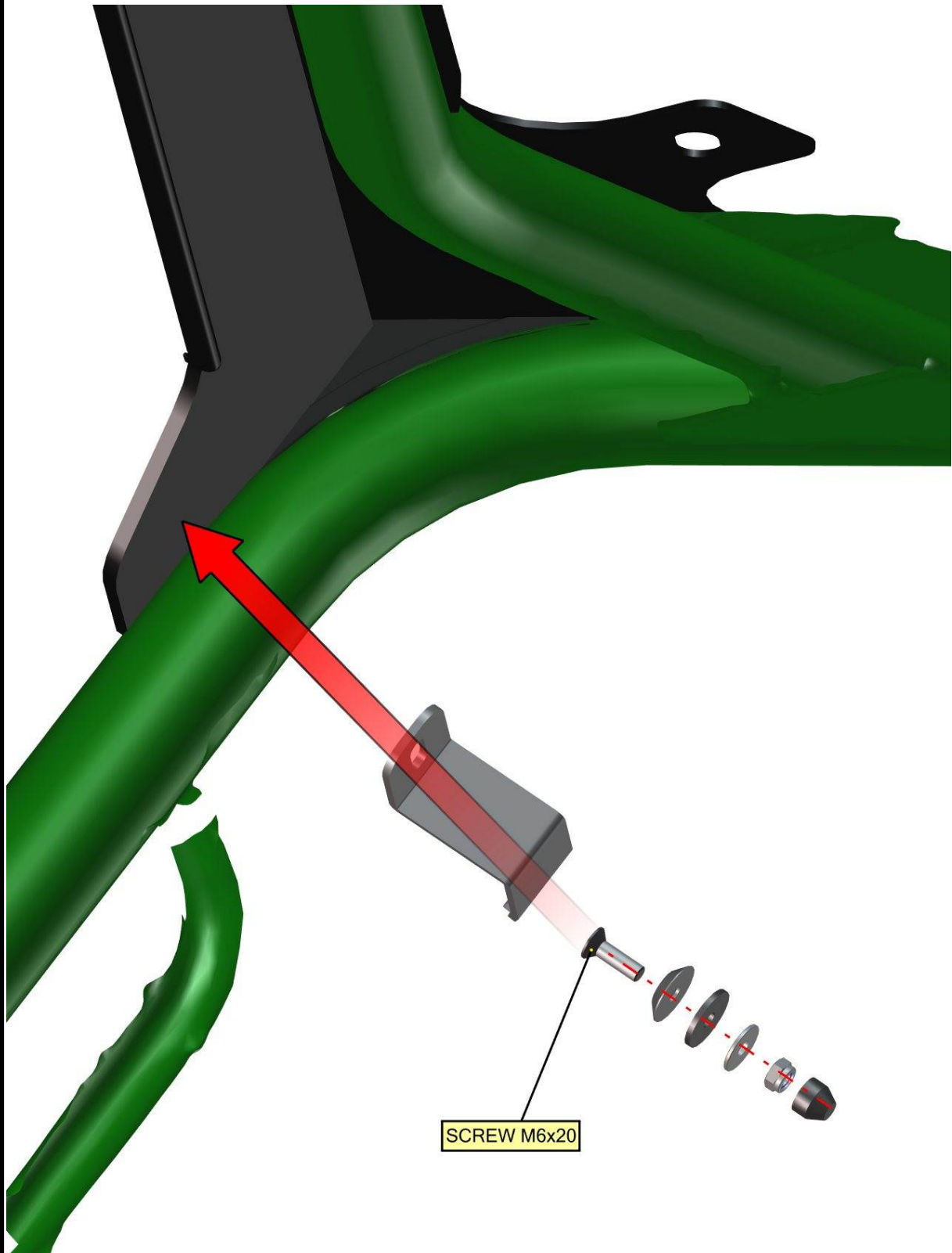

ROOF

Loosen the roof holders screws and place the roof onto the UTV roller cage.  
It's necessary unistall the front roof holders completely.



32



Turn the rear roof holder into the correct position and tighten.



33

FOR ALL TECHNICAL QUESTIONS, PLEASE CALL  
DFK AMERICA INC.  
(630) 324-8585

## DETAILED VIEW



34

Place the front upper ledge/roof holders onto the front upper ledge and fix by included screws, washers, nuts and covers.

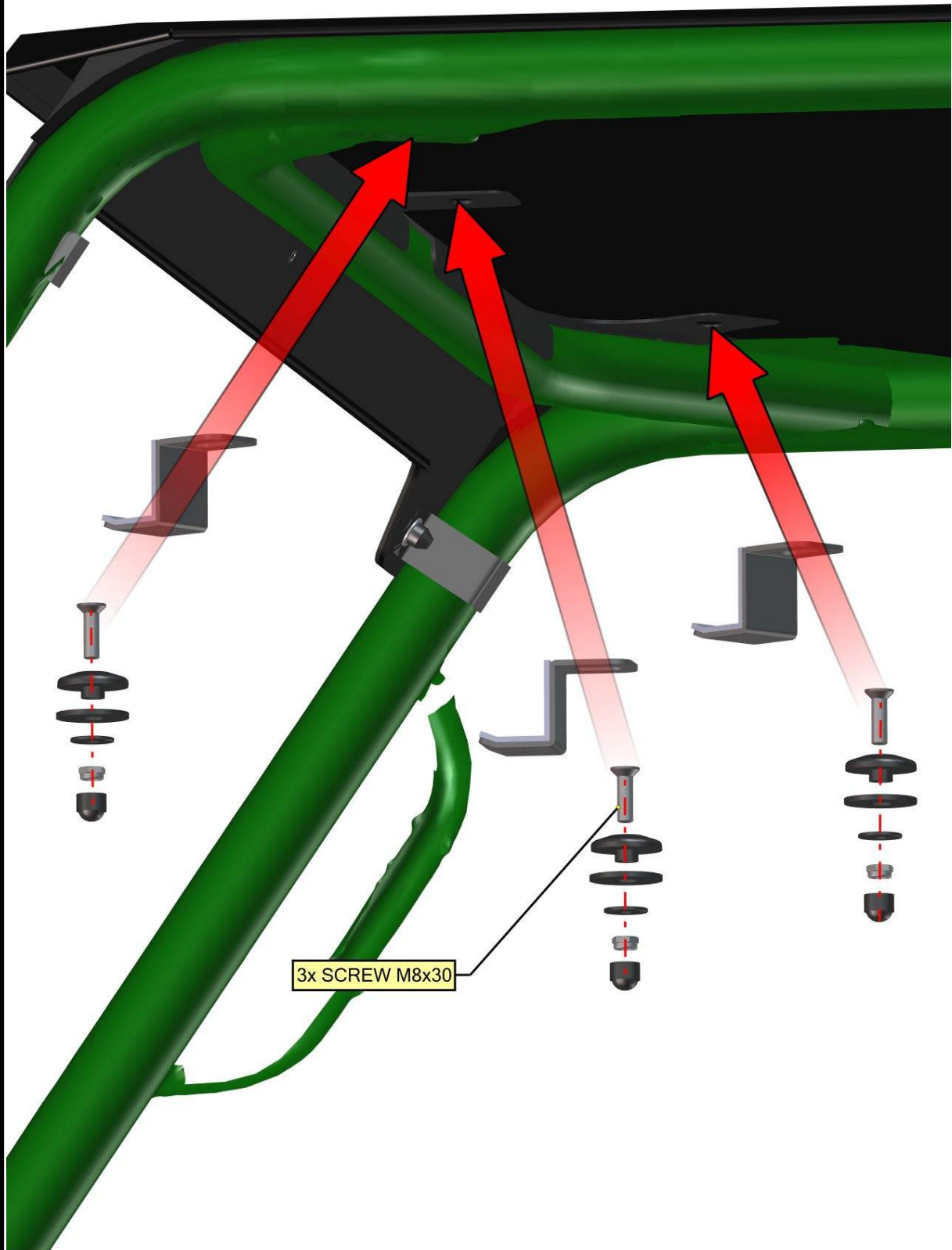

35



**FRONT PANEL 2.**

Place the front glass assembly onto the front upper ledge by hinges and fix using included fixing assemblies.

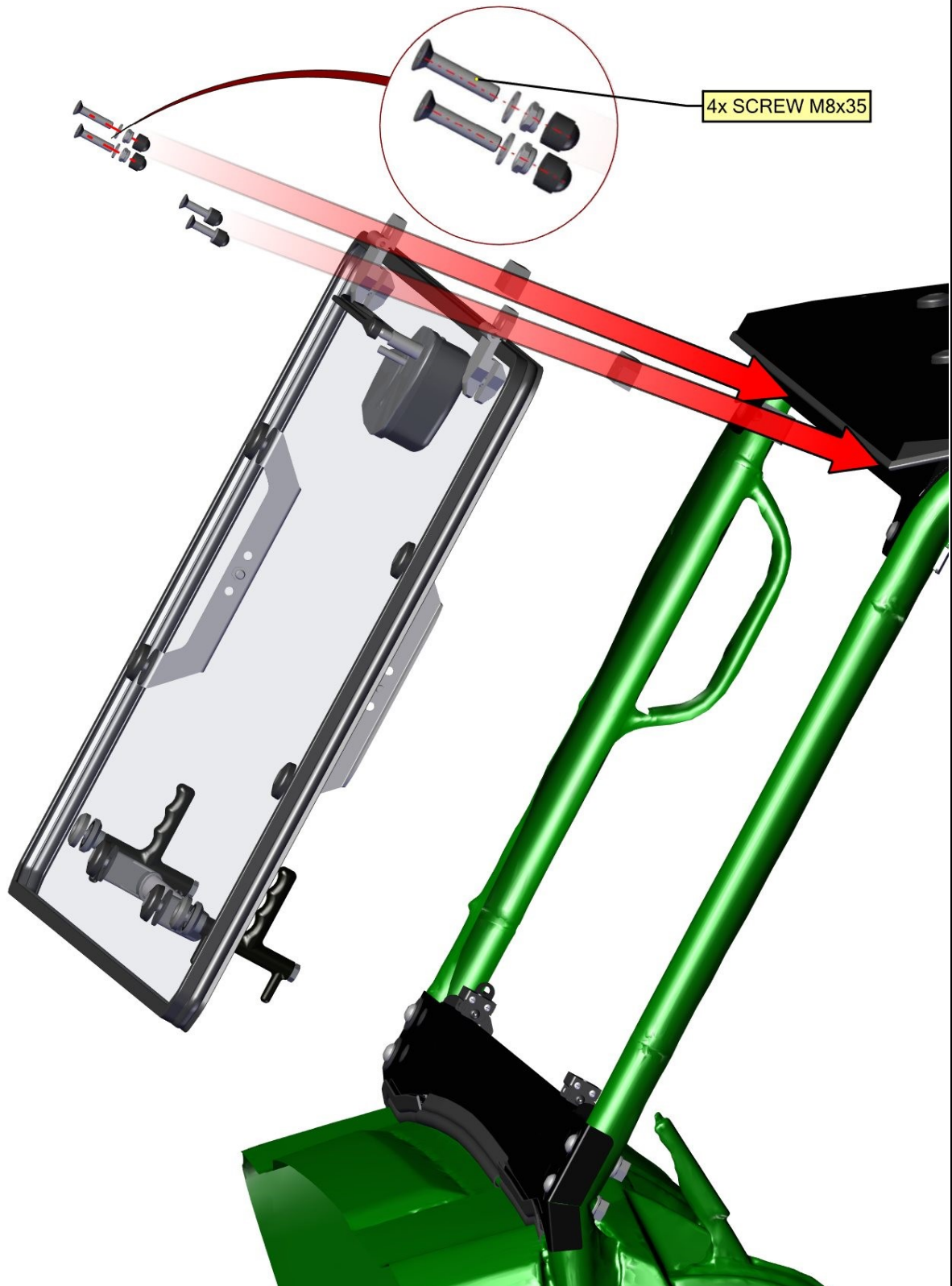



Install gas spring into the gas spring holders and fix by included self-locking nuts, washers and covers. On both sides.



37

Adjust the front glass stop assembly into the best position and tighten screws hard on both sides.

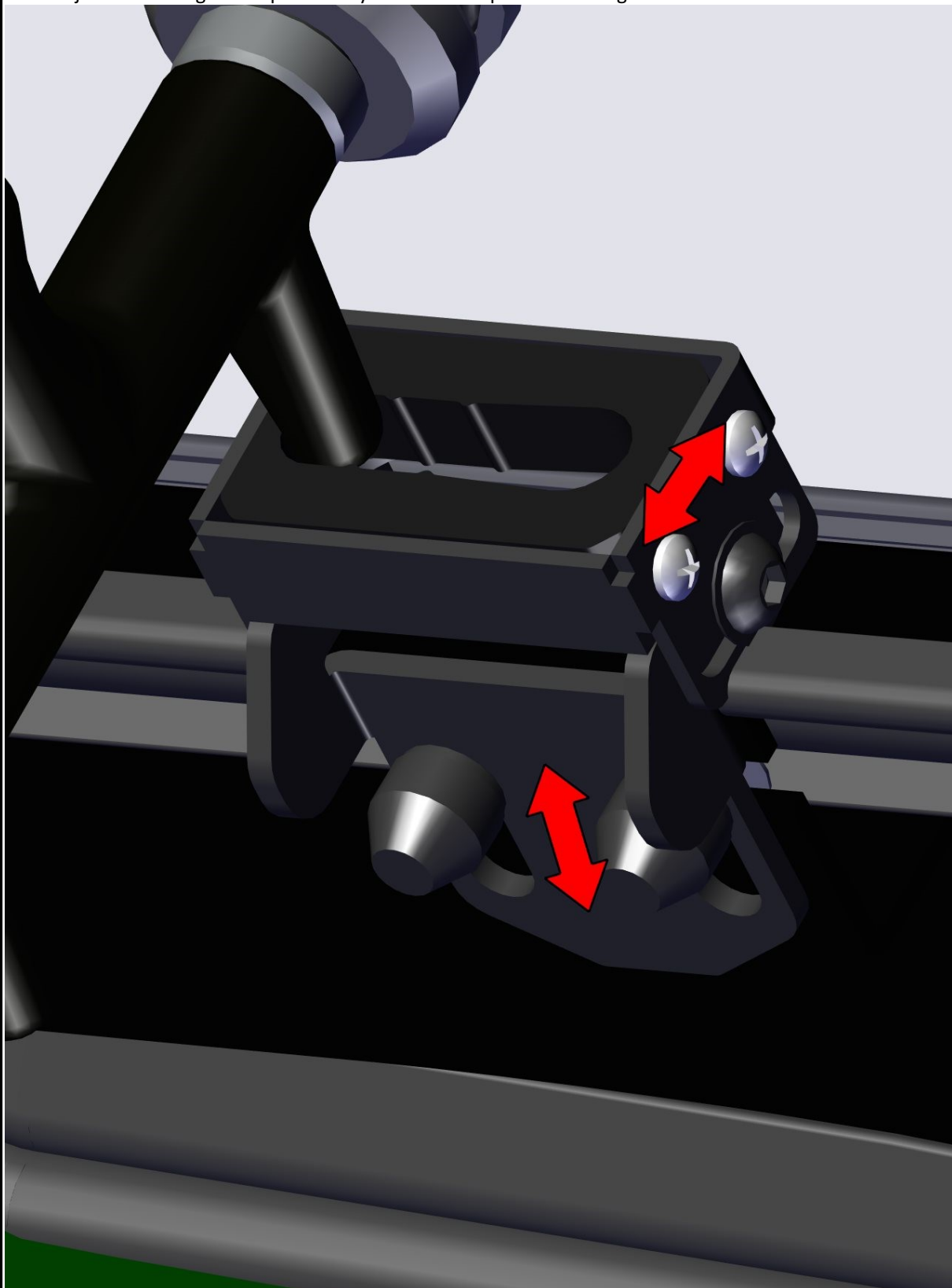

38

ELECTROINSTALLATION

WIPER/WASHER 2.

Lead the wiper harness with the washer tube to the wiper motor.

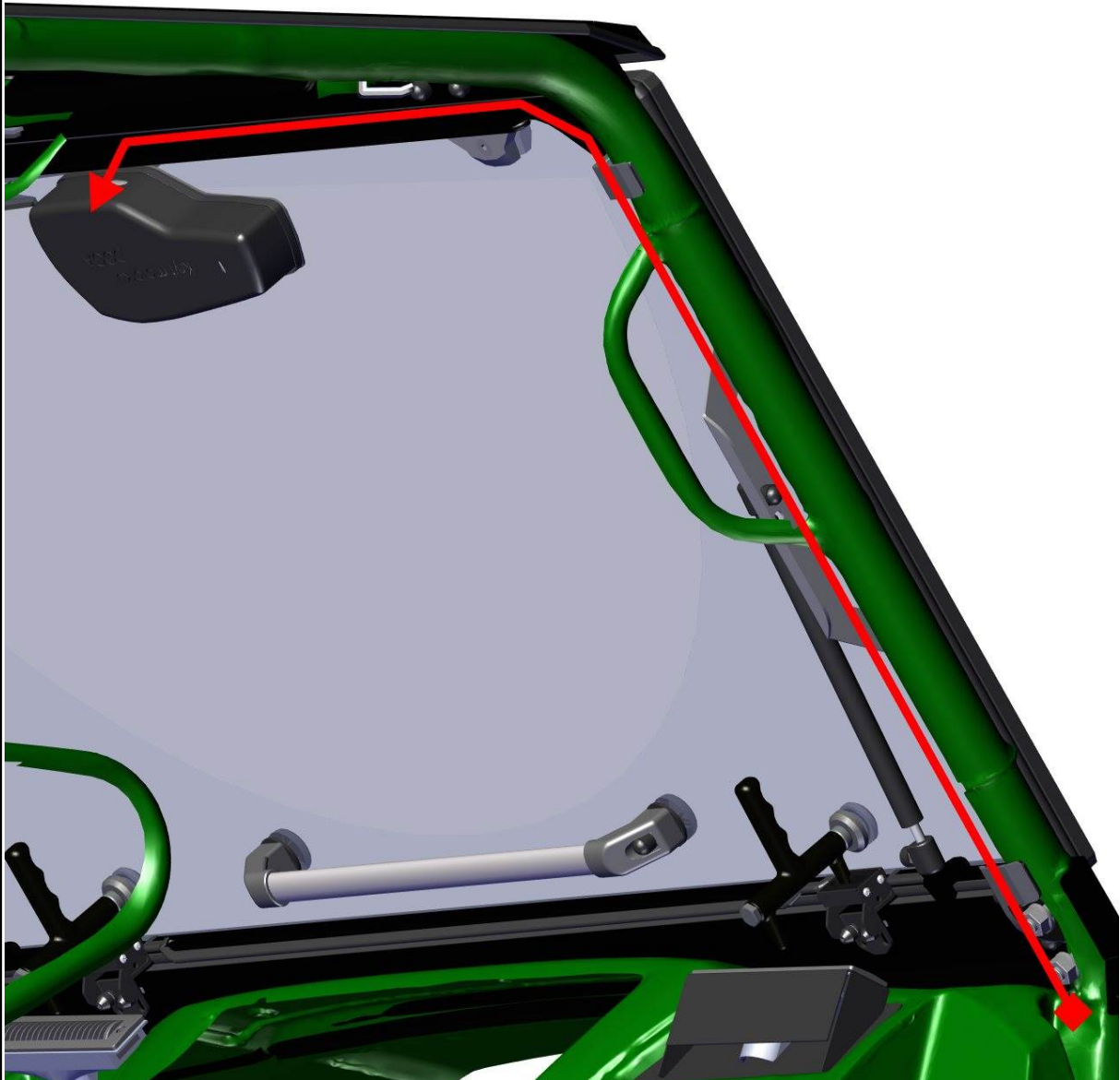

39

SEE NEXT PAGES

Connect the wiper harness branch to the wiper motor. DETAILED VIEW

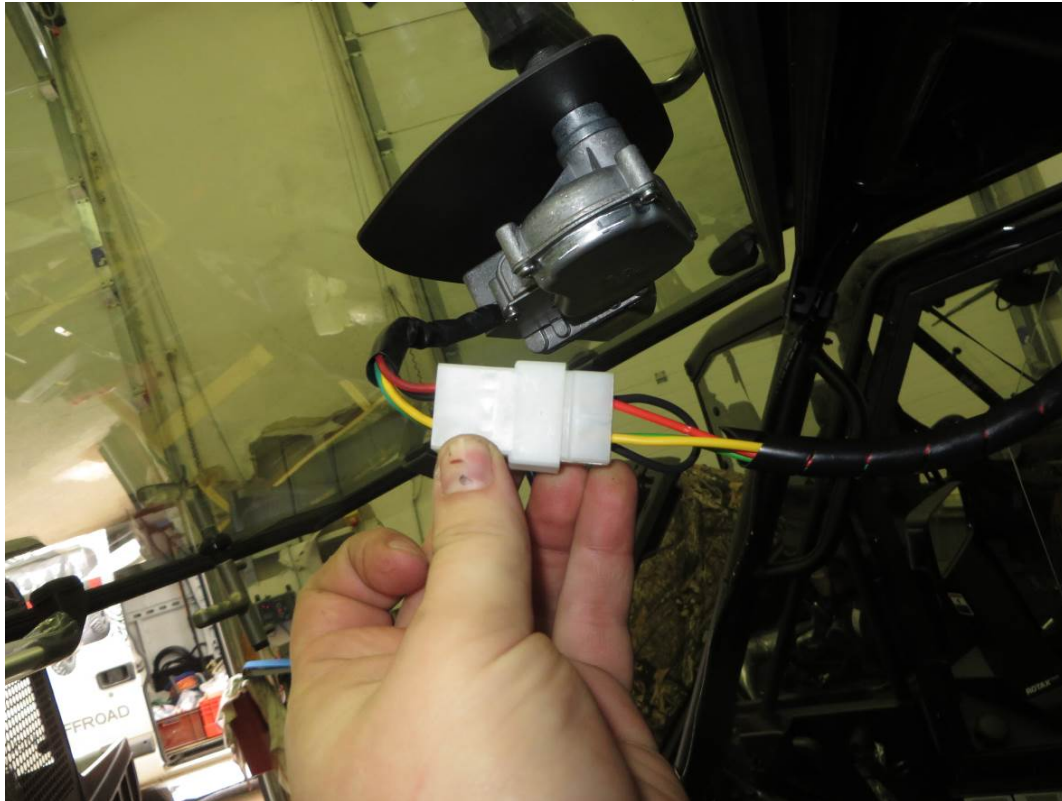

Lead the washer tube through front upper ledge using pre-installed hose pass. DETAILED VIEW



Connect the washer tube to the washer jet.



Connect the wiper washer harness to the relay harness.



**WARNING: IT IS ABSOLUTELY NECESSARY TO FILL THE WASHER TANK WITH THE WASHER LIQUID BEFORE FIRST USAGE!!**

LEFT DOOR + RIGHT DOOR 2.

Place the right door ledge onto the original hinges and fix by included screws, washers and nut.  
Fix the ledge with the dashboard by included rubber rivet.

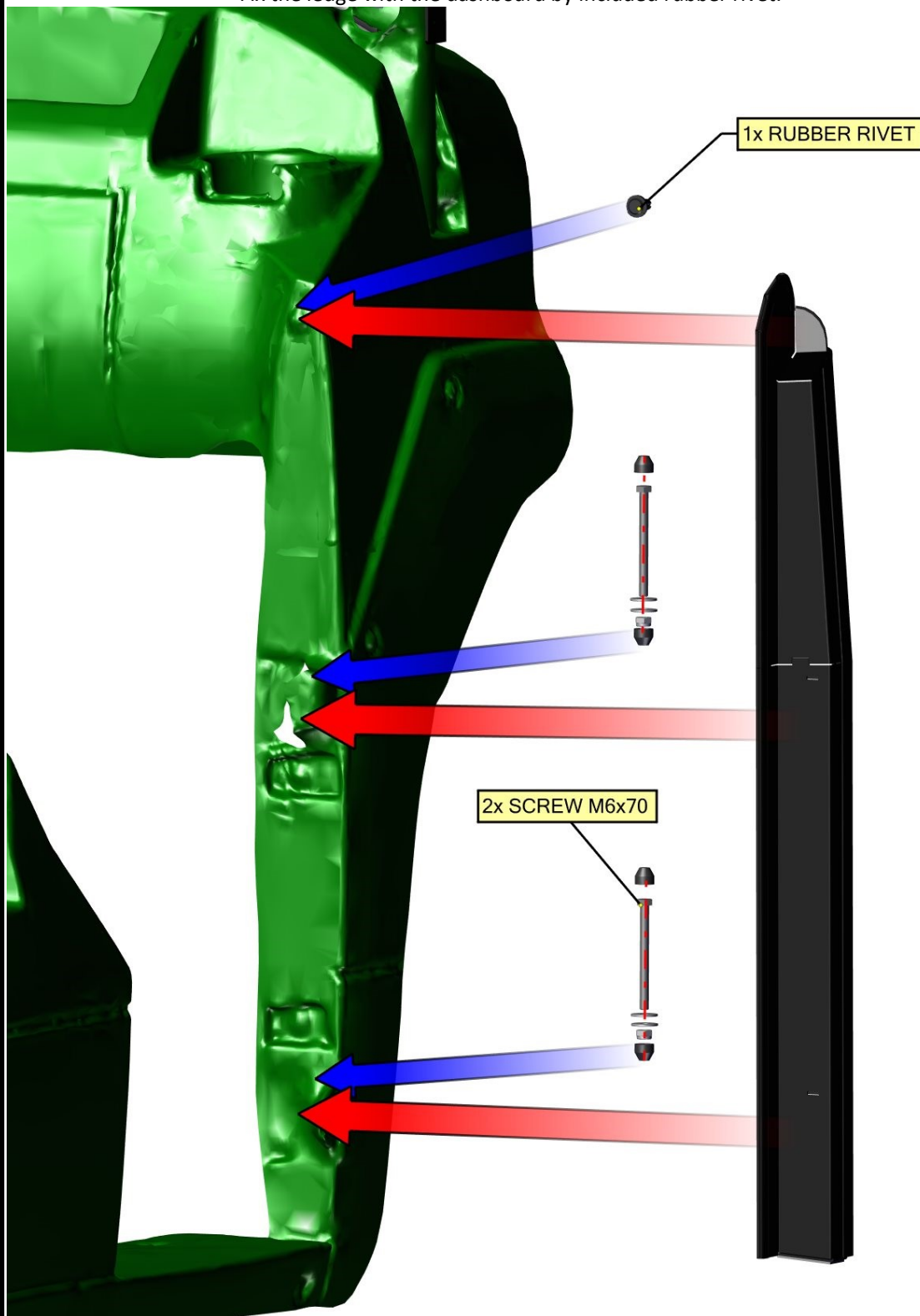

Place the gas tank cover into the position and fix by included rubber rivets.  
If necessary drill holes  $\varnothing 8\text{mm}$  to the UTV in accordance with the gas tank cover holes.

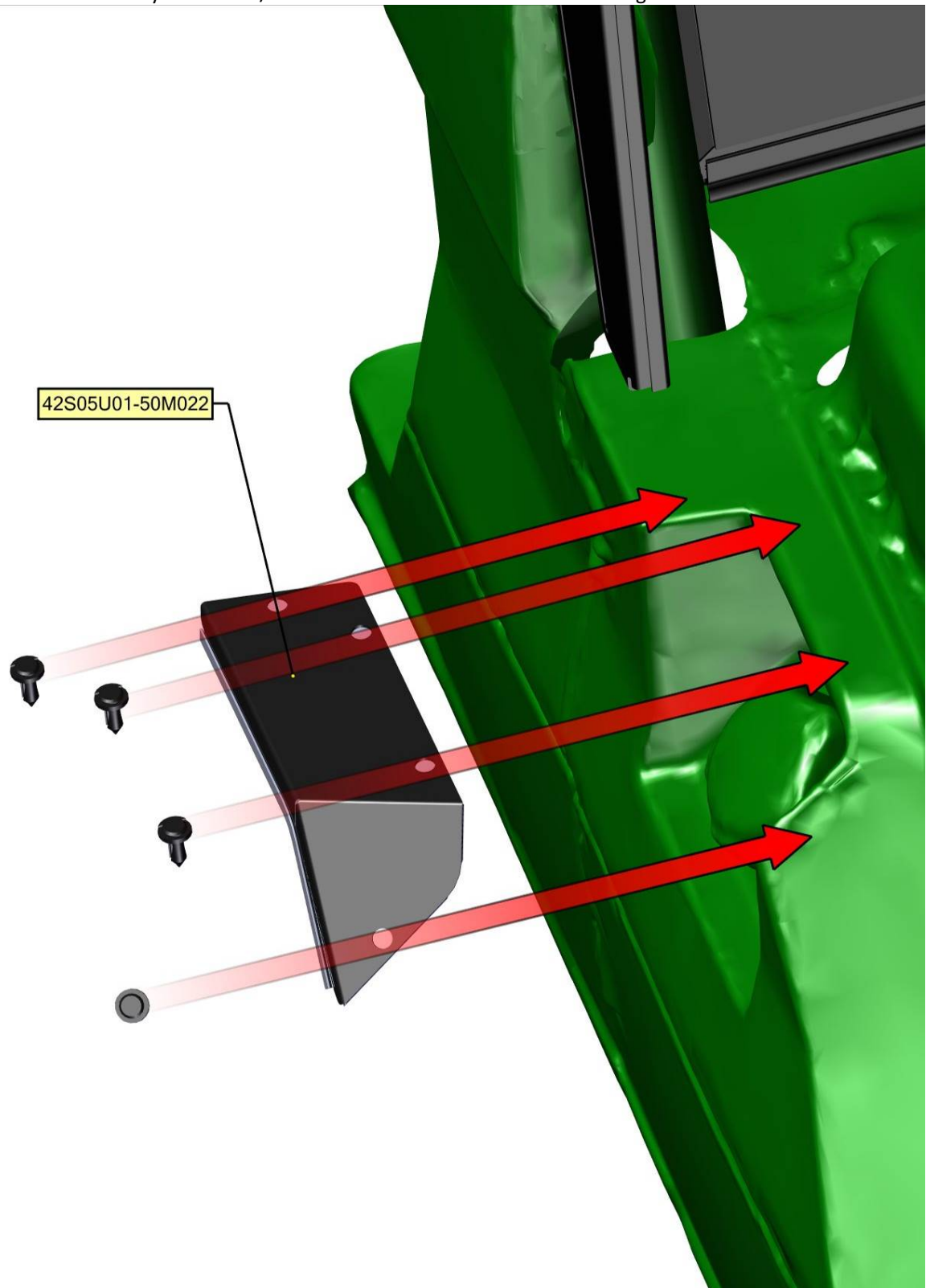

43

Install the door stop assembly into the right door stop holder.

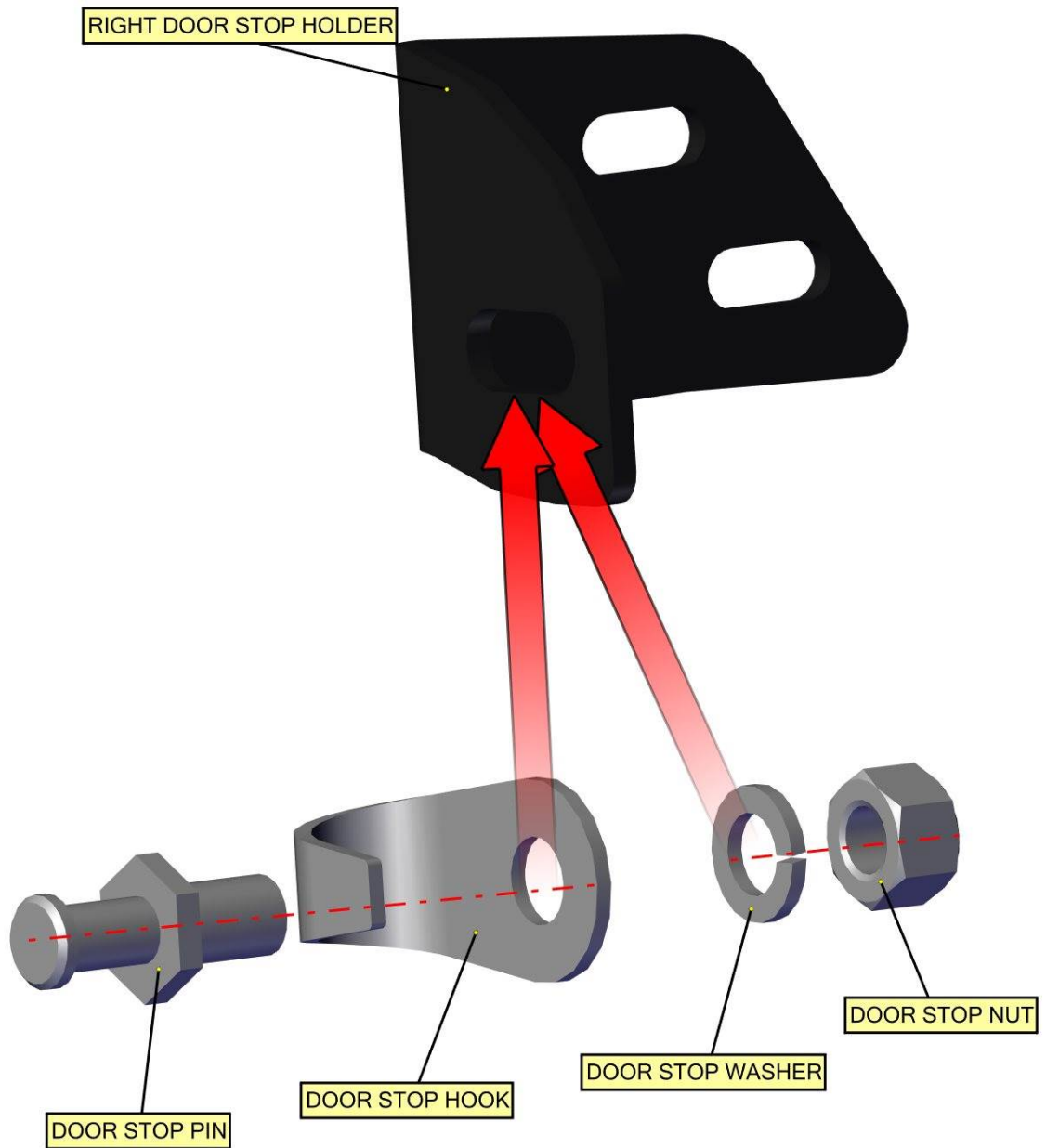



Place the right door stop assembly onto the prepared screws and fix by rest of the fixing assembly.

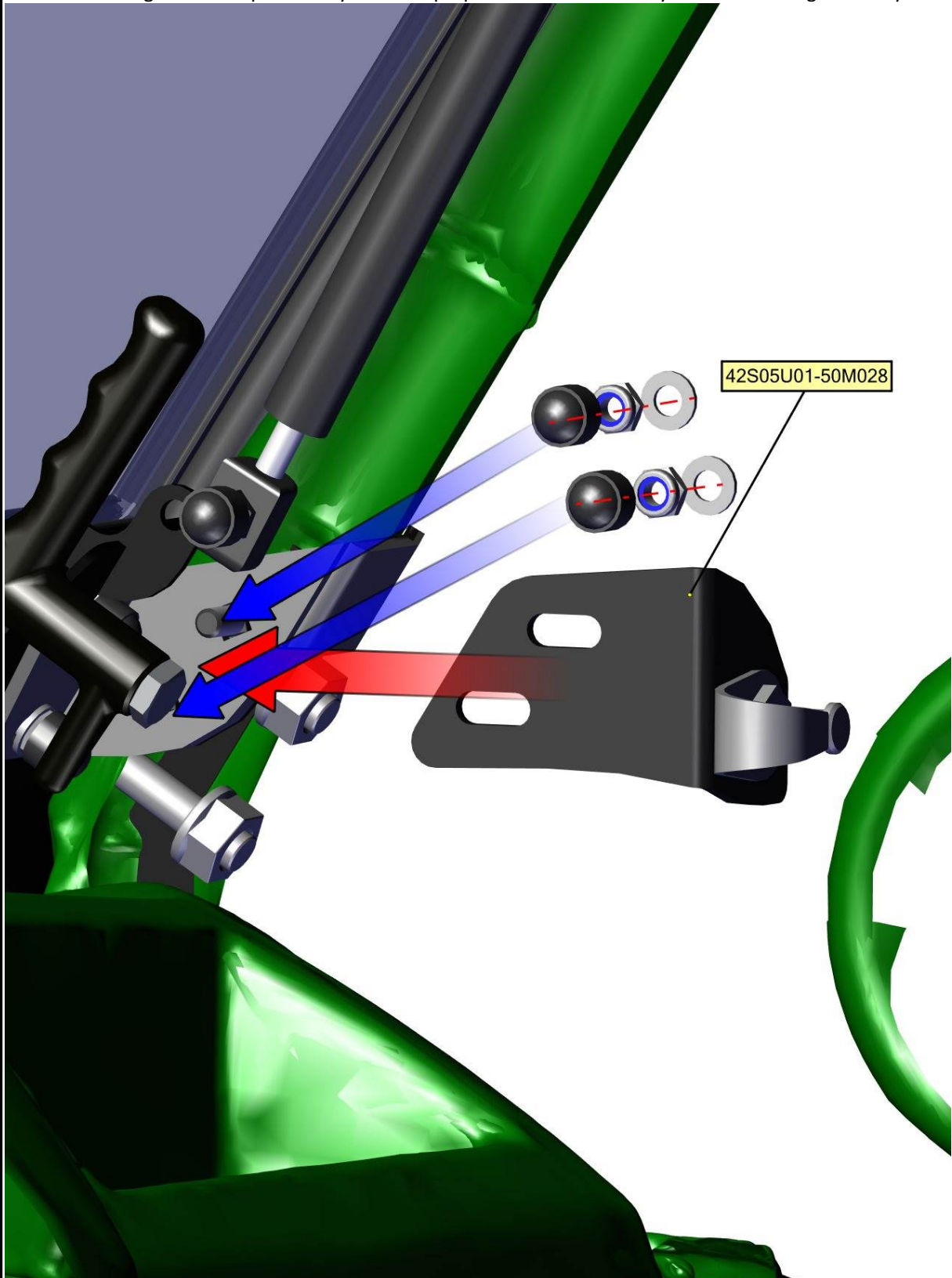

45

Take off the hinges pins covers and install washers 10 onto them.  
Place the right door assembly onto the hinges.

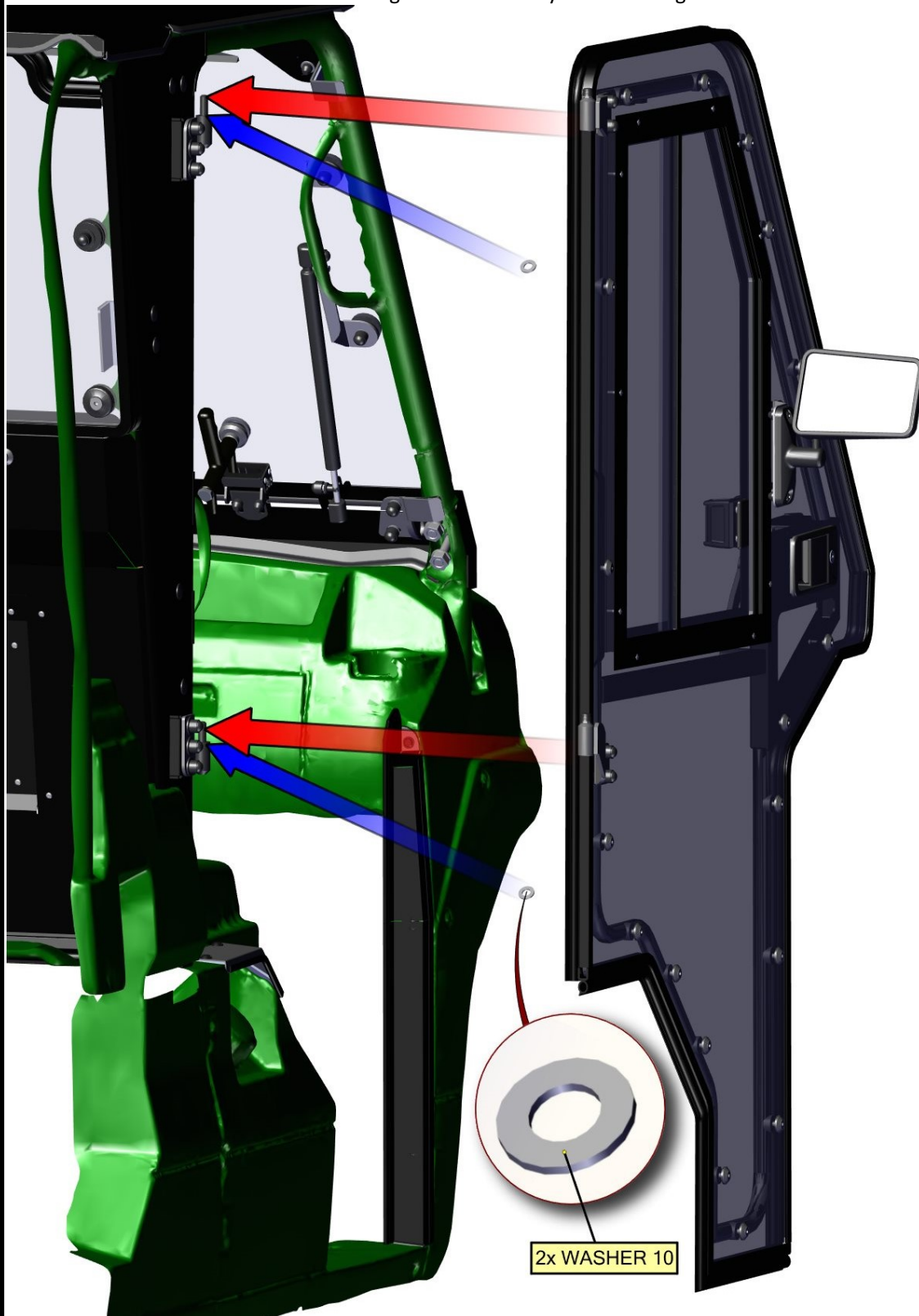

FOR ALL TECHNICAL QUESTIONS, PLEASE CALL  
DFK AMERICA INC.  
(630) 324-8585

Adjust the right door into the best position by hinges and tighten the hinges screws correctly.

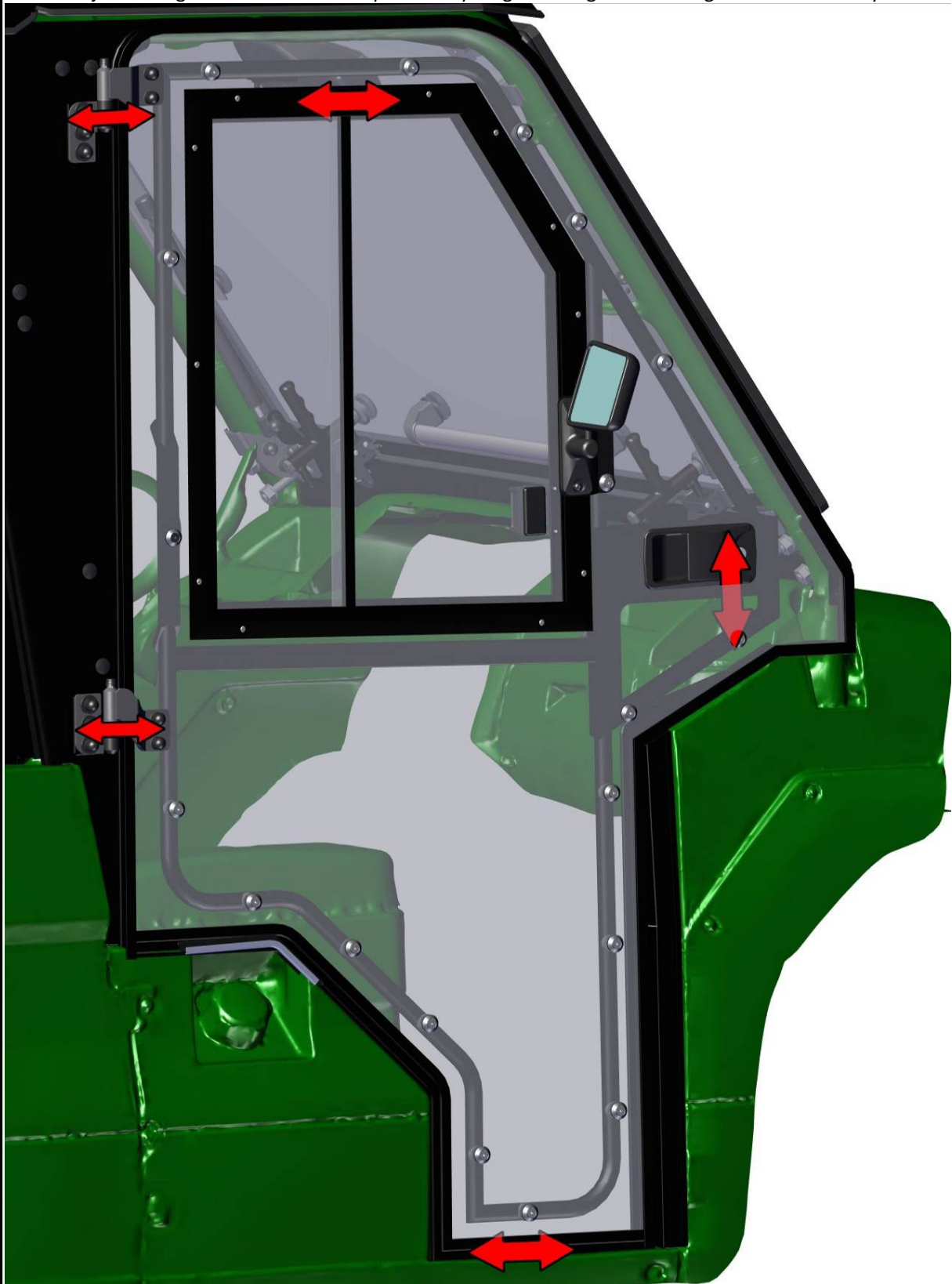

47

FOR ALL TECHNICAL QUESTIONS, PLEASE CALL  
DFK AMERICA INC.  
(630) 324-8585



Adjut the right door stop assembly into the best position and tightent screws hard.

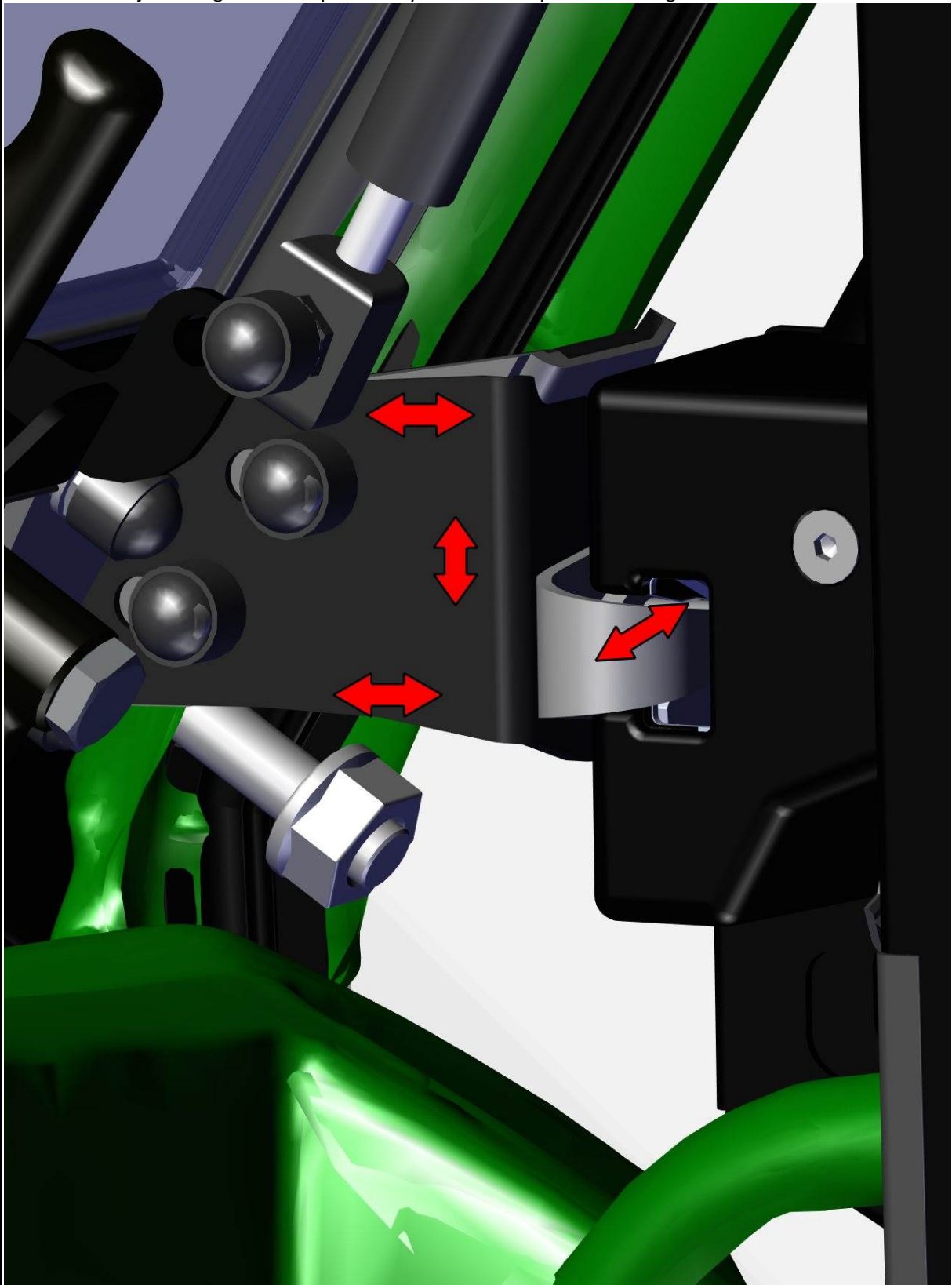

48

FOR ALL TECHNICAL QUESTIONS, PLEASE CALL  
DFK AMERICA INC.  
(630) 324-8585



Install the gas spring pins into the gas spring holders in same orientation as on picture below.

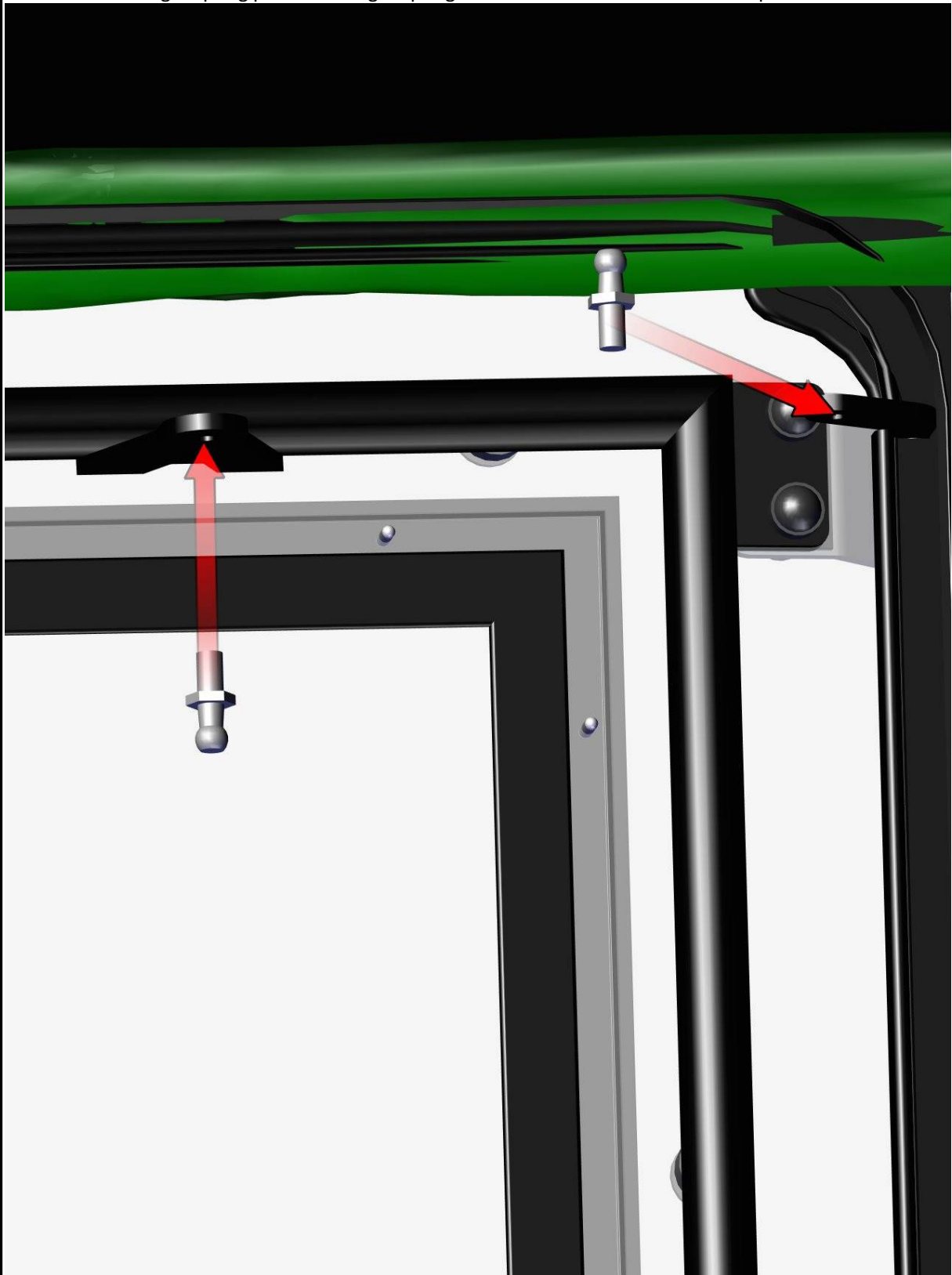

49

Fix the gas spring pins with the holders by included nuts, washers and covers and install the gas spring onto the pins.

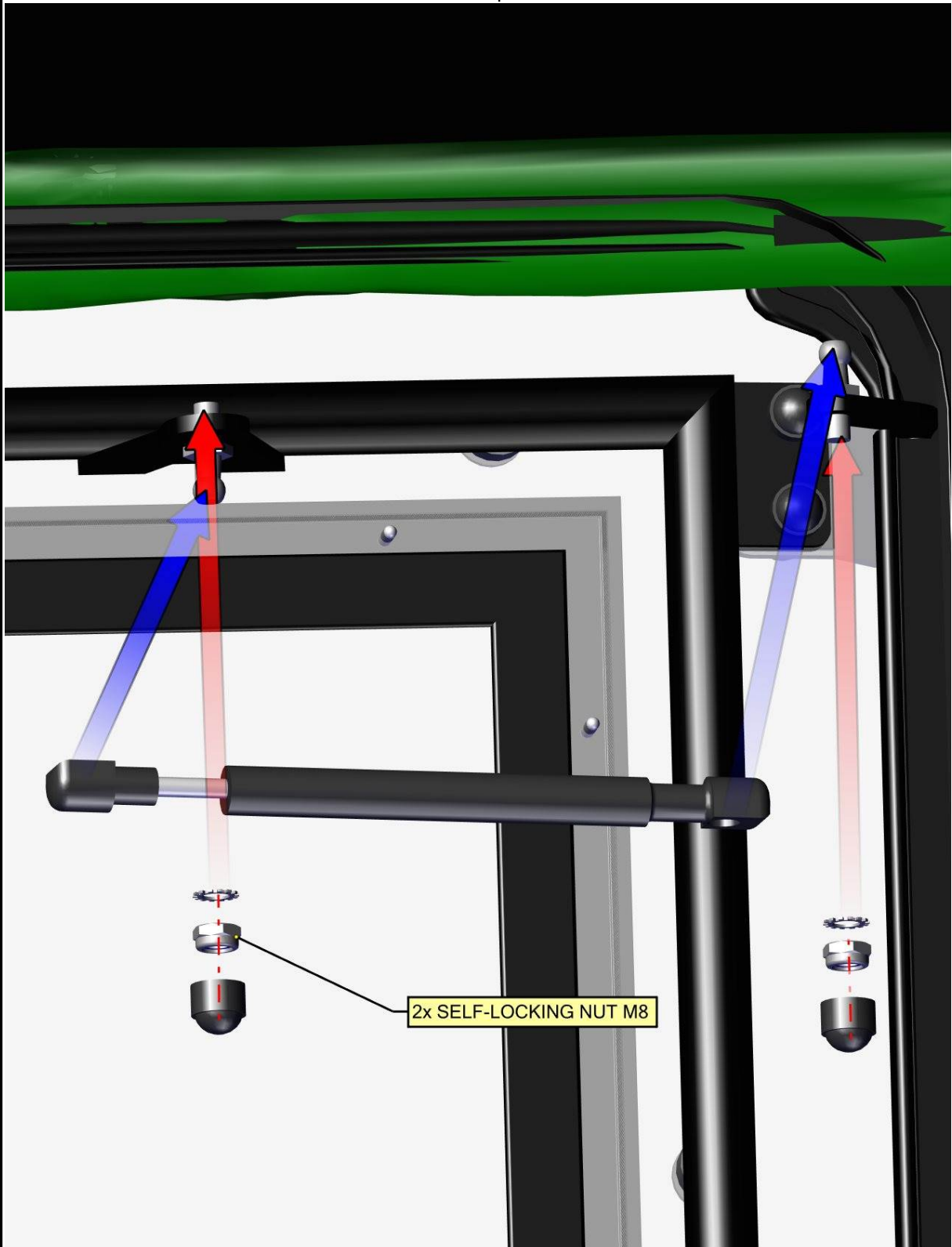

FOR ALL TECHNICAL QUESTIONS, PLEASE CALL  
DFK AMERICA INC.  
(630) 324-8585

Repeat previous steps with the left door assembly.



51

FOR ALL TECHNICAL QUESTIONS, PLEASE CALL  
DFK AMERICA INC.  
(630) 324-8585

## ELECTROINSTALLATION

**HEATER**

## FOR PETROL ENGINE

### Overall wiring diagram (heater)

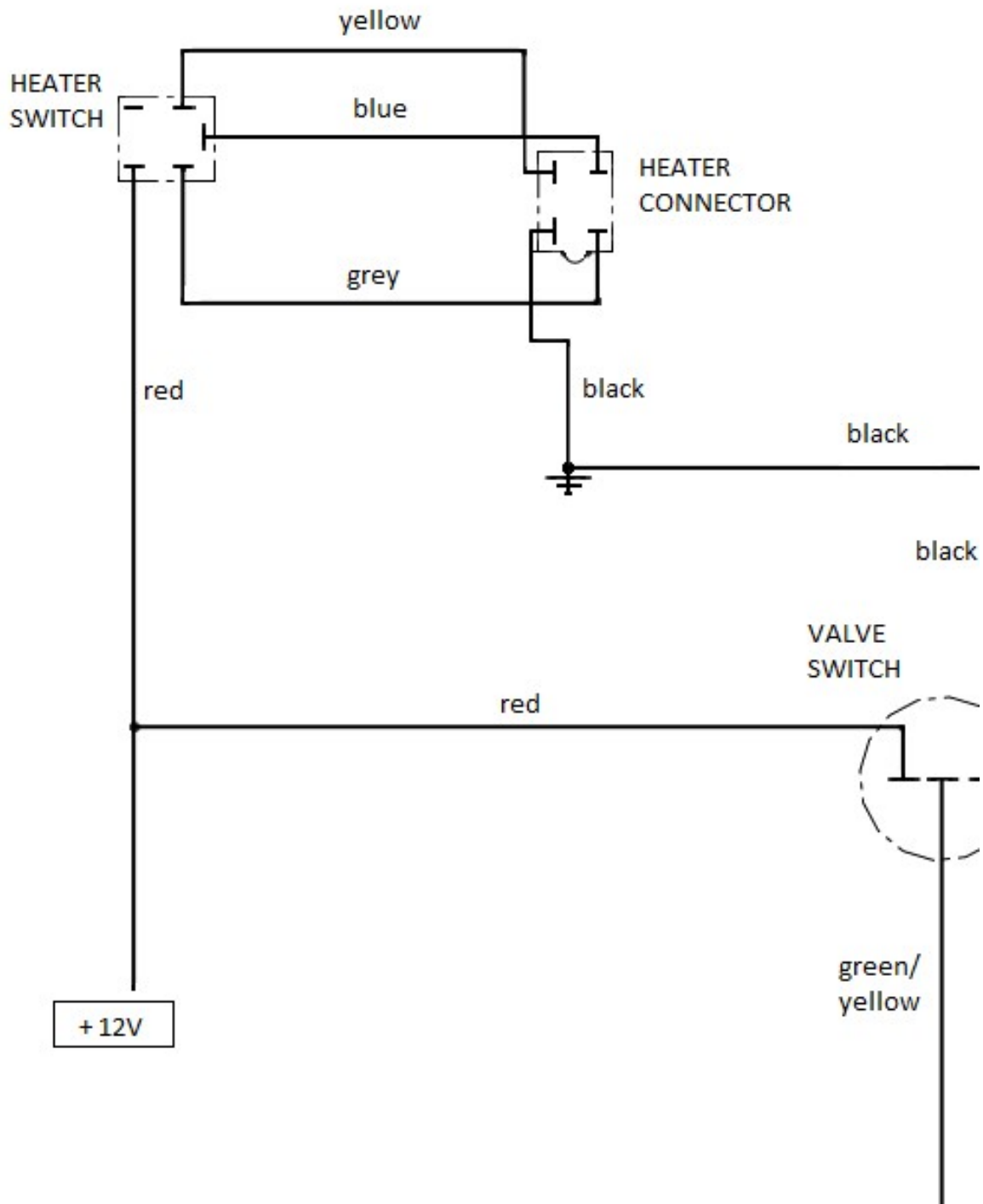

52



## IMPORTANT

IT IS ABSOLUTELY NECESSARY TO TAKE OUT THE RUBBER PLUGS FROM THE HEATER TUBES!!!

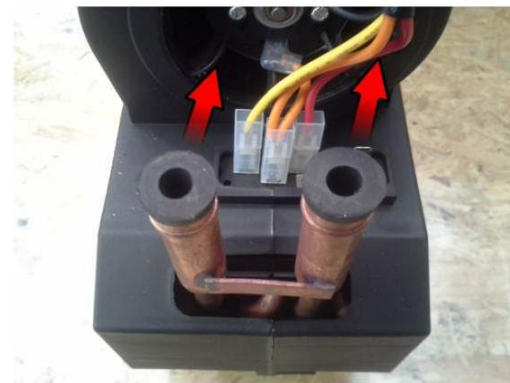
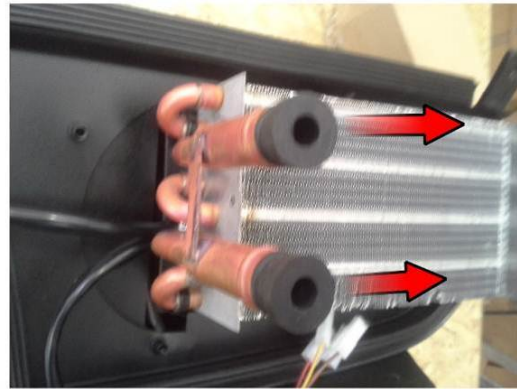

Drill necessary holes into the rear glove box cover and lead the hot water hoses and the heater harness through (red circles).



Install the hot water pump onto the hot water hose (red circle). Take extra care to the correct orientation. Connect the hot water pump to the pump harness.



FOR ALL TECHNICAL QUESTIONS, PLEASE CALL  
DFK AMERICA INC.  
(630) 324-8585

Install the heater holder to best position (heater assembly covers the glove box) and fix these with the UTV's body by included rubber rivets.

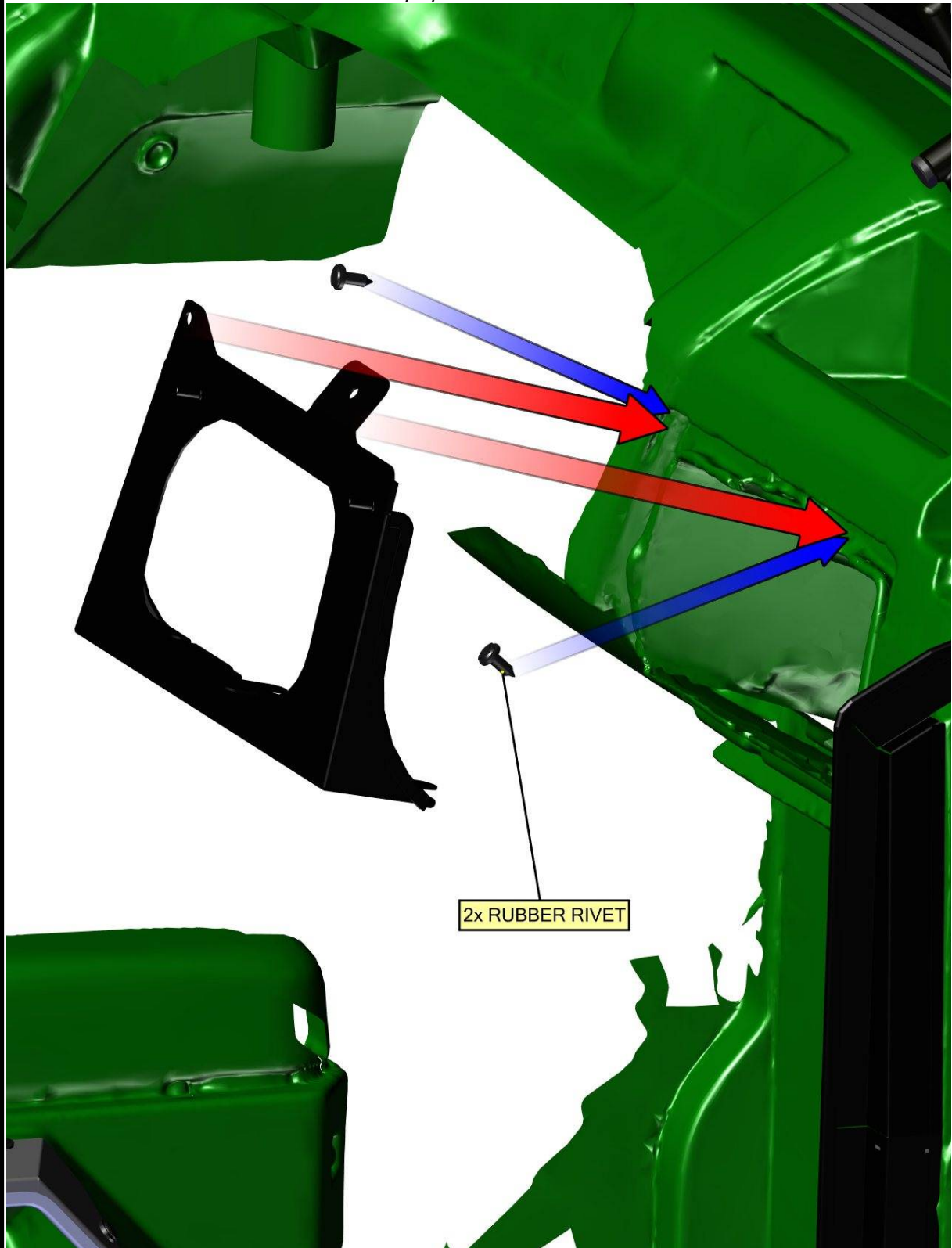

55



Run the harness branch from the harness to the UTV's main electrification.  
 Find the original cable where is 12V+ after you turn on the main UTV's switch.  
 Connect the harness cables, red to 12V+ original electrification and black to UTV's skelet.

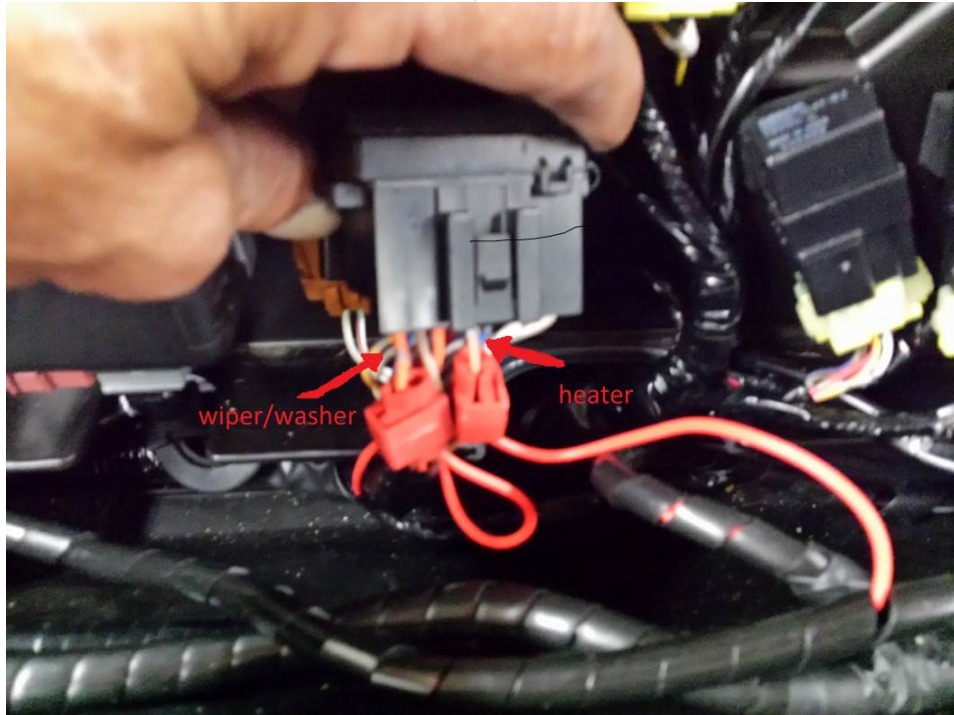

If you don't find connection for connectors installed on harness branch, you can use other connectors (included).



FOR ALL TECHNICAL QUESTIONS, PLEASE CALL  
 DFK AMERICA INC.  
 (630) 324-8585



Connect hot water hose with the UTV's cooling circuit near the cooler by "Y" coupling (included).



Lead the second hot water hose under the UTV floor to the engine.



FOR ALL TECHNICAL QUESTIONS, PLEASE CALL  
DFK AMERICA INC.  
(630) 324-8585

Connect hot water hose with the UTV's cooling circuit near the engine by "Y" coupling (included).



Connect the heater to the hot water hoses and to the heater harness and place the heater onto the heater holder and fix by included nuts, washers and covers on both sides.



FOR ALL TECHNICAL QUESTIONS, PLEASE CALL  
DFK AMERICA INC.  
(630) 324-8585

***It is absolutely necessary to bleed the air out of the UTV's engine cooling system. Incomplete bleeding of cooling system can result in engine damage. If you don't have sufficient experience with this process, we strongly recommend professional service technician assistance. We are not responsible for damages when cooling system bled incompletely. Please note that additional heater system will absorb more than 2 liters of coolant fluid.***

- 1. Important: After the heater system is installed, check the system for leaks. Turn on the electric vent switch and confirm that the engine is cold. Start the engine, open the bleeding valve and wait until the engine warms up. Important: Always check engine temperature – if it overheats, turn off the engine.***
- 2. To achieve engine operating temperature, depress the accelerator to increase the engine RPM. This will increase the pressure and flow of the water pump, forcing more coolant through the heater. After operating temperature is reached, turn off the engine and open it. Trapped air should come out from the heater system throughout the bleeding valve. Repeat this procedure until the heater/cooling system is completely bled out.***

***The DFK Cab heater, like the heater in a car, generates heat from the vehicle's engine.***

***In nearly all cases, the heater should generate enough heat from your UTV, side-by-side, or tractor engine that you may need to turn the heater off periodically otherwise the air in the cabin may be too hot.***

***It is important to check the coolant level regularly at least 4-5 times during the first several days of operation and fill as necessary until the coolant level has stabilized. The heater will draw and retain coolant, sometimes at the expense of coolant to the engine. This can cause engine overheating if not managed properly.***