



INSTALLATION INSTRUCTIONS

YAMAHA
WOLVERINE





SAFETY INSTRUCTIONS

Warning: Failure to heed all safety and operating instructions and warnings regarding use of this product can result in serious bodily injury.

READ PROPERLY COMPLETE ASSEMBLY INSTRUCTIONS BEFORE STARTING OF ASSEMBLY

Install all parts indicated in assembly instructions. Failure to fully assemble product before use could result in personal injury.

Assembly of product requires use of hand or power tools. If you are not experienced in using these types of tools, have product dealer do the install for you.

Some parts contain sharp edges, wear protective gloves if necessary.

Always keep your assembly area clean, uncluttered and well lit.

Keep visitors and children a safe distance away from the assembly area. Visitors should wear the same safety equipment described under.

Never operate your UTV with the cab doors open. Failure to properly latch the doors before moving the vehicle could result in serious injury.

Dress for safety. DO NOT wear loose clothing, gloves, neckties or jewelry if using power tools to assemble this product.

Insert all nut covers after you finish installation.

Never drive your UTV with the cab front window in open position. Failure to properly latch/lock front window before driving the vehicle could result in serious injury.

For safety purposes, if the DFK Cab doors are removed, it is mandatory that the OEM Half Doors or Nets are REINSTALLED before operating vehicle.

MAINTENANCE AND CLEANING

To clean polycarbonate surface use soapy water solution or other subtle means.

Dirt and dust wash by gently water stream and swipe only with wet or damp means in the direction from top to bottom.

The recommended frequency of cleaning of polycarbonate part is about 1 time per month or according to the actual degree of pollution.

***Do not use detergents that could scratch the surface plates.
(abrasives, harsh fabrics, etc.)***

***Do not use solvents or alkaline detergents or cleaners with ammonia
(ammonium hydroxide).***

Do not remove the impurities from the surface of the razor blades or other sharp items.

Do not clean cabin when the polycarbonate plates are heated by the sun.

Do not use the squeegee, it could be scratched surface plates.

Do not clean the water current strength greater than 50 bar (WAP)

The manufacturer is not responsible for scratching the surface in case of failure to comply with the above instructions.

All bolted connections of cab must be by user at regular intervals checked and tightened.

PREPARATION FOR INSTALLATION:

Uninstall all additional systems from the roller cages (work lights, rear mirrors, drink holders etc.)

CAB PREVIEW

4

LEFT DOOR + RIGHT DOOR 1.

Place the left hinges onto the left door base and fix by included screws, washers, nuts and covers.
Place the left door base assembly onto the UTV roller cage.

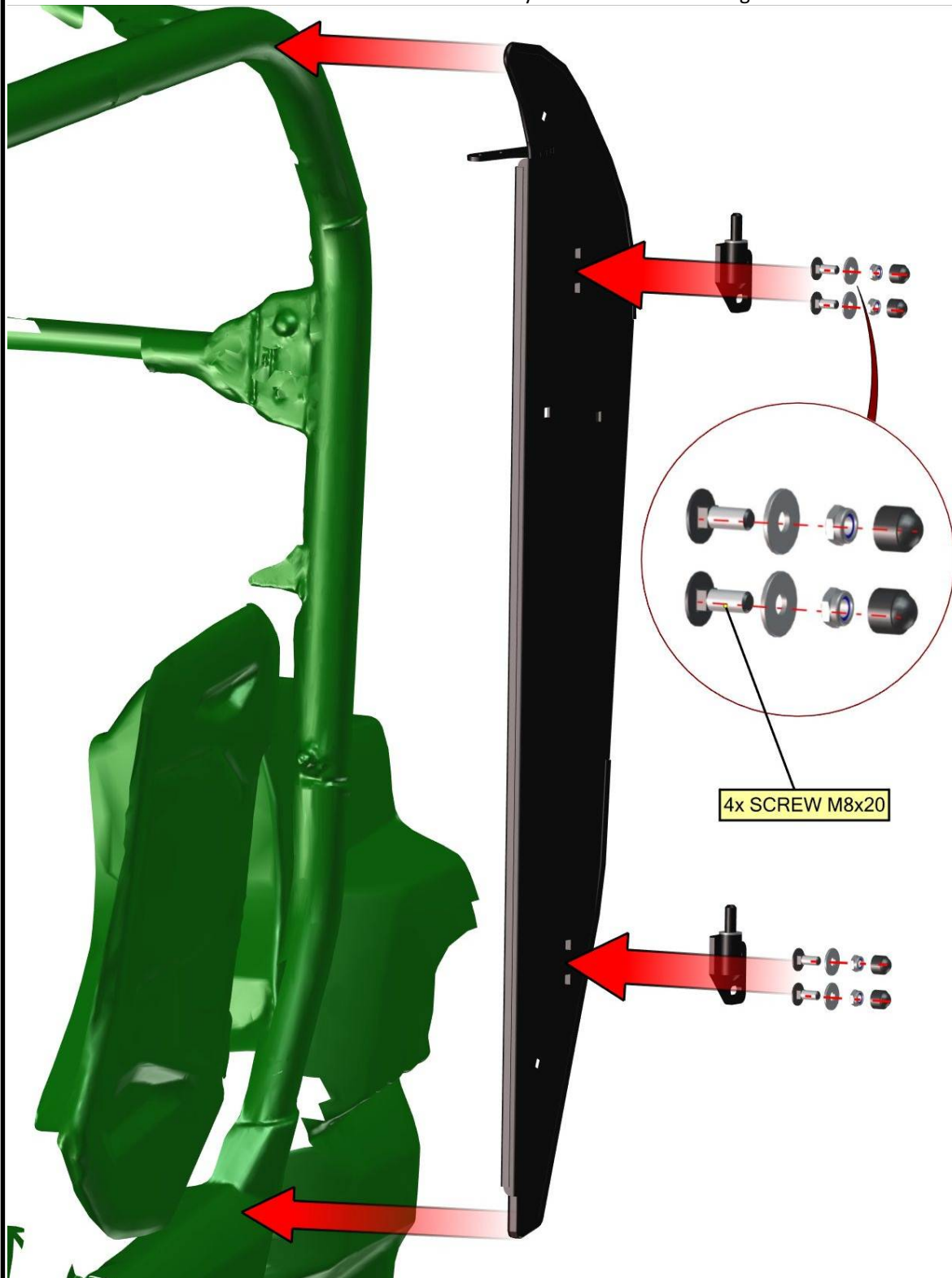

Place the upper holder and bottom holder onto the left door base and fix by included screws, washers, nuts and covers.

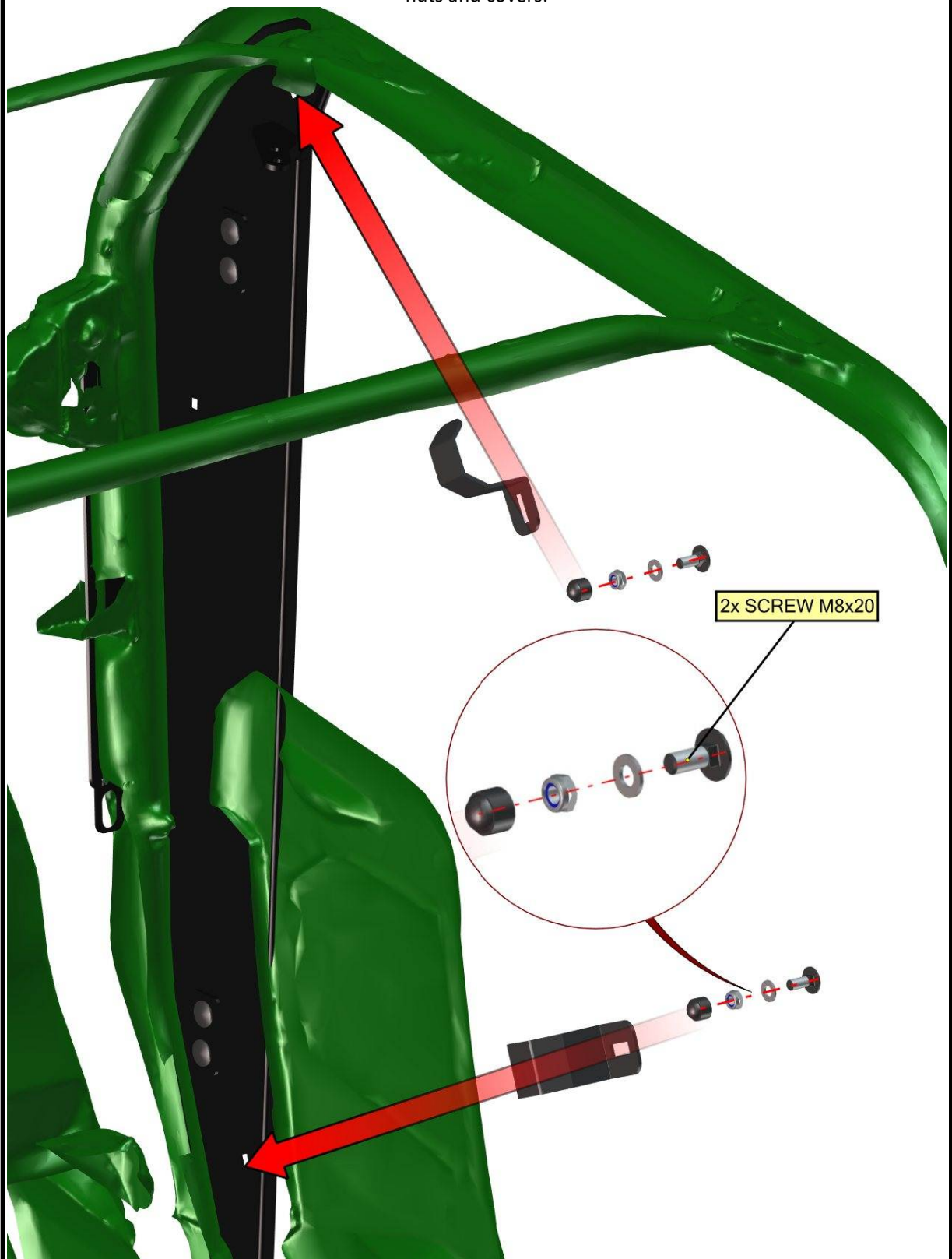

Place the middle holder onto the left door base and fix with the UTV roller cage by included screw, washers, nut and cover using UTV original hole.

Fix the middle holder with the left door base by included screws, washers and covers.

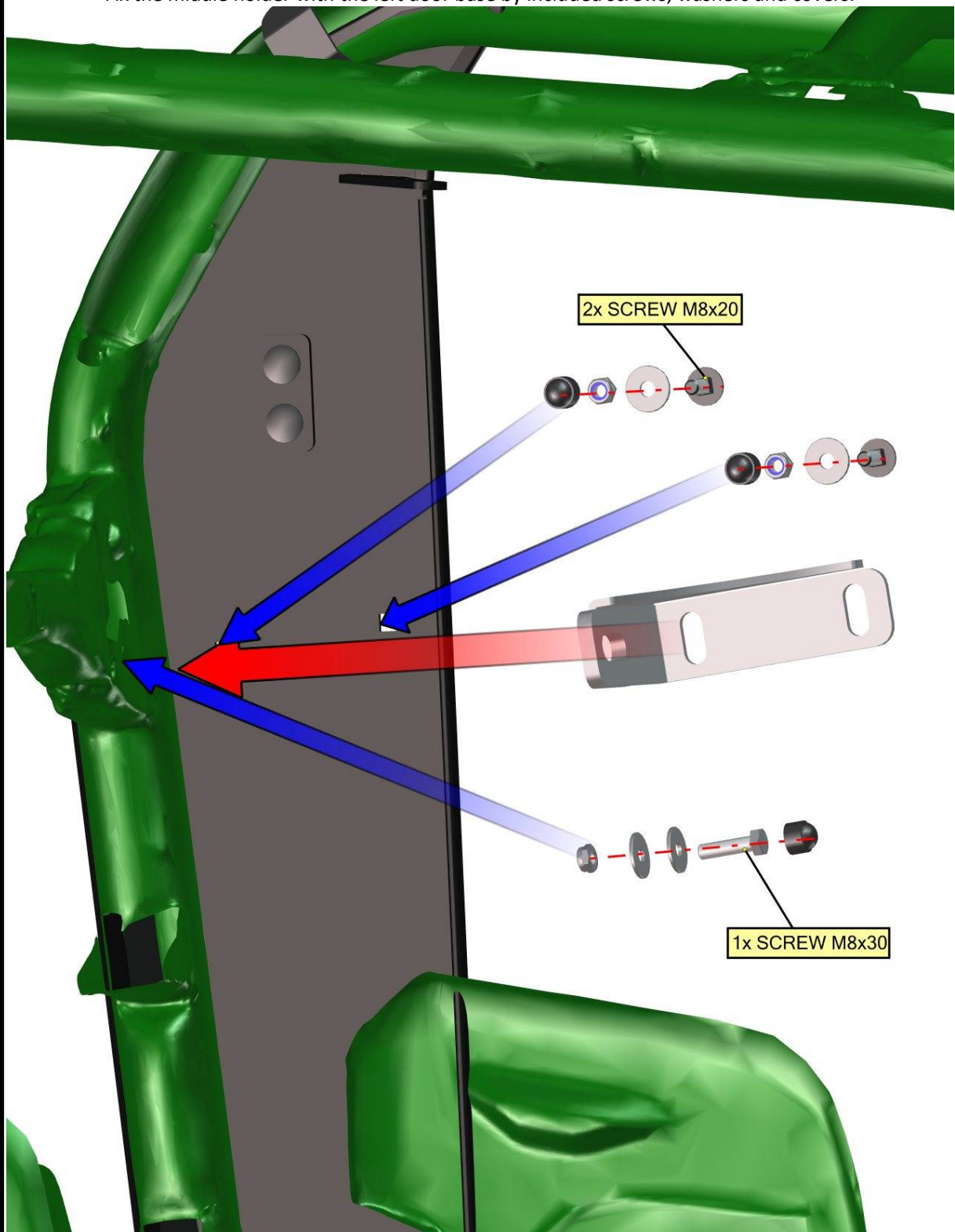

Repeat previous steps with the right door base.

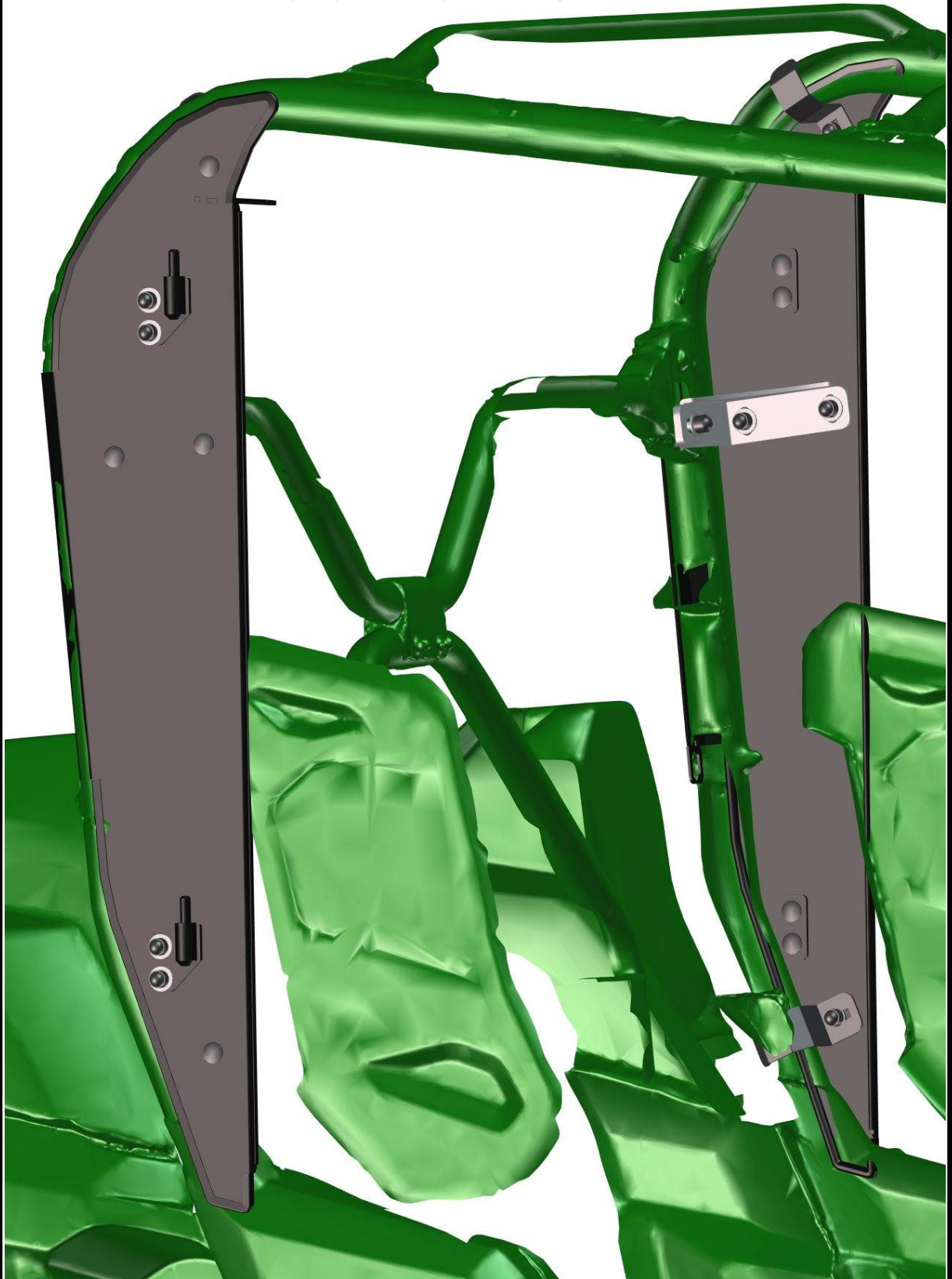

REAR PANEL 1.

Place the rear panel assembly onto the UTV roller cage.

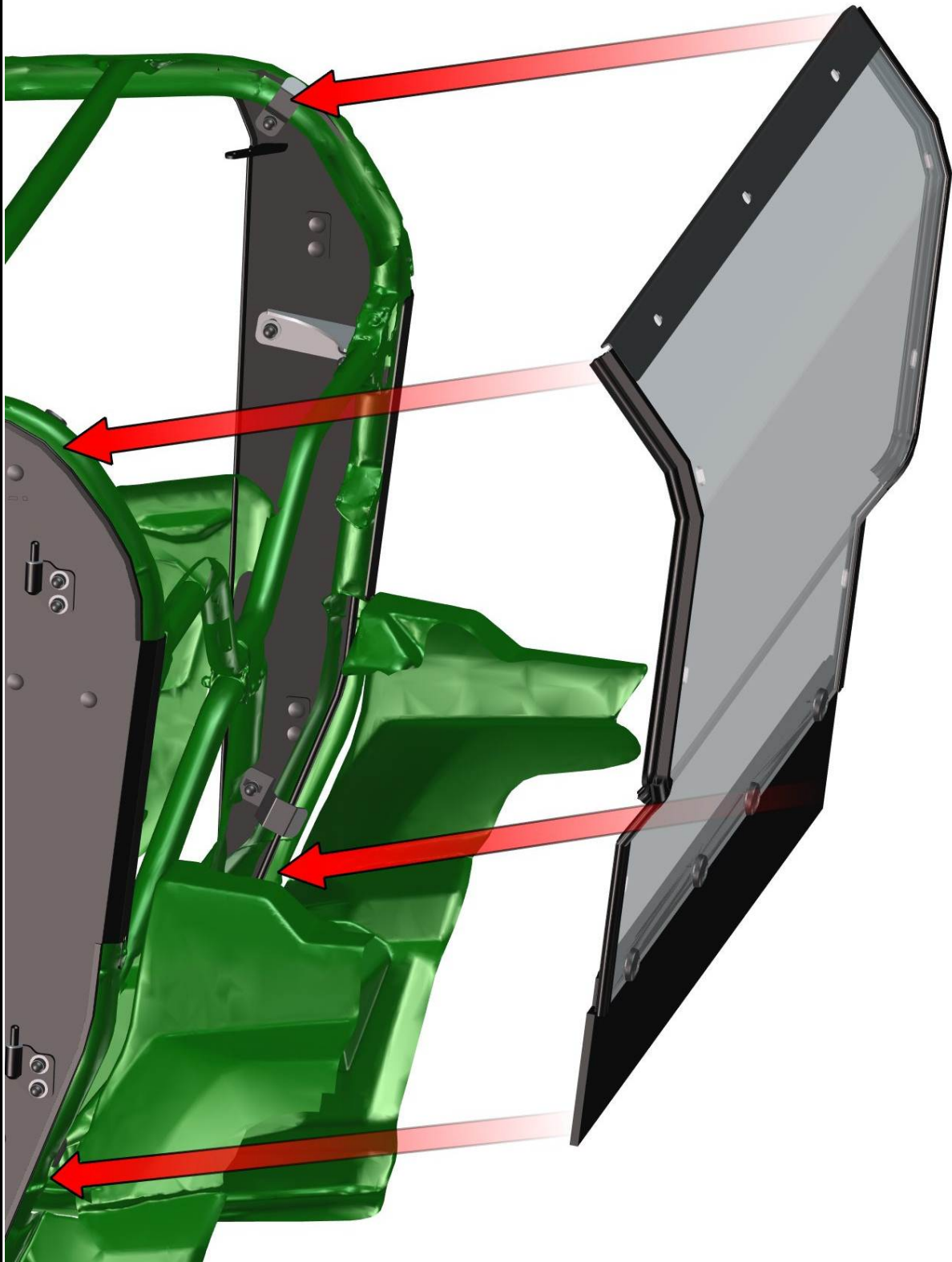

Place the rear panel holders onto the rear polycarbonate and fix by included screws, washers, nuts and covers on both sides.

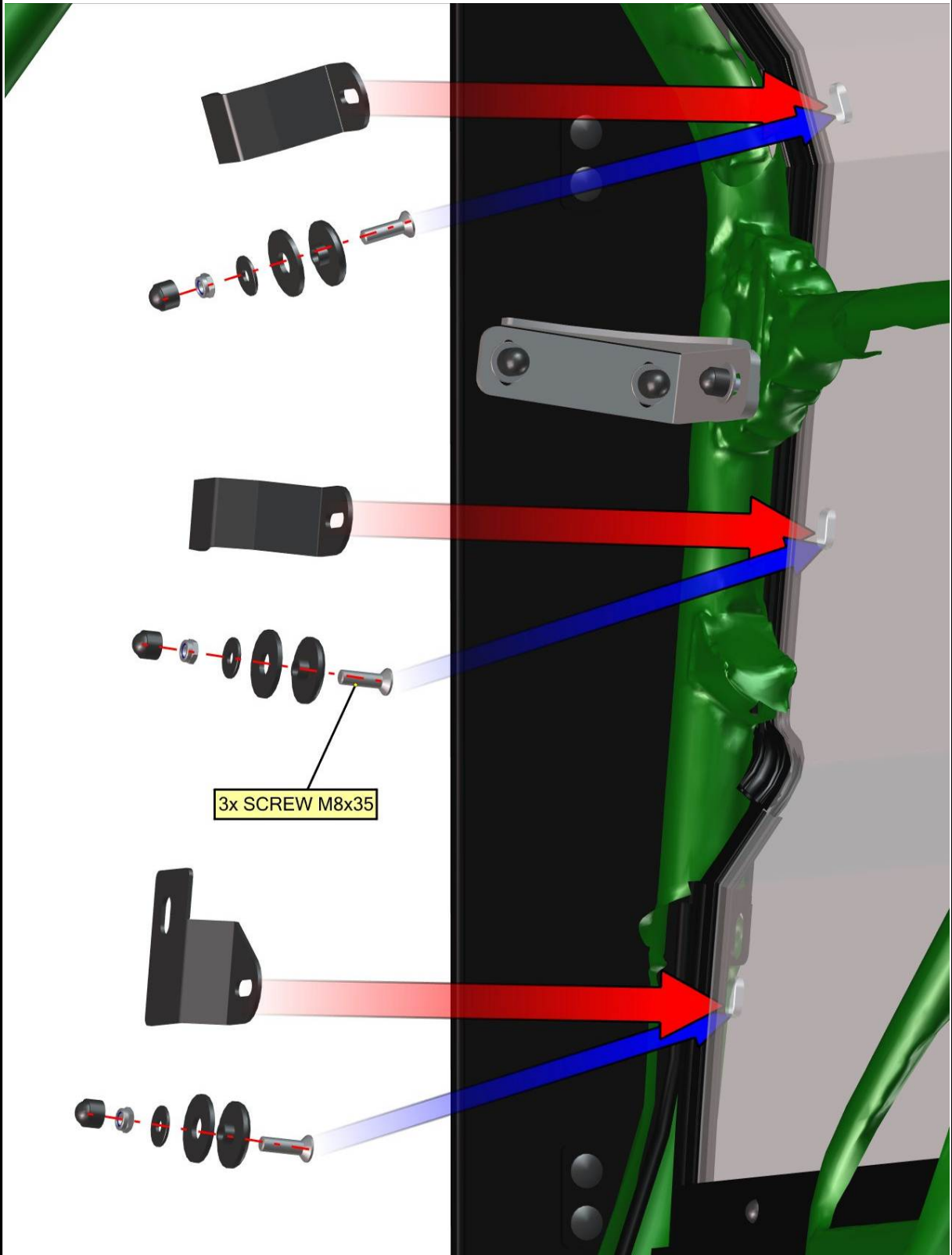

10

FOR ALL TECHNICAL QUESTIONS, PLEASE CALL
DFK AMERICA INC.
(630) 324-8585

FRONT PANEL 1.

Uninstall upper original screw from the UTV roller cage (red circle).



SEE NEXT PAGES

Replace the original screw by included screw from the inner side.

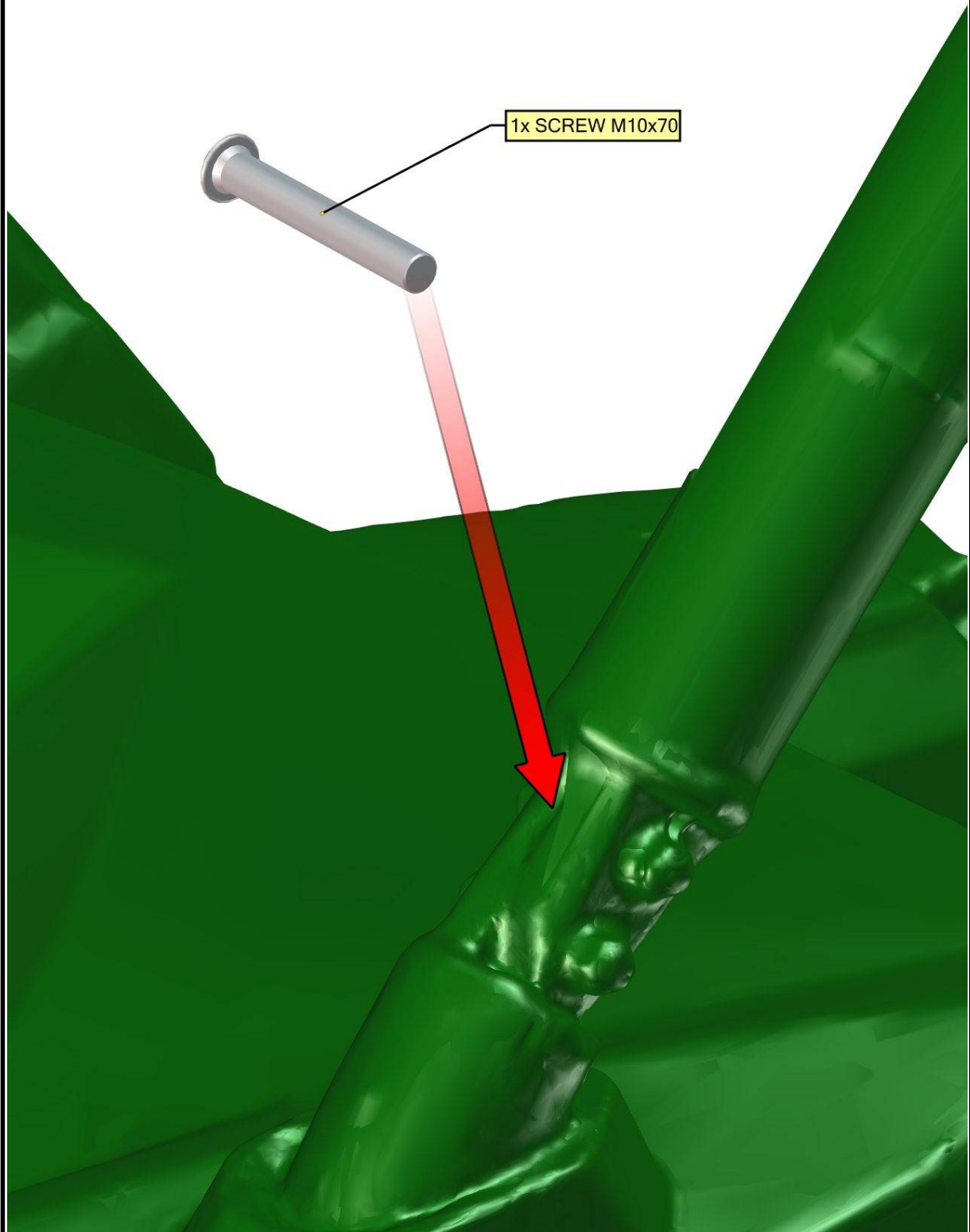

12

Uninstall the bottom original screw from the UTV roller cage (red circle).



SEE NEXT PAGES

Place the frame gap washer into the position and fix the bottom part by included screw , washer and nut.

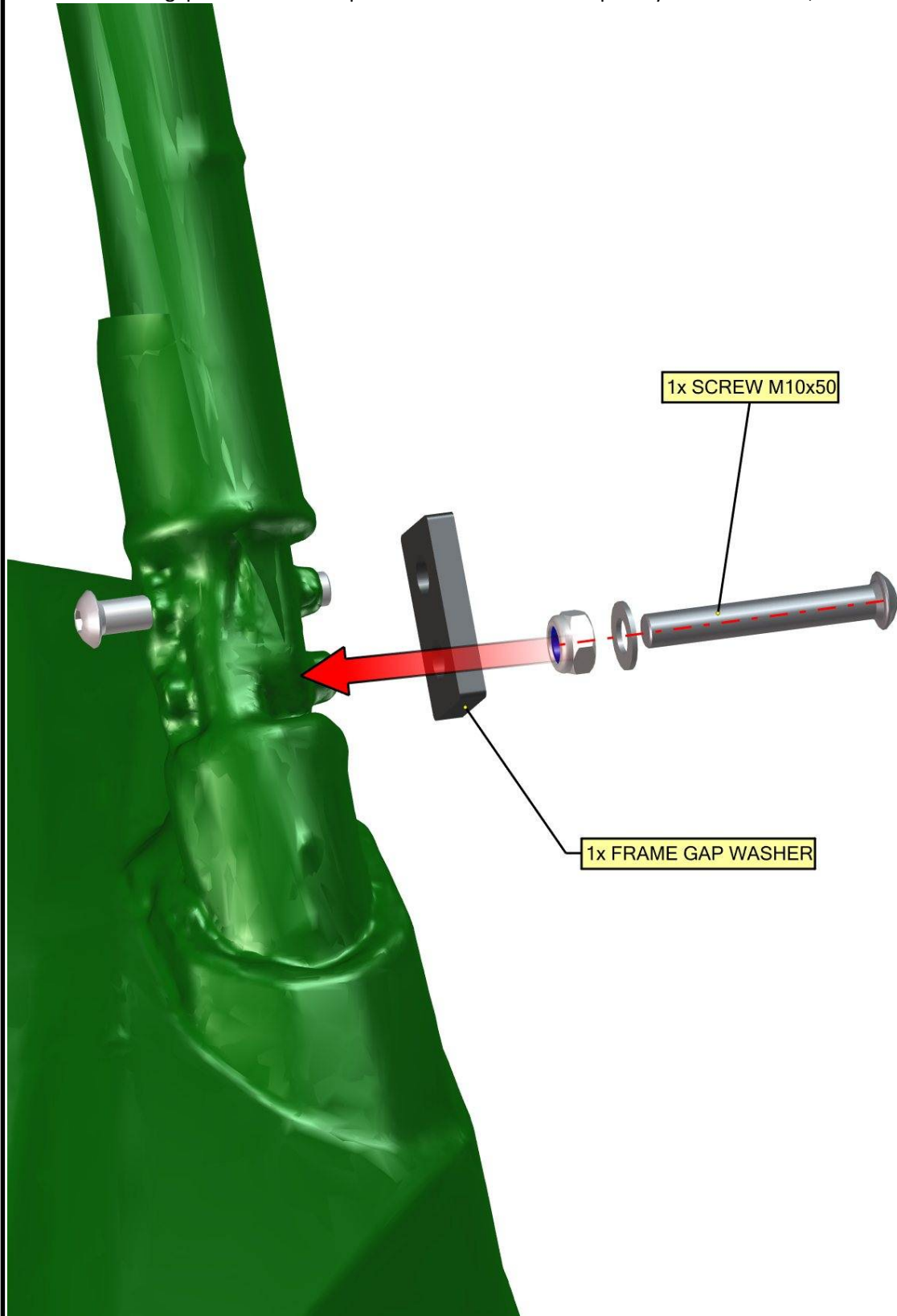

Place the front bottom leg holder into the best position. Replace the upper screw from the outer side and fix the front bottom ledge holder by the screw, washer and nut.

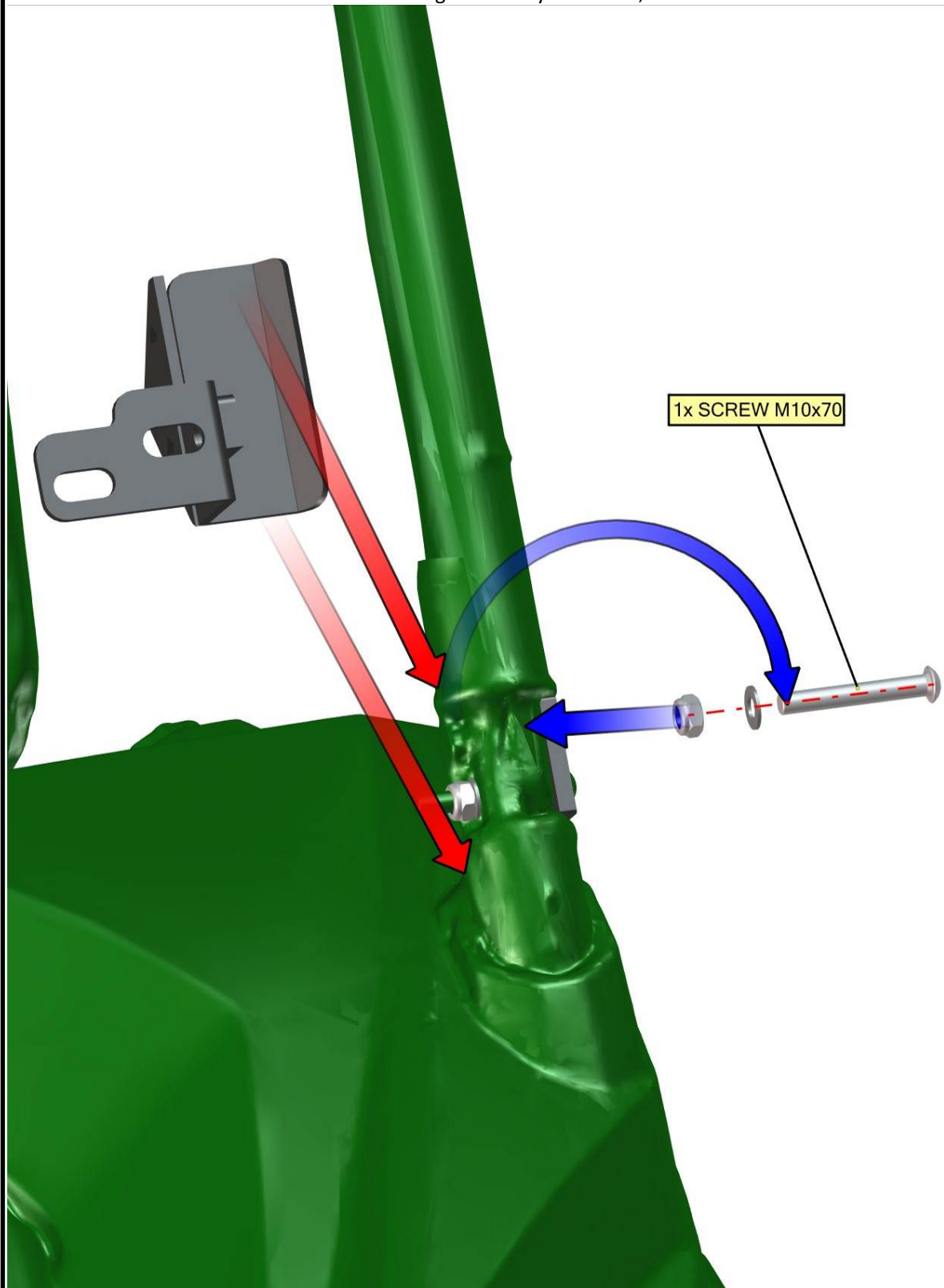

15

Repeat previous steps with the right bottom ledge holder assembly.

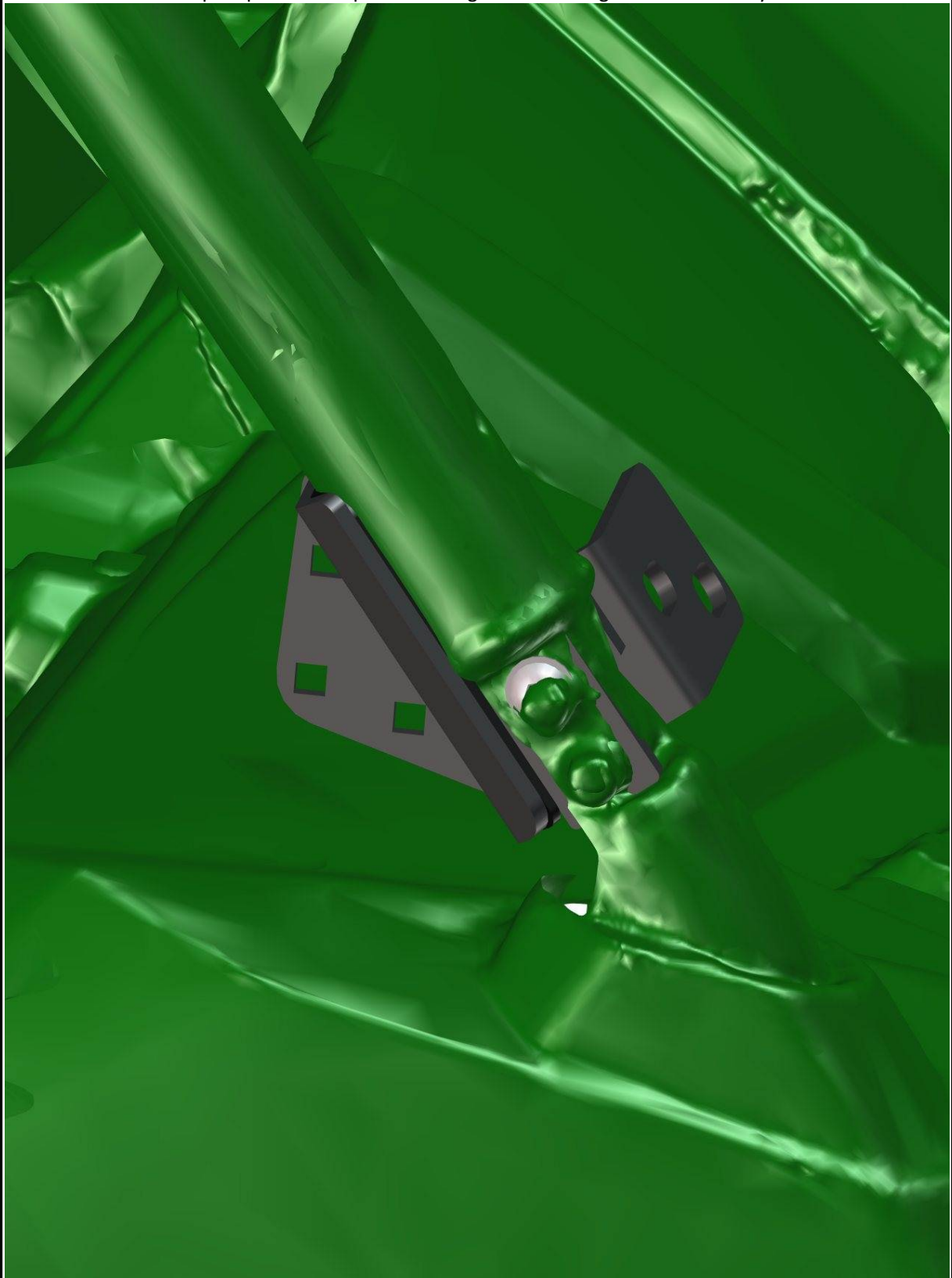

16

Place the front bottom ledge onto the front bottom ledge holders and fix by included screws, washers, nuts and covers.

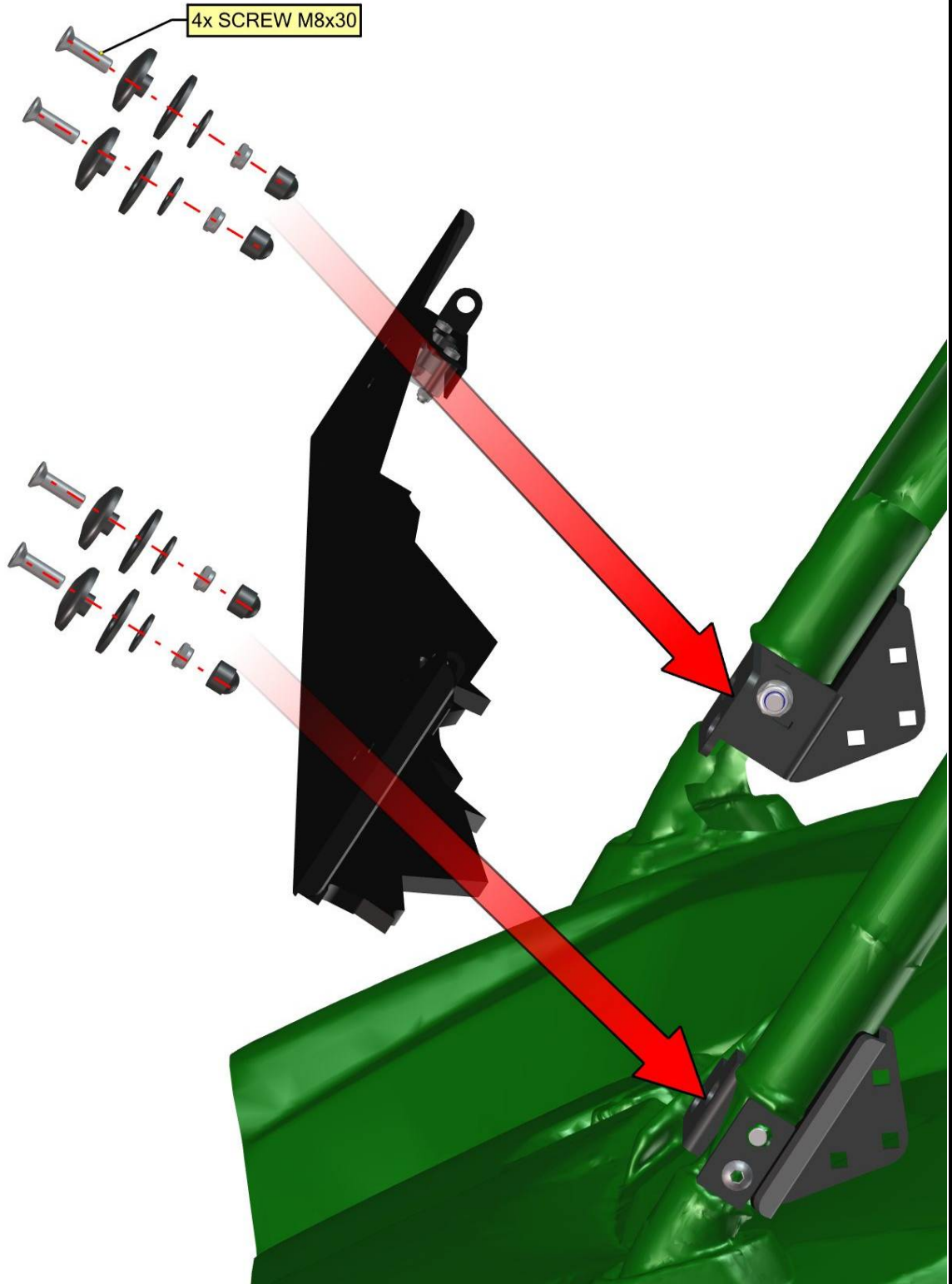

Place the front upper ledge onto the UTV roller cage and fix by included screws, washers, nuts and covers using original holes.

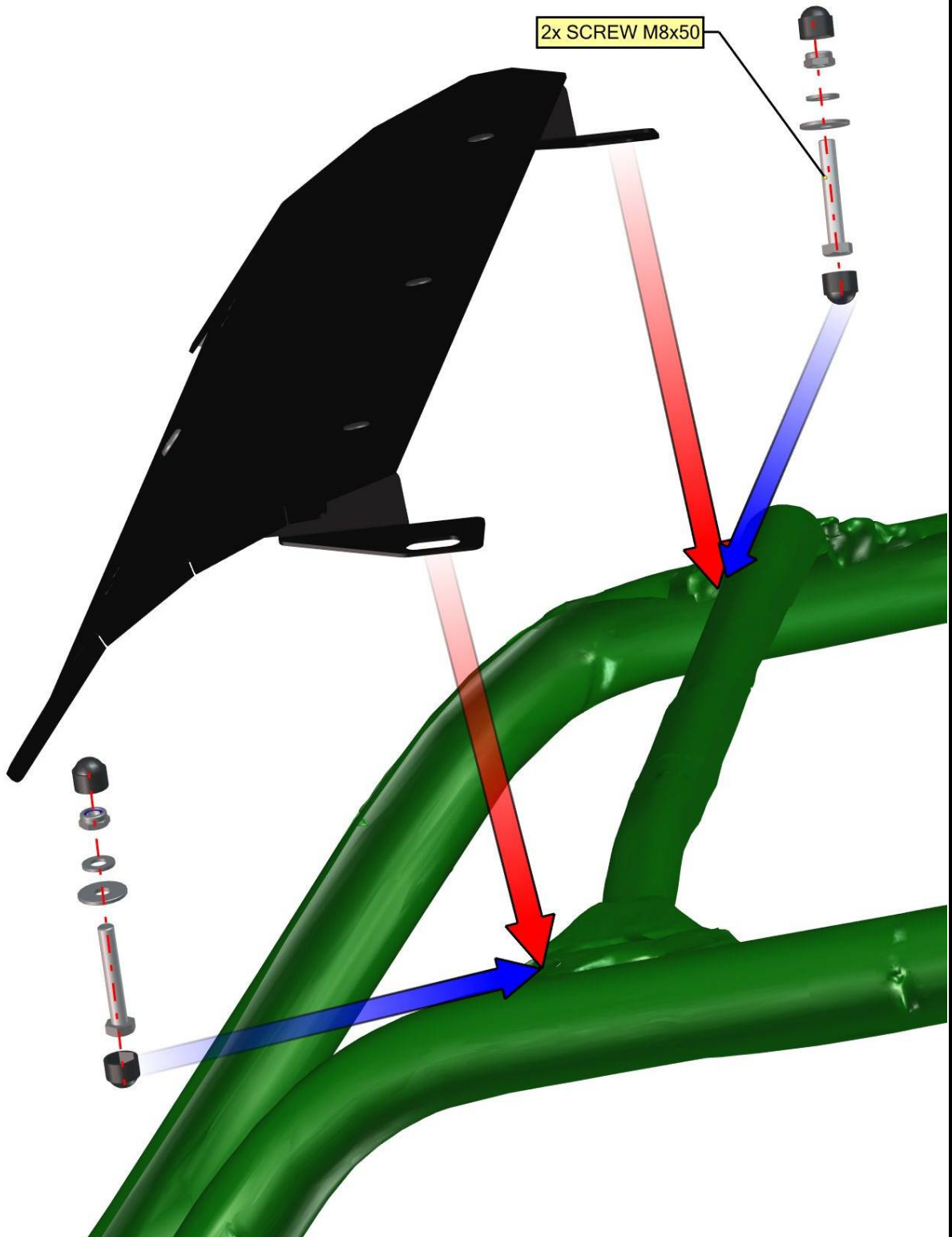

To fit the screws is necessary to uninstall original screws from the UTV roller cage lege and add 3 washers (included) to the fixing assembly (red circle) on both sides. DETAILED VIEW



Place the front upper ledge holder onto the UTV roller cage and fix by included screw, washer, nut and cover on both sides.

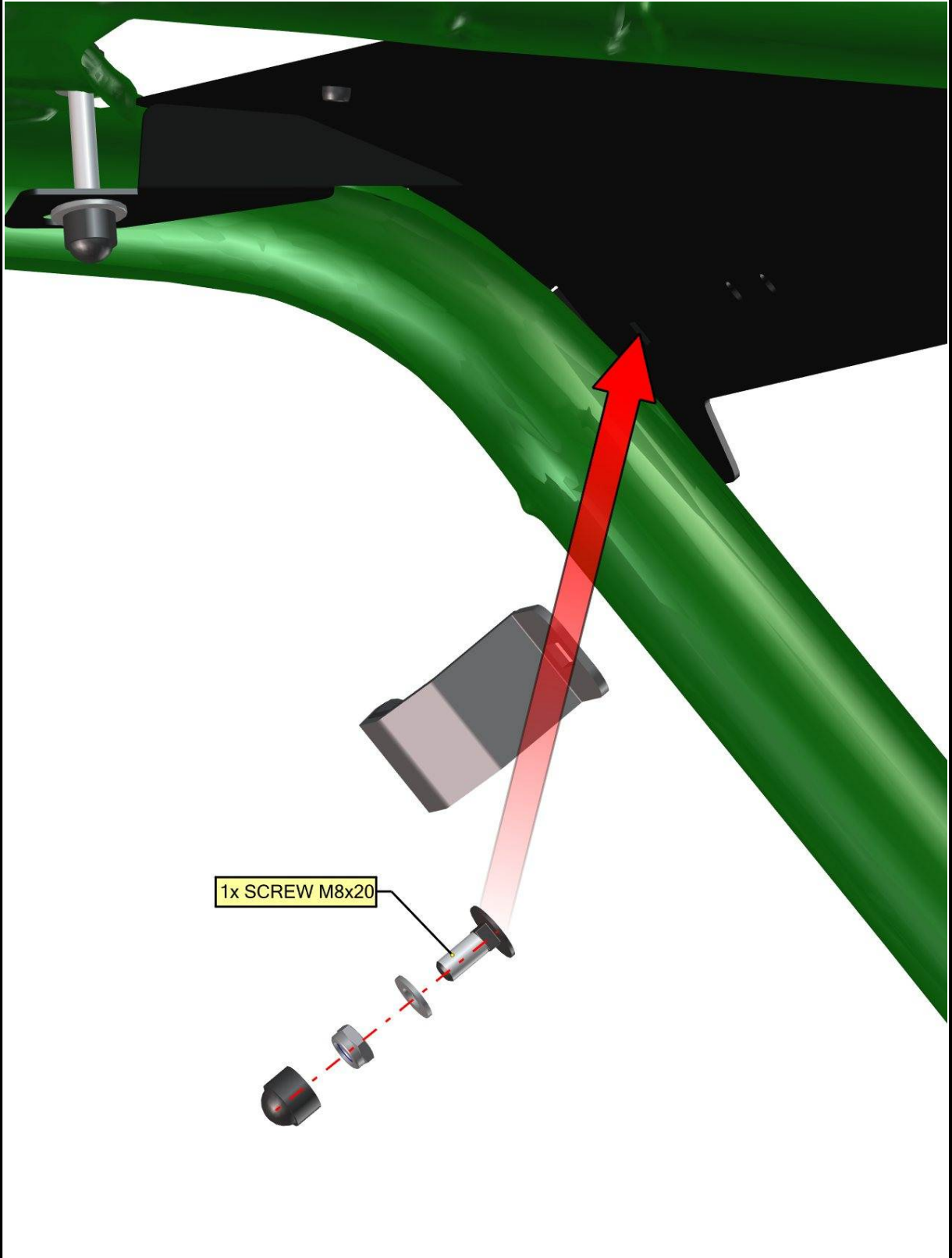

1x SCREW M8x20

20

ROOF

Place the roof onto the UTV roller cage.

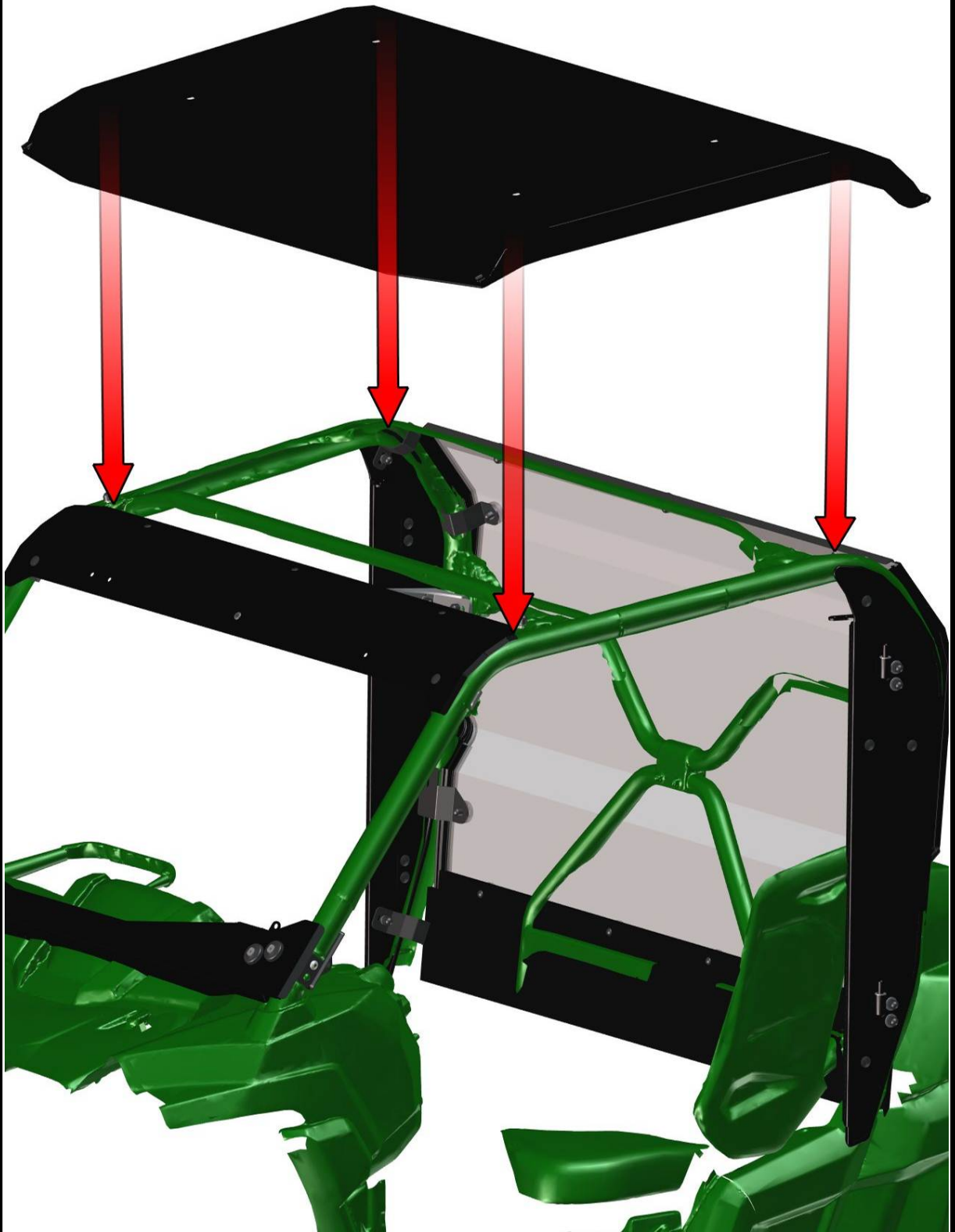

21

FOR ALL TECHNICAL QUESTIONS, PLEASE CALL
DFK AMERICA INC.
(630) 324-8585

Place the roof holders onto the roof panel and fix by included screws, washers, nuts and covers on both sides.

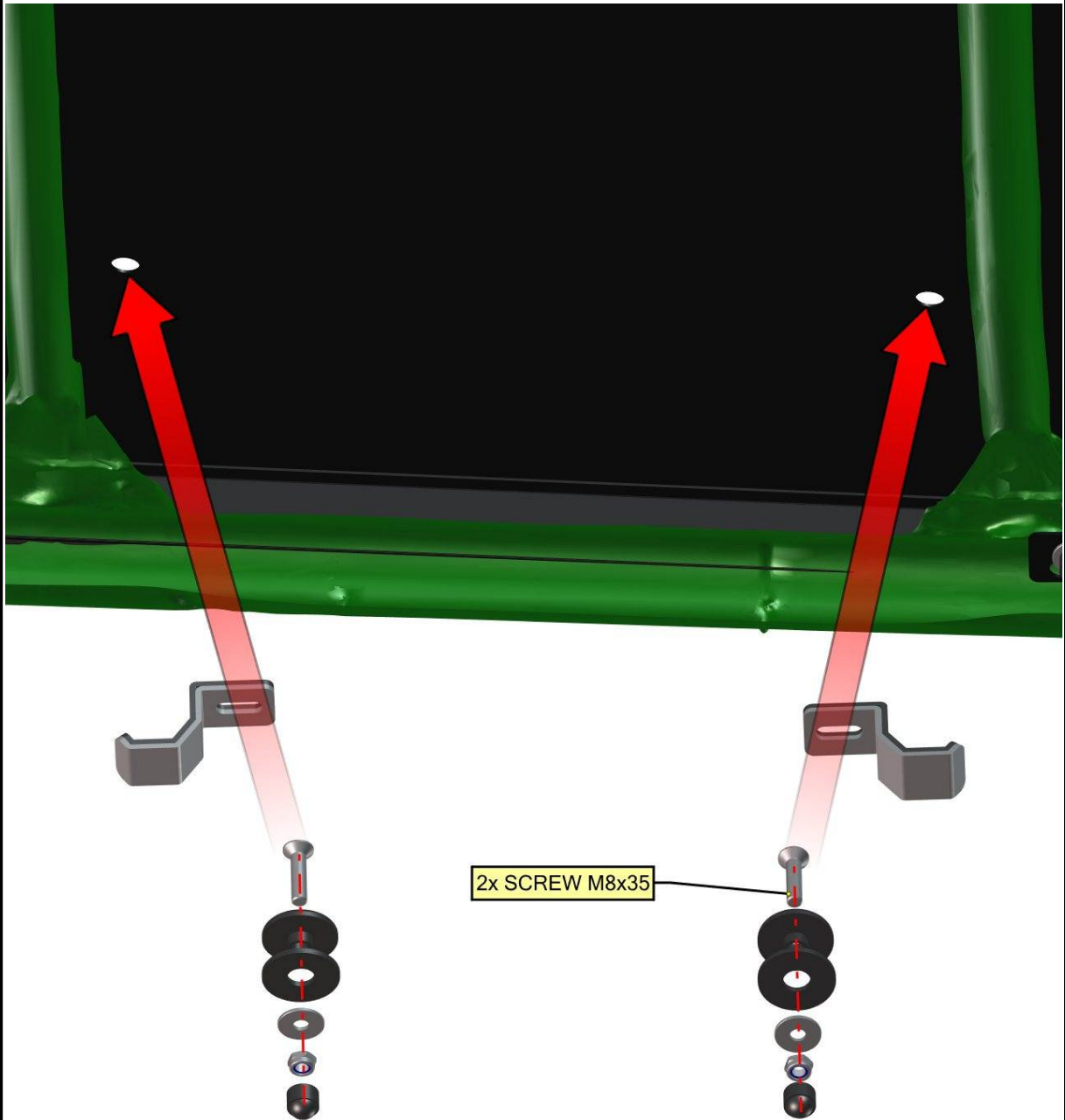

Fix the roof with the rear polycarbonate by included screws, washers, nuts and covers.

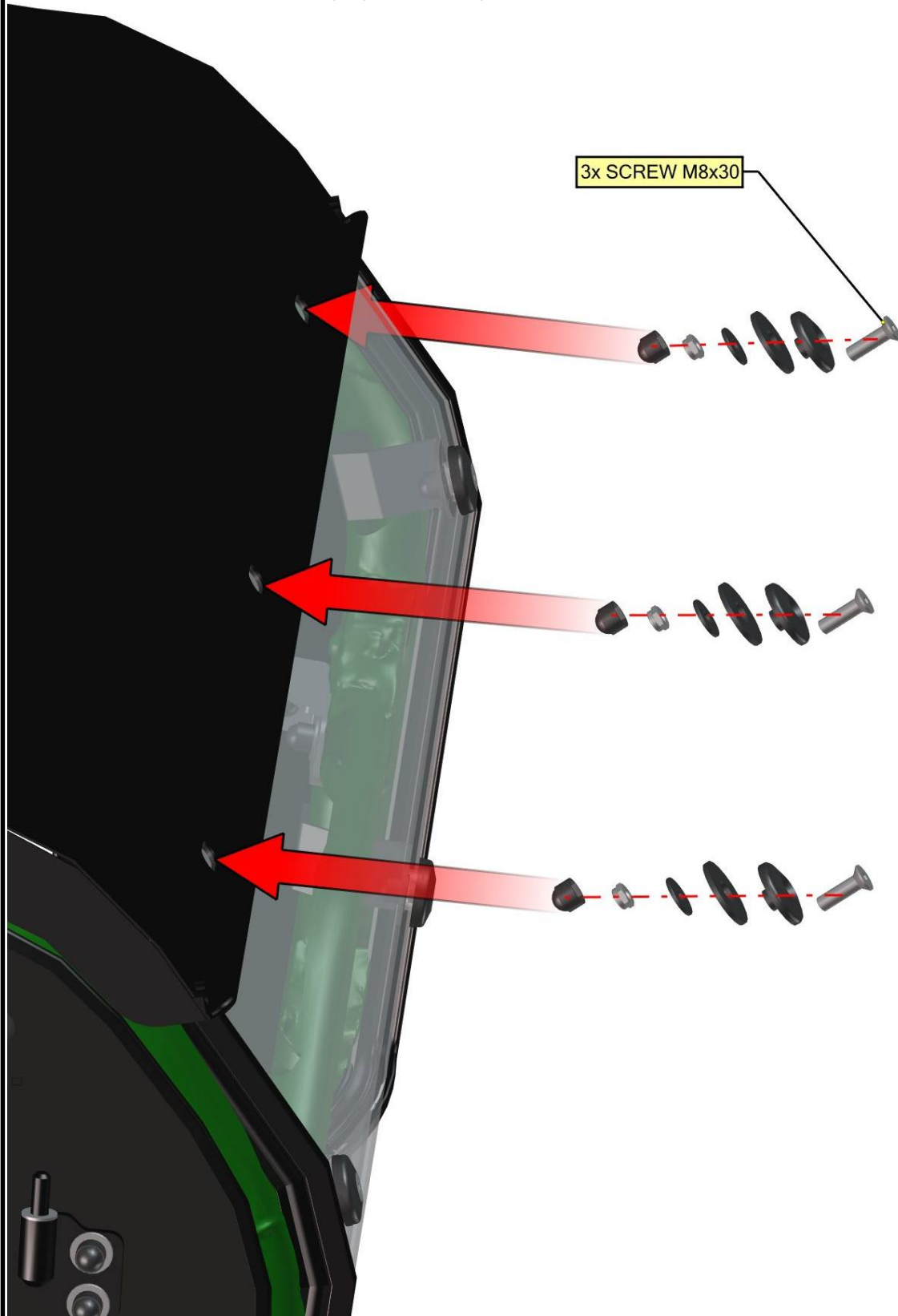

FOR ORIGINAL ROOF PANEL ONLY

Place the rear upper sealing ledge onto the rear panel and fix by included screws, washers, nuts and covers.

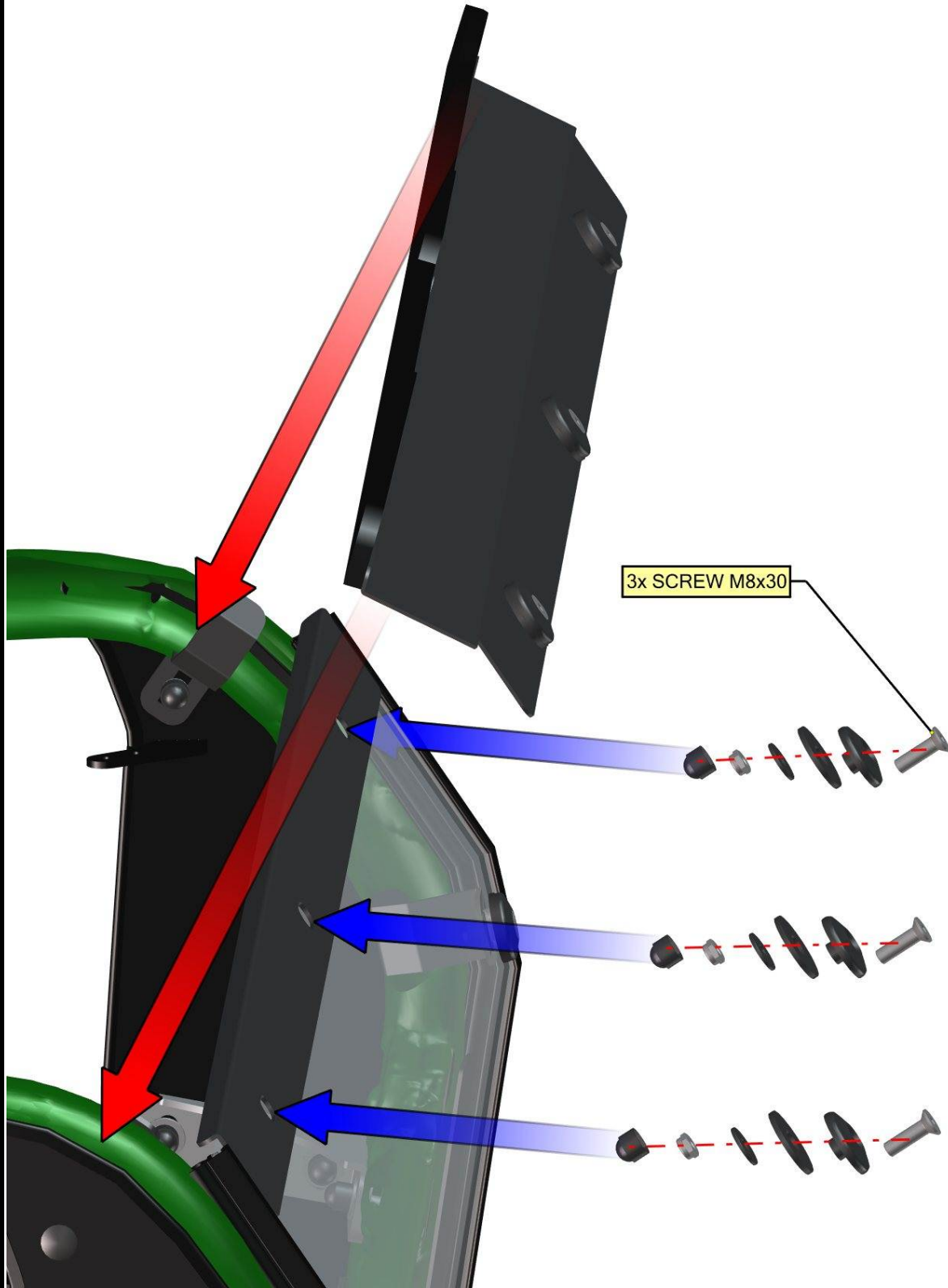

Place the front upper sealing ledge onto the front upper ledge and fix by included screws, washers, nuts and covers.

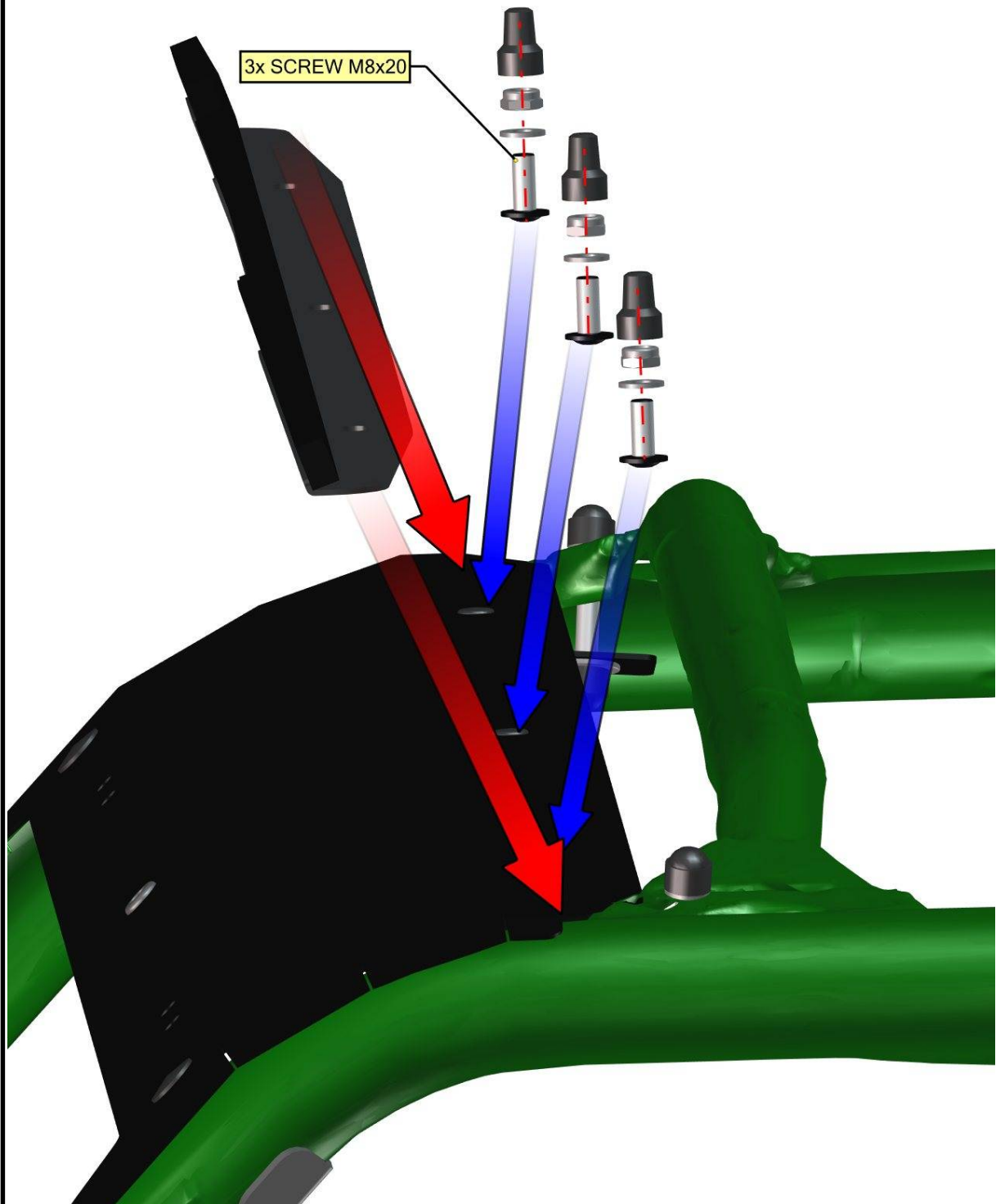

Place the original roof panel onto the UTV roller cage and fix in accordance with original roof instructions.
(not actual roof panel)

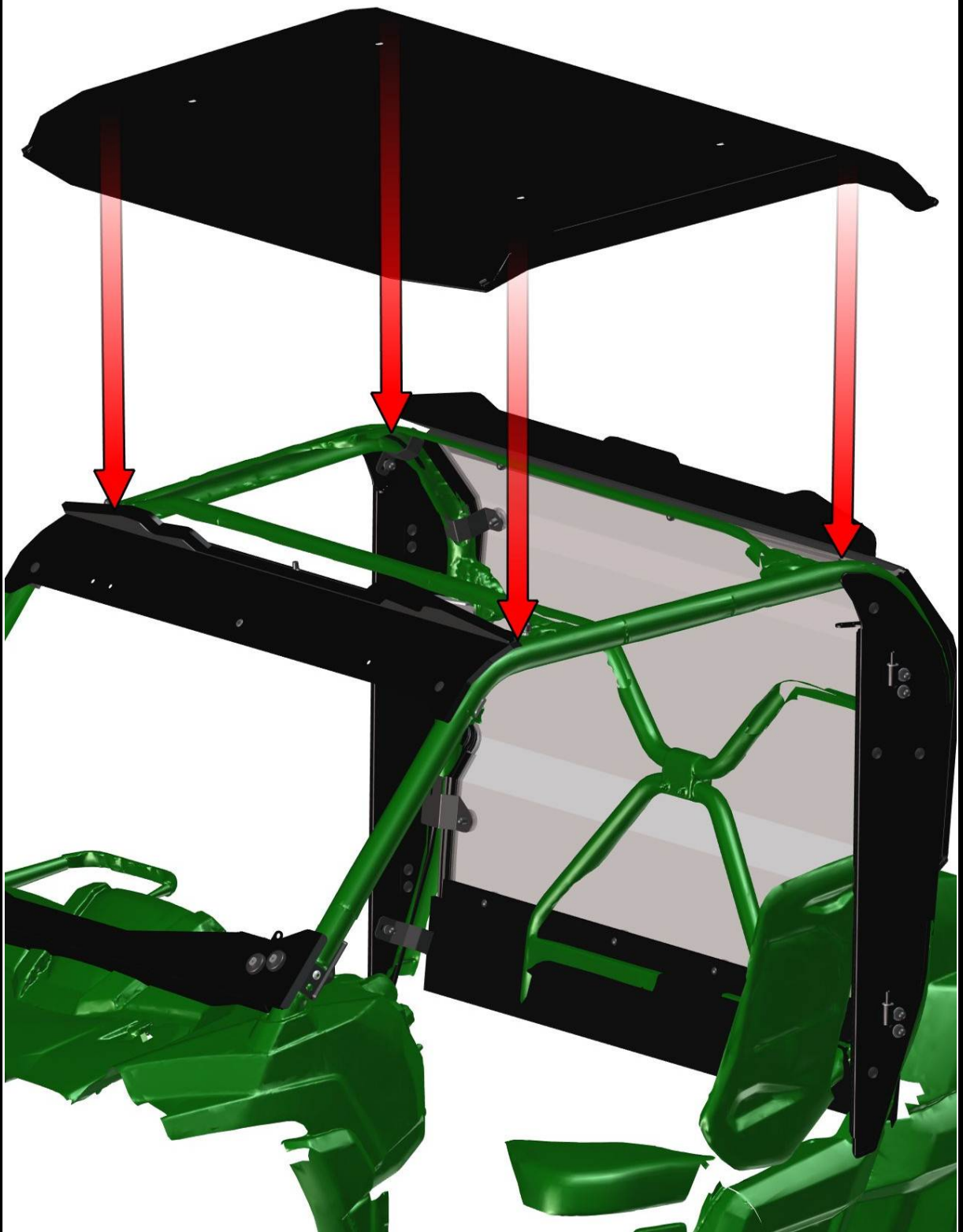

26

FOR ALL TECHNICAL QUESTIONS, PLEASE CALL
DFK AMERICA INC.
(630) 324-8585

FRONT PANEL 2.

Place the front glass assembly into the best position and fix the front hinges with the front upper ledge by included screws, washers, nuts and covers.

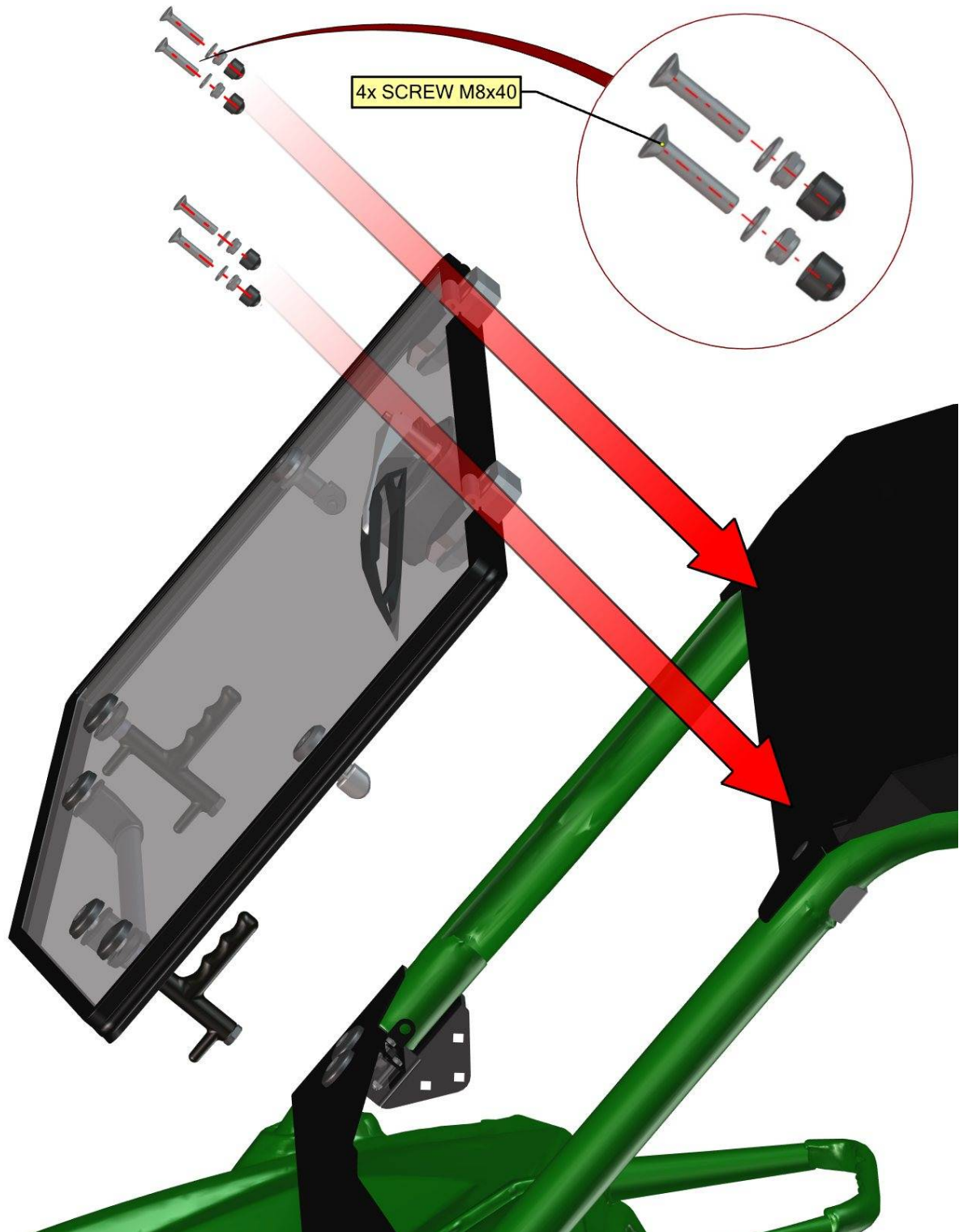

Install the gas spring into the gas spring holders on both sides.

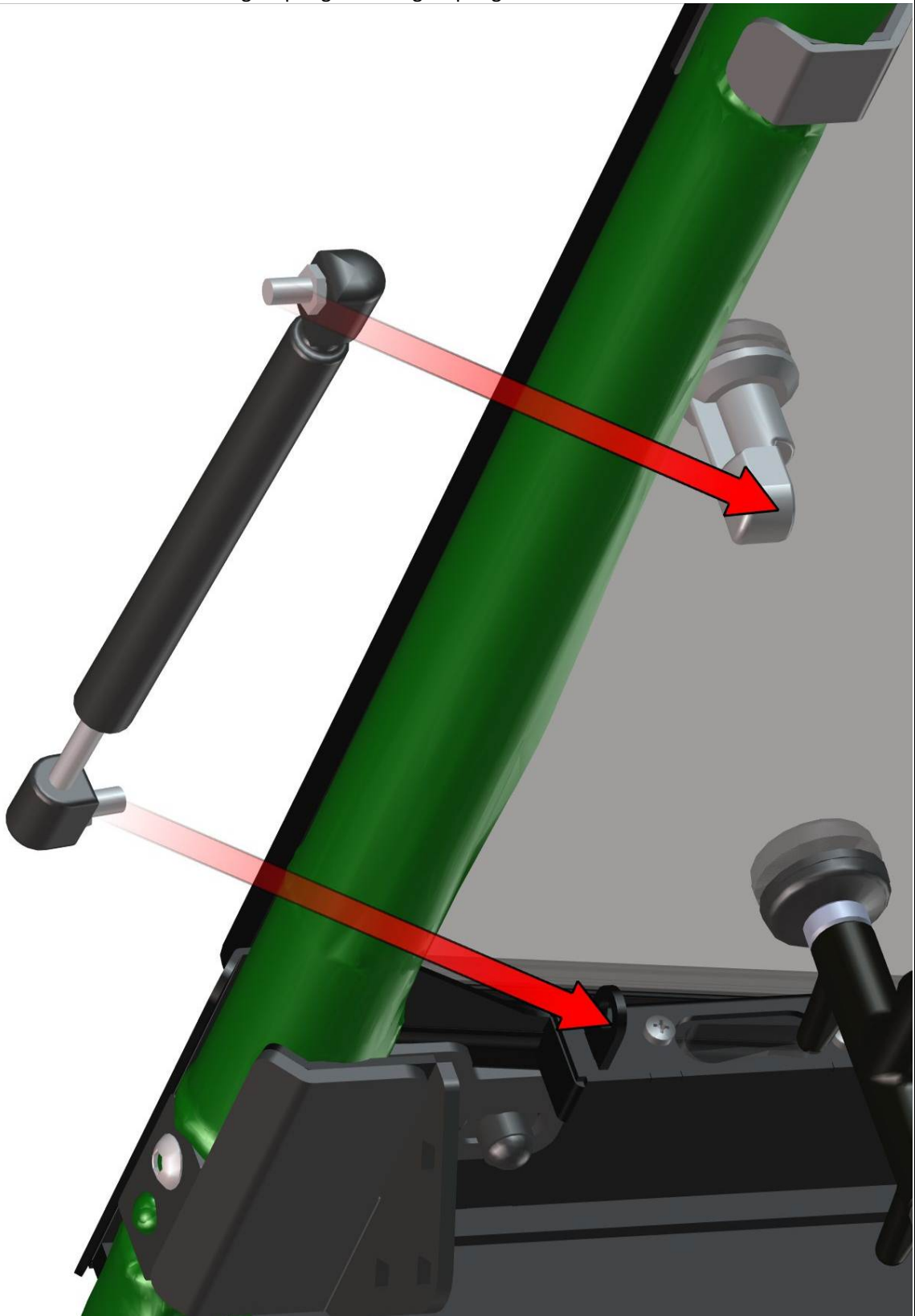

LEFT DOOR + RIGHT DOOR 2.

Place the left door sealing ledge onto the UTV panels and fix by included screws, washers and covers..

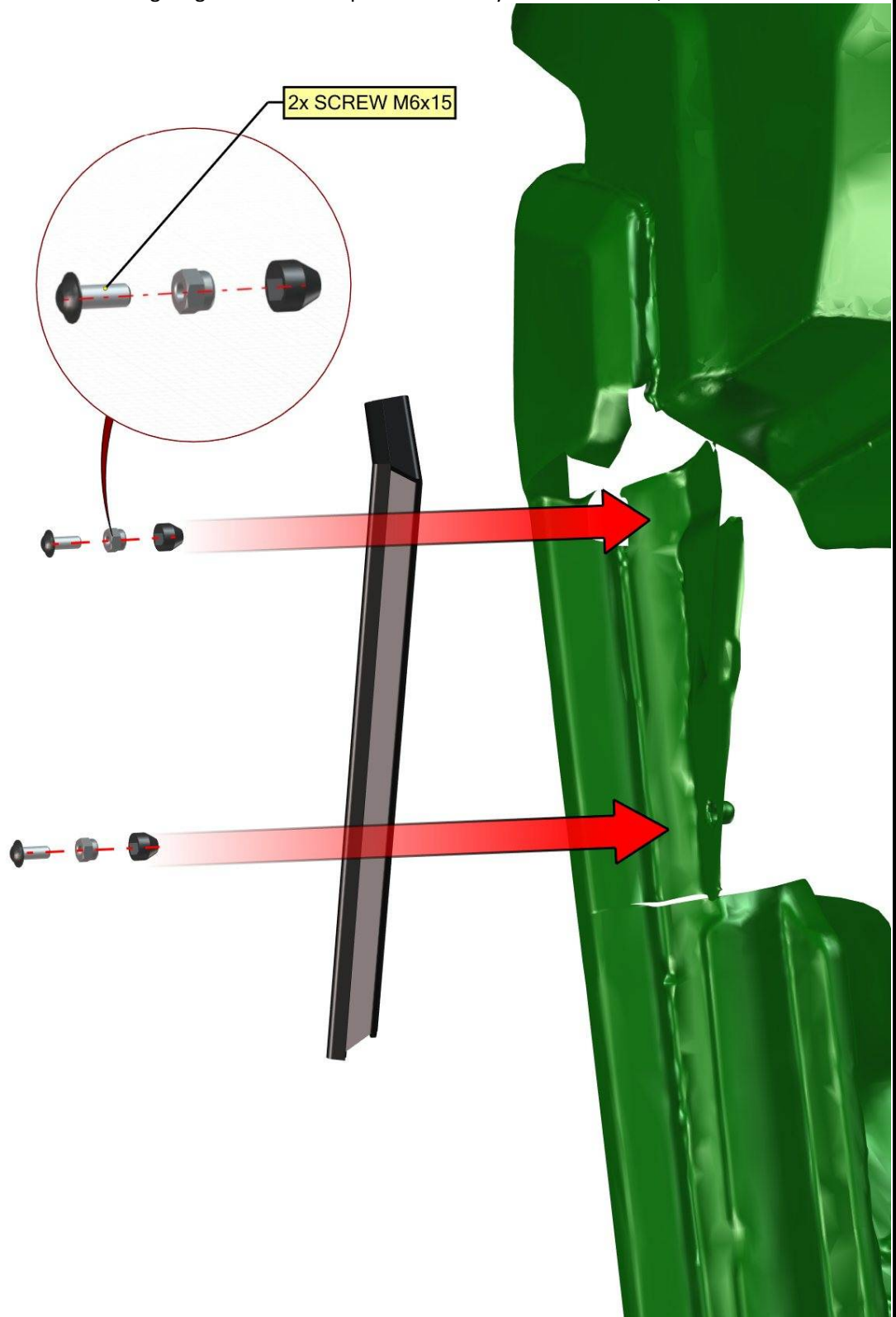

Detailed view



30

FOR ALL TECHNICAL QUESTIONS, PLEASE CALL
DFK AMERICA INC.
(630) 324-8585

Install the door stop assembly into the left door stop holder.

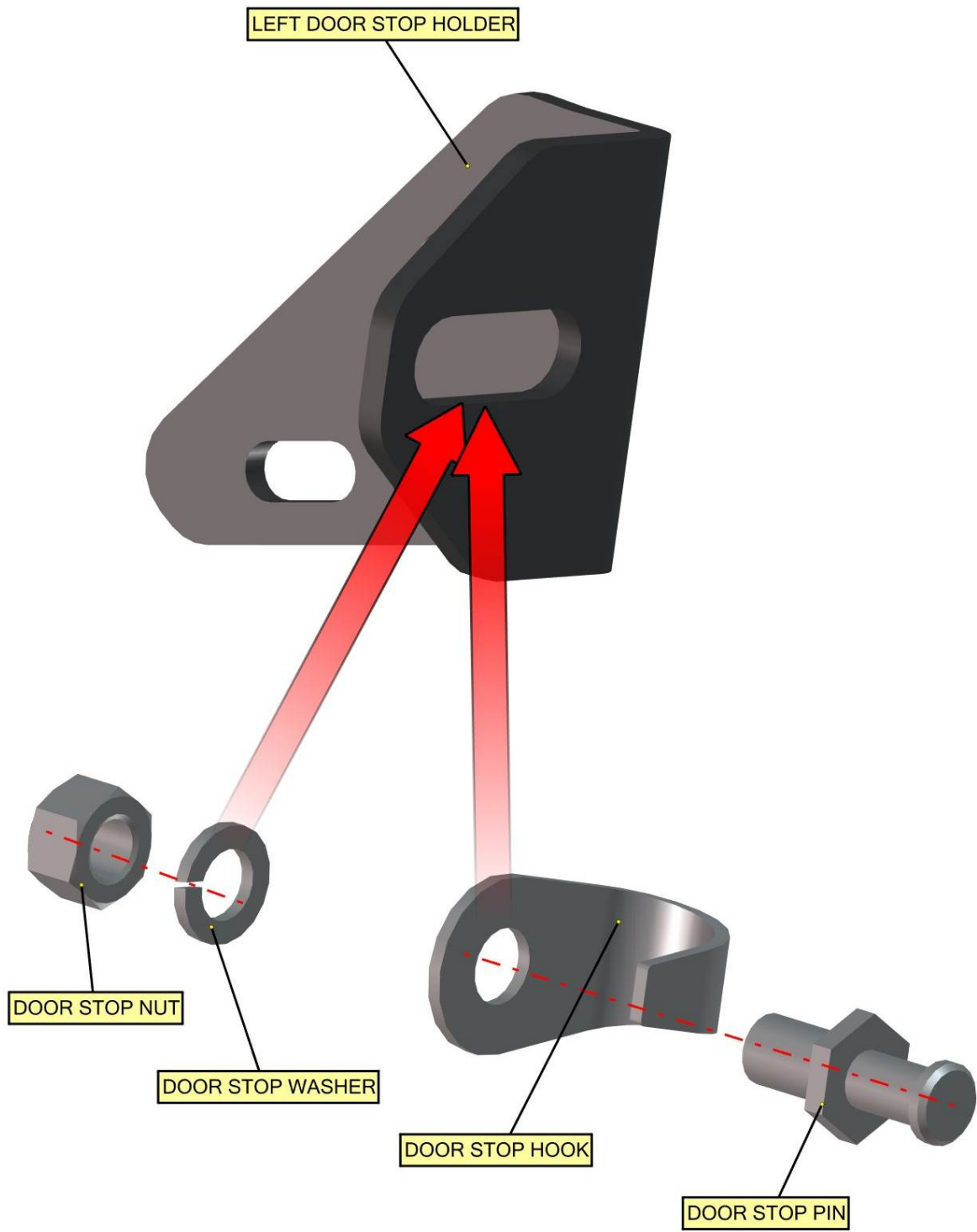

Place the left door stop assembly onto the left front bottom ledge holder and fix by included screws, washers, nuts and covers.

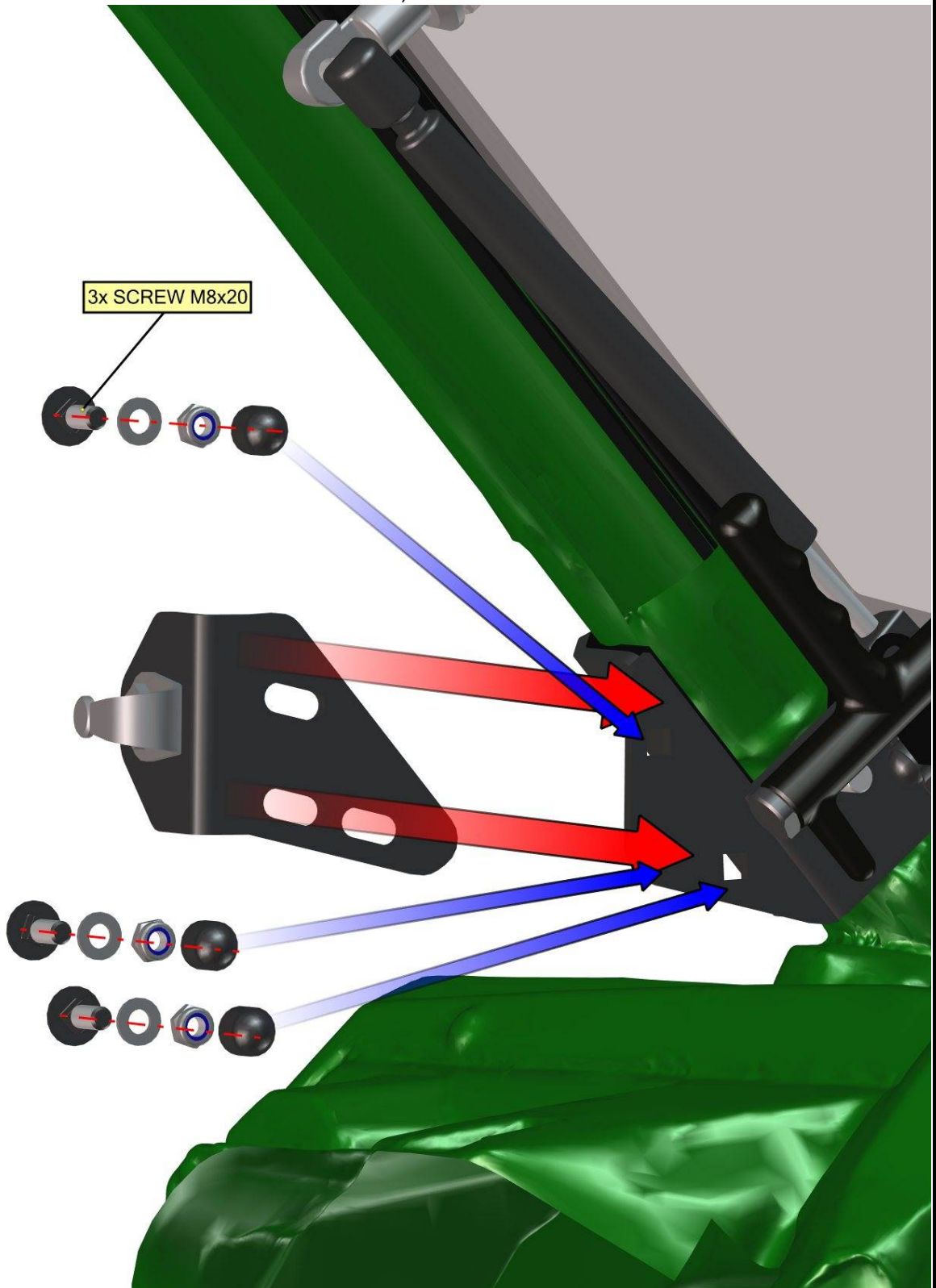

Lubricate the hinges pins and instal washers onto them. Place the left door onto the hinges.

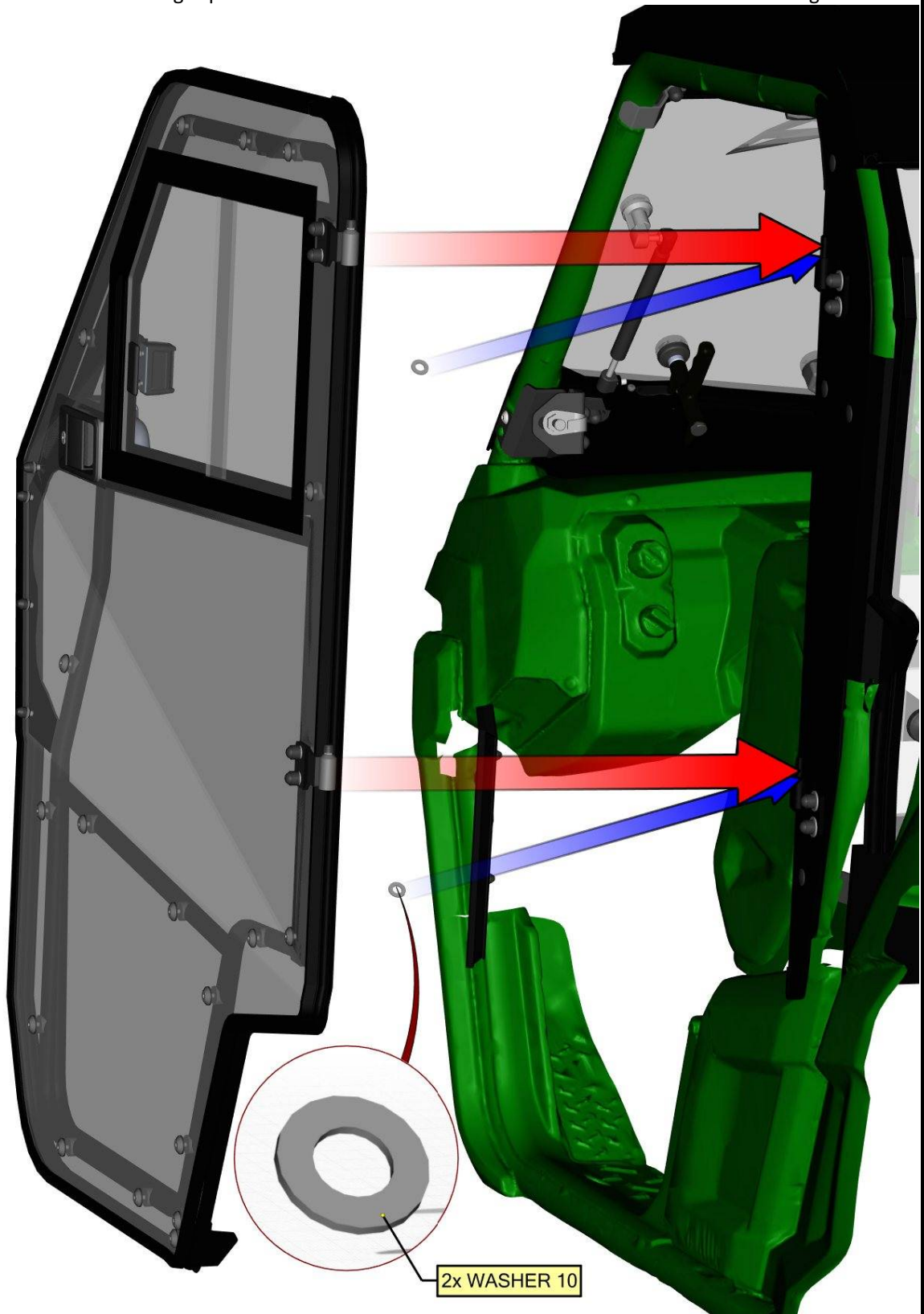

Adjust the left door into the best position by hinges and tighten screws correctly.

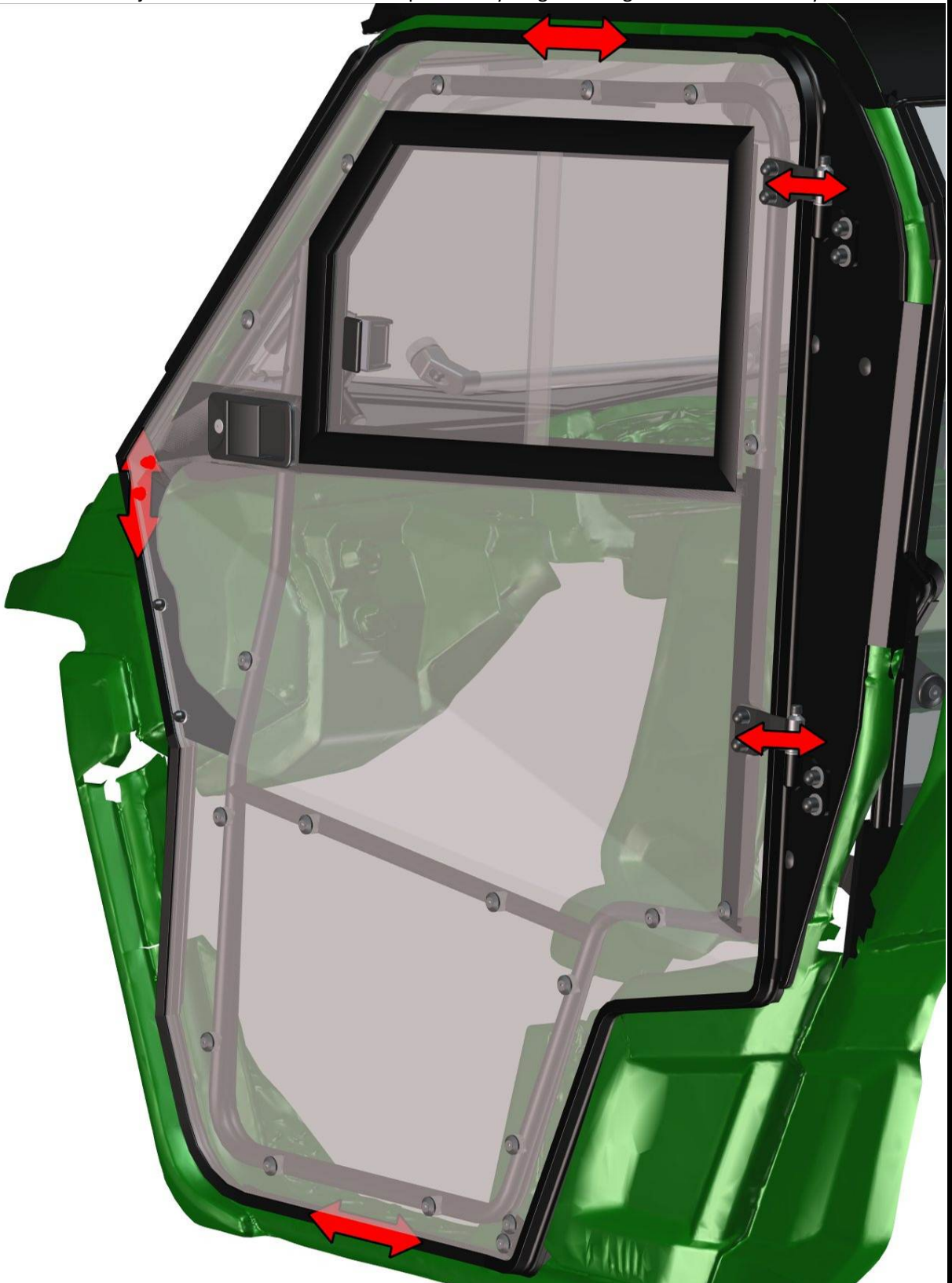

34

FOR ALL TECHNICAL QUESTIONS, PLEASE CALL
DFK AMERICA INC.
(630) 324-8585

Adjust the left door stop assembly into the best position and tighten screws correctly.

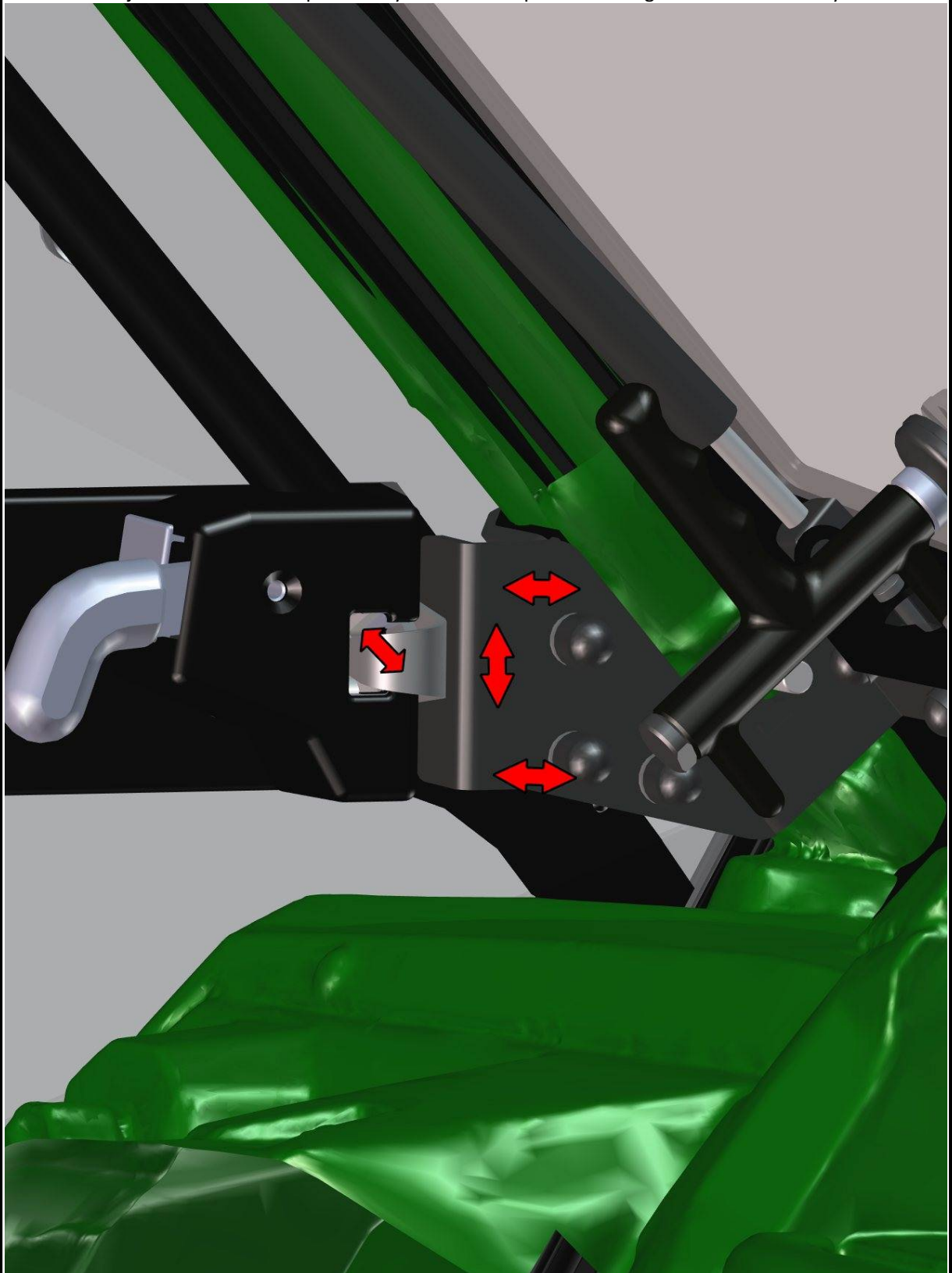

35

Install the gas spring into the gas spring holders.

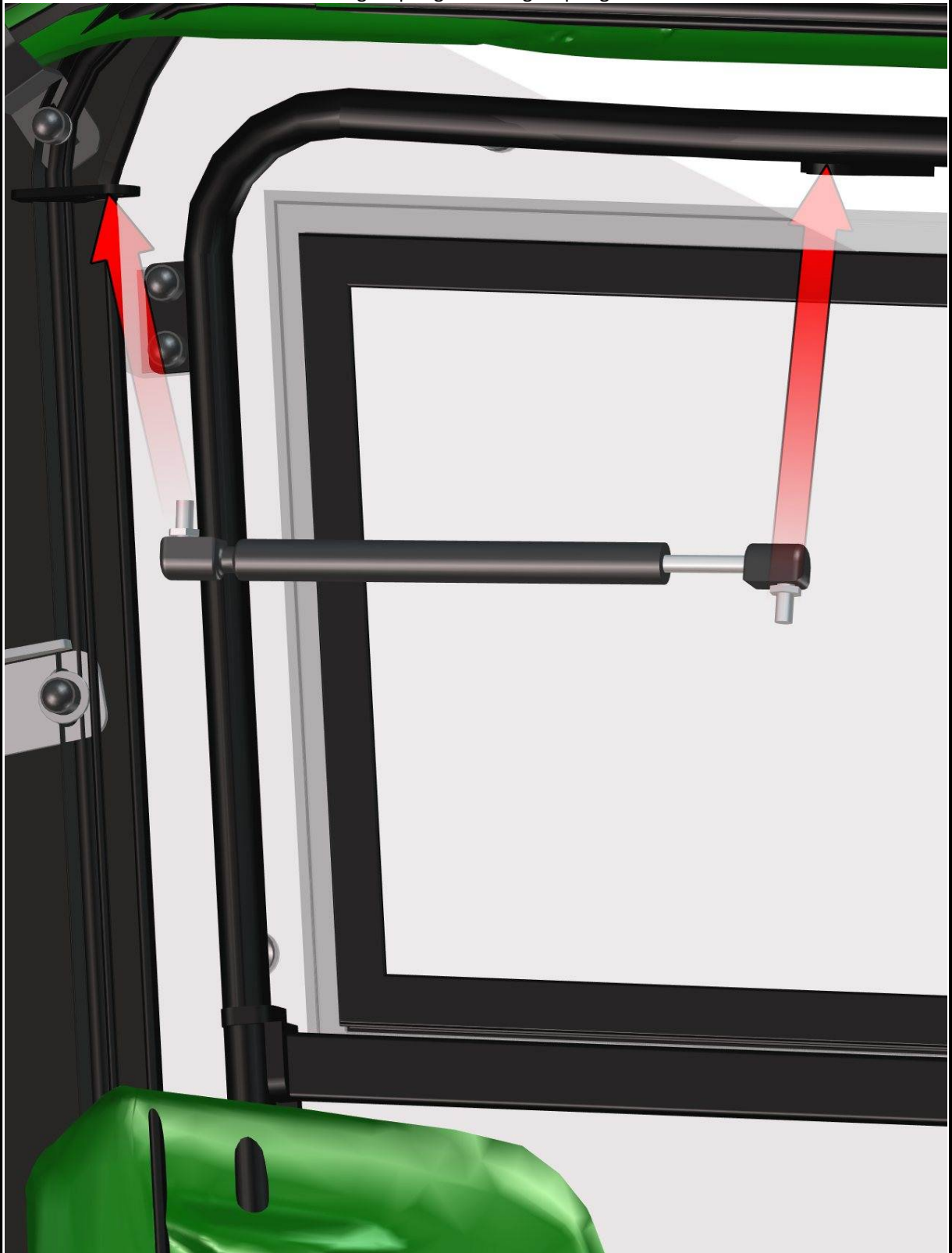

36

REPEAT PREVIOUS STEPS WITH THE RIGHT DOOR ASSEMBLY.

FOR ALL TECHNICAL QUESTIONS, PLEASE CALL
DFK AMERICA INC.
(630) 324-8585

ELECTROINSTALLATION

WIPER/WASHER

Accessories for mounting the washer tank.

Washer harness



Wiper harness

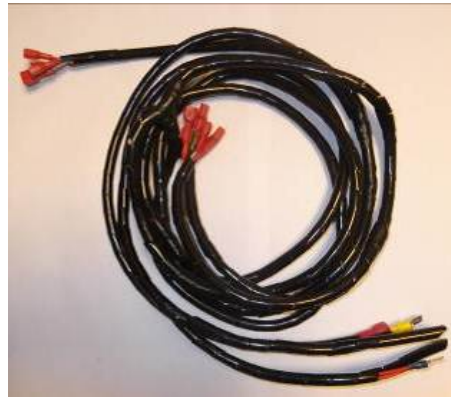

Washer tube



Wiper/washer switch



Overall wiring diagram

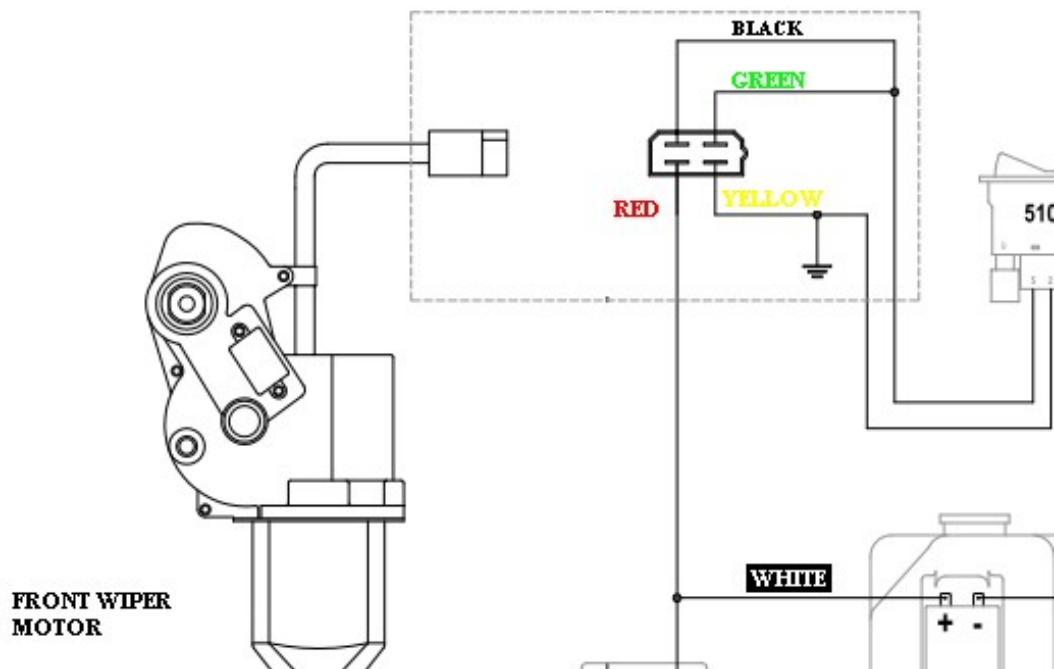



YAMAHA

WOLVERINE

HardCabs →

Install the washer tank holder onto the UTV frame and place the washer tank onto the holder.
Connect the washer harness to the washer motor (red circle).



39

Lead the washers harness through the front boot space to the right side of the vehicle (red line).



FOR ALL TECHNICAL QUESTIONS, PLEASE CALL
DFK AMERICA INC.
(630) 324-8585

Lead the wiper harness to the wiper motor.

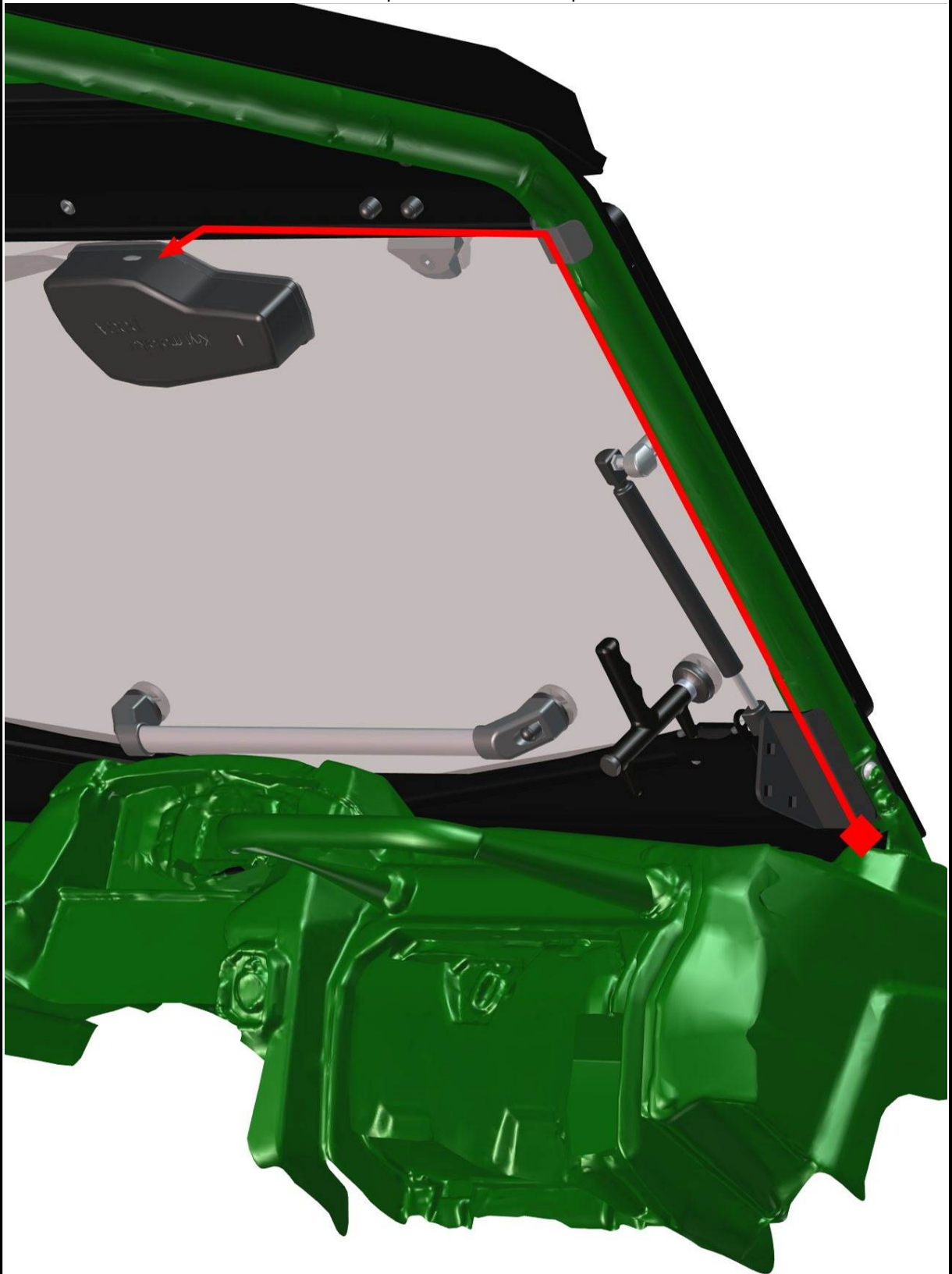

Lead the wiper/washer switch harness under the dashboard to the prepared hole (red rectangle) and lead the harness through.



Connect the wiper/washer switch harness to the switch a press it into the hole.
(DETAILED VIEW of the connection)

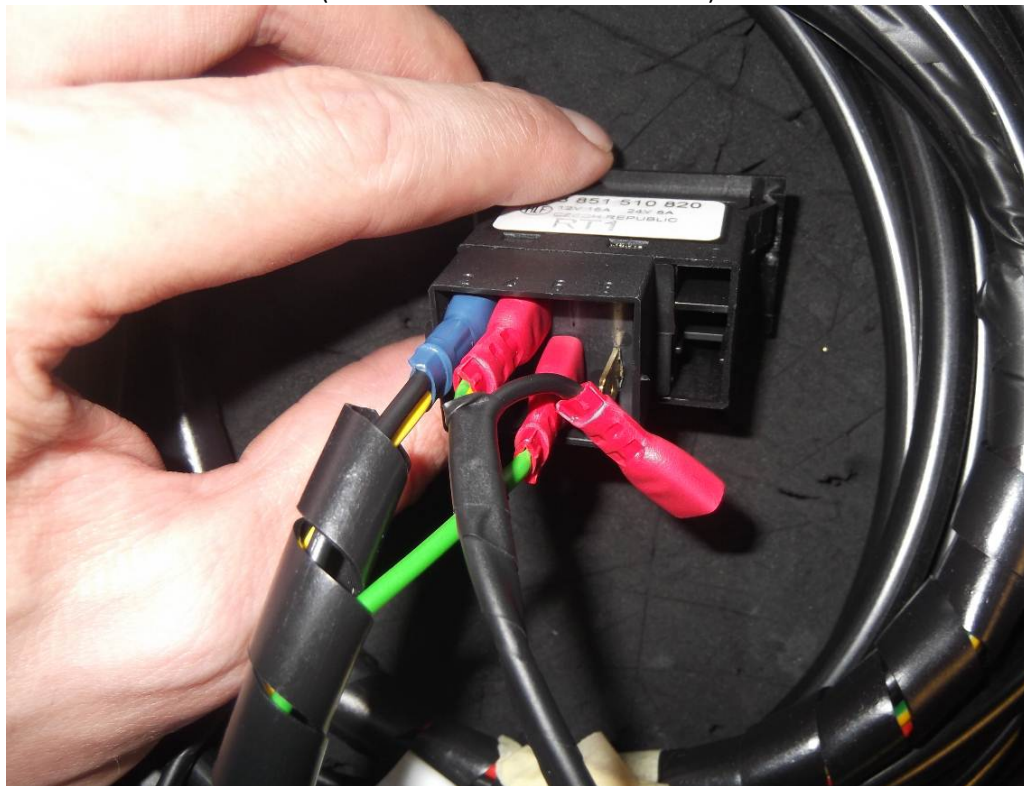

FOR ALL TECHNICAL QUESTIONS, PLEASE CALL
DFK AMERICA INC.
(630) 324-8585

Uninstall the wiper motor cover from the wiper motor and save for later usage.
Connect the wiper harness branch with the wiper motor connector.

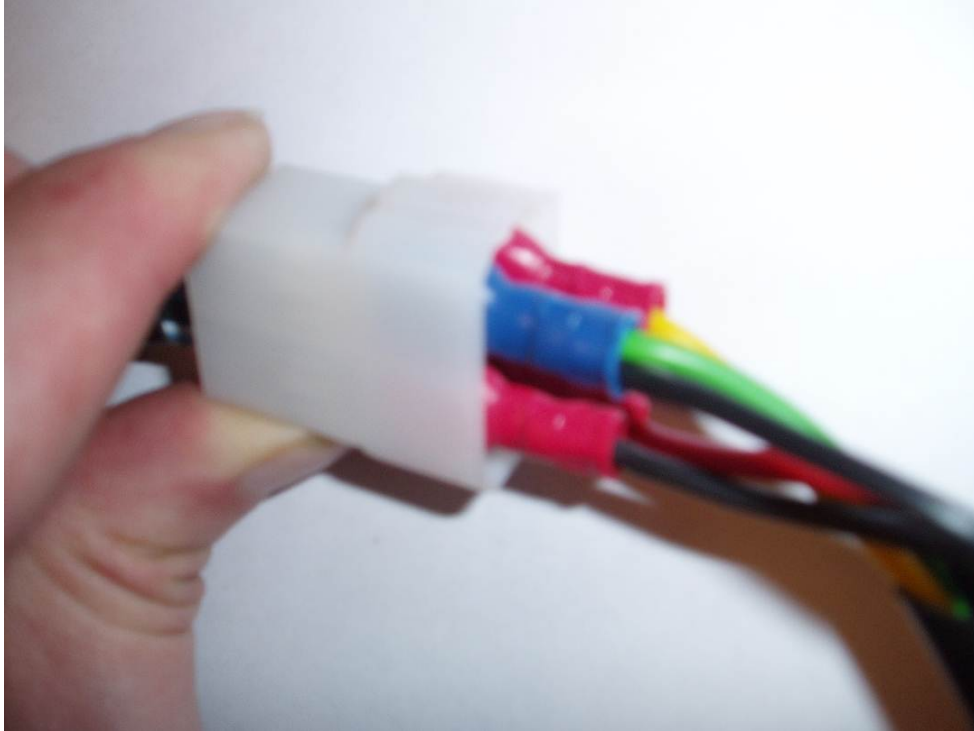

Install the wiper motor cover back to position.

Connect the washer hose by the washer tube with the wiper arm washer hose.



Connect the branches with the UTV's fuse box and with the battery "-"

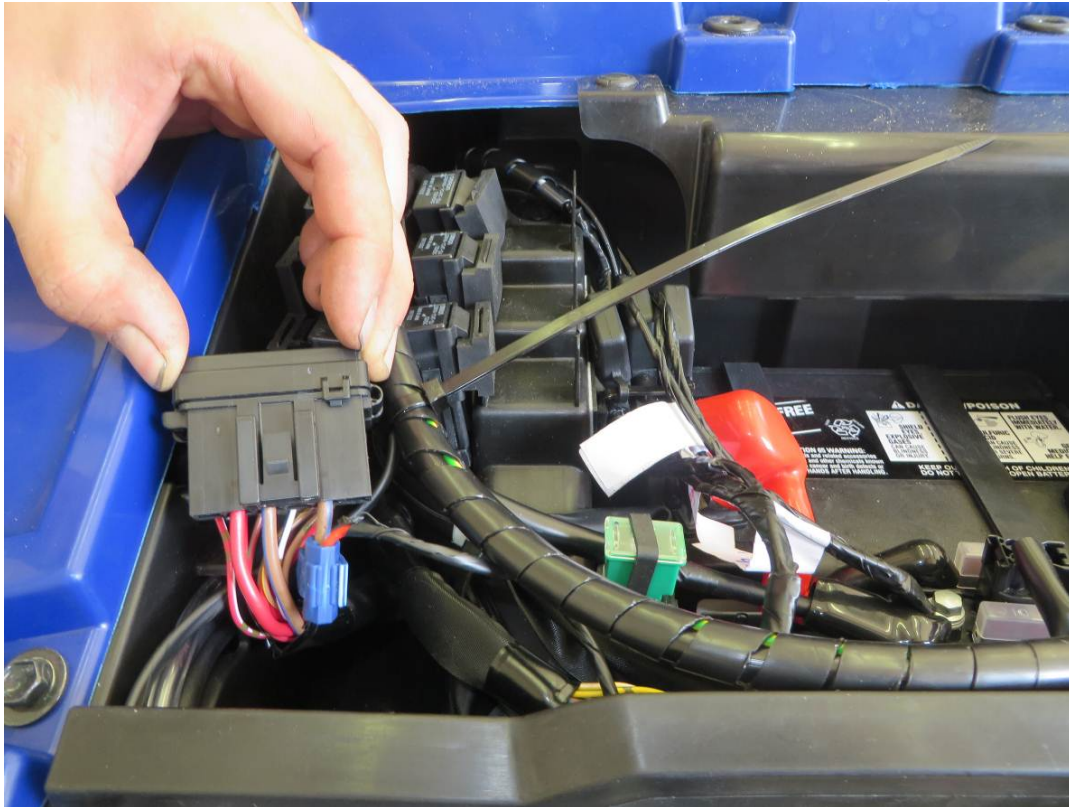

FILL THE WASHER TANK WITH THE WASHER LIQUID BEFORE FIRST USAGE.

HEATER

IMPORTANT

IT IS ABSOLUTELY NECESSARY TO TAKE OUT THE RUBBER PLUGS FROM THE HEATER TUBES!!!

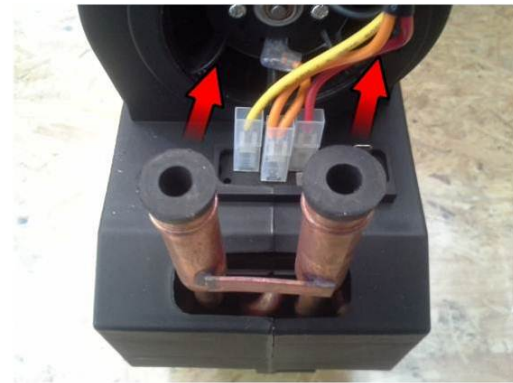
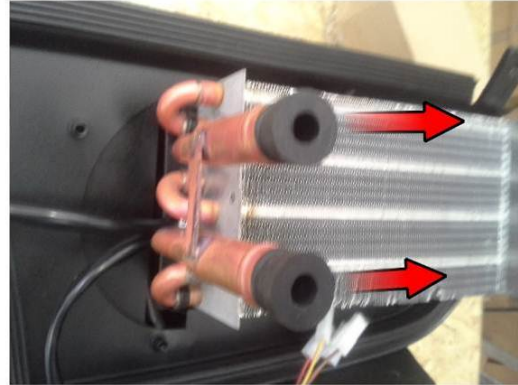

The heater assembly is designed for installation into the glovebox.



Uninstall the glovebox door from the glove box.
Cut holes into the glove box front wall necessary for the hot water hoses.



FOR ALL TECHNICAL QUESTIONS, PLEASE CALL
DFK AMERICA INC.
(630) 324-8585

Place the heater holder into the position and fix by included rubber rivets. Lead the heater harness through the prepared hole inside the glovebox.



Cut the heater hose to two same pieces. Install the heater hoses onto the heater. Install the air vent into the one heater hose and tighten straps hard (red circle). Lead the heater hoses through the prepared holes.



FOR ALL TECHNICAL QUESTIONS, PLEASE CALL
DFK AMERICA INC.
(630) 324-8585

Connect the heater to the heater harness branch.

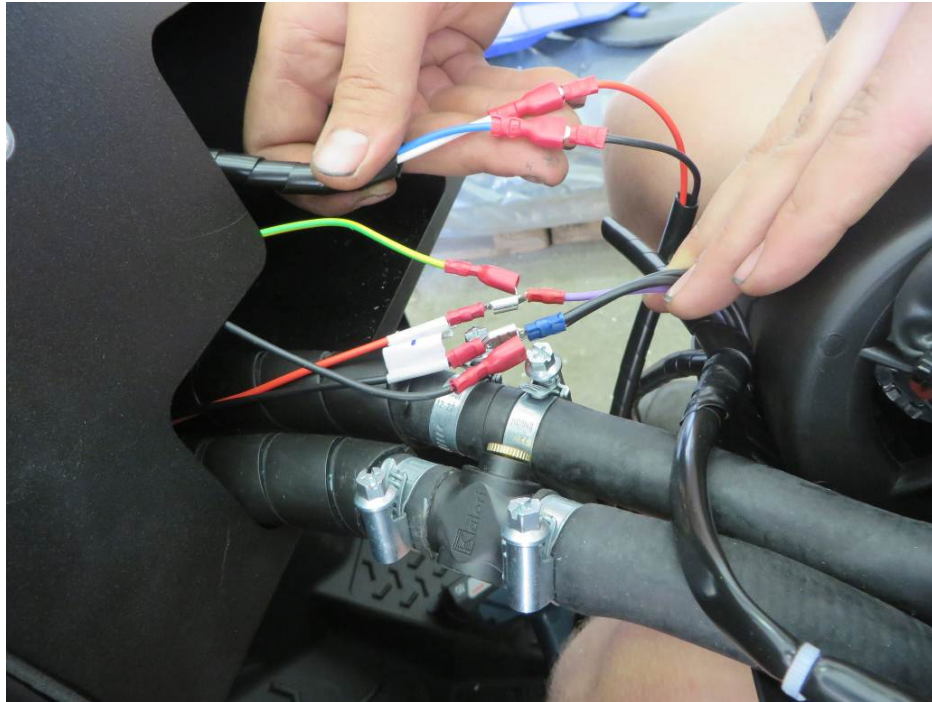

DETAILED VIEWS OF THE HARNESSES

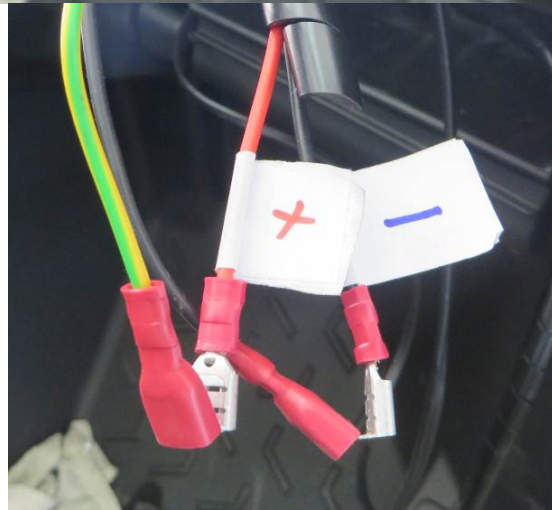
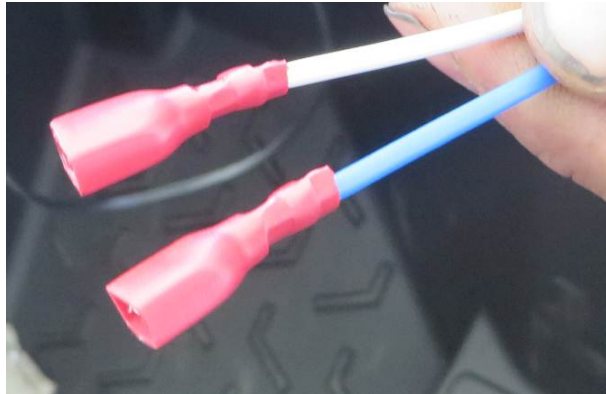

FOR ALL TECHNICAL QUESTIONS, PLEASE CALL
DFK AMERICA INC.
(630) 324-8585

Place the heater onto the heater holder and fix by included screws.

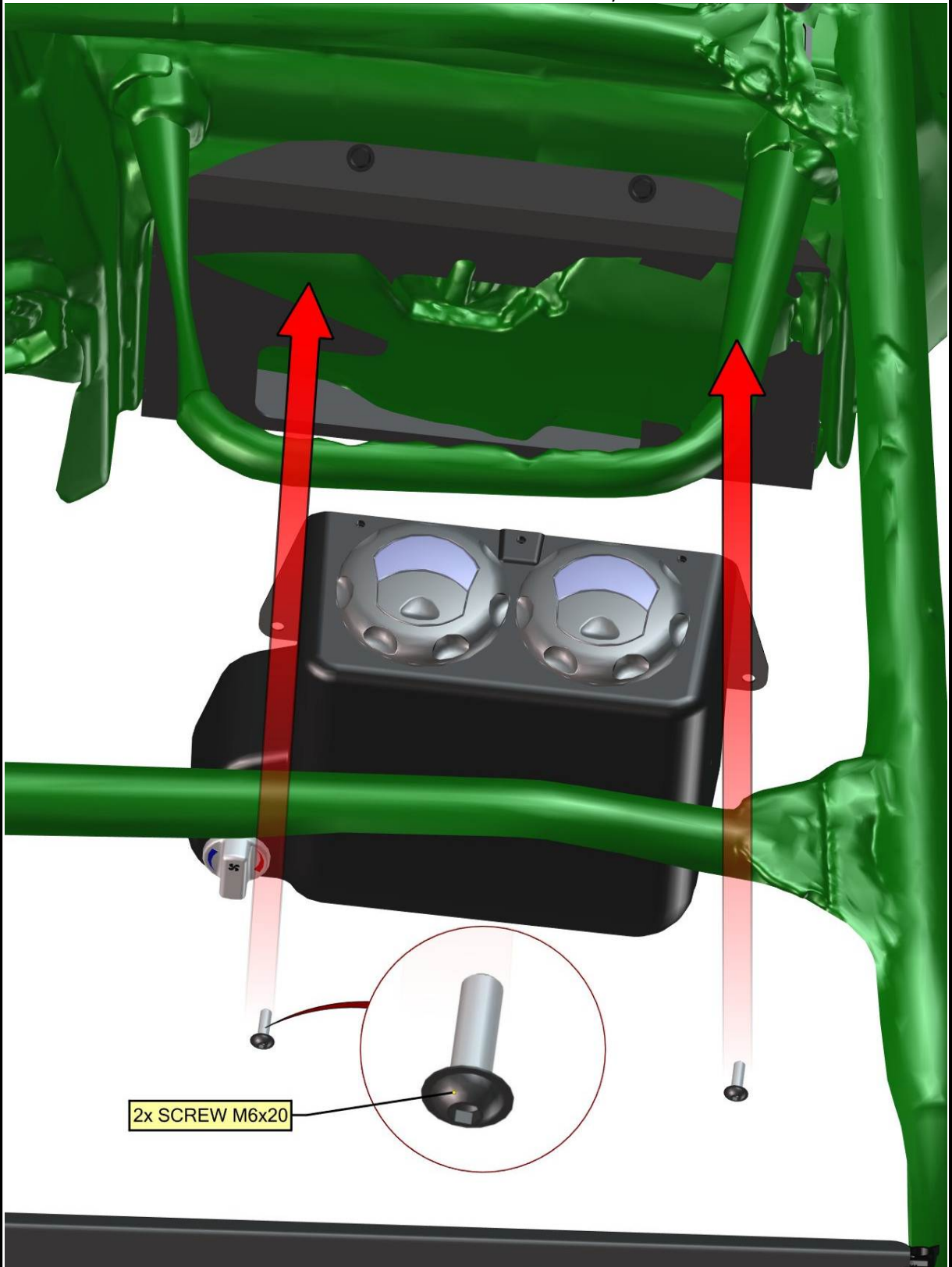

48

FOR ALL TECHNICAL QUESTIONS, PLEASE CALL
DFK AMERICA INC.
(630) 324-8585

Install the water pump into the heater hose with the el. valve in same position like on picture below.

Be very careful to not install pump in revers position.

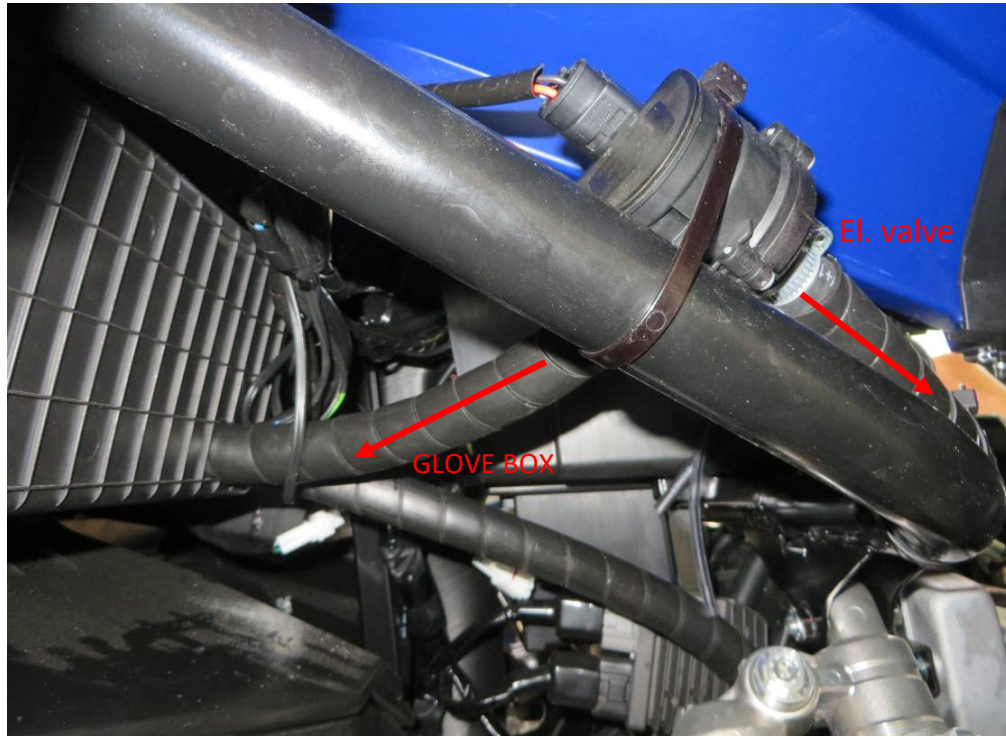

Install the heater hose onto the electric valve and tighten tightening strap hard (red circle).

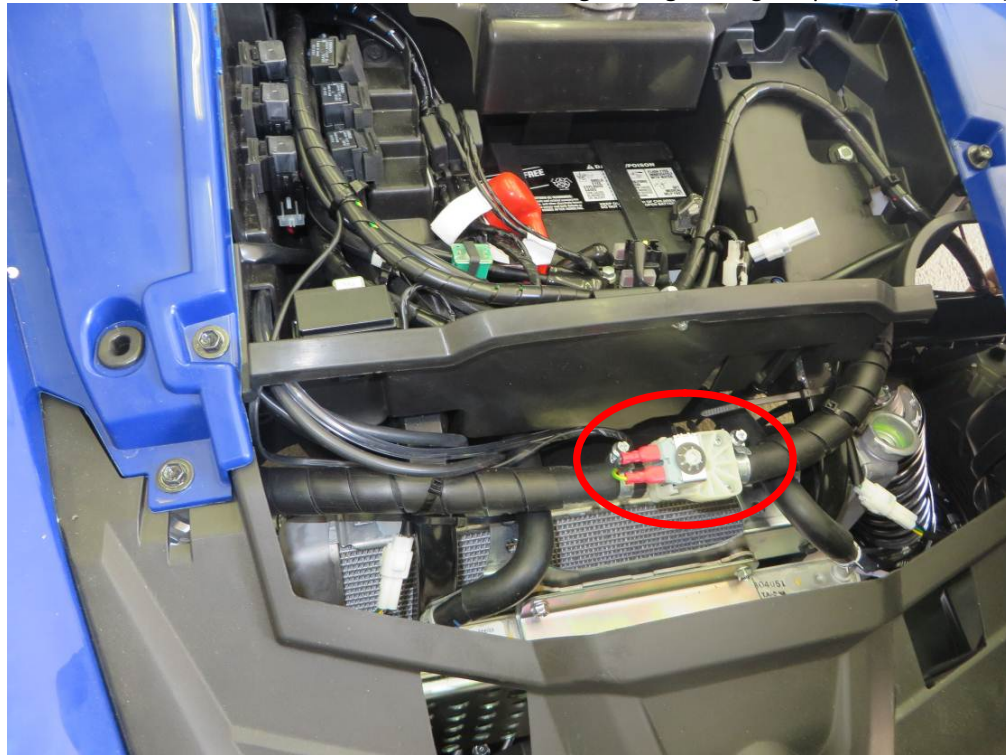

FOR ALL TECHNICAL QUESTIONS, PLEASE CALL
DFK AMERICA INC.
(630) 324-8585

Connect the pump harness with the el. vent harness branch
black to black and other by included connectors.

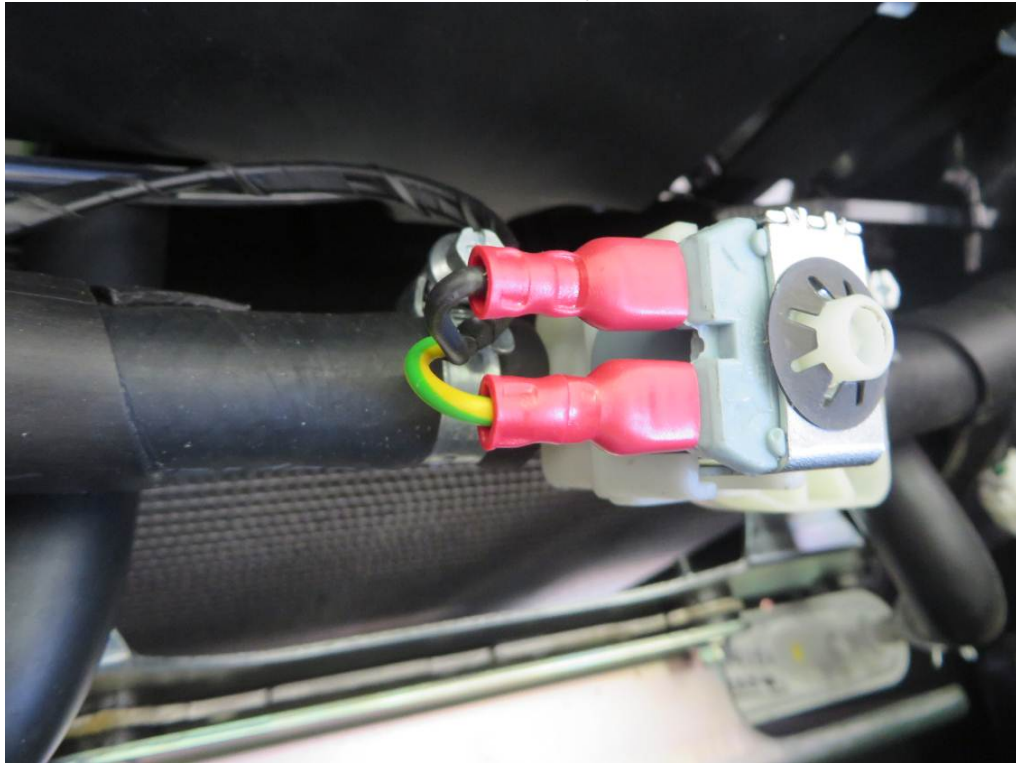

SEE THE NEXT PAGES

50

It is important to keep a reserve 10 inches each hose and cables for pulling of the heater assembly in the next steps.

Run the hose with the electric valve through the inner dashboard space left front wheel.
Run the hose with the air vent through the inner dashboard space to the right front wheel.

Lock the original cooling hose by clamps near the cooler (near left front wheel) and install "Y" couple and tightening straps. It is important to smaller part of coupling go down and onto front side.
Install heater hose with el. valve and tightening strap to this coupling. Tighten all straps very hard.

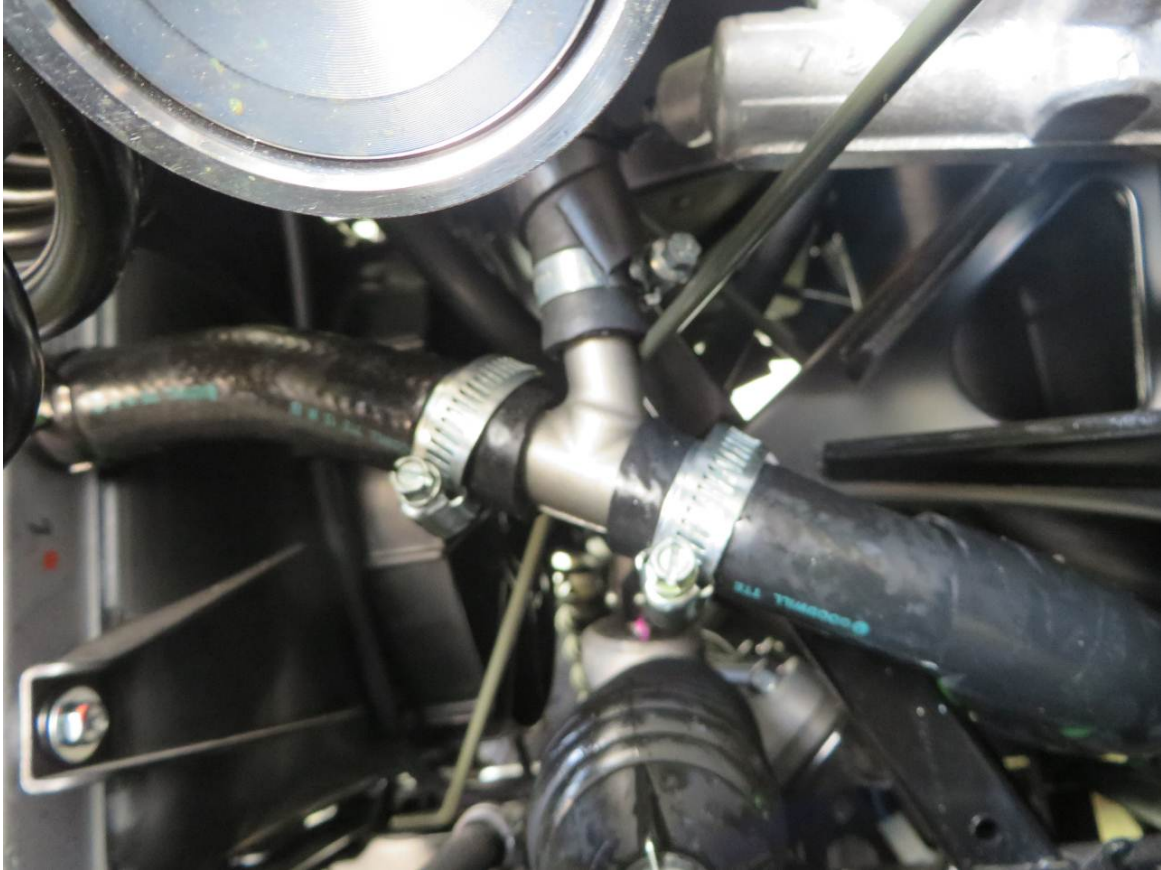

Unlock the clamps from the original cooling hose.
SEE NEXT PAGE

51

Lock the original cooling hose by clamps near the cooler (near right front wheel) and install "Y" couple and tightening straps. It is important to smaller part of coupling go onto front side. Install heater hose with air vent and tightening strap to this coupling. Tighten all straps very hard.

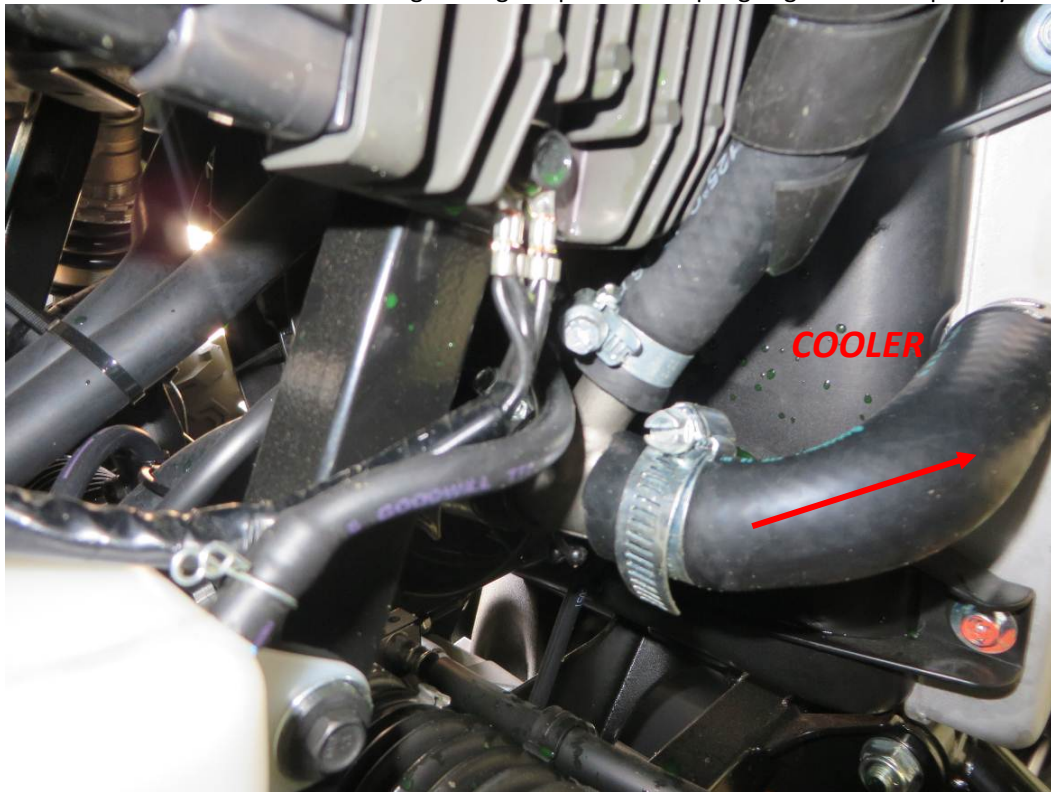

52

Run the heater harness to the UTV's battery space. Connect the branches with the UTV's fuse box wire (brown/blue) and with the battery "-"

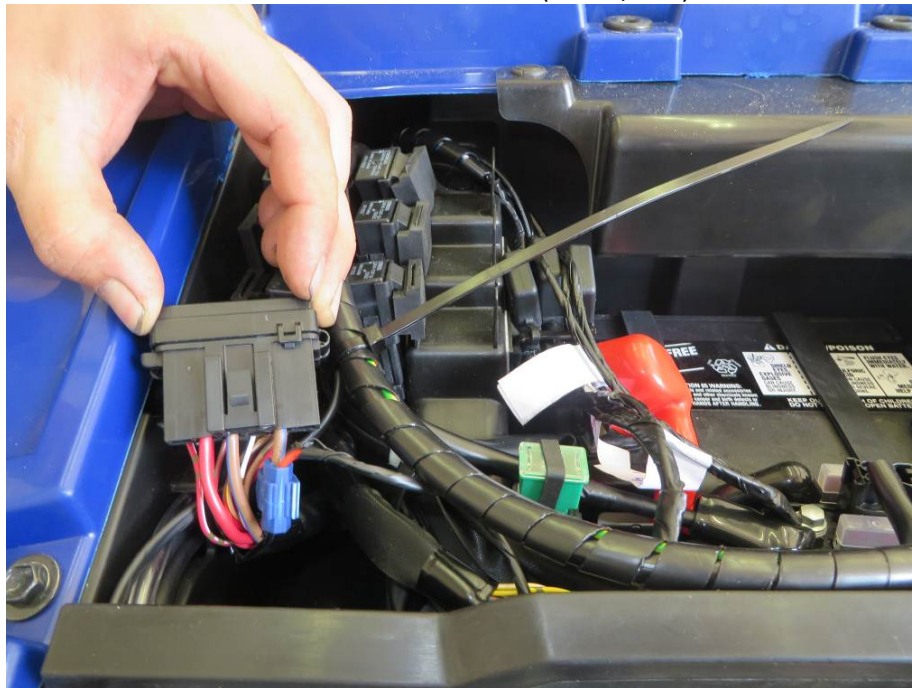

FOR ALL TECHNICAL QUESTIONS, PLEASE CALL
DFK AMERICA INC.
(630) 324-8585



It is absolutely necessary to bleed the air out of the UTV's engine cooling system. Incomplete bleeding of cooling system can result in engine damage. If you don't have sufficient experience with this process, we strongly recommend professional service technician assistance. We are not responsible for damages when cooling system bled incompletely. Please note that additional heater system will absorb more than 2 liters of coolant fluid.

- 1. Important: After the heater system installed check the system for leaks. Turn on the electric vent switch and confirm that the engine is cold. Start the engine, open bleeding valve and wait until engine warms up. Important: Always check engine temperature – if it overheats turn off engine.***
- 2. To achieve engine operating temperature depress the accelerator to increase the engine RPM. This will increase the pressure and flow of the water pump forcing more coolant through the heater. After operating temperature reaches turn off engine and open it. Trapped air should come out from heater system throughout bleeding valve. Repeat this procedure until heater/cooling system is completely bled out.***

The DFK Cab heater, like the heater in a car, generates heat from the vehicle's engine.

In nearly all cases, the heater should generate enough heat from your UTV, side by side, or tractor engine that you may need to turn the heater off periodically otherwise the air in the cabin may be too hot.

It is important to check the coolant level regularly at least 4-5 times during the first several days of operation and fill as necessary until the coolant level has stabilized. The heater will draw and retain coolant, sometimes at the expense of coolant to the engine. This can cause engine overheating if not managed properly.